

**BEREXCO, LLC
LANG LEASE
SE. 1/4, SECTION 30, T15S, R12W
RUSSELL COUNTY, KANSAS**

GRAVEL (STICKNEY RD.) ROAD

Notes:

1. Set (2) wood stakes at location site.
2. All flagging Red & Yellow.
3. Overhead power available at N. & S. lines and S. 1/4 of W. line, Sec. 30.
4. Kansas One Call System Inc. should be notified before excavation (1-800-344-7233).
5. CAUTION: Various pipelines in Sec. 30.
6. Contact landowner for best access and as to location of wood stakes in wheat.

30

Drillsite Location
Lang NCR 6

80'S. E. 1/2 SE SE
580'FSL 330'FEL

Ground Elevation = 1876

Y = 138960 X = 1802911

State Plane-NAD 27-Kansas North
(Mapping Grade GPS Used)

PRODUCER PRODUCER

1883

PRODUCER TANK BATTERY

●●●●

WHEAT

FLAGGED ROAD
OPPOSITE LOC.

GRAVEL (MICHAELIS RD.) ROAD

Ingress and egress to location as shown on this plot is per usage only and may not be legally opened for public use. Contact landowner, tenant and county road department for access.

ROAD (193 ST.)
GRAVEL

ROAD (194 ST.)
GRAVEL

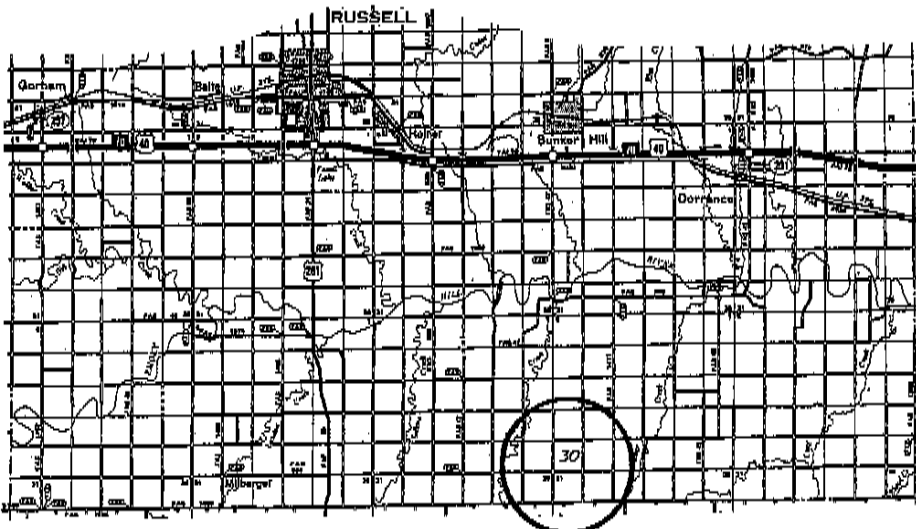
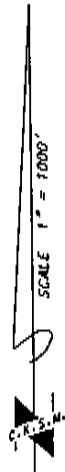

* Controlling data is based upon the best maps and photographs available to us and upon a regular section of land containing 640 acres.
 * Approximate section lines were determined using the normal standards of care of oilfield surveyors practicing in the state of Kansas. The section corners, which establish the precise section lines, were not necessarily located, and the exact location of the drillsite location in the section is not guaranteed. Therefore, the operator securing this service and accepting this plot and all other parties relying thereon agree to hold Central Kansas Oilfield Services, Inc., its officers and employees harmless from all losses, costs and expenses and said whittles released from any liability from incidental or consequential damages.
 * Elevations derived from National Geodetic Vertical Datum.

Date January 13, 2012