

Proposed Plan of Construction

Benson B-2  
Sec 23 T29S-R33W  
Haskell County, KS

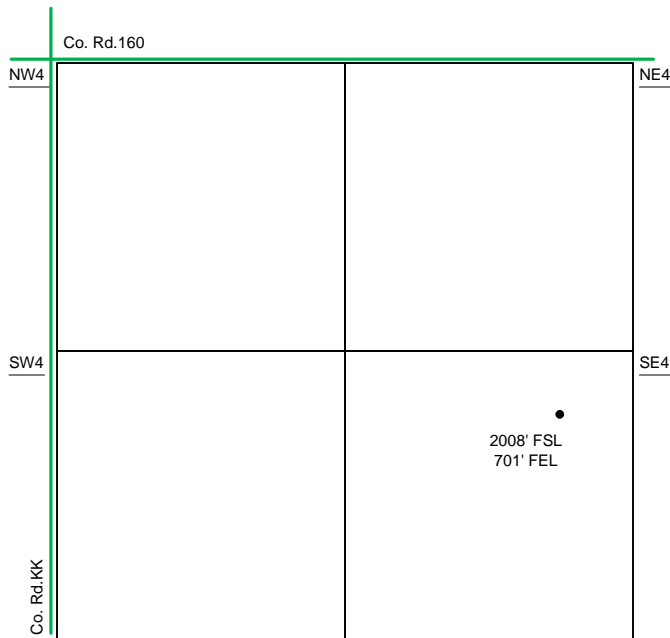

Sec 23 - T29S - R33W

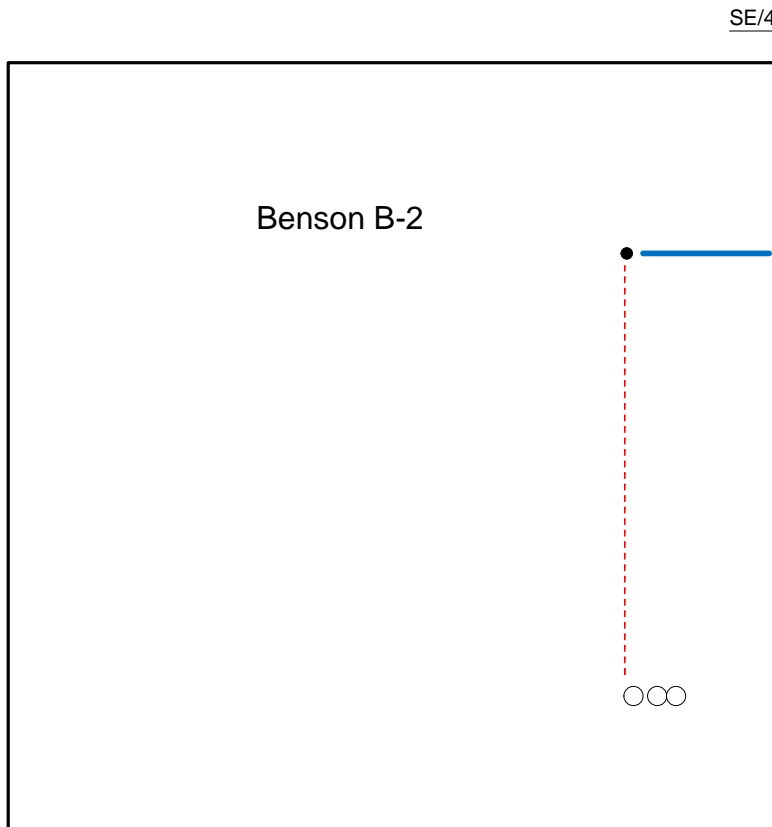

- Well Location
- Proposed Lease Roads
- - - Proposed Pipeline
- Proposed Tank Battery
- Proposed Power Lines
- - - Existing Pipeline

The **EXISTING** Tank Battery for the Benson B-2 is located in the SE of the SE quarter.

Proposed Details of  
SE/4 Sec 23 - T29S - R33W

Note-Drawing **Not** to Scale

Proposed Site Diagram  
Benson B-2  
January 24, 2012

