

Proposed Plan of Construction
 Watkins B-2
 Sec 23 T29S-R33W
 Haskell County, KS

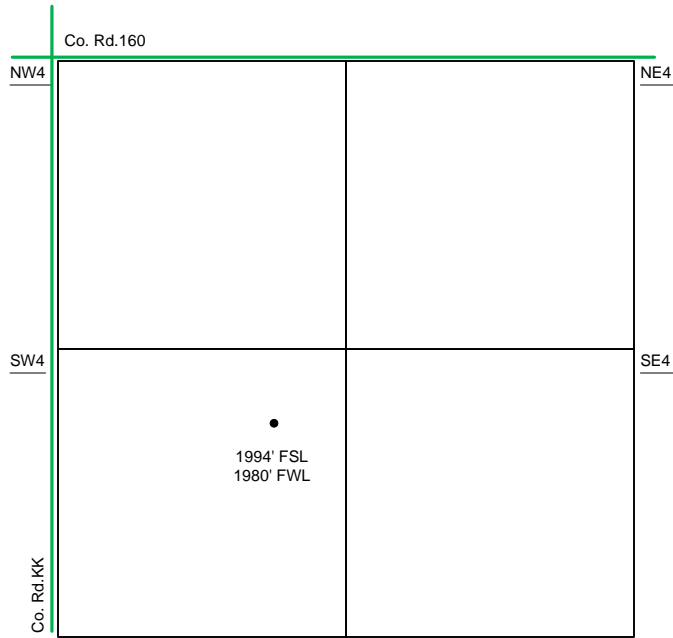

Sec 23 – T29S – R33W

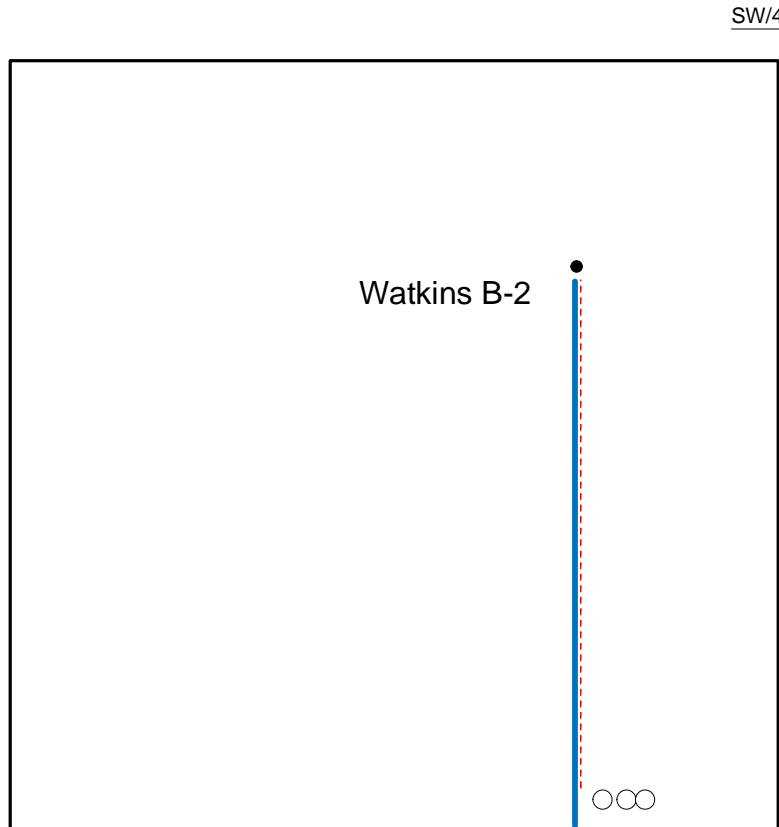

SW/4

- Well Location
- Proposed Lease Roads
- - - Proposed Pipeline
- Proposed Tank Battery
- Proposed Power Lines
- - - Existing Pipeline

The **EXISTING** Tank Battery for the Watkins B-2 is located in the SE of the SW quarter.

Proposed Details of
 SW/4 Sec 23 -T29S -R33W

Note-Drawing **Not** to Scale

