





1073947

**For KCC Use ONLY**

API # 15 - \_\_\_\_\_

### IN ALL CASES PLOT THE INTENDED WELL ON THE PLAT BELOW

In all cases, please fully complete this side of the form. Include items 1 through 5 at the bottom of this page.

Operator: \_\_\_\_\_

Lease: \_\_\_\_\_

Well Number: \_\_\_\_\_

Field: \_\_\_\_\_

Number of Acres attributable to well: \_\_\_\_\_

QTR/QTR/QTR/QTR of acreage: \_\_\_\_\_ - \_\_\_\_\_ - \_\_\_\_\_ - \_\_\_\_\_

Location of Well: County: \_\_\_\_\_

\_\_\_\_\_ feet from  N /  S Line of Section

\_\_\_\_\_ feet from  E /  W Line of Section

Sec. \_\_\_\_\_ Twp. \_\_\_\_\_ S. R. \_\_\_\_\_  E  W

Is Section:  Regular or  Irregular

**If Section is Irregular, locate well from nearest corner boundary.**

Section corner used:  NE  NW  SE  SW

### PLAT

Show location of the well. Show footage to the nearest lease or unit boundary line. Show the predicted locations of lease roads, tank batteries, pipelines and electrical lines, as required by the Kansas Surface Owner Notice Act (House Bill 2032). You may attach a separate plat if desired.

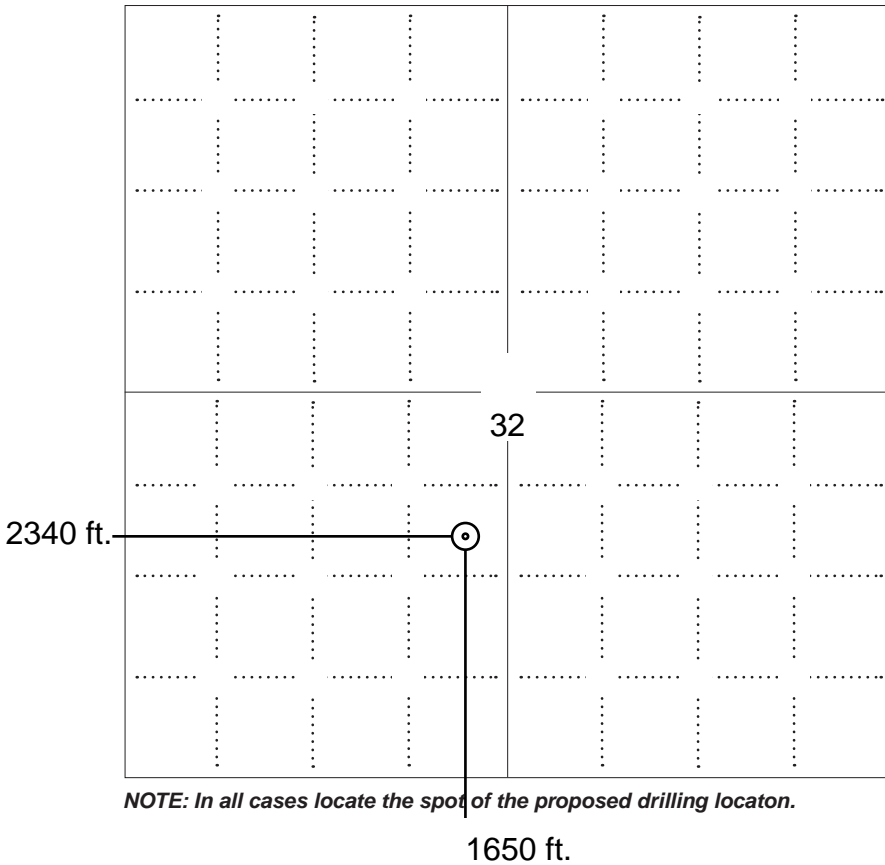

**NOTE: In all cases locate the spot of the proposed drilling location.**

### LEGEND

- Well Location
- Tank Battery Location
- Pipeline Location
- Electric Line Location
- Lease Road Location

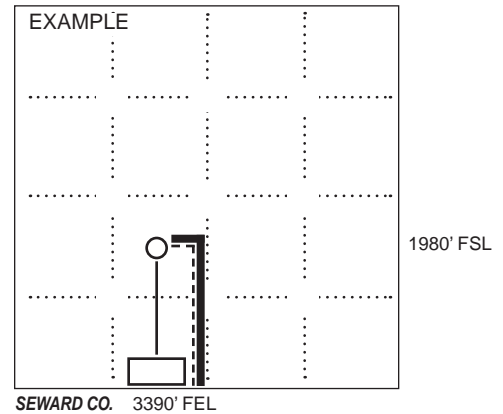

#### In plotting the proposed location of the well, you must show:

- The manner in which you are using the depicted plat by identifying section lines, i.e. 1 section, 1 section with 8 surrounding sections, 4 sections, etc.
- The distance of the proposed drilling location from the south / north and east / west outside section lines.
- The distance to the nearest lease or unit boundary line (in footage).
- If proposed location is located within a prorated or spaced field a certificate of acreage attribution plat must be attached: (C0-7 for oil wells; CG-8 for gas wells).
- The predicted locations of lease roads, tank batteries, pipelines, and electrical lines.



KANSAS CORPORATION COMMISSION 1073947  
OIL & GAS CONSERVATION DIVISION

Form CDP-1  
May 2010  
Form must be Typed

**APPLICATION FOR SURFACE PIT**

*Submit in Duplicate*

Operator Name: _____		License Number: _____	
Operator Address: _____			
Contact Person: _____		Phone Number: _____	
Lease Name & Well No.: _____		Pit Location (QQQQ): _____-_____-_____-_____	
Type of Pit: <input type="checkbox"/> Emergency Pit <input type="checkbox"/> Burn Pit <input type="checkbox"/> Settling Pit <input type="checkbox"/> Drilling Pit <input type="checkbox"/> Workover Pit <input type="checkbox"/> Haul-Off Pit <i>(If WP Supply API No. or Year Drilled)</i>		Pit is: <input type="checkbox"/> Proposed <input type="checkbox"/> Existing If Existing, date constructed: _____ Pit capacity: _____ (bbls)	
Is the pit located in a Sensitive Ground Water Area? <input type="checkbox"/> Yes <input type="checkbox"/> No		Chloride concentration: _____ mg/l <i>(For Emergency Pits and Settling Pits only)</i>	
Is the bottom below ground level? <input type="checkbox"/> Yes <input type="checkbox"/> No		Artificial Liner? <input type="checkbox"/> Yes <input type="checkbox"/> No	
How is the pit lined if a plastic liner is not used?			
Pit dimensions (all but working pits): _____ Length (feet)    _____ Width (feet) <input type="checkbox"/> N/A: Steel Pits Depth from ground level to deepest point: _____ (feet) <input type="checkbox"/> No Pit			
If the pit is lined give a brief description of the liner material, thickness and installation procedure.		Describe procedures for periodic maintenance and determining liner integrity, including any special monitoring.	
Distance to nearest water well within one-mile of pit: _____ feet    Depth of water well _____ feet		Depth to shallowest fresh water _____ feet. Source of information: <input type="checkbox"/> measured <input type="checkbox"/> well owner <input type="checkbox"/> electric log <input type="checkbox"/> KDWR	
<b>Emergency, Settling and Burn Pits ONLY:</b> Producing Formation: _____ Number of producing wells on lease: _____ Barrels of fluid produced daily: _____ Does the slope from the tank battery allow all spilled fluids to flow into the pit? <input type="checkbox"/> Yes <input type="checkbox"/> No		<b>Drilling, Workover and Haul-Off Pits ONLY:</b> Type of material utilized in drilling/workover: _____ Number of working pits to be utilized: _____ Abandonment procedure: _____ Drill pits must be closed within 365 days of spud date.	
<p><b>Submitted Electronically</b></p>			

**KCC OFFICE USE ONLY**

Liner     Steel Pit     RFAC     RFAS

Date Received: \_\_\_\_\_ Permit Number: \_\_\_\_\_ Permit Date: \_\_\_\_\_ Lease Inspection:     Yes     No



### CERTIFICATION OF COMPLIANCE WITH THE KANSAS SURFACE OWNER NOTIFICATION ACT

*This form must be submitted with all Forms C-1 (Notice of Intent to Drill); CB-1 (Cathodic Protection Borehole Intent); T-1 (Request for Change of Operator Transfer of Injection or Surface Pit Permit); and CP-1 (Well Plugging Application). Any such form submitted without an accompanying Form KSONA-1 will be returned.*

Select the corresponding form being filed:  C-1 (Intent)  CB-1 (Cathodic Protection Borehole Intent)  T-1 (Transfer)  CP-1 (Plugging Application)

OPERATOR: License # \_\_\_\_\_  
Name: \_\_\_\_\_  
Address 1: \_\_\_\_\_  
Address 2: \_\_\_\_\_  
City: \_\_\_\_\_ State: \_\_\_\_\_ Zip: \_\_\_\_\_ + \_\_\_\_\_  
Contact Person: \_\_\_\_\_  
Phone: ( \_\_\_\_\_ ) \_\_\_\_\_ Fax: ( \_\_\_\_\_ ) \_\_\_\_\_  
Email Address: \_\_\_\_\_

Well Location:  
\_\_\_\_ - \_\_\_\_ - \_\_\_\_ - \_\_\_\_ Sec. \_\_\_\_ Twp. \_\_\_\_ S. R. \_\_\_\_  East  West  
County: \_\_\_\_\_  
Lease Name: \_\_\_\_\_ Well #: \_\_\_\_\_

*If filing a Form T-1 for multiple wells on a lease, enter the legal description of the lease below:*

**Surface Owner Information:**

Name: \_\_\_\_\_  
Address 1: \_\_\_\_\_  
Address 2: \_\_\_\_\_  
City: \_\_\_\_\_ State: \_\_\_\_\_ Zip: \_\_\_\_\_ + \_\_\_\_\_

*When filing a Form T-1 involving multiple surface owners, attach an additional sheet listing all of the information to the left for each surface owner. Surface owner information can be found in the records of the register of deeds for the county, and in the real estate property tax records of the county treasurer.*

*If this form is being submitted with a Form C-1 (Intent) or CB-1 (Cathodic Protection Borehole Intent), you must supply the surface owners and the KCC with a plat showing the predicted locations of lease roads, tank batteries, pipelines, and electrical lines. The locations shown on the plat are preliminary non-binding estimates. The locations may be entered on the Form C-1 plat, Form CB-1 plat, or a separate plat may be submitted.*

**Select one of the following:**

- I certify that, pursuant to the Kansas Surface Owner Notice Act (House Bill 2032), I have provided the following to the surface owner(s) of the land upon which the subject well is or will be located: 1) a copy of the Form C-1, Form CB-1, Form T-1, or Form CP-1 that I am filing in connection with this form; 2) if the form being filed is a Form C-1 or Form CB-1, the plat(s) required by this form; and 3) my operator name, address, phone number, fax, and email address.
- I have not provided this information to the surface owner(s). I acknowledge that, because I have not provided this information, the KCC will be required to send this information to the surface owner(s). To mitigate the additional cost of the KCC performing this task, I acknowledge that I am being charged a \$30.00 handling fee, payable to the KCC, which is enclosed with this form.

*If choosing the second option, submit payment of the \$30.00 handling fee with this form. If the fee is not received with this form, the KSONA-1 form and the associated Form C-1, Form CB-1, Form T-1, or Form CP-1 will be returned.*

I Submitted Electronically

I

For KCC Use ONLY  
 API # 15 - \_\_\_\_\_

**IN ALL CASES PLOT THE INTENDED WELL ON THE PLAT BELOW**

In all cases, please fully complete this side of the form. Include items 1 through 5 at the bottom of this page.

Operator: Royal Drilling, Inc.  
 Lease: Wegele E  
 Well Number: 2  
 Field: Cromwell  
 Number of Acres attributable to well: \_\_\_\_\_  
 QTR/QTR/QTR/QTR of acreage: E2 - SE - NE - SW

Location of Well: County: Russell  
1,650 feet from  N /  S Line of Section  
2,340 feet from  E /  W Line of Section  
 Sec. 32 Twp. 15 S. R. 15  E  W

Is Section:  Regular or  Irregular

If Section is Irregular, locate well from nearest corner boundary.

Section corner used:  NE  NW  SE  SW

**PLAT**

Show location of the well. Show footage to the nearest lease or unit boundary line. Show the predicted locations of lease roads, tank batteries, pipelines and electrical lines, as required by the Kansas Surface Owner Notice Act (House Bill 2032). You may attach a separate plat if desired.

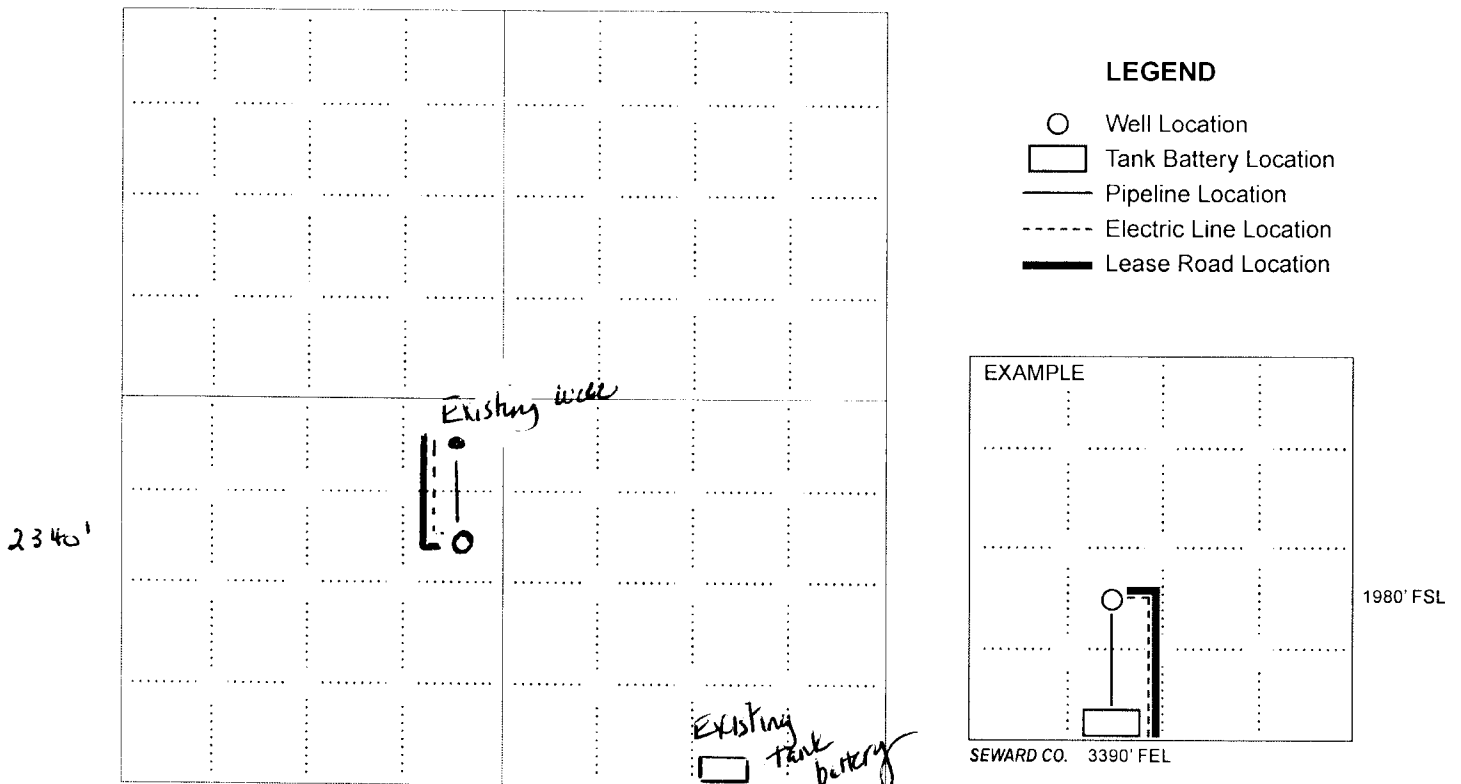

NOTE: In all cases locate the spot of the proposed drilling location.

1650'

In plotting the proposed location of the well, you must show:

1. The manner in which you are using the depicted plat by identifying section lines, i.e. 1 section, 1 section with 8 surrounding sections, 4 sections, etc.
2. The distance of the proposed drilling location from the south / north and east / west outside section lines.
3. The distance to the nearest lease or unit boundary line (in footage).
4. If proposed location is located within a prorated or spaced field a certificate of acreage attribution plat must be attached: (C0-7 for oil wells; CG-8 for gas wells).
5. The predicted locations of lease roads, tank batteries, pipelines, and electrical lines.

# OIL AND GAS LEASE

*[Handwritten initials]*

THIS AGREEMENT, Entered into this the 5th day of February, 1979  
between Solomon Wegele and Bertha Wegele, his wife  
Rt. 1, Russell, Kansas 67665

and Cities Service Company hereinafter called Lessor,  
hereinafter called Lessee, does witness:

1. That lessor, for and in consideration of the sum of Ten & more Dollars in hand paid and of the covenants and agreements hereinafter contained to be performed by the lessee, has this day granted, leased, and let and by these presents does hereby grant, lease, and let exclusively unto the lessee the hereinafter described land, and with the right to utilize this lease or any part thereof with other oil and gas leases as to all or any part of the lands covered thereby as hereinafter provided, for the purpose of carrying on geological, geophysical and other exploratory work, including core drilling and the drilling, mining, and operating for, producing, and saving all of the oil, gas, casinghead gas, casinghead gasoline and their respective constituent vapors, and all other gases or for constructing roads, laying pipe lines, building tanks, storing oil, building power, stations, telephone lines and other structures thereon necessary or convenient for the economical operation of said land alone or conjointly with neighboring lands, to produce, save, take care of, and manufacture

all of such substances, said tract of land with any reversionary rights therein being situated in the County of Russell, State of Kansas, and described as follows:

Township 15 South, Range 15 West  
Section 32: The East Half of the Southeast Quarter (E $\frac{1}{2}$ SE $\frac{1}{4}$ ) and the Northwest Quarter Of the Southeast Quarter (NW $\frac{1}{4}$ SE $\frac{1}{4}$ ) and Northeast Quarter of the Southwest Quarter (NE $\frac{1}{4}$ SW $\frac{1}{4}$ )  
containing 160 acres, more or less.

2. This lease shall remain in force for a term of five years from November 20th, 1979 or any of the products covered by this lease is or can be produced.

3. The lessee shall deliver to lessor as royalty, free of cost, on the lease, or on the pipe line to which lessee may connect its wells the equal one-eighth part of all oil produced and saved from the leased premises, or at the lessee's option may pay to the lessor for such one-eighth royalty the market price for oil of like grade and gravity prevailing on the day such oil is run into the pipe line or into storage tanks.

4. The lessee shall pay to lessor for gas produced from any oil well and used by the lessee for the manufacture of gasoline or any other product as royalty 1/3 of the market value of such gas at the mouth of the well; if said gas is sold by the lessee, then as royalty 1/8 of the proceeds of the sale thereof at the mouth of the well. The lessee shall pay lessor as royalty 1/8 of the proceeds from the sale of gas as such at the mouth of the well where gas, condensate, distillate or other gaseous substance is found, and where such gas is not sold or used lessee may pay or tender annually at the end of each yearly period during the completion of the first such gas well during which such gas is not sold or used, as in lieu royalty, whether one or more wells, an amount equal to the delay rental provided in paragraph 5 hereof and while said in lieu royalty is so paid or tendered it will be considered under all provisions of this lease that gas is being produced in paying quantities. The lessor to have gas free of charge from any gas well on the leased premises for stoves and inside lights in the principal dwelling house on said land by making his own connections with the well, the use of such gas to be at the lessor's sole risk and expense.

5. If operations for the drilling of a well for oil or gas are not commenced on said land on or before the 20th day of November, 1980, this lease shall terminate as to both parties, unless the lessee shall on or before said date by check or draft pay or tender to the lessor or for the lessor's credit in the Otis State Bank at Otis, Kansas 67565

or its successors, which Bank and its successors are the lessor's agent and shall continue as the depository of any and all sums payable under this lease regardless of changes of ownership in said land or in the oil and gas or in the rentals to accrue hereunder, the sum of One Hundred Sixty & no/100 Dollars which shall operate as a rental and cover the expense of deferring the commencement of operations for drilling for a period of one year. In like manner and upon like payments or tenders the commencement of operations for drilling may further be deferred for like periods successively. All payments or tenders may be made by check or draft of lessee or any assignee thereof, mailed or delivered on or before the rental paying date, either in full or in part, and to said depository bank, and it is understood and agreed that the consideration first recited herein, the down payment, covers not only the privilege granted to the date when said first rental is payable as aforesaid, but also the lessee's option of extending that period as aforesaid and any and all other rights conferred. Notwithstanding the death of the lessor or his successors in interest, the payment or tender of rentals in the manner above shall be binding on the heirs, devisees, executors, and administrators of such persons.

6. In the event said lessor owns a less interest in the above described land than the entire and undivided fee simple estate therein then the royalties and rentals here provided for shall be paid the said lessor only in the proportion which his interest bears to the whole and undivided fee; however, in the event the title to any interest in said land should revert to lessor, or his heirs, or his or their grantees, this lease shall cover such reversion, and rentals hereunder shall be increased at the next succeeding rental anniversary after written notice of such reversion by lessor to lessee, provided said notice is received by lessee at least 30 days prior to any such rental anniversary.

7. The lessee shall have the right to use, free of cost, gas, oil and water found on said land for its operations thereon, except water from the wells of the lessor. When required by lessor, the lessee shall bury its pipe lines below plow depth and shall pay for damage caused by its operations to growing crops on said land. No well shall be drilled a greater than 200 feet to the house or barn now on said premises without written consent of the lessor. Lessee shall have the right at any time during, or after the expiration of this lease to remove all machinery, fixtures, houses, buildings and other structures placed on said premises, including the right to drag and remove all casing, but lessee shall be under no obligation to do so.

8. If the estate of either party hereto is assigned (and the privilege of assigning in whole or in part is expressly allowed), the covenants hereof shall extend to the heirs, devisees, executors, administrators, successors, and assigns, but no change or division in ownership of the land, rentals, or royalties, however accomplished, shall operate to enlarge the obligations or diminish the rights of lessee, and no change of ownership in the land or in the rentals or royalties or any sum due under this lease shall be binding on the lessee until it has been furnished with either the original recorded instrument of conveyance or a duly certified copy thereof, or a certified copy of the will of any deceased owner and of the probate thereof, or certified copy of the proceedings of conveyance or a duly certified copies thereof necessary in showing a complete chain of title back to lessor to the full interest claimed, and all advance payments of rentals made hereunder before receipt of said documents shall be binding on any direct or indirect assignee, grantee, devisee, administrator, executor, or heir of lessor.

9. There shall be no obligation on the part of the lessee to offset wells on separate tracts into which the land covered by this lease may be hereafter divided by sale, devise, descent or otherwise, or to furnish separate measuring or receiving tanks. It is hereby agreed that in the event this lease shall be assigned as to a part or as to units of the above described land, and the holder or owner of any such part or parts shall make default in the payment of the proportionate part of the royalty due from him or them, such default shall not operate to defeat or affect this lease insofar as it covers a part of said land upon which the lessee or any assignee hereof, shall make due payment of said rentals.

10. Lessor hereby warrants and agrees to defend the title to the land herein described and agrees that the lessee, at its option, may pay and discharge in whole or in part any taxes, mortgages, or other liens existing, levied, or assessed on or against the above described land, and in event it exercises such option it shall be subrogated to the rights of any holder or holders thereof and may reimburse itself by applying to the discharge of any such mortgage, tax or other lien, any royalty or rentals accruing hereunder.

11. If at any time prior to discovery of oil or gas on said land, lessee should drill a dry hole or holes thereon, or if after discovery of oil or gas the production thereof should cease from any cause, this lease shall terminate if lessee commences additional drilling or reworking operations within sixty (60) days thereafter or if it be within the primary term commences or resumes the payment or tender of rentals on or before the rental payment date next ensuing after the expiration of three months from the date of completion of the dry hole or cessation of production. If at the expiration of the primary term oil or gas is not being produced on said land, but lessee is then engaged in drilling or reworking operations thereon, the lease shall remain in force so long as operations are prosecuted, either on the same well or any other well thereafter commenced, with no cessation of more than sixty (60) consecutive days, and if they result in the production of oil or gas, this lease shall remain in effect so long thereafter as there is production of oil or gas under any provision of this lease.

12. Lessee may at any time surrender or cancel this lease in whole or in part by delivering or mailing such release to the lessor, or by placing same of record in the proper county. In case said lease is surrendered and canceled as to only a portion of the acreage covered thereby, then all payments and liabilities thereafter accruing under the terms of said lease as to the portion canceled shall cease and determine and any rentals thereafter paid may be apportioned on an acreage basis, but as to the portion of the acreage not released the terms and provisions of this lease shall continue and remain in full force and effect for all purposes.

13. All provisions hereof, express or implied, shall be subject to all federal and state laws and the orders, rules, or regulations (and interpretations thereof) of all governmental agencies administering the same, and this lease shall not be in any way terminated wholly or partially nor shall the lessee be liable in damages for failure to comply with any of the express or implied provisions hereof if such failure accords with any such laws, orders, rules or regulations for interpretations thereof. If lessee should be prevented during the last six months of the primary term herefrom from drilling a well hereunder by the order of any constituted authority having jurisdiction thereover, or if lessee should be unable during said period to drill a well hereunder due to equipment necessary in the drilling thereof not being available on account of any cause, the primary term of this lease shall continue until six months after said order is suspended and if said equipment is available, but the lessee shall pay delay rentals herein provided during such extension.

14. Lessee, at its option, is hereby given the right and power to pool or combine into one or more units the land covered by this lease, or any portion thereof, with other land covered by another lease, or leases adjoining same or in the vicinity thereof, when, in lessee's judgment, it is necessary or advisable to do so in order to properly develop and operate said lease premises so as to promote the conservation of such minerals in and under said land, such pooling to be of tracts adjoining same or in the vicinity thereof, as to form a compact unit or units, and to be in a unit or units not exceeding 40 acres each in the event of an oil well, or into a unit or units not exceeding 160 acres each in the event of a gas and/or condensate or distillate well. Lessee shall execute in writing and file for record in the county in which the land is situated an instrument identifying and describing the pooled acreage. The entire acreage so pooled into a unit or units shall be treated for all purposes, except the payments of royalties on production from the pooled unit, as if it were included in this lease. If production is found on any part of the pooled acreage it shall be treated as if production is had from this lease whether any well is located on the land covered by this lease or not. Any well drilled on any such unit shall be and constitute a well hereunder. In lieu of the royalties elsewhere herein specified lessor shall receive on production from the unit so pooled only such portion of the royalty stipulated herein as the amount of his net royalty interest therein on an acreage basis bears to the total mineral acreage so pooled in the particular unit involved.

15. This lease and all its terms, conditions, and stipulations shall extend to and be binding on all successors of said lessor and lessee.

IN WITNESS WHEREOF, we sign the day and year first above written.

Printed Name \_\_\_\_\_  
Printed Name \_\_\_\_\_  
Printed Name \_\_\_\_\_  
Printed Name \_\_\_\_\_

*Solomon Wegele*  
Solomon Wegele

*Bertha Wegele*  
Bertha Wegele

Oil & Gas 1559109  
File 1554109