



APPLICATION FOR COMMINGLING OF PRODUCTION (K.A.R. 82-3-123) OR FLUIDS (K.A.R. 82-3-123a) *Commingling ID # _____*

OPERATOR: License # _____ API No. 15 - _____
Name: _____ Spot Description: _____
Address 1: _____ - - - - - Sec. _____ Twp. _____ S. R. _____ East West
Address 2: _____ Feet from North / South Line of Section
City: _____ State: _____ Zip: _____ + _____ Feet from East / West Line of Section
Contact Person: _____ County: _____
Phone: (_____) _____ Lease Name: _____ Well #: _____

1. Name and upper and lower limit of each production interval to be commingled:
Formation: _____ (Perfs): _____
Formation: _____ (Perfs): _____
Formation: _____ (Perfs): _____
Formation: _____ (Perfs): _____
Formation: _____ (Perfs): _____

2. Estimated amount of fluid production to be commingled from each interval:
Formation: _____ BOPD: _____ MCFPD: _____ BWPD: _____
Formation: _____ BOPD: _____ MCFPD: _____ BWPD: _____
Formation: _____ BOPD: _____ MCFPD: _____ BWPD: _____
Formation: _____ BOPD: _____ MCFPD: _____ BWPD: _____
Formation: _____ BOPD: _____ MCFPD: _____ BWPD: _____

3. Plat map showing the location of the subject well, all other wells on the subject lease, and all wells on offsetting leases within a 1/2 mile radius of the subject well, and for each well the names and addresses of the lessee of record or operator.

4. Signed certificate showing service of the application and affidavit of publication as required in K.A.R. 82-3-135a.

For Commingling of PRODUCTION ONLY, include the following:

- 5. Wireline log of subject well. Previously Filed with ACO-1: Yes No
- 6. Complete Form ACO-1 (*Well Completion form*) for the subject well.

For Commingling of FLUIDS ONLY, include the following:

- 7. Well construction diagram of subject well.
- 8. Any available water chemistry data demonstrating the compatibility of the fluids to be commingled.

AFFIDAVIT: I am the affiant and hereby certify that to the best of my current information, knowledge and personal belief, this request for commingling is true and proper and I have no information or knowledge, which is inconsistent with the information supplied in this application.

Submitted Electronically

KCC Office Use Only
 Denied Approved
15-Day Periods Ends: _____
Approved By: _____ Date: _____

Protests may be filed by any party having a valid interest in the application. Protests must be in writing and comply with K.A.R. 82-3-135b and must be filed within 15 days of publication of the notice of application.



February 23, 2012

State Corporation Commission
Conservation Division
130 S. Market, Room 2078
Wichita, KS 67202

RE: #1 Jacobs-Wood
Sec. 1-30S-31W
Haskell County, Kansas

To Whom It May Concern:

Enclosed please find an ACO-4 for the above referenced well. The required attachments have also been enclosed. Ritchie Exploration, Inc. would like for this to be held confidential for the maximum allowable time.

If you have any questions, please feel free to call the undersigned or John Niernberger at 316-691-9500. Thank you for all of your help in this matter.

Sincerely,

Karen Hopper
Production Assistant

kjh

Enclosures

R 31 W

R 30 W

T
29
S

T
30
S

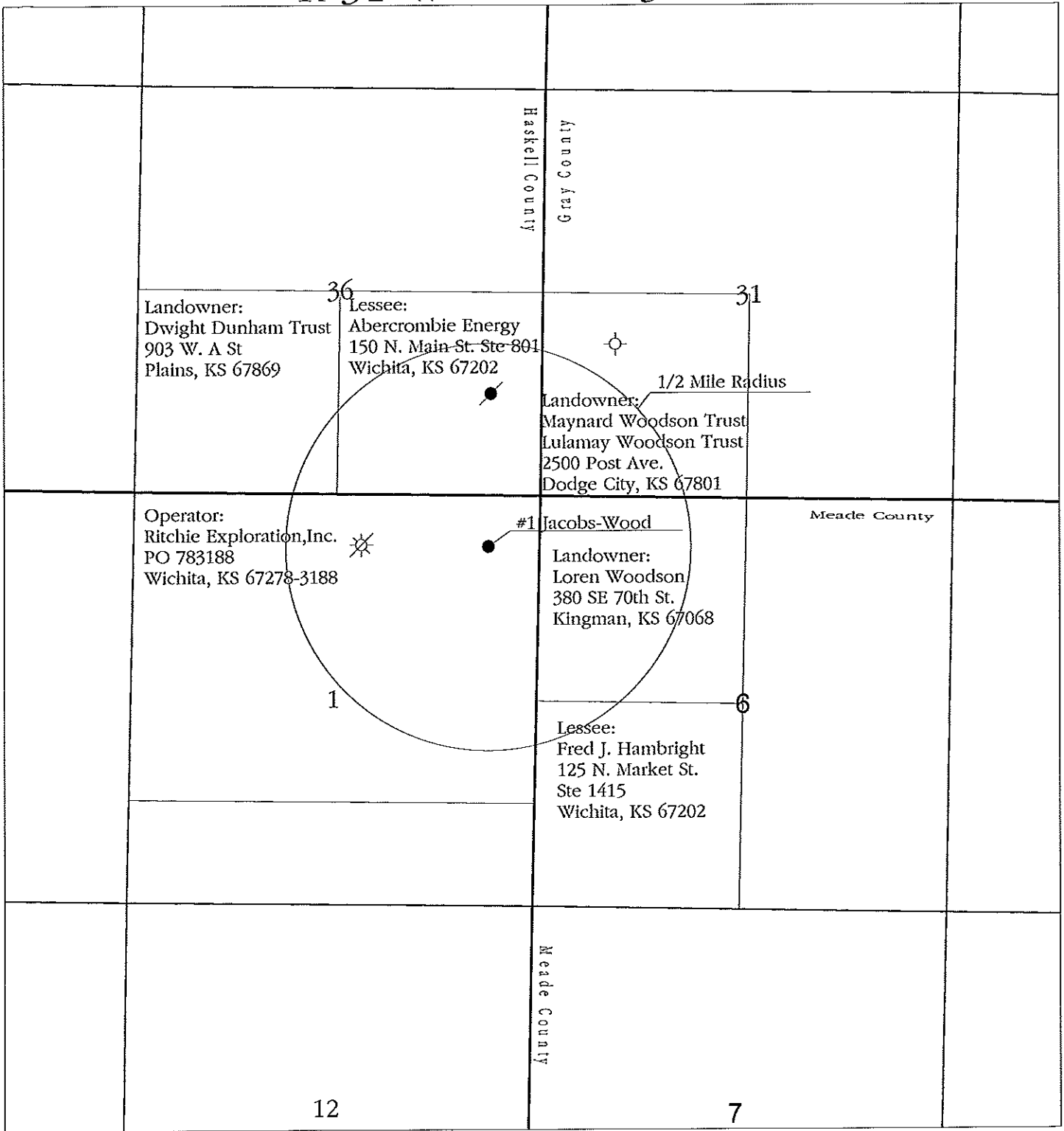

Legend

- Oil Well
- / Abandoned Oil Well
- ⊗ Abandoned Gas Well
- / Dry and Abandoned Well

 RITCHIE EXPLORATION, INC. Wichita, Kansas		Application for Commingling of Production or Fluids
Applicant Well: #1 Jacobs-Wood All Wells on Offsetting Leases Within 1/2 Mile Radius Name and Address of Lessee of Record or Operator		
Haskell / Meade County		
Prepared By: Justin Clegg	Scale: 1 : 22,000	Date: January 19, 2012

APPLICATION FOR COMMINGLING OF PRODUCTION OR FLUIDS

**Operator, Lessee or Unleased Mineral Owner
within a ½ mile radius of Ritchie Exploration, Inc.'s**

**#1 Jacobs-Wood
660' FNL & 660' FEL
Section 1-30S-31W
Haskell Co., KS**

**Haskell County, KS
Township 29 South, Range 31 West**

Sec. 36:	SW/4	Jacqueline & Dwight Dunham Trust Landowner 903 W. A St. Plains, KS 67869	
	SE/4	Abercrombie Engery 150 N. Main St., Ste 801 Wichita, KS 67202	Lessee

Township 30 South, Range 31 West

Sec. 1:	N/2; N/2S/2	Ritchie Exploration, Inc.	Operator: #1 Jacobs-Wood
---------	-------------	---------------------------	--------------------------

**Meade County, KS
Township 30 South, Range 30 West**

Sec. 6:	NW/4	Loren Woodson 380 SE 70 th St. Kingman, KS 67068	Landowner
	SW/4	J. Fred Hambright 125 N. Market St., Ste 1415 Wichita, KS 67202	Lessee

**Gray County, KS
Township 29 South, Range 30 West**

**Sec. 31:	SW/4	Maynard Woodson Trust Lulamay Woodson Trust 2500 Post Ave. Dodge City, KS 67801	Landowner
------------	------	--	-----------

****Register of Deeds was unable to research if there is a current oil and gas lease on acreage, therefore the landowner's names are listed.**

KANSAS CORPORATION COMMISSION
OIL & GAS CONSERVATION DIVISION

Form ACO-1
October 2008
Form Must Be Typed

WELL COMPLETION FORM
WELL HISTORY - DESCRIPTION OF WELL & LEASE

OPERATOR: License # 4767
Name: Ritchie Exploration, Inc.
Address 1: P.O. Box 783188
Address 2: _____
City: Wichita State: KS Zip: 67278 + 3118
Contact Person: John Niernberger
Phone: (316) 691-9500
CONTRACTOR: License # 34127
Name: Tomcat Drilling, LLC
Wellsite Geologist: Terry McLeod
Purchaser: Plains Marketing
Designate Type of Completion:
 New Well Re-Entry Workover
 Oil SWD SIOW
 Gas ENHR SIGW
 CM (Coal Bed Methane) Temp. Abd.
 Dry Other _____
(Core, WSW, Expl., Cathodic, etc.)

If Workover/Re-entry: Old Well Info as follows:
Operator: _____
Well Name: _____
Original Comp. Date: _____ Original Total Depth: _____
 Deepening Re-perf. Conv. to Enhr. Conv. to SWD
 Plug Back: _____ Plug Back Total Depth _____
 Commingled Docket No.: _____
 Dual Completion Docket No.: _____
 Other (SWD or Enhr.?) Docket No.: _____

<u>1/19/2010</u>	<u>2/4/2010</u>	<u>2/5/2010</u>
Spud Date or Recompletion Date	Date Reached TD	Completion Date or Recompletion Date

API No. 15 - 081-21887-0000
Spot Description: _____
NE, NE Sec. 1 Twp. 30 S. R. 31 East West
660 Feet from North / South Line of Section
660 Feet from East / West Line of Section
Footages Calculated from Nearest Outside Section Corner:
 NE NW SE SW
County: Haskell
Lease Name: Jacobs-Wood Well #: 1
Field Name: _____
Producing Formation: Morrow Sand & Mississippian Chester
Elevation: Ground: 2827 Kelly Bushing: 2838
Total Depth: 5700 Plug Back Total Depth: 5464'
Amount of Surface Pipe Set and Cemented at: 1667 Feet
Multiple Stage Cementing Collar Used? Yes No
If yes, show depth set: 3184' Feet
If Alternate II completion, cement circulated from: _____
feet depth to: _____ w/ _____ sx cmf.

Drilling Fluid Management Plan
(Data must be collected from the Reserve Pit)
Chloride content: 23400 ppm Fluid volume: 1200 bbls
Dewatering method used: evaporation
Location of fluid disposal if hauled offsite: _____
Operator Name: _____
Lease Name: _____ License No.: _____
Quarter _____ Sec. _____ Twp. _____ S. R. _____ East West
County: _____ Docket No.: _____

INSTRUCTIONS: An original and two copies of this form shall be filed with the Kansas Corporation Commission, 130 S. Market - Room 2078, Wichita, Kansas 67202, within 120 days of the spud date, recompletion, workover or conversion of a well. Rule 82-3-130, 82-3-106 and 82-3-107 apply. Information of side two of this form will be held confidential for a period of 12 months if requested in writing and submitted with the form (see rule 82-3-107 for confidentiality in excess of 12 months). One copy of all wireline logs and geologist well report shall be attached with this form. ALL CEMENTING TICKETS MUST BE ATTACHED. Submit CP-4 form with all plugged wells. Submit CP-111 form with all temporarily abandoned wells.

All requirements of the statutes, rules and regulations promulgated to regulate the oil and gas industry have been fully complied with and the statements herein are complete and correct to the best of my knowledge.

Signature: _____
Title: Production Manager Date: 4/12/10
Subscribed and sworn to before me this 12th day of April,
20 10.
Notary Public: Debra K. Phillips
Date Commission Expires: 5-4-11

KCC Office Use ONLY
 Letter of Confidentiality Received
If Denied, Yes Date: _____
 Wireline Log Received
 Geologist Report Received
 UIC Distribution

 **DEBRA K. PHILLIPS**
Notary Public - State of Kansas
My Appt. Expires 5-4-11

Operator Name: Ritchie Exploration, Inc. Lease Name: Jacobs-Wood Well #: 1
 Sec. 1 Twp. 30 S. R. 31 East West County: Haskell

INSTRUCTIONS: Show important tops and base of formations penetrated. Detail all cores. Report all final copies of drill stems tests giving interval tested, time tool open and closed, flowing and shut-in pressures, whether shut-in pressure reached static level, hydrostatic pressures, bottom hole temperature, fluid recovery, and flow rates if gas to surface test, along with final chart(s). Attach extra sheet if more space is needed. Attach copy of all Electric Wireline Logs surveyed. Attach final geological well site report.

Drill Stem Tests Taken <input checked="" type="checkbox"/> Yes <input type="checkbox"/> No <i>(Attach Additional Sheets)</i> Samples Sent to Geological Survey <input checked="" type="checkbox"/> Yes <input type="checkbox"/> No Cores Taken <input type="checkbox"/> Yes <input checked="" type="checkbox"/> No Electric Log Run <input checked="" type="checkbox"/> Yes <input type="checkbox"/> No <i>(Submit Copy)</i> List All E. Logs Run: Dual Induction Log Compensated Density/Neutron Log	<input type="checkbox"/> Log Formation (Top), Depth and Datum <input checked="" type="checkbox"/> Sample Name Top Datum SEE ATTACHED
---	--

CASING RECORD <input checked="" type="checkbox"/> New <input type="checkbox"/> Used							
Report all strings set-conductor, surface, intermediate, production, etc.							
Purpose of String	Size Hole Drilled	Size Casing Set (In O.D.)	Weight Lbs. / Ft.	Setting Depth	Type of Cement	# Sacks Used	Type and Percent Additives
Surface	12-1/4	8-5/8	24	1667	common	525	3%cc, 2%gel & 1/4# floccula
Production	7-7/8	4-1/2	10.5	5500	ASC	250	10% sst, 2% gel & 5-1/4 g2sor#o
Port Collar				3184'	A-Con	325	3%cc, 1/4#sx floccula, 2% WLA-1

ADDITIONAL CEMENTING / SQUEEZE RECORD				
Purpose:	Depth Top Bottom	Type of Cement	#Sacks Used	Type and Percent Additives
<input type="checkbox"/> Perforate <input type="checkbox"/> Protect Casing <input type="checkbox"/> Plug Back TD <input type="checkbox"/> Plug Off Zone				

Shots Per Foot	PERFORATION RECORD - Bridge Plugs Set/Type Specify Footage of Each Interval Perforated	Acid, Fracture, Shot, Cement Squeeze Record (Amount and Kind of Material Used)	Depth
4	5252' - 5264' (2/23/10)	1500 GALS 15% NE	
		34,000# 20/40 Sand in 200 BBLs wtr &	
		4,570 SCF Nitrogen	

TUBING RECORD: Size: <u>2-3/8</u> Set At: <u>5325</u> Packer At:		Liner Run: <input type="checkbox"/> Yes <input checked="" type="checkbox"/> No	
Date of First, Resumed Production, SWD or Enhr. <u>3/30/10</u>		Producing Method: <input type="checkbox"/> Flowing <input checked="" type="checkbox"/> Pumping <input type="checkbox"/> Gas Lift <input type="checkbox"/> Other (Explain)	
Estimated Production Per 24 Hours	Oil Bbls. <u>1.67</u>	Gas Mcf	Water Bbls. <u>6.68</u>
			Gas-Oil Ratio <u>31</u>

DISPOSITION OF GAS: <input type="checkbox"/> Vented <input type="checkbox"/> Sold <input type="checkbox"/> Used on Lease <i>(If vented, Submit ACO-18.)</i>	METHOD OF COMPLETION: <input type="checkbox"/> Open Hole <input type="checkbox"/> Perf. <input type="checkbox"/> Dually Comp. <input type="checkbox"/> Commingled <input type="checkbox"/> Other (Specify) _____	PRODUCTION INTERVAL: _____ _____
---	--	--



#1 Jacobs-Wood

660' FNL. & 660' FEL
NE NE Section 1-30S-31W
Haskell County, Kansas
API# 15-081-21887-0000
Tomcat Drilling, LLC Rig #3
Elevation: GL: 2827', KB: 2838'

Sample Tops			Ref. Well
Chase Herrington	2663'	+175	-8
Heebner	4178'	-1340	-7
Lansing	4285'	-1447	-10
Lansing "B"	4330'	-1492	-13
Muncie Shale	4510'	-1672	-18
Stark Shale	4683'	-1845	-16
Lansing "K" Por.	4697'	-1859	-14
BKC	4799'	-1961	-25
Pawnee	4948'	-2110	-23
Cherokee Shale	4991'	-2153	-22
Atoka Shale	5195'	-2357	-25
Morrow Shale	5241'	-2403	-33
Morrow Sand	5247'	-2409	-32
Miss. Chester	5257'	-2419	-32
Miss. Chester Sand	5405'	-2567	-37
Miss. St. Gen	5429'	-2591	-39
Miss. St. Louis	5647'	-2908	-62
RTD	5700'	-2862	

AFFIDAVIT

STATE OF KANSAS)
 - SS.
County of Sedgwick)

John Niernberger, of lawful age, being first duly sworn, deposeth and saith: That he is Production Manager of Ritchie Exploration, County of Sedgwick, State of Kansas, and that notice was given to all lessee of record or operator within ½ mile radius of the Jacobs-Wood #1 well located in the County of Haskell (see attached plat map). This notice included a letter and a copy of the Commingle Application (ACO-4). All notices were mailed on January 27, 2012.

made as aforesaid on the 23rd of

February A.D. 2012

And affiant further says that he has personal knowledge of the statements above set forth and that they are true.

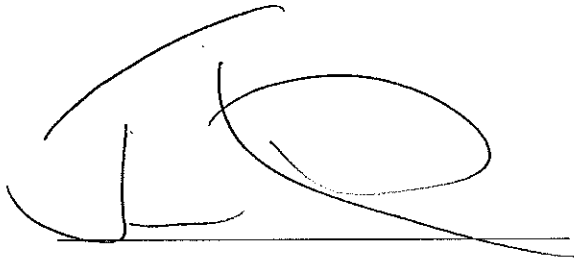

Subscribed and sworn to before me this

23rd day of February 2012

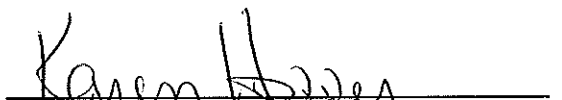

Notary Public Sedgwick County, Kansas

KAREN HOPPER
NOTARY PUBLIC-STATE OF KANSAS
MY APPT. EXPIRES 3-8-15

AFFIDAVIT

STATE OF KANSAS \
- SS.
County of Sedgwick /

Mark Fletchall, of lawful age, being first duly sworn, deposeth and saith: That he is Record Clerk of The Wichita Eagle, a daily newspaper published in the City of Wichita, County of Sedgwick, State of Kansas, and having a general paid circulation on a daily basis in said County, which said newspaper has been continuously and uninterruptedly published in said County for more than one year prior to the first publication of the notice hereinafter mentioned, and which said newspaper has been entered as second class mail matter at the United States Post Office in Wichita, Kansas, and which said newspaper is not a trade, religious or fraternal publication and that a notice of a true copy is hereto attached was published in the regular and entire Morning issue of said The Wichita Eagle for 1 issues, that the first publication of said notice was

made as aforesaid on the 30th of

January A.D. 2012, with

subsequent publications being made on the following dates:

And affiant further says that he has personal knowledge of the statements above set forth and that they are true.

Mark Fletchall

Subscribed and sworn to before me this

30th day of January, 2012

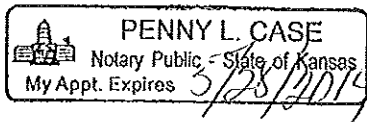

Penny L Case
Notary Public Sedgwick County, Kansas

Printer's Fee : \$91.60

LEGAL PUBLICATION
PUBLISHED IN THE WICHITA EAGLE
JANUARY 30, 2012 (3165858)
LEGAL NOTICE
You, and each of you, are hereby notified that Ritchie Exploration, Inc. has filed an application to commence the commencing of production from the Morrow Sand and Mississippian Chester sources of supply for the #1 Jacobs-Wood well located approx. NE NE of Section 1-305-31W, Haskell County, Kansas.
Any persons who object to or protest this application shall be required to file their objections or protests with the Conservation Division of the State Corporation Commission of the State of Kansas within fifteen (15) days from the date of the publication. These protests shall be filed pursuant to Commission regulations and must state specific reasons why the grant of the application may cause waste, violate correlative rights or pollute the natural resources of the state of Kansas.
If no protests are received, this application may be granted through a summary proceeding. If valid protests are received, this matter will be set for hearing.
All persons interested or concerned shall take notice of the foregoing and shall govern themselves accordingly.
RITCHIE EXPLORATION, INC.
P.O. Box 783188
Wichita, KS 67278-3188
(316) 691-9800

Proof of Publication

STATE OF KANSAS
COUNTY OF HASKELL SS.

Rolf Jungclas

being first duly sworn, deposes and says that he/she is editor of THE HASKELL COUNTY MONITOR-CHIEF, a weekly newspaper printed in the State of Kansas and published in and of general circulation in Haskell County, Kansas, with a general paid circulation on a weekly basis in Haskell County, Kansas and that said newspaper is not a trade, religious or fraternal publication.

Said newspaper is a weekly, published at least weekly 50 times a year; has been so published continuously and uninterruptedly in said county and state for a period of more than five years prior to the first publication of said notice; and has been admitted at the post office of Sublette in said county as second class matter.

That the attached notice is a true copy thereof, and was published in the regular and entire issue of said newspaper for 1 consecutive week(s). The first publication thereof being made as aforesaid on the

1 day of Feb, 20 12.
with subsequent publications being made on the following dates:

- _____ , 20 _____
- _____ , 20 _____
- _____ , 20 _____
- _____ , 20 _____
- _____ , 20 _____

(Sign) Rolf Jungclas
Witness my hand this 1 day of Feb, 20 12

Kelly C Anderson
(Notary Public)

My commission expires 2-7-2014
 Publication fee \$ 37.80
 Affidavit, \$ _____
 Notary's Fee \$ _____
 Additional Copies \$ _____
 Total Fee \$ 37.80

(Seal) **KELLY C. ANDERSON**
Notary Public - State of Kansas
My Comm. Expires February 7, 2014

(Published in the Haskell County Monitor on Wednesday, February 1, 2012.)

LEGAL NOTICE

You, and each of you, are hereby notified that Ritchie Exploration, Inc. has filed an application to commence the commingling of production from the Morrow Sand and Mississippian Chester sources of supply for the #1 Jacobs-Wood well located approx. NE NE of Section 1, 30S-31W, Haskell County, Kansas.

Any persons who object to or protest this application shall be required to file their objections or protests with the Conservation Division of the State Corporation Commission of the State of Kansas within fifteen (15) days from the

date of the publication. These protests shall be filed pursuant to Commission regulations and must state specific reasons why the grant of the application may cause waste, violate correlative rights or pollute the natural resources of the state of Kansas.

If no protests are received this application may be granted through a summary proceeding. If valid protests are received, this matter will be set for hearing.

All persons interested or concerned shall take notice of the foregoing and shall govern themselves accordingly.

RITCHIE EXPLORATION, INC.
P.O. Box 783188
Wichita, KS 67278-3188
(316) 691-9500

March 9, 2012

John Niernberger
Ritchie Exploration, Inc.
P.O. Box 783188
Wichita, KS 67278-3188

RE: Approved Commingling CO021205
Jacobs-Wood #1 Sec.1-T30S-R31W, Haskell County
API No. 15-081-21887-00-00

Dear Mr. Niernberger:

Your Application for Commingling (ACO-4) for the above described well has been reviewed and approved by the Kansas Corporation Commission (KCC) per K.A.R. 82-3-123. Notice was examined and found to be proper per K.A.R. 82-3-135a. No protest had been filed within the 15-day protest period. This application, which was received by the KCC on February 23, 2012, concerns approval to simultaneously produce from the following sources of supply through the same tubing string in the same wellbore:

Source of Supply	Estimated Current Production			Perf Depth
	BOPD	MCFPD	BWPD	
Morrow Sand	1.43	0	0.70	5252-5261
Mississippian Chester	0.61	0	2.82	5261-5264
Total Estimated Current Production	2.04	0.0	3.52	

Based upon the depth of the Mississippian Chester formation perforations, total oil production shall not exceed 200 BOPD and total gas production shall not exceed 50% of the absolute open flow (AOF).

Commingling ID number CO021205 has been assigned to this approved application. Use this number for well completion reports (ACO-1) and other correspondence that may concern this approved commingling.

Sincerely,

Rick Hestermann
Production Department