



Confidentiality Requested:

Yes No

KANSAS CORPORATION COMMISSION 1073399
OIL & GAS CONSERVATION DIVISION

Form ACO-1

August 2013

Form must be Typed
Form must be Signed
All blanks must be Filled

WELL COMPLETION FORM
WELL HISTORY - DESCRIPTION OF WELL & LEASE

OPERATOR: License # _____

Name: _____

Address 1: _____

Address 2: _____

City: _____ State: _____ Zip: _____ + _____

Contact Person: _____

Phone: (_____) _____

CONTRACTOR: License # _____

Name: _____

Wellsite Geologist: _____

Purchaser: _____

Designate Type of Completion:

- New Well Re-Entry Workover
- Oil WSW SWD SIOW
- Gas D&A ENHR SIGW
- OG GSW Temp. Abd.
- CM (Coal Bed Methane)
- Cathodic Other (Core, Expl., etc.): _____

If Workover/Re-entry: Old Well Info as follows:

Operator: _____

Well Name: _____

Original Comp. Date: _____ Original Total Depth: _____

- Deepening Re-perf. Conv. to ENHR Conv. to SWD
- Plug Back Conv. to GSW Conv. to Producer
- Commingled Permit #: _____
- Dual Completion Permit #: _____
- SWD Permit #: _____
- ENHR Permit #: _____
- GSW Permit #: _____

Spud Date or Recompletion Date	Date Reached TD	Completion Date or Recompletion Date
-----------------------------------	-----------------	---

API No. 15 - _____

Spot Description: _____

_____ - _____ - _____ Sec. _____ Twp. _____ S. R. _____ East West

_____ Feet from North / South Line of Section

_____ Feet from East / West Line of Section

Footages Calculated from Nearest Outside Section Corner:

- NE NW SE SW

GPS Location: Lat: _____, Long: _____
(e.g. xx.xxxxx) (e.g. -xxx.xxxxx)

Datum: NAD27 NAD83 WGS84

County: _____

Lease Name: _____ Well #: _____

Field Name: _____

Producing Formation: _____

Elevation: Ground: _____ Kelly Bushing: _____

Total Vertical Depth: _____ Plug Back Total Depth: _____

Amount of Surface Pipe Set and Cemented at: _____ Feet

Multiple Stage Cementing Collar Used? Yes No

If yes, show depth set: _____ Feet

If Alternate II completion, cement circulated from: _____

feet depth to: _____ w/ _____ sx cmt.

Drilling Fluid Management Plan

(Data must be collected from the Reserve Pit)

Chloride content: _____ ppm Fluid volume: _____ bbls

Dewatering method used: _____

Location of fluid disposal if hauled offsite:

Operator Name: _____

Lease Name: _____ License #: _____

Quarter _____ Sec. _____ Twp. _____ S. R. _____ East West

County: _____ Permit #: _____

AFFIDAVIT

I am the affiant and I hereby certify that all requirements of the statutes, rules and regulations promulgated to regulate the oil and gas industry have been fully complied with and the statements herein are complete and correct to the best of my knowledge.

Submitted Electronically

KCC Office Use ONLY

- Confidentiality Requested
Date: _____
- Confidential Release Date: _____
- Wireline Log Received
- Geologist Report Received
- UIC Distribution
- ALT I II III Approved by: _____ Date: _____

1073399

Operator Name: _____ Lease Name: _____ Well #: _____

Sec. _____ Twp. _____ S. R. _____ East West County: _____

INSTRUCTIONS: Show important tops of formations penetrated. Detail all cores. Report all final copies of drill stems tests giving interval tested, time tool open and closed, flowing and shut-in pressures, whether shut-in pressure reached static level, hydrostatic pressures, bottom hole temperature, fluid recovery, and flow rates if gas to surface test, along with final chart(s). Attach extra sheet if more space is needed.

Final Radioactivity Log, Final Logs run to obtain Geophysical Data and Final Electric Logs must be emailed to kcc-well-logs@kcc.ks.gov. Digital electronic log files must be submitted in LAS version 2.0 or newer AND an image file (TIFF or PDF).

Drill Stem Tests Taken <i>(Attach Additional Sheets)</i>	<input type="checkbox"/> Yes <input type="checkbox"/> No	<input type="checkbox"/> Log	Formation (Top), Depth and Datum	<input type="checkbox"/> Sample
Samples Sent to Geological Survey	<input type="checkbox"/> Yes <input type="checkbox"/> No	Name	Top	Datum
Cores Taken	<input type="checkbox"/> Yes <input type="checkbox"/> No			
Electric Log Run	<input type="checkbox"/> Yes <input type="checkbox"/> No			
List All E. Logs Run:				

CASING RECORD <input type="checkbox"/> New <input type="checkbox"/> Used							
Report all strings set-conductor, surface, intermediate, production, etc.							
Purpose of String	Size Hole Drilled	Size Casing Set (In O.D.)	Weight Lbs. / Ft.	Setting Depth	Type of Cement	# Sacks Used	Type and Percent Additives

ADDITIONAL CEMENTING / SQUEEZE RECORD				
Purpose:	Depth Top Bottom	Type of Cement	# Sacks Used	Type and Percent Additives
<input type="checkbox"/> Perforate				
<input type="checkbox"/> Protect Casing				
<input type="checkbox"/> Plug Back TD				
<input type="checkbox"/> Plug Off Zone				

Did you perform a hydraulic fracturing treatment on this well? Yes No *(If No, skip questions 2 and 3)*

Does the volume of the total base fluid of the hydraulic fracturing treatment exceed 350,000 gallons? Yes No *(If No, skip question 3)*

Was the hydraulic fracturing treatment information submitted to the chemical disclosure registry? Yes No *(If No, fill out Page Three of the ACO-1)*

Shots Per Foot	PERFORATION RECORD - Bridge Plugs Set/Type Specify Footage of Each Interval Perforated	Acid, Fracture, Shot, Cement Squeeze Record <i>(Amount and Kind of Material Used)</i>	Depth

TUBING RECORD: Size: _____ Set At: _____ Packer At: _____ Liner Run: Yes No

Date of First, Resumed Production, SWD or ENHR: _____ Producing Method:
 Flowing Pumping Gas Lift Other *(Explain)* _____

Estimated Production Per 24 Hours	Oil Bbls.	Gas Mcf	Water Bbls.	Gas-Oil Ratio	Gravity

DISPOSITION OF GAS: <input type="checkbox"/> Vented <input type="checkbox"/> Sold <input type="checkbox"/> Used on Lease <i>(If vented, Submit ACO-18.)</i>	METHOD OF COMPLETION: <input type="checkbox"/> Open Hole <input type="checkbox"/> Perf. <input type="checkbox"/> Dually Comp. <input type="checkbox"/> Commingled <i>(Submit ACO-5)</i> <i>(Submit ACO-4)</i> <input type="checkbox"/> Other <i>(Specify)</i> _____	PRODUCTION INTERVAL: _____ _____
--	---	---



DRILL STEM TEST REPORT

Prepared For: **Bach Oil Production**

PO Box 723
Alma, NE 68920

ATTN: Bob Peterson

Lloyd #1

29-4s-20w Phillips,KS

Start Date: 2012.01.10 @ 22:00:00

End Date: 2012.01.11 @ 04:59:30

Job Ticket #: 45553 DST #: 1

Trilobite Testing, Inc
PO Box 362 Hays, KS 67601
ph: 785-625-4778 fax: 785-625-5620

Printed: 2012.01.18 @ 11:26:50

Bach Oil Production
29-4s-20w Phillips,KS
Lloyd #1
DST # 1
LKC "C"
2012.01.10



**TRILOBITE
TESTING, INC.**

DRILL STEM TEST REPORT

Bach Oil Production

29-4s-20w Phillips,KS

PO Box 723
Alma, NE 68920

Lloyd #1

Job Ticket: 45553

DST#: 1

ATTN: Bob Peterson

Test Start: 2012.01.10 @ 22:00:00

GENERAL INFORMATION:

Formation: **LKC "C"**

Deviated: No Whipstock: ft (KB)

Time Tool Opened: 23:53:00

Time Test Ended: 04:59:30

Test Type: Conventional Bottom Hole (Initial)

Tester: James Winder

Unit No: 57

Interval: 3235.00 ft (KB) To 3260.00 ft (KB) (TVD)

Reference Elevations: 2002.00 ft (KB)

Total Depth: 3260.00 ft (KB) (TVD)

1997.00 ft (CF)

Hole Diameter: 7.88 inches Hole Condition: Fair

KB to GR/CF: 5.00 ft

Serial #: 6719

Inside

Press @ Run Depth: 35.25 psig @ 3236.00 ft (KB)

Capacity: 8000.00 psig

Start Date: 2012.01.10

End Date:

2012.01.11

Last Calib.:

2012.01.11

Start Time: 22:00:05

End Time:

04:59:29

Time On Btm:

2012.01.10 @ 23:49:30

Time Off Btm:

2012.01.11 @ 03:13:00

TEST COMMENT: 45 - IF: Blow built to 2 1/2"
45 - IS: Bled off, No blow back
45 - FF: Blow built to 1 1/4"
60 - FS: Bled off, No blow back

PRESSURE SUMMARY

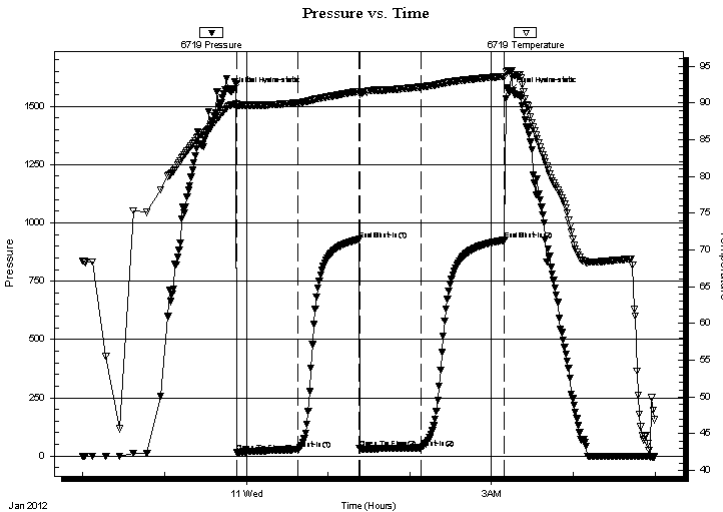

Time (Min.)	Pressure (psig)	Temp (deg F)	Annotation
0	1563.83	89.77	Initial Hydro-static
4	16.21	89.72	Open To Flow (1)
49	28.70	90.04	Shut-In(1)
93	928.72	91.59	End Shut-In(1)
94	34.30	91.30	Open To Flow (2)
139	35.25	92.19	Shut-In(2)
200	925.70	93.63	End Shut-In(2)
204	1561.35	94.42	Final Hydro-static

Recovery

Length (ft)	Description	Volume (bbl)
35.00	SOCM 98% m, 2% o	0.22
5.00	WMCO 66% o, 21% m, 11% w, 2% g	0.07
0.00	GIP = 20'	0.00

Gas Rates

	Choke (inches)	Pressure (psig)	Gas Rate (Mcf/d)



**TRILOBITE
TESTING, INC.**

DRILL STEM TEST REPORT

TOOL DIAGRAM

Bach Oil Production

29-4s-20w Phillips,KS

PO Box 723
Alma, NE 68920

Lloyd #1

Job Ticket: 45553

DST#: 1

ATTN: Bob Peterson

Test Start: 2012.01.10 @ 22:00:00

Tool Information

Drill Pipe:	Length: 3202.00 ft	Diameter: 3.80 inches	Volume: 44.92 bbl	Tool Weight: 2500.00 lb
Heavy Wt. Pipe:	Length: 0.00 ft	Diameter: 0.00 inches	Volume: 0.00 bbl	Weight set on Packer: 25000.00 lb
Drill Collar:	Length: 30.00 ft	Diameter: 2.25 inches	Volume: 0.15 bbl	Weight to Pull Loose: 55000.00 lb
			<u>Total Volume: 45.07 bbl</u>	Tool Chased 0.00 ft
Drill Pipe Above KB:	25.00 ft			String Weight: Initial 46000.00 lb
Depth to Top Packer:	3235.00 ft			Final 46000.00 lb
Depth to Bottom Packer:	ft			
Interval between Packers:	25.00 ft			
Tool Length:	53.00 ft			
Number of Packers:	2	Diameter: 6.75 inches		

Tool Comments:

Tool Description

Tool Description	Length (ft)	Serial No.	Position	Depth (ft)	Accum. Lengths
Shut In Tool	5.00			3212.00	
Hydraulic tool	5.00			3217.00	
Jars	5.00			3222.00	
Safety Joint	3.00			3225.00	
Packer	5.00			3230.00	28.00 Bottom Of Top Packer
Packer	5.00			3235.00	
Stubb	1.00			3236.00	
Recorder	0.00	6719	Inside	3236.00	
Recorder	0.00	8320	Outside	3236.00	
Perforations	21.00			3257.00	
Bullnose	3.00			3260.00	25.00 Bottom Packers & Anchor

Total Tool Length: 53.00



**TRILOBITE
TESTING, INC.**

DRILL STEM TEST REPORT

FLUID SUMMARY

Bach Oil Production

29-4s-20w Phillips,KS

PO Box 723
Alma, NE 68920

Lloyd #1

Job Ticket: 45553

DST#: 1

ATTN: Bob Peterson

Test Start: 2012.01.10 @ 22:00:00

Mud and Cushion Information

Mud Type: Gel Chem

Cushion Type:

Oil API:

deg API

Mud Weight: 9.00 lb/gal

Cushion Length:

ft

Water Salinity:

ppm

Viscosity: 53.00 sec/qt

Cushion Volume:

bbbl

Water Loss: 7.59 in³

Gas Cushion Type:

Resistivity: ohm.m

Gas Cushion Pressure:

psig

Salinity: 800.00 ppm

Filter Cake: 1.00 inches

Recovery Information

Recovery Table

Length ft	Description	Volume bbl
35.00	SOCM 98% _m , 2% _o	0.218
5.00	WMCO 66% _o , 21% _m , 11% _w , 2% _g	0.070
0.00	GIP = 20'	0.000

Total Length: 40.00 ft Total Volume: 0.288 bbl

Num Fluid Samples: 0

Num Gas Bombs: 0

Serial #:

Laboratory Name:

Laboratory Location:

Recovery Comments:

Serial #: 6719

Inside

Bach Oil Production

Lloyd #1

DST Test Number: 1

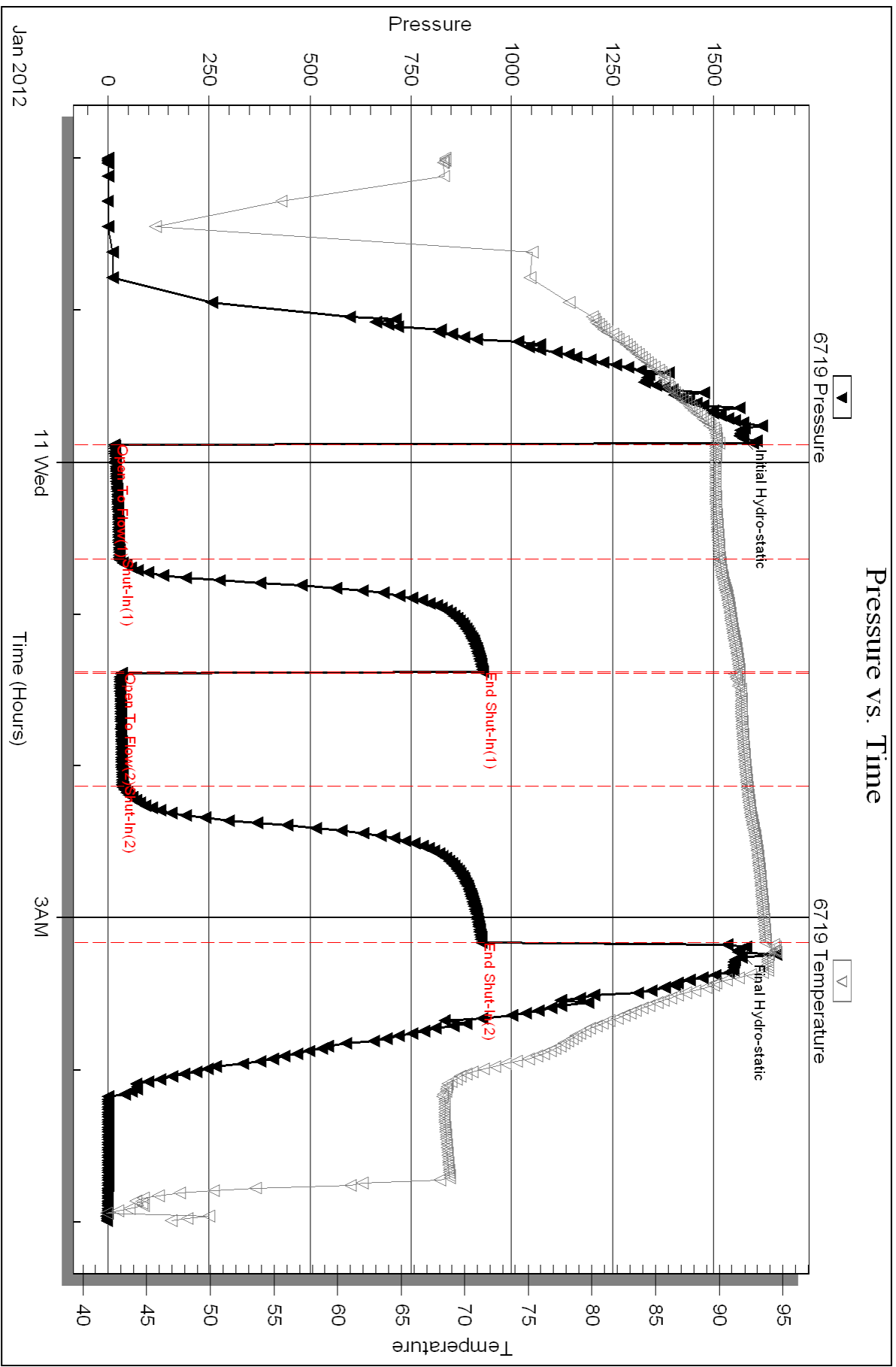

Serial #: 8320

Outside

Bach Oil Production

Lloyd #1

DST Test Number: 1

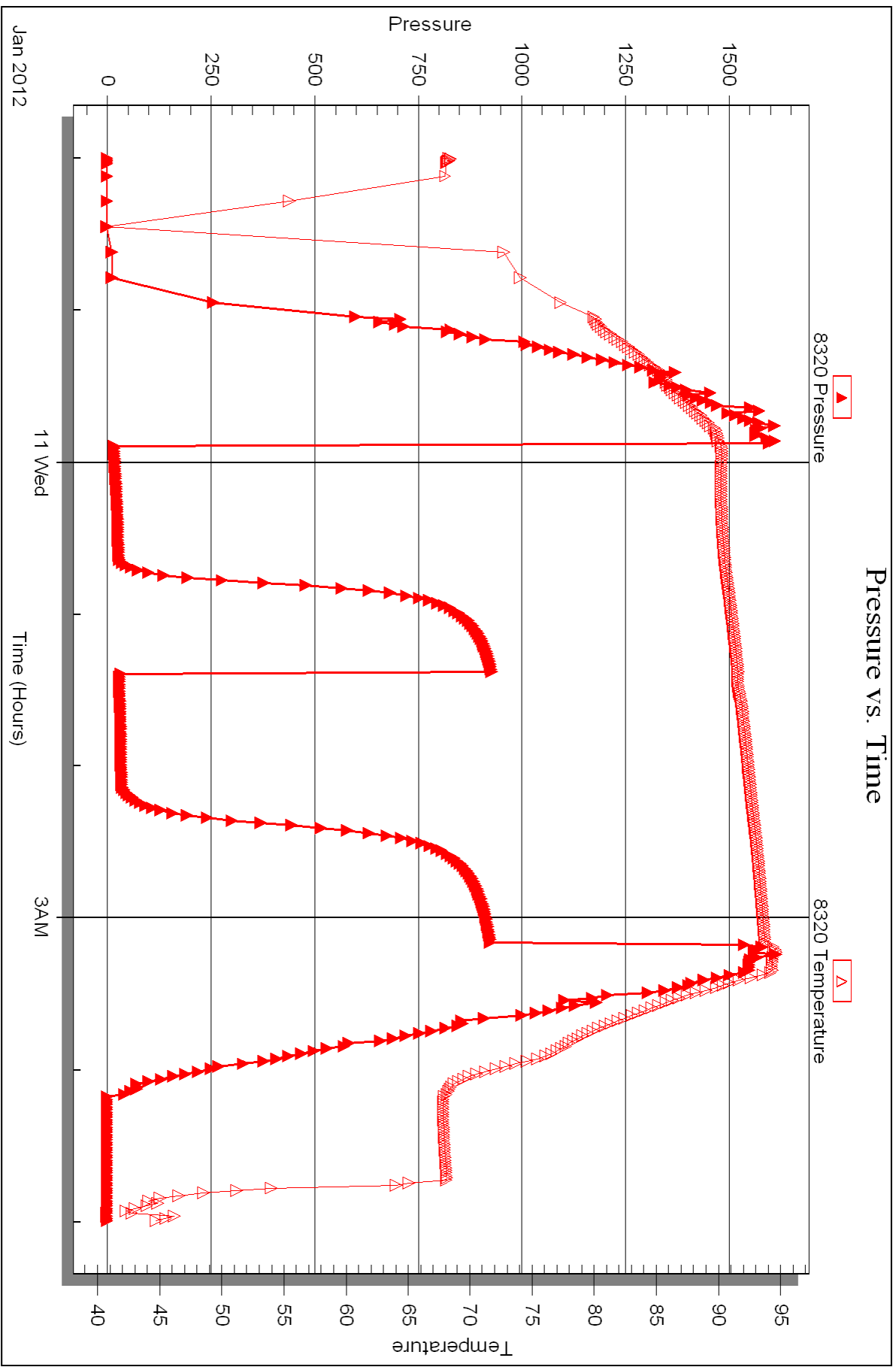



DRILL STEM TEST REPORT

Prepared For: **Bach Oil Production**

PO Box 723
Alma, NE 68920

ATTN: Bob Peterson

Lloyd #1

29-4s-20w Phillips,KS

Start Date: 2012.01.11 @ 12:10:00

End Date: 2012.01.11 @ 18:43:00

Job Ticket #: 45554 DST #: 2

Trilobite Testing, Inc
PO Box 362 Hays, KS 67601
ph: 785-625-4778 fax: 785-625-5620

Printed: 2012.01.18 @ 11:25:17

Bach Oil Production
29-4s-20w Phillips,KS
Lloyd #1
DST # 2
LKC "F"
2012.01.11



**TRILOBITE
TESTING, INC.**

DRILL STEM TEST REPORT

Bach Oil Production

29-4s-20w Phillips,KS

PO Box 723
Alma, NE 68920

Lloyd #1

Job Ticket: 45554

DST#: 2

ATTN: Bob Peterson

Test Start: 2012.01.11 @ 12:10:00

GENERAL INFORMATION:

Formation: **LKC "F"**

Deviated: No Whipstock: ft (KB)

Time Tool Opened: 14:08:30

Time Test Ended: 18:43:00

Test Type: Conventional Bottom Hole (Reset)

Tester: James Winder

Unit No: 57

Interval: 3273.00 ft (KB) To 3300.00 ft (KB) (TVD)

Reference Elevations: 2002.00 ft (KB)

Total Depth: 3300.00 ft (KB) (TVD)

1997.00 ft (CF)

Hole Diameter: 7.88 inches Hole Condition: Fair

KB to GR/CF: 5.00 ft

Serial #: 6719

Inside

Press @ Run Depth: 45.37 psig @ 3274.00 ft (KB)

Capacity: 8000.00 psig

Start Date: 2012.01.11

End Date:

2012.01.11

Last Calib.:

2012.01.11

Start Time: 12:10:05

End Time:

18:42:59

Time On Btm:

2012.01.11 @ 14:06:00

Time Off Btm:

2012.01.11 @ 17:13:00

TEST COMMENT: 60 - IF: Blow built to 1 1/4" in 18 min., then on/off surging blow built to 2 1/4" by 60 min.

30 - IS: Bled off, No blow back

45 - FF: Blow started at 7 min., on/off surging blow built to 1 1/4"

45 - FS: Bled off, No blow back

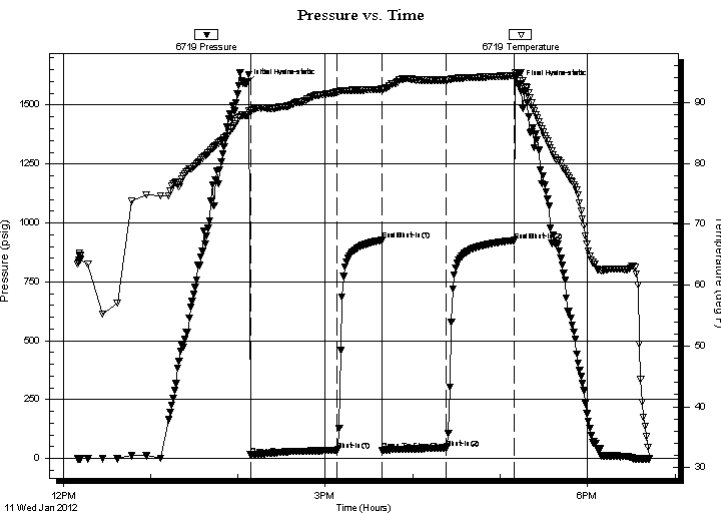

PRESSURE SUMMARY

Time (Min.)	Pressure (psig)	Temp (deg F)	Annotation
0	1591.05	87.92	Initial Hydro-static
3	16.26	88.65	Open To Flow (1)
62	35.39	91.71	Shut-In(1)
93	926.34	92.17	End Shut-In(1)
93	36.41	92.05	Open To Flow (2)
137	45.37	93.66	Shut-In(2)
184	926.03	94.41	End Shut-In(2)
187	1588.68	94.93	Final Hydro-static

Recovery

Length (ft)	Description	Volume (bbl)
60.00	WCM w/trace oil 80%w, 20%w	0.57
1.00	WM w/trace oil 50%w, 50%w	0.01

* Recovery from multiple tests

Gas Rates

	Choke (inches)	Pressure (psig)	Gas Rate (Mcf/d)

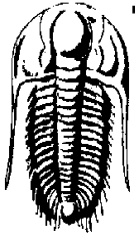

TRILOBITE TESTING, INC.

DRILL STEM TEST REPORT

Bach Oil Production

29-4s-20w Phillips,KS

PO Box 723
Alma, NE 68920

Lloyd #1

Job Ticket: 45554

DST#: 2

ATTN: Bob Peterson

Test Start: 2012.01.11 @ 12:10:00

GENERAL INFORMATION:

Formation: LKC "F"		Test Type: Conventional Bottom Hole (Reset)
Deviated: No Whipstock:	ft (KB)	Tester: James Winder
Time Tool Opened: 14:08:30		Unit No: 57
Time Test Ended: 18:43:00		
Interval: 3273.00 ft (KB) To 3300.00 ft (KB) (TVD)		Reference Elevations: 2002.00 ft (KB)
Total Depth: 3300.00 ft (KB) (TVD)		1997.00 ft (CF)
Hole Diameter: 7.88 inches	Hole Condition: Fair	KB to GR/CF: 5.00 ft

Serial #: 8320 **Outside**

Press @RunDepth:	psig @ 3274.00 ft (KB)	Capacity:	8000.00 psig
Start Date:	2012.01.11	End Date:	2012.01.11
Start Time:	12:10:05	End Time:	18:42:29
		Last Calib.:	2012.01.11
		Time On Btm:	
		Time Off Btm:	

TEST COMMENT: 60 - IF: Blow built to 1 1/4" in 18 min., then on/off surging blow built to 2 1/4" by 60 min.
 30 - IS: Bled off, No blow back
 45 - FF: Blow started at 7 min., on/off surging blow built to 1 1/4"
 45 - FS: Bled off, No blow back

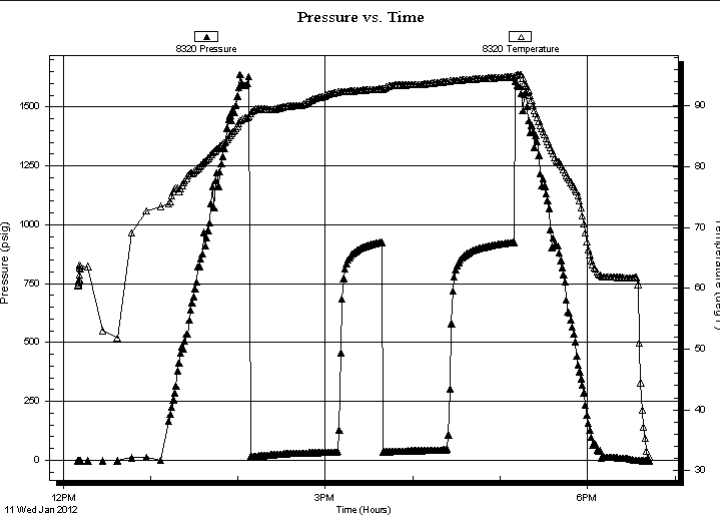

PRESSURE SUMMARY

Time (Min.)	Pressure (psig)	Temp (deg F)	Annotation

Recovery

Length (ft)	Description	Volume (bbl)
60.00	WCM w/trace oil 80%w, 20%w	0.57
1.00	WM w/trace oil 50%w, 50%w	0.01

* Recovery from multiple tests

Gas Rates

Choke (inches)	Pressure (psig)	Gas Rate (Mcf/d)



**TRILOBITE
TESTING, INC.**

DRILL STEM TEST REPORT

TOOL DIAGRAM

Bach Oil Production

29-4s-20w Phillips,KS

PO Box 723
Alma, NE 68920

Lloyd #1

Job Ticket: 45554

DST#: 2

ATTN: Bob Peterson

Test Start: 2012.01.11 @ 12:10:00

Tool Information

Drill Pipe:	Length: 3233.00 ft	Diameter: 3.80 inches	Volume: 45.35 bbl	Tool Weight: 2500.00 lb
Heavy Wt. Pipe:	Length: 0.00 ft	Diameter: 0.00 inches	Volume: 0.00 bbl	Weight set on Packer: 25000.00 lb
Drill Collar:	Length: 30.00 ft	Diameter: 2.25 inches	Volume: 0.15 bbl	Weight to Pull Loose: 54000.00 lb
			<u>Total Volume: 45.50 bbl</u>	Tool Chased 0.00 ft
Drill Pipe Above KB:	18.00 ft			String Weight: Initial 46000.00 lb
Depth to Top Packer:	3273.00 ft			Final 46000.00 lb
Depth to Bottom Packer:	ft			
Interval between Packers:	27.00 ft			
Tool Length:	55.00 ft			
Number of Packers:	2	Diameter: 6.75 inches		

Tool Comments:

Tool Description

Tool Description	Length (ft)	Serial No.	Position	Depth (ft)	Accum. Lengths
Shut In Tool	5.00			3250.00	
Hydraulic tool	5.00			3255.00	
Jars	5.00			3260.00	
Safety Joint	3.00			3263.00	
Packer	5.00			3268.00	28.00 Bottom Of Top Packer
Packer	5.00			3273.00	
Stubb	1.00			3274.00	
Recorder	0.00	6719	Inside	3274.00	
Recorder	0.00	8320	Outside	3274.00	
Perforations	23.00			3297.00	
Bullnose	3.00			3300.00	27.00 Bottom Packers & Anchor

Total Tool Length: 55.00



**TRILOBITE
TESTING, INC.**

DRILL STEM TEST REPORT

FLUID SUMMARY

Bach Oil Production

29-4s-20w Phillips,KS

PO Box 723
Alma, NE 68920

Lloyd #1

Job Ticket: 45554

DST#: 2

ATTN: Bob Peterson

Test Start: 2012.01.11 @ 12:10:00

Mud and Cushion Information

Mud Type: Gel Chem

Cushion Type:

Oil API:

deg API

Mud Weight: 9.00 lb/gal

Cushion Length:

ft

Water Salinity:

17000 ppm

Viscosity: 62.00 sec/qt

Cushion Volume:

bbbl

Water Loss: 7.98 in³

Gas Cushion Type:

Resistivity: ohm.m

Gas Cushion Pressure:

psig

Salinity: 1000.00 ppm

Filter Cake: 1.00 inches

Recovery Information

Recovery Table

Length ft	Description	Volume bbbl
60.00	WCM w/trace oil 80% _m , 20% _w	0.568
1.00	WM w/trace oil 50% _w , 50% _m	0.014

Total Length: 61.00 ft Total Volume: 0.582 bbl

Num Fluid Samples: 0

Num Gas Bombs: 0

Serial #:

Laboratory Name:

Laboratory Location:

Recovery Comments: RW= .491 @ 54.4 deg F

Serial #: 6719

Inside

Bach Oil Production

Lloyd #1

DST Test Number: 2

Pressure vs. Time

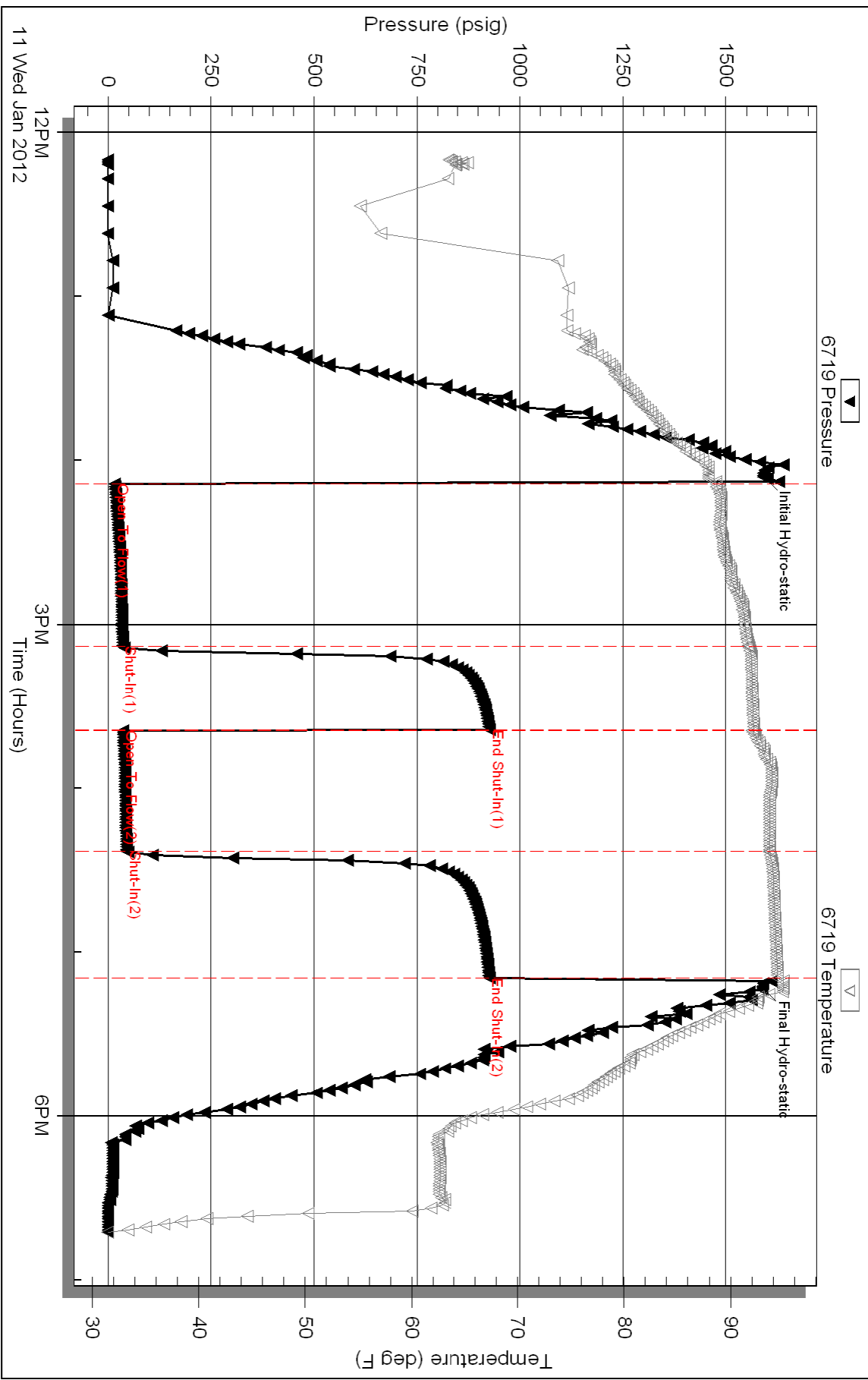

Triobite Testing, Inc

Ref. No: 45554

Printed: 2012.01.18 @ 11:25:18

Serial #: 8320

Outside Bach Oil Production

Lloyd #1

DST Test Number: 2

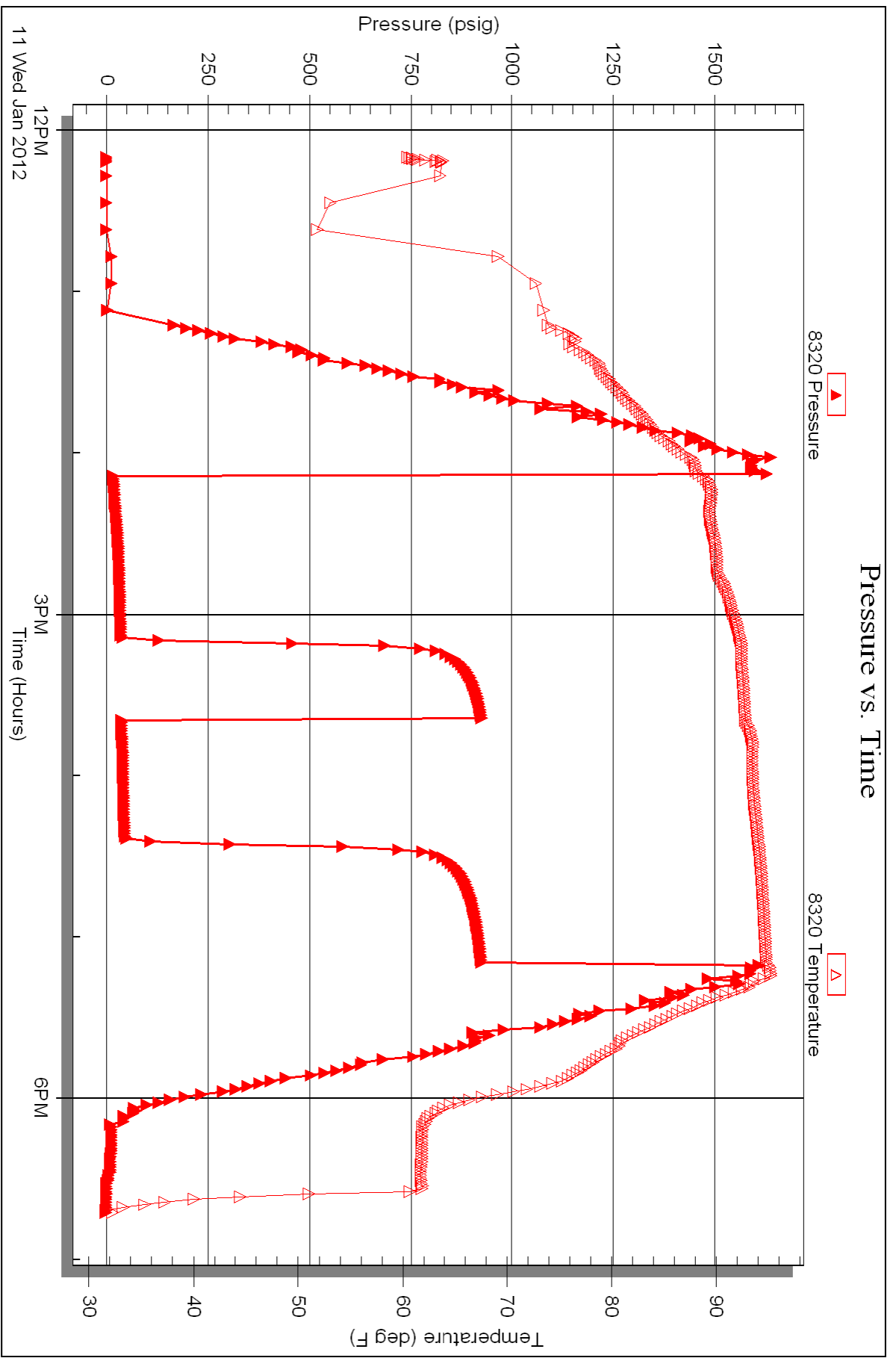

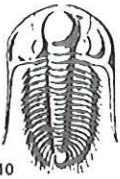

TRILOBITE TESTING INC.

P.O. Box 1733 • Hays, Kansas 67601

RECEIVED
JAN 12 2012

Test Ticket

NO. 45553

BY: _____

Well Name & No. Bach Oil Production Lloyd #1 Test No. 1 Date 1-10-12

Company Bach Oil Production Elevation 2002 KB 1997 GL _____

Address PO Box 723 Alma NE 68920

Co. Rep / Geo. Bob Peterson Rig Murfin #16

Location: Sec. 29 Twp. 4s Rge. 20w Co. Phillips State KS

Interval Tested 3235-3260 Zone Tested LKC "C"

Anchor Length 25 Drill Pipe Run 3202 Mud Wt. 8.7

Top Packer Depth 3220 Drill Collars Run 30 Vis 53

Bottom Packer Depth 3225 Wt. Pipe Run - WL 7.6

Total Depth 3260 Chlorides 800 ppm System LCM 3

Blow Description IF: Blow built to 2 1/2"

ISI: Bled off, No blowback

FF: Blow built to 1 1/4"

FSI: Bled off, No blowback

Rec	Feet of	%gas	%oil	%water	%mud
<u>5</u>	<u>WMCO</u>	<u>2</u>	<u>66</u>	<u>11</u>	<u>21</u>
<u>35</u>	<u>SOCM</u>	<u>-</u>	<u>2</u>	<u>-</u>	<u>98</u>
	<u>GIP = 20'</u>				

Rec Total 40 BHT 94 Gravity - API RW - @ - °F Chlorides - ppm

(A) Initial Hydrostatic <u>1564</u>	<input type="checkbox"/> Test <u>1125'</u>	T-On Location <u>19:30</u>
(B) First Initial Flow <u>16</u>	<input checked="" type="checkbox"/> Jars <u>250'</u>	T-Started <u>22:00</u>
(C) First Final Flow <u>29</u>	<input checked="" type="checkbox"/> Safety Joint <u>75'</u>	T-Open <u>23:53</u>
(D) Initial Shut-In <u>929</u>	<input checked="" type="checkbox"/> Circ Sub <u>NA</u>	T-Pulled <u>3:09</u>
(E) Second Initial Flow <u>34</u>	<input type="checkbox"/> Hourly Standby <u>1/2 hr 50'</u>	T-Out <u>4:55</u>
(F) Second Final Flow <u>35</u>	<input type="checkbox"/> Mileage <u>130 RT 182'</u>	Comments _____
(G) Final Shut-In <u>926</u>	<input checked="" type="checkbox"/> Sampler _____	
(H) Final Hydrostatic <u>1561</u>	<input checked="" type="checkbox"/> Straddle _____	<input checked="" type="checkbox"/> Ruined Shale Packer _____

Initial Open 45 Extra Packer _____ Extra Copies _____

Initial Shut-In 45 Extra Recorder _____ Sub Total 0

Final Flow 45 Day Standby _____ Total 11082'

Final Shut-In 60 Accessibility _____ MP/DST Disc't _____

Sub Total 11082'

Approved By _____ Our Representative James Winder

Trilobite Testing Inc. shall not be liable for damaged or any kind of the property or personnel of the one for whom a test is made, or for any loss suffered or sustained, directly or indirectly, through the use of its equipment, or its statements or opinion concerning the results of any test, tools lost or damaged in the hole shall be paid for at cost by the party for whom the test is made.



TRILOBITE TESTING INC.

P.O. Box 1733 • Hays, Kansas 67601

RECEIVED
JAN 12 2012

Test Ticket

NO. 45554

4/10

BY: _____

Well Name & No. Lloyd #1 Test No. 2 Date 1-11-12
 Company Bugh Oil Production Elevation 2002 KB 1997 GL
 Address PO Box 723 Alma NE 68920
 Co. Rep / Geo. Bob Peterson Rig Murfin #16
 Location: Sec. 29 Twp. 4s Rge. 20w Co. Phillips State KS

Interval Tested 3273 - 3300 Zone Tested LKC "F"
 Anchor Length 27 Drill Pipe Run 3223 Mud Wt. 9.0
 Top Packer Depth 3268 Drill Collars Run 30 Vis 62
 Bottom Packer Depth 3273 Wt. Pipe Run - WL 8.0
 Total Depth 3300 Chlorides 1000 ppm System LCM 3
 Blow Description IF: Blow built to 1 1/4" in 18 min., then on/off ^{surging} blow built to 2 1/4" by 60 min.
ISI: Bled off, No blowback
FF: Blow started at 7 min., on/off ^{surging} blow built to 1 1/4"
FSI: Bled off, No blowback

Rec	Feet of	%gas	%oil	%water	%mud
<u>1</u>	<u>WCM w/trace oil</u>	<u>-</u>	<u>trace</u>	<u>50</u>	<u>50</u>
<u>60</u>	<u>WCM w/trace oil</u>	<u>-</u>	<u>trace</u>	<u>20</u>	<u>80</u>
Rec	Feet of	%gas	%oil	%water	%mud
Rec	Feet of	%gas	%oil	%water	%mud
Rec	Feet of	%gas	%oil	%water	%mud

Rec Total 61 BHT 94 Gravity - API RW .491 @ 59.4 °F Chlorides _____ ppm

(A) Initial Hydrostatic <u>1591</u>	<input type="checkbox"/> Test <u>* 1125'</u>	T-On Location <u>11:35</u>
(B) First Initial Flow <u>16</u>	<input type="checkbox"/> Jars <u>* 250'</u>	T-Started <u>12:10</u>
(C) First Final Flow <u>35</u>	<input type="checkbox"/> Safety Joint <u>* 75'</u>	T-Open <u>14:08</u>
(D) Initial Shut-In <u>926</u>	<input checked="" type="checkbox"/> Circ Sub <u>* N/A</u>	T-Pulled <u>17:09</u>
(E) Second Initial Flow <u>36</u>	<input checked="" type="checkbox"/> Hourly Standby _____	T-Out <u>18:35</u>
(F) Second Final Flow <u>45</u>	<input type="checkbox"/> Mileage <u>130 RT 182'</u>	Comments _____
(G) Final Shut-In <u>926</u>	<input checked="" type="checkbox"/> Sampler _____	
(H) Final Hydrostatic <u>1589</u>	<input checked="" type="checkbox"/> Straddle _____	<input checked="" type="checkbox"/> Ruined Shale Packer _____
	<input checked="" type="checkbox"/> Shale Packer _____	<input checked="" type="checkbox"/> Ruined Packer _____
Initial Open <u>60</u>	<input checked="" type="checkbox"/> Extra Packer _____	<input checked="" type="checkbox"/> Extra Copies _____
Initial Shut-In <u>30</u>	<input checked="" type="checkbox"/> Extra Recorder _____	Sub Total <u>0</u>
Final Flow <u>45</u>	<input checked="" type="checkbox"/> Day Standby _____	Total <u>11632'</u>
Final Shut-In <u>45</u>	<input checked="" type="checkbox"/> Accessibility _____	MP/DST Disc't _____
	Sub Total <u>11632'</u>	

Approved By _____ Our Representative Jesse Winkler

Trilobite Testing Inc. shall not be liable for damaged of any kind of the property or personnel of the one for whom a test is made, or for any loss suffered or sustained, directly or indirectly, through the use of its equipment, or its statements or opinion concerning the results of any test, tools lost or damaged in the hole shall be paid for at cost by the party for whom the test is made.



INVOICE

PO Box 31
Russell, KS 67665

Invoice Number: 129808

Invoice Date: Jan 7, 2012

Page: 1

Voice: (817) 546-7282
Fax: (817) 246-3361

Bill To:
Bach Oil Production R. R. #1 Box 28 Phillipsburg, KS 67661

Federal Tax I.D.#: 20-5975804

Customer ID	Well Name/# or Customer P.O.	Payment Terms	
Bach	Lloyd #1	Net 30 Days	
Job Location	Camp Location	Service Date	Due Date
KS1-01	Oakley	Jan 7, 2012	2/6/12

Quantity	Item	Description	Unit Price	Amount
150.00	MAT	Class A Common	16.25	2,437.50
3.00	MAT	Gel	21.25	63.75
5.00	MAT	Chloride	58.20	291.00
158.00	SER	Handling	2.25	355.50
70.00	SER	Mileage 158 sx @.11	17.38	1,216.60
1.00	SER	Surface	1,125.00	1,125.00
70.00	SER	Pump Truck Mileage	7.00	490.00
70.00	SER	Light Vehicle Mileage	4.00	280.00
1.00	SER	Manifold Rental	200.00	200.00
1.00	CEMENTER	Alan Ryan		
1.00	EQUIP OPER	Wayne McGhghy		
1.00	OPER ASSIST	Tyler Flipse		

Subtotal	6,459.35
Sales Tax	189.87
Total Invoice Amount	6,649.22
Payment/Credit Applied	
TOTAL	6,649.22

ALL PRICES ARE NET, PAYABLE
30 DAYS FOLLOWING DATE OF
INVOICE. 1 1/2% CHARGED
THEREAFTER. IF ACCOUNT IS
CURRENT, TAKE DISCOUNT OF

\$ 1297.87

ONLY IF PAID ON OR BEFORE
Feb 1, 2012

ALLIED CEMENTING CO., LLC. 036066

Federal Tax I.D.# 20-5975804

REMIT TO P.O. BOX 31
RUSSELL, KANSAS 67665

SERVICE POINT: Dodley, KS

DATE <u>1/2/12</u>	SEC <u>29</u>	TWP <u>9</u>	RANGE <u>20</u>	CALLED OUT	ON LOCATION	JOB START <u>7:00</u>	JOB FINISH <u>7:30</u>
LEASE <u>Lloyd</u>	WELL # <u>1</u>	LOCATION <u>Logan W N 20</u>			COUNTY <u>Phillips</u>	STATE <u>KS</u>	
OLD OR NEW (Circle one)							

CONTRACTOR Marvin 16

TYPE OF JOB Surface

HOLE SIZE 12 1/4 T.D. 224'

CASING SIZE 8 7/8 DEPTH 223'

TUBING SIZE DEPTH

DRILL PIPE DEPTH

TOOL DEPTH

PRES. MAX MINIMUM

MEAS. LINE SHOE JOINT

CEMENT LEFT IN CSG. 15'

PERFS.

DISPLACEMENT 13.2496

OWNER S

CEMENT AMOUNT ORDERED 150 con 370 cc

20 regular

COMMON	<u>150</u>	@ <u>16.25</u>	<u>2437.50</u>
POZMIX		@	
GEL*	<u>3</u>	@ <u>21.25</u>	<u>63.75</u>
CHLORIDE	<u>5</u>	@ <u>58.20</u>	<u>291.00</u>
ASC		@	

EQUIPMENT

PUMP TRUCK CEMENTER Alan

102 HELPER Wayne

BULK TRUCK DRIVER Tyler

3911

BULK TRUCK DRIVER

#

HANDLING <u>158.3K</u>	@ <u>2.25</u>	<u>355.50</u>
MILEAGE <u>114.5H/mile</u>		<u>1216.60</u>
TOTAL		<u>4364.35</u>

REMARKS:

Ru Coy, Circ in late, Mix Cement

Displace Cement

Cement did Circulate in

cellar

Thank You

Alan, Wayne, Tyler

SERVICE

DEPTH OF JOB	<u>223'</u>	
PUMP TRUCK CHARGE		<u>1185.00</u>
EXTRA FOOTAGE	@	
MILEAGE <u>70</u>	@ <u>7.00</u>	<u>490.00</u>
MANIFOLD	@	<u>200.00</u>
<u>152 Vehicle</u> <u>70</u>	@ <u>4.00</u>	<u>280.00</u>

TOTAL 2095.00

CHARGE TO Back Oil

STREET

CITY STATE ZIP

PLUG & FLOAT EQUIPMENT

	@	
	@	
	@	
	@	
	@	

TOTAL

To Allied Cementing Co., LLC.
You are hereby requested to rent cementing equipment and furnish cementer and helper(s) to assist owner or contractor to do work as is listed. The above work was done to satisfaction and supervision of owner agent or contractor. I have read and understand the "GENERAL TERMS AND CONDITIONS" listed on the reverse side.

SALES TAX (If Any)

TOTAL CHARGES

DISCOUNT IF PAID IN 30 DAYS

PRINTED NAME

SIGNATURE Ang



INVOICE

PO Box 31
Russell, KS 67665

Invoice Number: 129866

Invoice Date: Jan 12, 2012

Page: 1

Voice: (817) 546-7282

Fax: (817) 246-3361

Bill To:
Bach Oil Production R. R. #1 Box 28 Phillipsburg, KS 67661

Federal Tax I.D.#: 20-5975804

Customer ID	Well Name# or Customer P.O.	Payment Terms	
Bach	Lloyd #1	Net 30 Days	
Job Location	Camp Location	Service Date	Due Date
KS2-03	Russell	Jan 12, 2012	2/11/12

Quantity	Item	Description	Unit Price	Amount
132.00	MAT	Class A Common	16.25	2,145.00
88.00	MAT	Pozmix	8.50	748.00
10.00	MAT	Gel	21.25	212.50
56.00	MAT	Flo Seal	2.70	151.20
230.00	SER	Handling	2.25	517.50
60.00	SER	Mileage 230 sx @.11	25.30	1,518.00
1.00	SER	Rotary Plug	1,250.00	1,250.00
60.00	SER	Pump Truck Mileage	7.00	420.00
60.00	SER	Light Vehicle Mileage	4.00	240.00
1.00	EQP	8.5/8 Wooden Wiper Plug	64.00	64.00
1.00	CEMENTER	Glenn Ginther		
1.00	EQUIP OPER	Woody O'Neil		
1.00	EQUIP OPER	Ron Bennett		

ALL PRICES ARE NET, PAYABLE
30 DAYS FOLLOWING DATE OF
INVOICE. 1 1/2% CHARGED
THEREAFTER. IF ACCOUNT IS
CURRENT, TAKE DISCOUNT OF

\$ 2,106.64

ONLY IF PAID ON OR BEFORE
Feb 6, 2012

Subtotal	7,266.20
Sales Tax	494.10
Total Invoice Amount	7,760.30
Payment/Credit Applied	
TOTAL	7,760.30

ALLIED CEMENTING CO., LLC. 034539

Federal Tax I.D.# 20-5975804

REMIT TO P.O. BOX 31
RUSSELL, KANSAS 67665

SERVICE POINT:
Russell Ks.

DATE <u>1-12-2012</u>	SEC. <u>29</u>	TWP. <u>4 S</u>	RANGE <u>20W</u>	CALLED OUT	ON LOCATION	JOB START <u>4:00 PM</u>	JOB FINISH <u>4:30 PM</u>
LEASE <u>LLOYD</u>	WELL # <u>1</u>	LOCATION <u>Logan Ks. 1 1/2 W 1/2 N + W 1/4</u>		COUNTY <u>Phillips</u>	STATE <u>KANSAS</u>		
OLD OR NEW (Circle one)							

CONTRACTOR MURFIN DRUG. Rig #16
 TYPE OF JOB ROTARY Plug
 HOLE SIZE 7 7/8 I.D. 3420'
 CASING SIZE 8 5/8 SURFACE DEPTH 223'
 TUBING SIZE DEPTH
 DRILL PIPE 4 1/2 X-H DEPTH
 TOOL DEPTH
 PRES. MAX MINIMUM
 MEAS. LINE SHOE JOINT
 CEMENT LEFT IN CSG.
 PERFS.
 DISPLACEMENT

OWNER
 CEMENT
 AMOUNT ORDERED 220 SX @ 60 4% GEL
Y4 # F10-Soal PER SX.

COMMON	<u>132 SX</u>	@	<u>16.25</u>	<u>2145.00</u>
POZMIX	<u>88 SX</u>	@	<u>8.50</u>	<u>748.00</u>
GEL	<u>10 SX</u>	@	<u>21.25</u>	<u>212.50</u>
CHLORIDE		@		
ASC		@		
	<u>F10-Seal 56 LBS</u>	@	<u>2.70</u>	<u>151.20</u>
		@		
		@		
		@		
		@		
		@		
		@		
HANDLING	<u>230</u>	@	<u>2.25</u>	<u>517.50</u>
MILEAGE	<u>60 x 230 x .11</u>			<u>3840.00</u>
TOTAL				<u>7614.20</u>

EQUIPMENT

PUMP TRUCK CEMENTER Glenn
 # 417 HELPER Woody
 BULK TRUCK
 # 473 DRIVER Rory
 BULK TRUCK
 # DRIVER

REMARKS:

25 SX @ 1610'
100 SX @ 920'
40 SX @ 275'
10 SX @ 40' wiper plug
30 SX @ RAT Hole
15 SX @ mouse Hole

THANK'S

SERVICE

DEPTH OF JOB				
PUMP TRUCK CHARGE				<u>1250.00</u>
EXTRA FOOTAGE		@		
MILEAGE	<u>60 HV</u>	@	<u>7.00</u>	<u>420.00</u>
MANIFOLD		@		
	<u>LV 60</u>	@	<u>4.00</u>	<u>240.00</u>
		@		
TOTAL				<u>1910.00</u>

CHARGE TO: Jason Bach Oil Production
 STREET _____
 CITY _____ STATE _____ ZIP _____

PLUG & FLOAT EQUIPMENT

<u>8 5/8 WOODEN WIPER</u>	@	<u>64.00</u>	<u>64.00</u>
	@		
	@		
	@		
	@		

To Allied Cementing Co., LLC.
 You are hereby requested to rent cementing equipment

GEOLOGIST'S REPORT

DRILLING TIME AND SAMPLE LOG

BACH OIL PRODUCTION

WELL: Lloyd #1

LOC.: 2185' FNL & 2510' FWL
SEC. 29-4-20W

PHILLIPS COUNTY, KANSAS
API: 15-147-20659-00-00

DRILLING CONTR.: MURFIN RIG #16
SPUD: 01-07-12 COMP: 01-11-12
MUD UP: 2800' TYPE MUD: CHEM.
DRILL TIME: 2850-RTD
RTD: 3420' LTD: 3421'

SAMPLES SAVED: 2900'-RTD
GEOLOGIST: ROBERT J. PETERSEN

ELEVATION

KB: 2002'
GL: 1997'

LOG MEASURED FROM: KB

SURFACE CASING

8 5/8" surface csg.
Set @223' KB.
Cem. w/150sx Common,
3% CC, 2% Gel.

PRODUCTION CASING

N/A D&A

WELL LOG SURVEYS

RAG

ELECTRIC LOG TOPS

FORMATION	DEPTH	DATUM	Position
Stone Corral	1602	+400	-7
Base Stone Corral	1623	+379	+1
Topeka	2981	-979	-9
Heebner	3174	-1172	-12
Toronto	3201	-1199	-12
Lansing	3217	-1215	-11
Base Kansas City	3410	-1408	-11

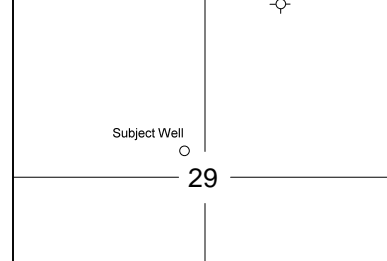

REFERENCE WELL:

Bach Oil Prod.
Becker Unit #1
D&A
N/2 NE NW NE
29-4-20W
2058KB

REMARKS AND RECOMMENDATIONS

Due to the drill stem test results and comparative log analysis the operator plugged and abandoned this test
Respectfully submitted,

Robert J. Petersen
Robert J. Petersen

DAILY REPORT

@7:00 A.M.

01-07-12 MIRU, SPUD
01-08-12 460' Drilling
01-09-12 2330' Drilling
01-10-12 3020' Drilling
01-11-12 3260' DST #1
01-12-12 3420' Logging

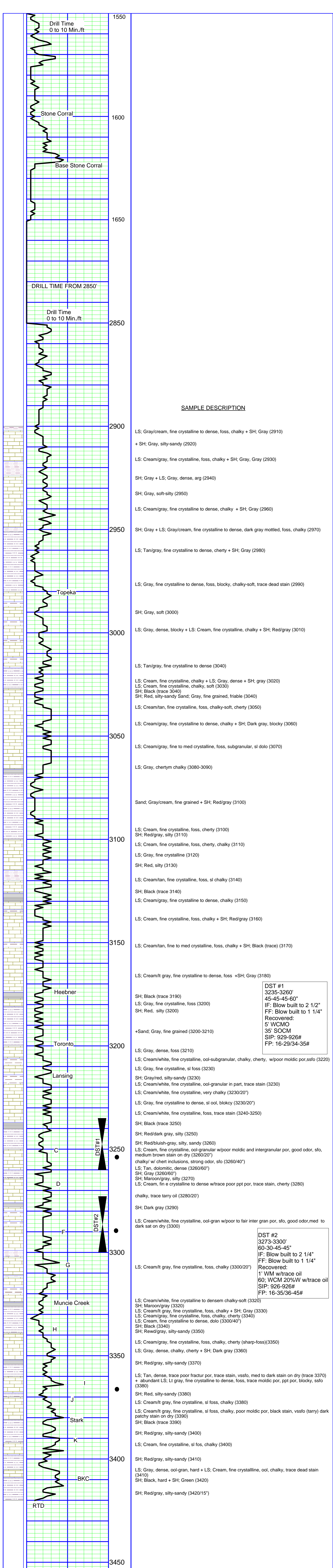

Conservation Division
Finney State Office Building
130 S. Market, Rm. 2078
Wichita, KS 67202-3802



Phone: 316-337-6200
Fax: 316-337-6211
<http://kcc.ks.gov/>

Mark Sievers, Chairman
Ward Loyd, Commissioner
Thomas E. Wright, Commissioner

Sam Brownback, Governor

February 23, 2012

Jason Bach
Bach, Jason dba Bach Oil Production
PO BOX 723
ALMA, NE 68920-0723

Re: ACO1
API 15-147-20659-00-00
Lloyd 1
NW/4 Sec.29-04S-20W
Phillips County, Kansas

Dear Production Department:

We are herewith requesting that the Well Completion Form ACO-1 and attached information for the subject well be held confidential for a period of two years.

Should you have any questions or need additional information regarding subject well, please contact our office.

Respectfully,
Jason Bach