

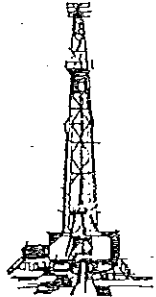

ROBERT E. MOSER, R.L.S.

Oil Field Surveying

335 N. Mission Road • Wichita, Kansas 67206
(316) 683-2853



KM2061.24

INVOICE NO.

VESS OIL CORPORATION
OPERATOR

11.6
NO.

Enyart 'A'
FARM

Butler (KS) 12 26s 04e
COUNTY S T R

660'FN - 1980'FE
LOCATION

ELEVATION: 1385.1'Gr.

Vess Oil Corporation
8100 East 22nd St. "N"
Wichita, KS 67226

HWY 11
AUTHORIZED BY: Mr. C. Costa
"MIDIAN"

SCALE: 1" = 1000'

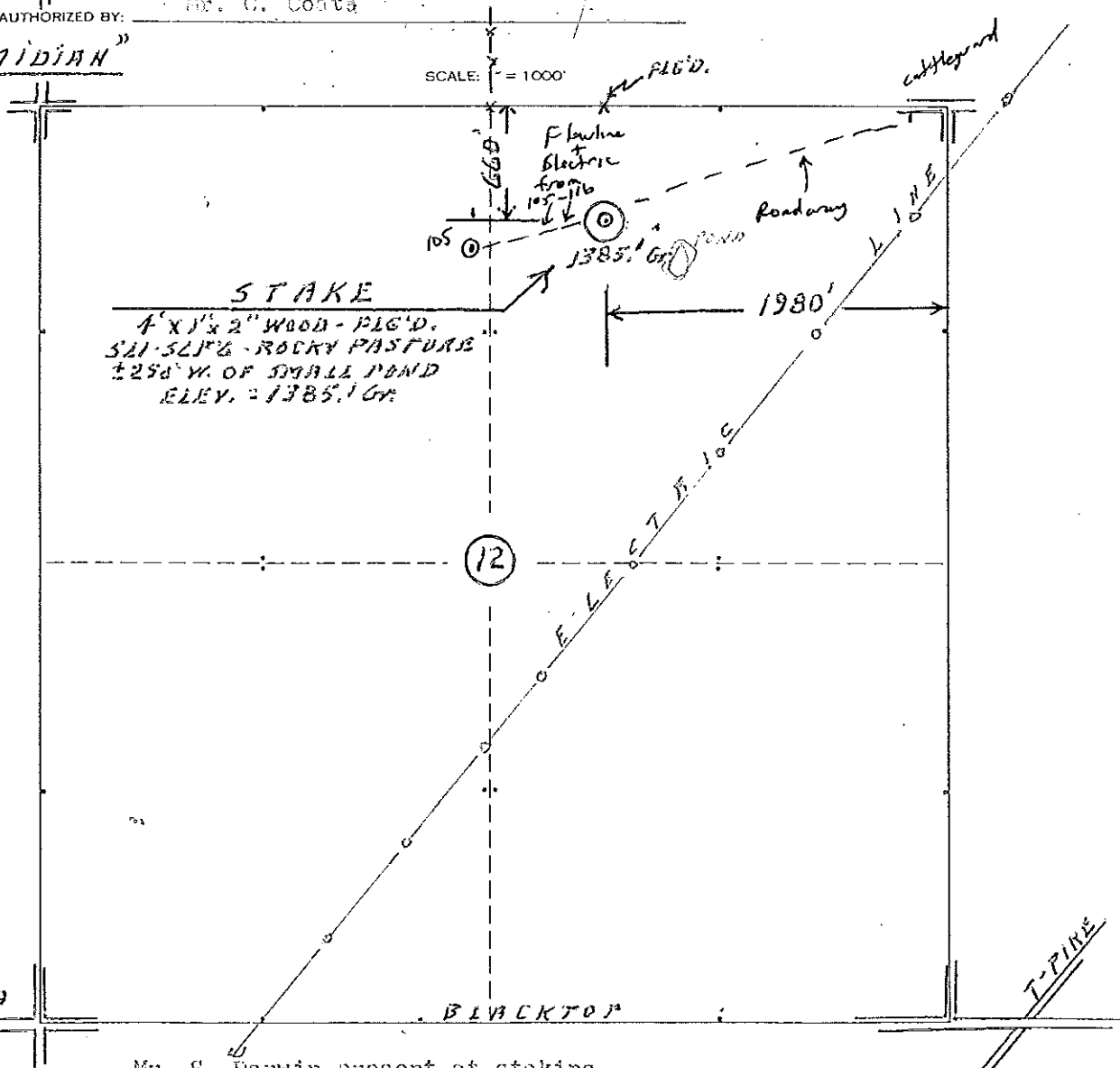

TOWANDA
← 2.5 MILES

Mr. S. Darwin present at staking.

Date: 6 February 2012
R. E. Moser
Surveyor: R. E. Moser, R.L.S. #329 KS