



KANSAS CORPORATION COMMISSION 1075945
OIL & GAS CONSERVATION DIVISION

Form must be Typed
Form must be Signed
All blanks must be Filled

For KCC Use:
Effective Date:
District #
SGA? Yes No

NOTICE OF INTENT TO DRILL

Must be approved by KCC five (5) days prior to commencing well

Form KSONA-1, Certification of Compliance with the Kansas Surface Owner Notification Act, MUST be submitted with this form.

Expected Spud Date: month day year

Spot Description:

OPERATOR: License#
Name:
Address 1:
Address 2:
City: State: Zip:
Contact Person:
Phone:

Sec. Twp. S. R. E W
feet from N / S Line of Section
feet from E / W Line of Section

Is SECTION: Regular Irregular?

(Note: Locate well on the Section Plat on reverse side)

CONTRACTOR: License#
Name:

County:

Lease Name: Well #:

Field Name:

Is this a Prorated / Spaced Field? Yes No

Target Formation(s):

Nearest Lease or unit boundary line (in footage):

Ground Surface Elevation: feet MSL

Water well within one-quarter mile: Yes No

Public water supply well within one mile: Yes No

Depth to bottom of fresh water:

Depth to bottom of usable water:

Surface Pipe by Alternate: I II

Length of Surface Pipe Planned to be set:

Length of Conductor Pipe (if any):

Projected Total Depth:

Formation at Total Depth:

Water Source for Drilling Operations:

Well Farm Pond Other:

DWR Permit #: (Note: Apply for Permit with DWR)

Will Cores be taken? Yes No

If Yes, proposed zone:

Well Drilled For: Well Class: Type Equipment:
Oil Gas Enh Rec Storage Disposal Seismic; # of Holes Other
Infield Pool Ext. Wildcat Other
Mud Rotary Air Rotary Cable

Operator:
Well Name:
Original Completion Date: Original Total Depth:

Directional, Deviated or Horizontal wellbore? Yes No
If Yes, true vertical depth:
Bottom Hole Location:
KCC DKT #:

AFFIDAVIT

The undersigned hereby affirms that the drilling, completion and eventual plugging of this well will comply with K.S.A. 55 et. seq.

It is agreed that the following minimum requirements will be met:

- 1. Notify the appropriate district office prior to spudding of well;
2. A copy of the approved notice of intent to drill shall be posted on each drilling rig;
3. The minimum amount of surface pipe as specified below shall be set by circulating cement to the top; in all cases surface pipe shall be set through all unconsolidated materials plus a minimum of 20 feet into the underlying formation.
4. If the well is dry hole, an agreement between the operator and the district office on plug length and placement is necessary prior to plugging;
5. The appropriate district office will be notified before well is either plugged or production casing is cemented in;
6. If an ALTERNATE II COMPLETION, production pipe shall be cemented from below any usable water to surface within 120 DAYS of spud date. Or pursuant to Appendix "B" - Eastern Kansas surface casing order #133,891-C, which applies to the KCC District 3 area, alternate II cementing must be completed within 30 days of the spud date or the well shall be plugged. In all cases, NOTIFY district office prior to any cementing.

Submitted Electronically

For KCC Use ONLY
API # 15 -
Conductor pipe required feet
Minimum surface pipe required feet per ALT. I II
Approved by:
This authorization expires:
(This authorization void if drilling not started within 12 months of approval date.)
Spud date: Agent:

Remember to:

- File Certification of Compliance with the Kansas Surface Owner Notification Act (KSONA-1) with Intent to Drill;
- File Drill Pit Application (form CDP-1) with Intent to Drill;
- File Completion Form ACO-1 within 120 days of spud date;
- File acreage attribution plat according to field proration orders;
- Notify appropriate district office 48 hours prior to workover or re-entry;
- Submit plugging report (CP-4) after plugging is completed (within 60 days);
- Obtain written approval before disposing or injecting salt water.
- If well will not be drilled or permit has expired (See: authorized expiration date) please check the box below and return to the address below.

Well will not be drilled or Permit Expired Date:
Signature of Operator or Agent:

E
W



For KCC Use ONLY
API # 15 - _____

IN ALL CASES PLOT THE INTENDED WELL ON THE PLAT BELOW

In all cases, please fully complete this side of the form. Include items 1 through 5 at the bottom of this page.

Operator: _____
Lease: _____
Well Number: _____
Field: _____
Number of Acres attributable to well: _____
QTR/QTR/QTR/QTR of acreage: _____ - _____ - _____ - _____

Location of Well: County: _____
_____ feet from N / S Line of Section
_____ feet from E / W Line of Section
Sec. _____ Twp. _____ S. R. _____ E W

Is Section: Regular or Irregular

If Section is Irregular, locate well from nearest corner boundary.

Section corner used: NE NW SE SW

PLAT

Show location of the well. Show footage to the nearest lease or unit boundary line. Show the predicted locations of lease roads, tank batteries, pipelines and electrical lines, as required by the Kansas Surface Owner Notice Act (House Bill 2032). You may attach a separate plat if desired.

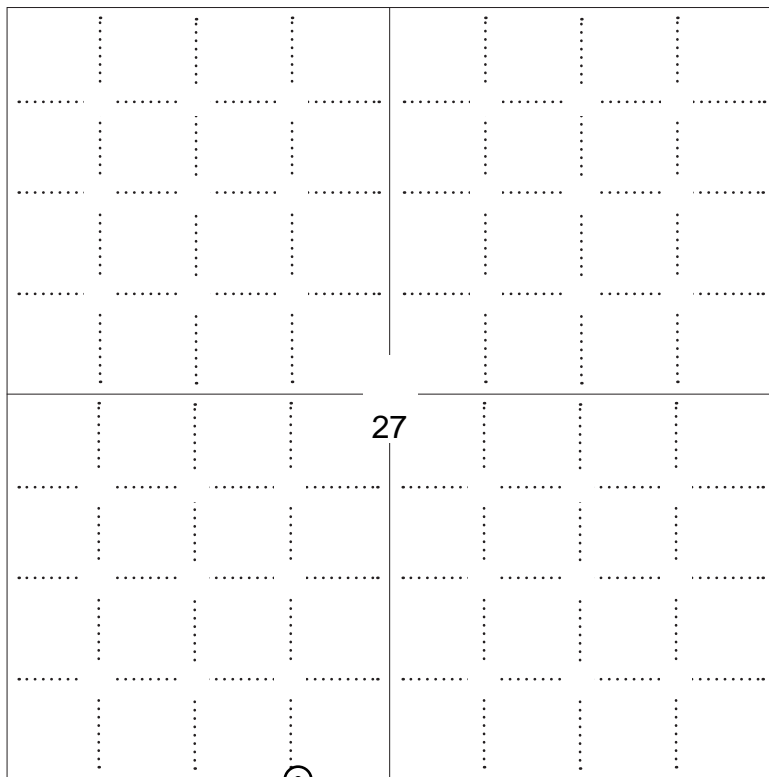

NOTE: In all cases locate the spot of the proposed drilling location.

LEGEND

- Well Location
- Tank Battery Location
- Pipeline Location
- Electric Line Location
- Lease Road Location

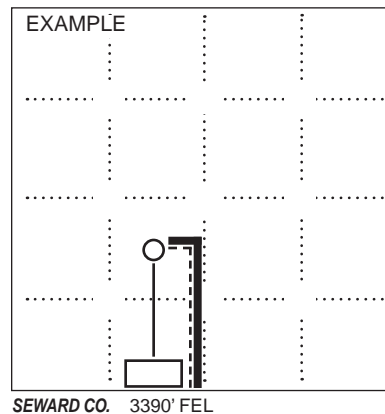

In plotting the proposed location of the well, you must show:

1. The manner in which you are using the depicted plat by identifying section lines, i.e. 1 section, 1 section with 8 surrounding sections, 4 sections, etc.
2. The distance of the proposed drilling location from the south / north and east / west outside section lines.
3. The distance to the nearest lease or unit boundary line (in footage).
4. If proposed location is located within a prorated or spaced field a certificate of acreage attribution plat must be attached: (C0-7 for oil wells; CG-8 for gas wells).
5. The predicted locations of lease roads, tank batteries, pipelines, and electrical lines.

**APPLICATION FOR SURFACE PIT***Submit in Duplicate*

Operator Name:		License Number:	
Operator Address:			
Contact Person:		Phone Number:	
Lease Name & Well No.:		Pit Location (QQQQ): ____ - ____ - ____ - ____	
Type of Pit: <input type="checkbox"/> Emergency Pit <input type="checkbox"/> Burn Pit <input type="checkbox"/> Settling Pit <input type="checkbox"/> Drilling Pit <input type="checkbox"/> Workover Pit <input type="checkbox"/> Haul-Off Pit <i>(If WP Supply API No. or Year Drilled)</i>		Pit is: <input type="checkbox"/> Proposed <input type="checkbox"/> Existing If Existing, date constructed: _____ Pit capacity: _____ (bbls)	
Is the pit located in a Sensitive Ground Water Area? <input type="checkbox"/> Yes <input type="checkbox"/> No		Chloride concentration: _____ mg/l <i>(For Emergency Pits and Settling Pits only)</i>	
Is the bottom below ground level? <input type="checkbox"/> Yes <input type="checkbox"/> No		Artificial Liner? <input type="checkbox"/> Yes <input type="checkbox"/> No	
How is the pit lined if a plastic liner is not used?			
Pit dimensions (all but working pits): _____ Length (feet) _____ Width (feet) <input type="checkbox"/> N/A: Steel Pits Depth from ground level to deepest point: _____ (feet) <input type="checkbox"/> No Pit			
If the pit is lined give a brief description of the liner material, thickness and installation procedure.		Describe procedures for periodic maintenance and determining liner integrity, including any special monitoring.	
Distance to nearest water well within one-mile of pit: _____ feet Depth of water well _____ feet		Depth to shallowest fresh water _____ feet. Source of information: <input type="checkbox"/> measured <input type="checkbox"/> well owner <input type="checkbox"/> electric log <input type="checkbox"/> KDWR	
Emergency, Settling and Burn Pits ONLY: Producing Formation: _____ Number of producing wells on lease: _____ Barrels of fluid produced daily: _____ Does the slope from the tank battery allow all spilled fluids to flow into the pit? <input type="checkbox"/> Yes <input type="checkbox"/> No		Drilling, Workover and Haul-Off Pits ONLY: Type of material utilized in drilling/workover: _____ Number of working pits to be utilized: _____ Abandonment procedure: _____ _____ Drill pits must be closed within 365 days of spud date.	
Submitted Electronically			

KCC OFFICE USE ONLY
 Liner Steel Pit RFAC RFAS

 Date Received: _____ Permit Number: _____ Permit Date: _____ Lease Inspection: Yes No

**CERTIFICATION OF COMPLIANCE WITH THE
KANSAS SURFACE OWNER NOTIFICATION ACT**

This form must be submitted with all Forms C-1 (Notice of Intent to Drill); CB-1 (Cathodic Protection Borehole Intent); T-1 (Request for Change of Operator Transfer of Injection or Surface Pit Permit); and CP-1 (Well Plugging Application). Any such form submitted without an accompanying Form KSONA-1 will be returned.

Select the corresponding form being filed: C-1 (Intent) CB-1 (Cathodic Protection Borehole Intent) T-1 (Transfer) CP-1 (Plugging Application)

OPERATOR: License # _____

Well Location:

Name: _____

____ - ____ - ____ - ____ Sec. ____ Twp. ____ S. R. ____ East West

Address 1: _____

County: _____

Address 2: _____

Lease Name: _____ Well #: _____

City: _____ State: _____ Zip: _____ + _____

If filing a Form T-1 for multiple wells on a lease, enter the legal description of the lease below:

Contact Person: _____

Phone: (_____) _____ Fax: (_____) _____

Email Address: _____

Surface Owner Information:

Name: _____

When filing a Form T-1 involving multiple surface owners, attach an additional sheet listing all of the information to the left for each surface owner. Surface owner information can be found in the records of the register of deeds for the county, and in the real estate property tax records of the county treasurer.

Address 1: _____

Address 2: _____

City: _____ State: _____ Zip: _____ + _____

If this form is being submitted with a Form C-1 (Intent) or CB-1 (Cathodic Protection Borehole Intent), you must supply the surface owners and the KCC with a plat showing the predicted locations of lease roads, tank batteries, pipelines, and electrical lines. The locations shown on the plat are preliminary non-binding estimates. The locations may be entered on the Form C-1 plat, Form CB-1 plat, or a separate plat may be submitted.

Select one of the following:

- I certify that, pursuant to the Kansas Surface Owner Notice Act (House Bill 2032), I have provided the following to the surface owner(s) of the land upon which the subject well is or will be located: 1) a copy of the Form C-1, Form CB-1, Form T-1, or Form CP-1 that I am filing in connection with this form; 2) if the form being filed is a Form C-1 or Form CB-1, the plat(s) required by this form; and 3) my operator name, address, phone number, fax, and email address.
- I have not provided this information to the surface owner(s). I acknowledge that, because I have not provided this information, the KCC will be required to send this information to the surface owner(s). To mitigate the additional cost of the KCC performing this task, I acknowledge that I am being charged a \$30.00 handling fee, payable to the KCC, which is enclosed with this form.

If choosing the second option, submit payment of the \$30.00 handling fee with this form. If the fee is not received with this form, the KSONA-1 form and the associated Form C-1, Form CB-1, Form T-1, or Form CP-1 will be returned.

Submitted Electronically

SGOMI
LOCATION LAYOUT FOR
DAVIS 3407 #27-1 & #27-1H
ON THE LINE BETWEEN THE SE 1/4 SW 1/4
OF SECTION 27 AND THE NE 1/4 NW 1/4 OF
SECTION 34, T34S, R7W, 6TH P.M.

FIGURE #1
 SCALE: 1" = 60'
 DATE: 12-09-11
 DRAWN BY: C.C.

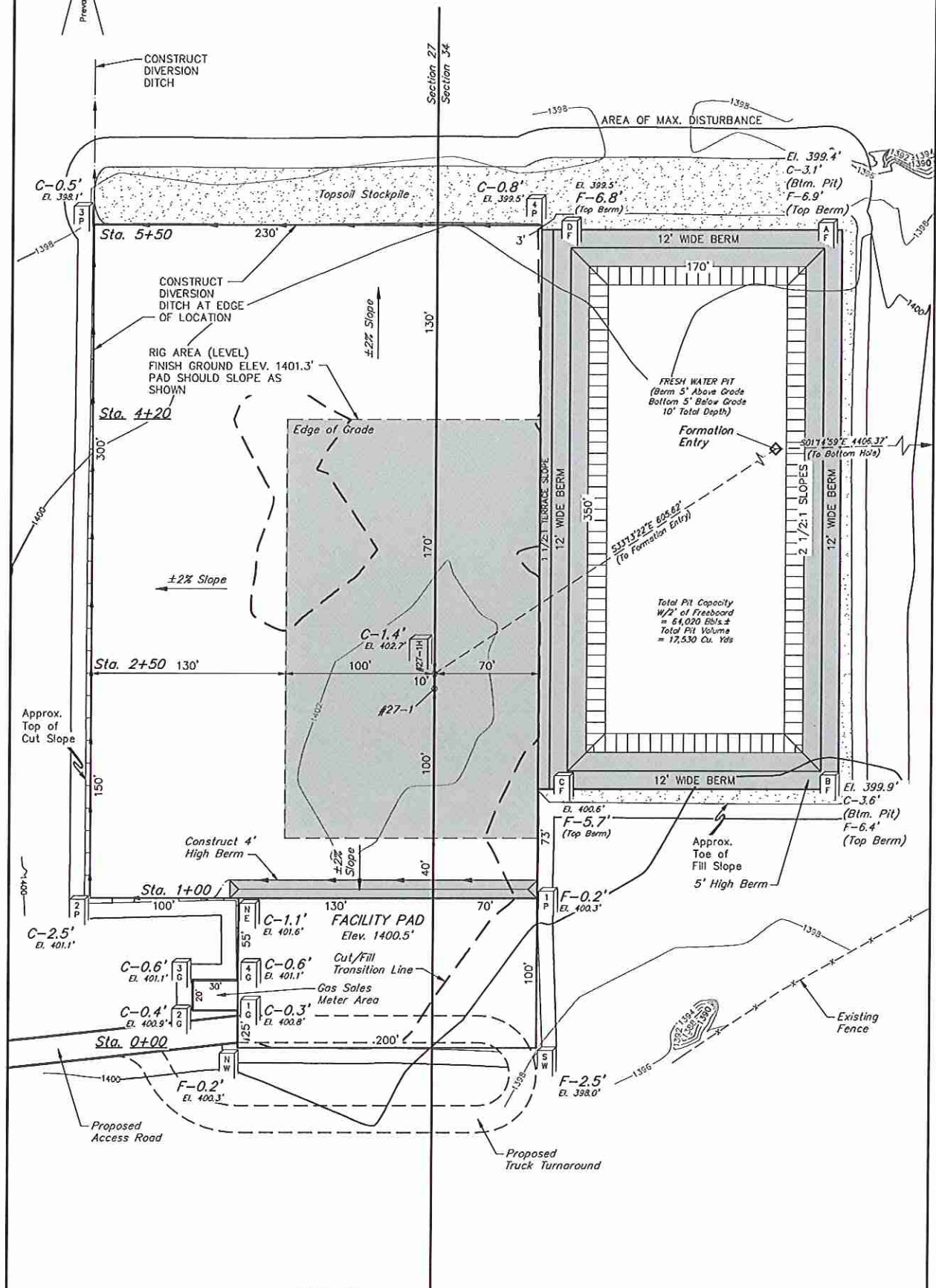
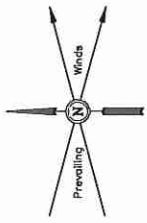

Elev. Ungraded Ground At #27-1H Loc. Stake = 1402.7'
 FINISHED GRADE ELEV. AT #27-1H LOC. STAKE = 1401.3'

UINTAH ENGINEERING & LAND SURVEYING
 85 So. 200 East • Vernal, Utah 84078 • (435) 783-1017

98°4'0"W 1,915,000 98°3'0"W

CROFT FARMS, INC.
BY SUSAN E.
CROFT, PRESIDENT

NAD27 State Plane Kansas South
Lat: 37.064415 X: 2126548.938
Lon: -98.066324 Y: 145122.7944

DEE S. CROFT TRUST NO. 1
DATED 8/15/1984 BY SUSAN
E. CROFT, TRUSTEE, INNIS
S. CROFT SHARE & SUSAN
E. CROFT, A SINGLE PERSON



**Shell
Davis
3407 27-2H BHL**

CROFT FARMS,
INC. BY SUSAN E.
CROFT, PRESIDENT

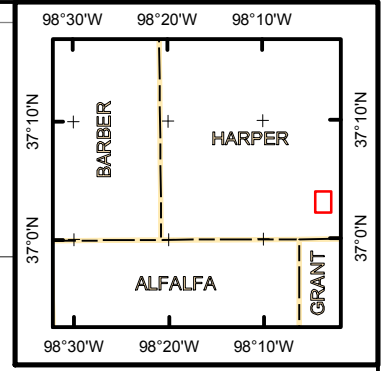

28

27

26

13,455,000

13,455,000

SHARYL R.
DAVIS, A
SINGLE PERSON

Shell Davis 3407 27-1

State Plane Kansas South
X: 2126342.336
Y: 140149.156

NAD27
Lat: 37.050759
Lon: -98.067111

SHARYL R.
DAVIS, A
SINGLE PERSON

CROFT FARMS,
INC. BY SUSAN E.
CROFT, PRESIDENT

T34S - R7W

THE DUSTY E. ALBRIGHT LIVING
TRUST, DATED JULY 10, 2007 (AN
UN-DIVIDED ONE-HALF INTEREST) AND
THE ERIN E. ALBRIGHT
LIVING TRUST, DATED
JULY 10, 2007, (AN UN-DIVIDED
ONE HALF-INTEREST), DUSTY E.
ALBRIGHT AND ERIN E. ALBRIGHT,
CO-TUSTEES OF EACH TRUST

SALLIE CARR 1

PULLIAM
DYLAN

PULLIAM
DAUSON

33

34

35

13,450,000

13,450,000

CHARLES
REDFERN, A
SINGLE MAN

THE DUSTY E. ALBRIGHT LIVING
TRUST, DATED JULY 10, 2007 (AN
UN-DIVIDED ONE-HALF INTEREST)
AND THE ERIN E. ALBRIGHT LIVING
TRUST, DATED JULY 10, 2007, (AN
UN-DIVIDED ONE HALF-INTEREST),
DUSTY E. ALBRIGHT AND
ERIN E. ALBRIGHT, CO-TUSTEES
OF EACH TRUST

NAD27 State Plane Kansas South
Lat: 37.037302 X: 2126785.602
Lon: -98.065671 Y: 135251.5406

Shell Davis

3407 27-1H BHL 3 T35S - R7W

Shell Gulf of Mexico Inc.

KANSAS
HARPER COUNTY
T34S - R7W SEC. 27, 34
Shell Davis 3407 27-1H&27-2H.mxd



January 19, 2012 E. Gilbertson - 4105 B by Eric Gilbertson
ShellDavis3407_27-1H&27-2H.mxd UTM 14N - NAD27 - US Feet

98°4'0"W 1,915,000 98°3'0"W

Davis 3407 27-2H Unit – 640 acres, more or less, containing all of Section 27, Township 34 South, Range 7 West, Harper County, Kansas

Summary of Changes

Lease Name and Number: Davis 3407 27-2H

API/Permit #: 15-077-21816-01-00

Doc ID: 1075945

Correction Number: 1

Approved By: Rick Hestermann 03/08/2012

Field Name	Previous Value	New Value
Formation At Total Depth	ARBUCKLE	MISSISSIPPI
KCC Only - Approved By	Rick Hestermann 02/22/2012	Rick Hestermann 03/08/2012
KCC Only - Approved Date	02/22/2012	03/08/2012
KCC Only - Date Received	02/22/2012	03/07/2012
KCC Only - Lease Inspection	Yes	No
Save Link	../kcc/detail/operatorEditDetail.cfm?docID=1071507	../kcc/detail/operatorEditDetail.cfm?docID=1075945
Target Producing Formation	ARBUCKLE	MISSISSIPPI

Summary of Attachments

Lease Name and Number: Davis 3407 27-2H

API: 15-077-21816-01-00

Doc ID: 1075945

Correction Number: 1

Approved By: Rick Hestermann 03/08/2012

Attachment Name

Davis Well Survey & Facility Plot Plan

Davis Lease Plat

Davis 2H Unit Description