

COMANCHE RESOURCES COMPANY  
JAMES LEASE  
SE.1/4, SECTION 31, T19S, R34W  
SCOTT COUNTY, KANSAS

Directions:

From the intersection of Highway 96 and Highway 83 in Scott City, Kansas go 2.0 miles West on Highway 96, then go 8.0 miles South on Highway 83 to the NW corner of Section 31, then go 0.91 miles East, then go 0.57 miles South to location.

HW. 70 ROAD/ DIRT TRAIL

Notes:

1. Set (2) wood stakes at location site.
2. All flagging Red & Yellow.
3. No overhead power available at Sec. 31.
4. Kansas One Call System Inc. should be notified before excavation (1-800-344-7233).
5. CAUTION: Various pipelines in Sec. 31.
6. Section 31 is irregular.
7. Contact landowner for best access and as to location of wood stakes in wheat.

\*Ingress and egress to location as shown on this plot is per usage only and may not be legally opened for public use. Contact landowner, tenant and county road department for access.

GRAVEL (S. WICHITA-SCOTT RD.) ROAD

ROAD

31

Drill-site Location

James #31-1

2300' FSL 330' FEL

Ground Elevation = 3066

Y = 626253 X = 1251778

State Plane-NAD 27-Kansas South  
(Mapping Grade GPS Used)

Tank Battery →

WHEAT

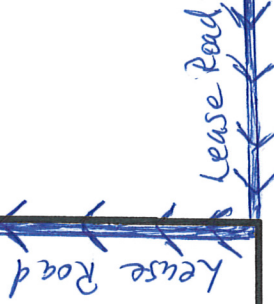

No Electric line

No Pipelines

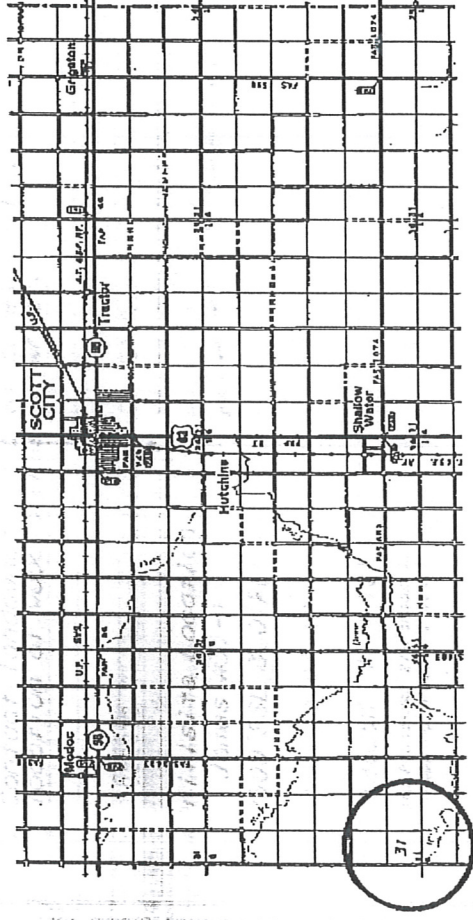

Central Kansas Oilfield Services, Inc. is based upon the best maps and photographs available to us and upon a regular section of field containing 360 acres.

Approximate acreage has been determined using the normal standards of some of the field surveys. The section corners, which establish the precise section lines, were not necessarily located, and the exact location of the well site location in the section cannot be guaranteed. Therefore, the Central Kansas Oilfield Services, Inc. is not responsible for any errors or omissions from all Texas, state and federal and sold articles released from any liability from fabrication or consequential damages.

Elevations derived from National Geospatial Intelligence Agency.

Date March 7, 2012

CENTRAL KANSAS OILFIELD SERVICES, INC. (620)792-1977