

OPERATOR : Samuel Gary Jr & Associates, Inc 1515 Wynkoop Street, Suite 700
Denver, Colorado 80202 office :303-831-4673 ; fax :303-863-7285

WELL NAME : Glassman 1-16

LOCATION : 2040 FSL / 1350 FWL Sec. 16-12S-16W ELLIS COUNTY

SURFACE OWNER : Marguerite Glassman
200 East 16th Street
Hays, KS 67601

R 16 W

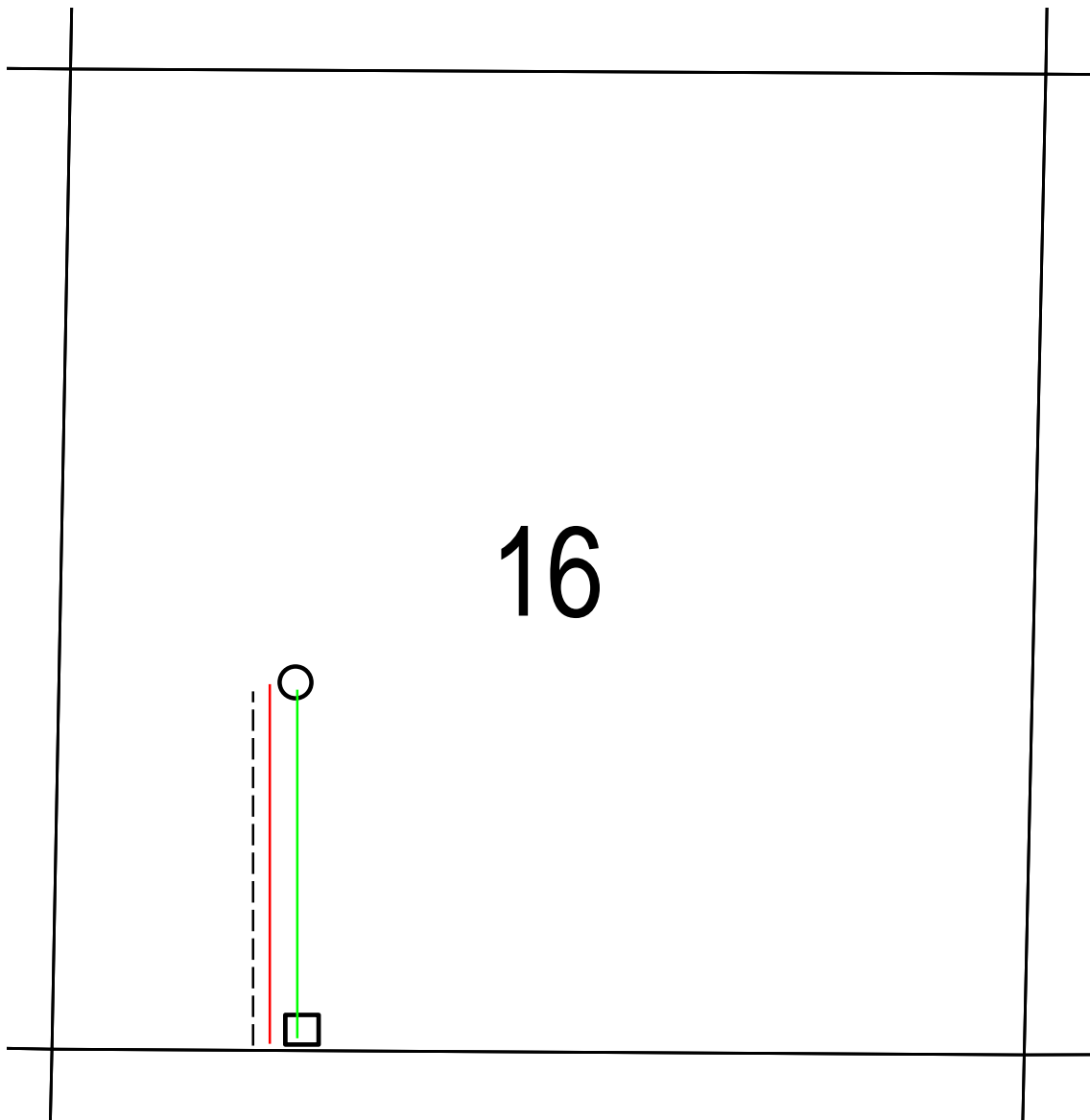

○ PROPOSED WELL LOCATION

□ ESTIMATED LOCATION OF TANK BATTERY

ESTIMATED LOCATION OF FLOW LINES
ESTIMATED LOCATION OF ELECTRICAL LINES
--- ESTIMATED LEASE ROAD