

Proposed Plan of Construction
Stanford C-2
Sec 26 T34S-R41W
Morton County, KS

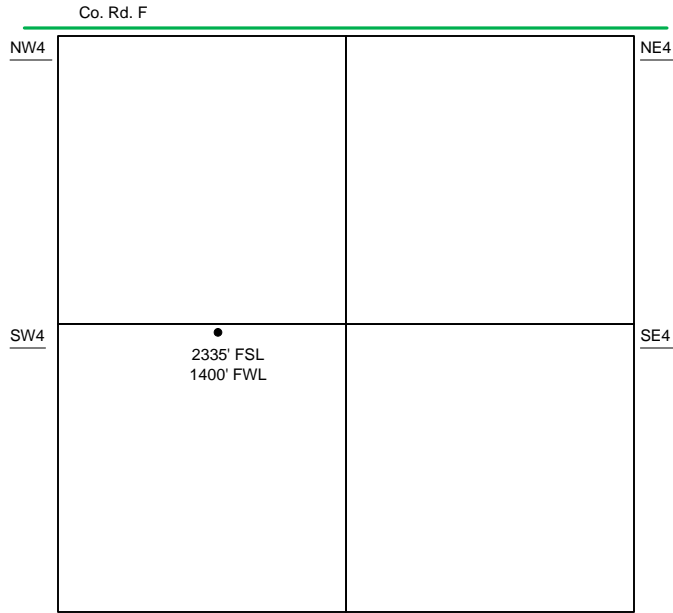

Sec 26 - T34S - R41W

The **Proposed** Tank Battery for the Stanford C-2 is located in the NW of the SW quarter.

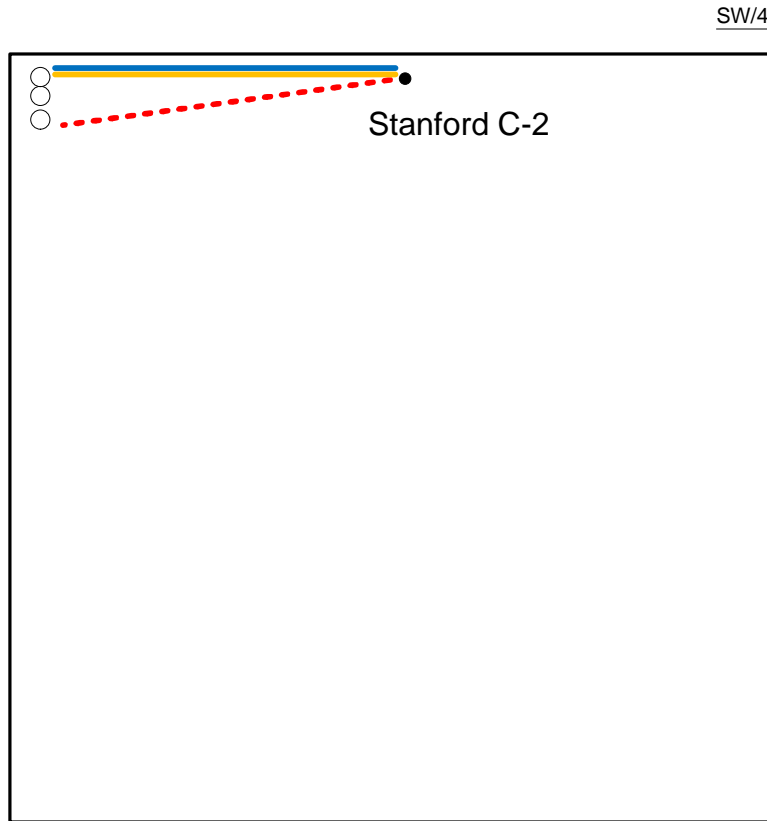

- Well Location
- Proposed Lease Roads
- - - Proposed Pipeline
- Proposed Tank Battery
- Proposed Power Lines
- - - Existing Pipeline

Proposed Details of
SW/4 Sec 26 -T34S -R41W

Note-Drawing **Not** to Scale

