

WOOLSEY OPERATING COMPANY, LLC

\* LUTHI LEASE

SE. 1/4, SECTION 36, T33S, R11W  
BARBER COUNTY, KANSAS

NO

ROAD

Notes:

1. Set (2) wood stakes at location site.
2. All flagging Red & Yellow.
3. Overhead power available at S. line, Sec.36 and in NW.1/4, Sec.36.
4. Kansas One Call System Inc. should be notified before excavation (1-800-344-7233).
5. CAUTION; Various pipelines in Sec.36.
6. Contact landowner for best access and as to location of wood stakes in wheat.
7. Original location (1015'FSL 1015'FEL) fell in a rough area, set new location footages per representative.

ROAD

ROAD

\* Ingress and egress to location as shown on this plot is per usage only and may not be legally opened for public use. Contact landowner, tenant and county road department for access.

SCALE 1" = 1000'



NO

(BETHEL RD.)

Drillsite Location

Luthi GU #5

1015'FSL 1420'FEL

Ground Elevation = 1441

Y = 167193 X = 2010773

State Plane-NAD 27-Kansas South  
(Mapping Grade GPS Used)

36

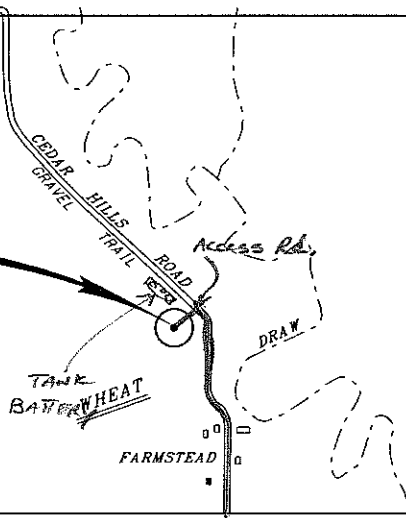

PAVED

(GERLANE RD.)

ROAD

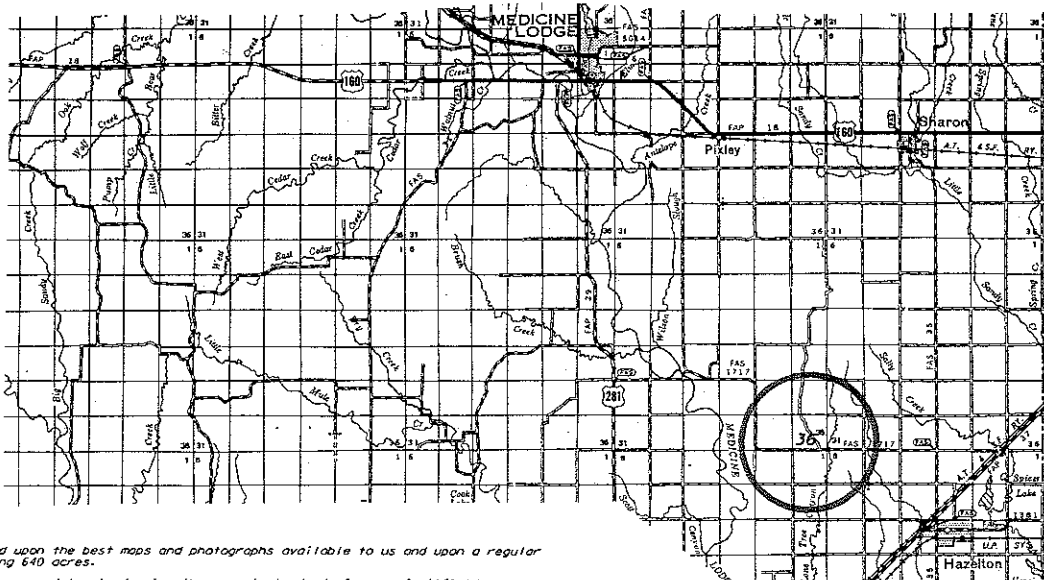

\* Controlling data is based upon the best maps and photographs available to us and upon a regular section of land containing 640 acres.

\* Approximate section lines were determined using the normal standard of care of oilfield surveyors practicing in the state of Kansas. The section corners, which establish the precise section lines, were not necessarily located, and the exact location of the drillsite location in the section is not guaranteed. Therefore, the operator securing this service and accepting this plot and all other parties relying thereon agree to hold Central Kansas Oilfield Services, Inc., its officers and employees harmless from all losses, costs and expenses and said entities released from any liability from incidental or consequential damages.

\* Elevations derived from National Geodetic Vertical Datum.

Date March 9, 2012