



KANSAS CORPORATION COMMISSION 1080473
OIL & GAS CONSERVATION DIVISION

Form ACO-4
Form must be typed
March 2009

APPLICATION FOR COMMINGLING OF *Commingling ID #* _____
PRODUCTION (K.A.R. 82-3-123) OR FLUIDS (K.A.R. 82-3-123a)

OPERATOR: License # _____ API No. 15 - _____
Name: _____ Spot Description: _____
Address 1: _____ - - - - - Sec. _____ Twp. _____ S. R. _____ East West
Address 2: _____ Feet from North / South Line of Section
City: _____ State: _____ Zip: _____ + _____ Feet from East / West Line of Section
Contact Person: _____ County: _____
Phone: (_____) _____ Lease Name: _____ Well #: _____

1. Name and upper and lower limit of each production interval to be commingled:
Formation: _____ (Perfs): _____
Formation: _____ (Perfs): _____
Formation: _____ (Perfs): _____
Formation: _____ (Perfs): _____
Formation: _____ (Perfs): _____

2. Estimated amount of fluid production to be commingled from each interval:
Formation: _____ BOPD: _____ MCFPD: _____ BWPD: _____
Formation: _____ BOPD: _____ MCFPD: _____ BWPD: _____
Formation: _____ BOPD: _____ MCFPD: _____ BWPD: _____
Formation: _____ BOPD: _____ MCFPD: _____ BWPD: _____
Formation: _____ BOPD: _____ MCFPD: _____ BWPD: _____

3. Plat map showing the location of the subject well, all other wells on the subject lease, and all wells on offsetting leases within a 1/2 mile radius of the subject well, and for each well the names and addresses of the lessee of record or operator.

4. Signed certificate showing service of the application and affidavit of publication as required in K.A.R. 82-3-135a.

For Commingling of PRODUCTION ONLY, include the following:

- 5. Wireline log of subject well. Previously Filed with ACO-1: Yes No
- 6. Complete Form ACO-1 (*Well Completion form*) for the subject well.

For Commingling of FLUIDS ONLY, include the following:

- 7. Well construction diagram of subject well.
- 8. Any available water chemistry data demonstrating the compatibility of the fluids to be commingled.

AFFIDAVIT: I am the affiant and hereby certify that to the best of my current information, knowledge and personal belief, this request for commingling is true and proper and I have no information or knowledge, which is inconsistent with the information supplied in this application.

Submitted Electronically

KCC Office Use Only
 Denied Approved
15-Day Periods Ends: _____
Approved By: _____ Date: _____

Protests may be filed by any party having a valid interest in the application. Protests must be in writing and comply with K.A.R. 82-3-135b and must be filed within 15 days of publication of the notice of application.

R 30 W

T
17
S

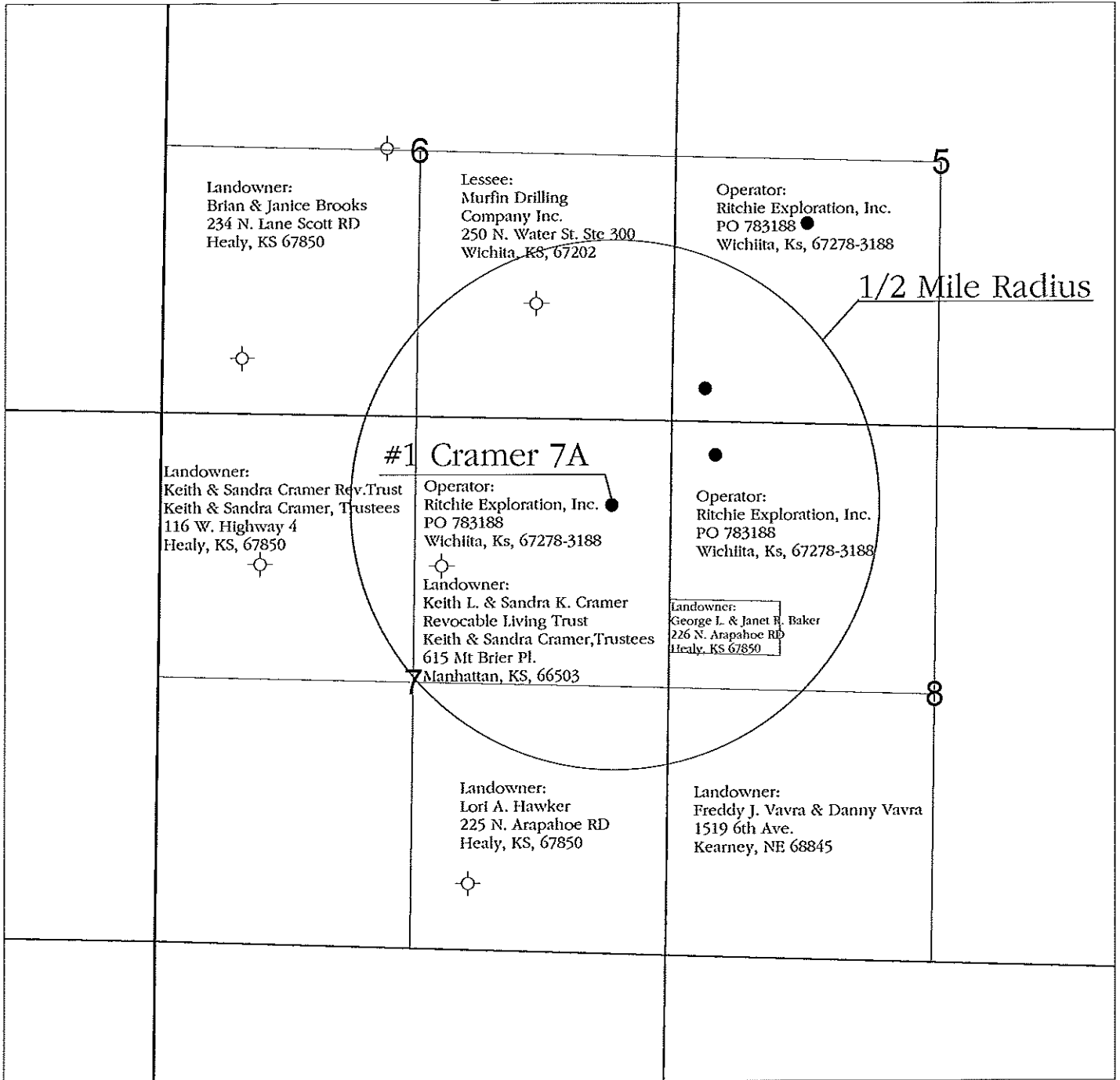

Legend

- Oil Well
- ⊕ Dry and Abandoned Well



RITCHIE
EXPLORATION, INC.
Wichita, Kansas

**Application for
Commingling of
Production or Fluids**

Applicant Well: #1 Cramer 7A
 All Wells on Offsetting Leases within 1/2 Mile Radius
 Name and Address Of Lessee of Record or Operator
 On Offsetting Leases

Prepared By: Adam Eldani	Scale: 1 : 18,000	Date: April 23, 2012
-----------------------------	----------------------	-------------------------

APPLICATION FOR COMMINGLING OF PRODUCTION OR FLUIDS

**Operator, Lessee or Unleased Mineral Owner
within a ½ mile radius of Ritchie Exploration, Inc.'s**

**#1 Cramer 7A
850' FNL & 590' FEL
Section 7-17S-30W
Lane Co., KS**

Township 17 South, Range 30 West

Sec. 5:	SW/4	Ritchie Exploration, Inc.	Operator: Wilkens 5C #1; Wilkens 5C #2
Sec. 6:	SW/4	Brian & Janice Brooks 234 N. Lane Scott RD Healy, KS 67850	Landowner
	SE/4	Murfin Drilling Company, Inc. 250 N. Water St., Ste 300 Wichita, KS 67202	Lessee
Sec. 7:	NW/4	Keith & Sandra Cramer Rev. Trust Keith & Sandra Cramer, Trustees 116 W. Highway 4 Healy, KS 67850	Landowner
	NE/4	Ritchie Exploration, Inc. Keith L. & Sandra K. Cramer Revocable Living Trust Keith & Sandra Cramer, Trustees 615 Mt Brier Pl. Manhattan, KS 66503	Operator: #1 Cramer 7A Mineral Owners
	SE/4	Lori A. Hawker 225 N. Arapahoe RD Healy, KS 67850	Landowner
Sec. 8:	NW/4, less a 15.7 acre tract	Ritchie Exploration, Inc.	Operator: #1 Sharp Seed 8B

Sec. 8:	15.7 acre tract George L. & Janet R. Baker in NW/4 226 N. Arapahoe RD Healy, KS 67850	Landowner
	SW/4 Freddy J. Vavra & Danny Vavra 1519 6 th Ave. Kearney, NE 68845	Landowners

AFFIDAVIT

STATE OF KANSAS)
 - SS.
County of Sedgwick)

John Niernberger, of lawful age, being first duly sworn, deposeth and saith: That he is Production Manager of Ritchie Exploration, County of Sedgwick, State of Kansas, and that notice was given to all lessee of record or operator within ½ mile radius of the Cramer 7A #1 well located in the County of Lane (see attached plat map). This notice included a letter and a copy of the Commingle Application (ACO-4). All notices were mailed on April 26, 2012.

made as aforesaid on the 26th of

April A.D. 2012

And affiant further says that he has personal knowledge of the statements above set forth and that they are true.

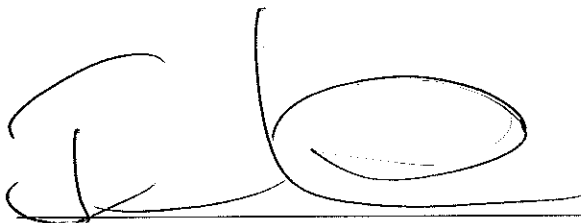

Subscribed and sworn to before me this

26th day of April 2012

KAREN HOPPER
NOTARY PUBLIC-STATE OF KANSAS
MY APPT. EXPIRES 3.8.15

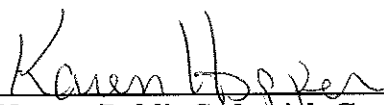

Notary Public Sedgwick County, Kansas

AFFIDAVIT

STATE OF KANSAS \
 - SS.
County of Sedgwick /

Mark Fletchall, of lawful age, being first duly sworn, deposeth and saith: That he is Record Clerk of The Wichita Eagle, a daily newspaper published in the City of Wichita, County of Sedgwick, State of Kansas, and having a general paid circulation on a daily basis in said County, which said newspaper has been continuously and uninterruptedly published in said County for more than one year prior to the first publication of the notice hereinafter mentioned, and which said newspaper has been entered as second class mail matter at the United States Post Office in Wichita, Kansas, and which said newspaper is not a trade, religious or fraternal publication and that a notice of a true copy is hereto attached was published in the regular and entire Morning issue of said The Wichita Eagle for 1 issues, that the first publication of said notice was

made as aforesaid on the 30th of

April A.D. 2012, with

subsequent publications being made on the following dates:

And affiant further says that he has personal knowledge of the statements above set forth and that they are true.

Mark Fletchall

Subscribed and sworn to before me this

30th day of April, 2012

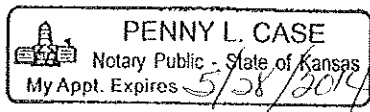

Penny L Case
Notary Public Sedgwick County, Kansas

Printer's Fee : \$91.60

LEGAL PUBLICATION
PUBLISHED IN THE WICHITA EAGLE
APRIL 30, 2012 (3182098)
LEGAL NOTICE
You, and each of you, are hereby notified that Ritchie Exploration, Inc. has filed an application to commence the commingling of production from the Lansing-Kansas City, and Johnson sources of supply for the #1 Cramer 7A well located approx. S/2 NE NE of Section 7-17S-30W, Lane County, Kansas.
Any persons who object to or protest this application shall be required to file their objections or protests with the Conservation Division of the State Corporation Commission of the State of Kansas within fifteen (15) days from the date of the publication. These protests shall be filed pursuant to Commission regulations and must state specific reasons why the grant of the application may cause waste, violate correlative rights or pollute the natural resources of the state of Kansas.
If no protests are received, this application may be granted through a summary proceeding. If valid protests are received, this matter will be set for hearing.
All persons interested or concerned shall take notice of the foregoing and shall govern themselves accordingly.
RITCHIE EXPLORATION, INC.
P.O. Box 783188
Wichita, KS 67278-3188
(316) 691-9500

Proof of Publication

State of Kansas,
County of Lane, ss:

Mary Hartman

of lawful age, being duly sworn upon oath states that he/she is the editor of THE DIGHTON HERALD

THAT said newspaper has been published at least weekly (50) times a year and has been so published for at least five years prior to the first publication of the attached notice.

THAT said paper was entered as second class matter at the post office of its publication;

THAT said paper has a general paid circulation on a daily, or weekly, or monthly, or yearly basis in LANE County, Kansas, and is NOT a trade, religious or fraternal publication and has been PRINTED and published in LANE County, Kansas.

THE ATTACHED was published on the following dates in a regular issue of said newspaper:

- 1st Publication was made on the 2 day of May, 2012
- 2nd Publication was made on the ___ day of _____, 20__
- 3rd Publication was made on the ___ day of _____, 20__
- 4th Publication was made on the ___ day of _____, 20__
- 5th Publication was made on the ___ day of _____, 20__
- 6th Publication was made on the ___ day of _____, 20__

Publication fee \$ 4320

Affidavit, Notary's Fees \$ _____

Additional Copies ___ @ ___ \$ _____

Total Publication Fee \$ 4320

(Signed) Mary Hartman

Witness my hand this 2 day of May, 2012

SUBSCRIBED and SWORN to before me this 2 day of May, 2012

Kelly C Anderson
(Notary Public)

My commission expires 2.7.2014

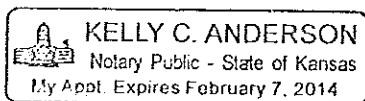

days from the date of the publication. These protests shall be filed pursuant to Commission regulations and must state specific reasons why the grant of the application may cause waste, violate correlative rights or pollute the natural resources of the state of Kansas.

If no protests are received, this application may be granted through a summary proceeding. If valid protests are received, this matter will be set for hearing.

All persons interested or concerned shall take notice of the foregoing and shall govern themselves accordingly.

RITCHIE EXPLORATION, INC.
P.O. Box 783188
Wichita, KS 67278-3188
(316) 691-9500

Legal

(First published in The Dighton Herald Wednesday, May 2, 2012)

LEGAL NOTICE

You, and each of you, are hereby notified that Ritchie Exploration, Inc. has filed an application to commence the commingling of production from the Lansing-Kansas City, and Johnson sources of supply for the #1 Cramer 7A well located approx. S/2 NE NB of Section 7-17S-30W, Lane County, Kansas.

Any persons who object to or protest this application shall be required to file their objections or protests with the Conservation Division of the State Corporation Commission of the State of Kansas within fifteen (15)

KANSAS CORPORATION COMMISSION
OIL & GAS CONSERVATION DIVISION

Form ACO-1
October 2008
Form Must Be Typed

WELL COMPLETION FORM
WELL HISTORY - DESCRIPTION OF WELL & LEASE

OPERATOR: License # 4767
Name: Ritchie Exploration, Inc.
Address 1: P.O. Box 783188
Address 2: _____
City: Wichita State: KS Zip: 67278 + 3118
Contact Person: John Niernberger
Phone: (316) 691-9500
CONTRACTOR: License # 5929
Name: Duke Drilling Co., Inc.
Wellsite Geologist: Mike Kidwell
Purchaser: NCRA
Designate Type of Completion:
 New Well _____ Re-Entry _____ Workover
 Oil _____ SWD _____ SIOW
_____ Gas _____ ENHR _____ SIGW
_____ CM (Coal Bed Methane) _____ Temp. Abd.
_____ Dry _____ Other _____
(Core, WSW, Expl., Cathodic, etc.)

If Workover/Re-entry: Old Well Info as follows:
Operator: _____
Well Name: _____
Original Comp. Date: _____ Original Total Depth: _____
_____ Deepening _____ Re-perf. _____ Conv. to Enhr. _____ Conv. to SWD
_____ Plug Back: _____ Plug Back Total Depth
_____ Commingled _____ Docket No.: _____
_____ Dual Completion _____ Docket No.: _____
_____ Other (SWD or Enhr.?) _____ Docket No.: _____
5/10/10 5/21/10 5/21/10
Spud Date or Date Reached TD Completion Date or
Recompletion Date Recompletion Date

API No. 15 - 101-22231-00-00
Spot Description: 140' N & 70' E
S/2 NE NE Sec. 7 Twp. 17 S. R. 30 East West
850 Feet from North / South Line of Section
590 Feet from East / West Line of Section
Footages Calculated from Nearest Outside Section Corner:
 NE NW SE SW
County: Lane
Lease Name: Cramer 7A Well #: 1
Field Name: _____
Producing Formation: LKC & Johnson
Elevation: Ground: 2887 Kelly Bushing: 2896
Total Depth: 4610 Plug Back Total Depth: 4578
Amount of Surface Pipe Set and Cemented at: 211 Feet
Multiple Stage Cementing Collar Used? Yes No
If yes, show depth set: 2208 Feet
If Alternate II completion, cement circulated from: 2208
feet depth to: surface w/ 235 sx cmt.

Drilling Fluid Management Plan
(Data must be collected from the Reserve Pit)
Chloride content: 7000 ppm Fluid volume: 660 bbls
Dewatering method used: evaporation
Location of fluid disposal if hauled offsite: _____
Operator Name: _____
Lease Name: _____ License No.: _____
Quarter _____ Sec. _____ Twp. _____ S. R. _____ East West
County: _____ Docket No.: _____

INSTRUCTIONS: An original and two copies of this form shall be filed with the Kansas Corporation Commission, 130 S. Market - Room 2078, Wichita, Kansas 67202, within 120 days of the spud date, recompletion, workover or conversion of a well. Rule 82-3-130, 82-3-106 and 82-3-107 apply. Information of side two of this form will be held confidential for a period of 12 months if requested in writing and submitted with the form (see rule 82-3-107 for confidentiality in excess of 12 months). One copy of all wireline logs and geologist well report shall be attached with this form. ALL CEMENTING TICKETS MUST BE ATTACHED. Submit CP-4 form with all plugged wells. Submit CP-111 form with all temporarily abandoned wells.

All requirements of the statutes, rules and regulations promulgated to regulate the oil and gas industry have been fully complied with and the statements herein are complete and correct to the best of my knowledge.

Signature: _____
Title: Production Manager Date: 9/7/10
Subscribed and sworn to before me this 7th day of September,
20 10.
Notary Public: Debra K Phillips
Date Commission Expires: 5-4-11

KCC Office Use ONLY

_____ Letter of Confidentiality Received
If Denied, Yes Date: _____
_____ Wireline Log Received
_____ Geologist Report Received
_____ UIC Distribution

DEBRA K. PHILLIPS
Notary Public - State of Kansas
My Appt. Expires 5-4-11

Operator Name: Ritchie Exploration, Inc. Lease Name: Cramer 7A Well #: 1
 Sec. 7 Twp. 17 S. R. 30 East West County: Lane

INSTRUCTIONS: Show important tops and base of formations penetrated. Detail all cores. Report all final copies of drill stems tests giving interval tested, time tool open and closed, flowing and shut-in pressures, whether shut-in pressure reached static level, hydrostatic pressures, bottom hole temperature, fluid recovery, and flow rates if gas to surface test, along with final chart(s). Attach extra sheet if more space is needed. Attach copy of all Electric Wireline Logs surveyed. Attach final geological well site report.

Drill Stem Tests Taken <input checked="" type="checkbox"/> Yes <input type="checkbox"/> No <i>(Attach Additional Sheets)</i> Samples Sent to Geological Survey <input checked="" type="checkbox"/> Yes <input type="checkbox"/> No Cores Taken <input type="checkbox"/> Yes <input checked="" type="checkbox"/> No Electric Log Run <input checked="" type="checkbox"/> Yes <input type="checkbox"/> No <i>(Submit Copy)</i> List All E. Logs Run: Radiation Guard Log	<input type="checkbox"/> Log Formation (Top), Depth and Datum <input checked="" type="checkbox"/> Sample Name Top Datum <p style="text-align: center;">SEE ATTACHED</p>
--	---

CASING RECORD <input checked="" type="checkbox"/> New <input type="checkbox"/> Used							
Report all strings set-conductor, surface, intermediate, production, etc.							
Purpose of String	Size Hole Drilled	Size Casing Set (In O.D.)	Weight Lbs. / Ft.	Setting Depth	Type of Cement	# Sacks Used	Type and Percent Additives
Surface	12-1/4	8-5/8	23	211	common	165	3%cc, 2%gel
Production	7-7/8	4-1/2	10.5	4601	ASC	200	10% sat, 2% gel, 3/4% CD-31

ADDITIONAL CEMENTING / SQUEEZE RECORD				
Purpose:	Depth Top Bottom	Type of Cement	#Sacks Used	Type and Percent Additives
<input type="checkbox"/> Perforate <input type="checkbox"/> Protect Casing <input type="checkbox"/> Plug Back TD <input type="checkbox"/> Plug Off Zone				

Shots Per Foot	PERFORATION RECORD - Bridge Plugs Set/Type Specify Footage of Each Interval Perforated	Acid, Fracture, Shot, Cement Squeeze Record <i>(Amount and Kind of Material Used)</i>	Depth
4	4520' - 4524' & 4528.5 - 4531.5 (Johnson) 6/8/10	750 gallons NE	
4	4024' - 4026' (LKC-E) 6/10/10		
4	3983.5' - 3986' (LKC-D) 6/8/10		
4	3969' - 3974' (LKC-C) 6/10/10		

TUBING RECORD: Size: <u>4554'</u> Set At: <u>2-3/8"</u> Packer At: _____		Liner Run: <input type="checkbox"/> Yes <input checked="" type="checkbox"/> No	
Date of First, Resumed Production, SWD or Enhr. <u>6/25/10</u>		Producing Method: <input type="checkbox"/> Flowing <input checked="" type="checkbox"/> Pumping <input type="checkbox"/> Gas Lift <input type="checkbox"/> Other (Explain)	
Estimated Production Per 24 Hours	Oil Bbls. <u>21.53</u>	Gas Mcf <u>79.96</u>	Water Bbls. <u>79.96</u> Gas-Oil Ratio _____ Gravity <u>28.6</u>

DISPOSITION OF GAS: <input type="checkbox"/> Vented <input type="checkbox"/> Sold <input type="checkbox"/> Used on Lease <i>(If vented, Submit ACO-18.)</i>	METHOD OF COMPLETION: <input type="checkbox"/> Open Hole <input type="checkbox"/> Perf. <input type="checkbox"/> Dually Comp. <input type="checkbox"/> Commingled <input type="checkbox"/> Other (Specify) _____	PRODUCTION INTERVAL: _____ _____
---	--	--



#1 Cramer 7A

850' FNL & 590' FEL

140' N & 70' E of S/2 NE NE Section 7-17S-30W

Lane County, Kansas

API# 15-101-22231-0000

Elevation: GL: 2887', KB: 2896'

Sample Tops			Ref. Well
Anhydrite	2282'	+614	+1
B/Anhydrite	2305'	+591	-1
Heebner	3903'	-1007	+7
Toronto	3924'	-1028	+6
Lansing	3942'	-1046	+6
Lansing "C"	3971'	-1075	+7
Lansing "D"	3986'	-1090	+8
Lansing "E"	4029'	-1133	+6
Muncie Shale	4109'	-1213	+7
Lansing "H"	4122'	-1226	+6
Lansing "J"	4183'	-1287	+7
Stark Shale	4207'	-1311	+9
Lansing "L"	4262'	-1366	+4
BKC	4289'	-1393	+3
Marmaton	4316'	-1420	+9
Altamont	4331'	-1435	+11
Altamont "B"	4345'	-1449	+17
Pawnee	4403'	-1507	+9
Myric	4440'	-1544	+4
Fort Scott	4457'	-1561	+3
Cherokee Shale	4477'	-1581	+3
Johnson	4517'	-1621	+7
B/Johnson	4534'	-1638	+4
Mississippian	4550'	-1654	+4
RTD	4610'	-1714	

Conservation Division
Finney State Office Building
130 S. Market, Rm. 2078
Wichita, KS 67202-3802



Phone: 316-337-6200
Fax: 316-337-6211
<http://kcc.ks.gov/>

Mark Sievers, Chairman
Ward Loyd, Commissioner
Thomas E. Wright, Commissioner

Sam Brownback, Governor

May 17, 2012

John Niernberger
Ritchie Exploration, Inc.
P.O. Box 783188
Wichita, KS 67278-3188

RE: Approved Commingling CO051201
Cramer 7A #1, Sec.7-T17S-R30W, Lane County
API No. 15-101-22231-00-00

Dear Mr. Niernberger:

Your Application for Commingling (ACO-4) for the above described well has been reviewed and approved by the Kansas Corporation Commission (KCC) per K.A.R. 82-3-123. Notice was examined and found to be proper per K.A.R. 82-3-135a. No protest had been filed within the 15-day protest period. This application, which was received by the KCC on May 7, 2012, concerns approval to simultaneously produce from the following sources of supply through the same tubing string in the same wellbore:

Source of Supply	Estimated Current Production			Perf Depth
	BOPD	MCFPD	BWPD	
Johnson	3.01	0.00	4.38	4520-4524, 4528-4531
LKC-C/D/E	22.04	0.00	141.57	4024-4026, 3983-3986, 3969-3974
Total Estimated Current Production	25.05	0.00	145.95	

Based upon the depth of the Johnson formation perforations, total oil production shall not exceed 200 BOPD and total gas production shall not exceed 50% of the absolute open flow (AOF).

Commingling ID number CO051201 has been assigned to this approved application. Use this number for well completion reports (ACO-1) and other correspondence that may concern this approved commingling.

Sincerely,

Rick Hestermann
Production Department