

# ADVANTAGE ELEVATIONS

OIL FIELD SURVEYORS

BOX 8604 - PRATT, KS 67124  
(620) 672-6491

511121  
INVOICE NO

FALCON EXPLORATION INC  
OPERATOR

1-31  
~~2-28~~  
NO

Gleason (NE) SE NW SW NE  
FARM

Clark  
COUNTY

31 30s 21w  
S T R

1880' FNL & 2030' FEL  
LOCATION

ELEVATION 2285' CR

FALCON EXPLORATION INC  
125 N Market St., Ste 1252  
Wichita, KS 67202

AUTHORIZED BY Leon Kuhn

SCALE: 1" = 1000'

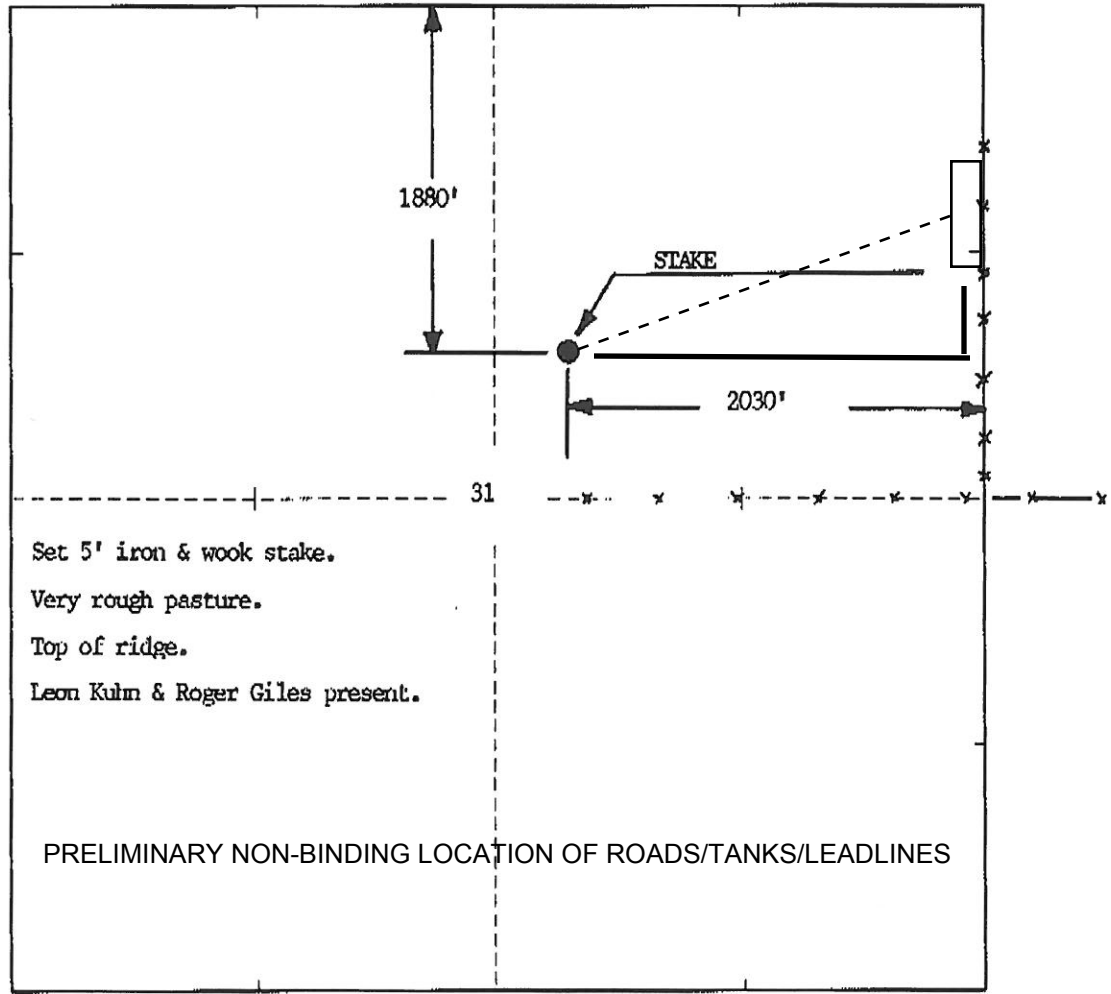

DATE STAKED 05/11/2012