

T33S, R7W, 6th P.M.

SCOMI

U.S. Alum. Cap.
8" Below Ground
NAD 27 Kansas South
N: 1927931.4
E: 2123701.91

S89°36'45"W - 2674.89' (Meas.)

S89°31'01"W - 2677.93' (Meas.)

1/2" Rebar 0.4' Below
Ground
NAD 27 Kansas South
N: 1929551.8
E: 2129054.39

Found Stone
0.1' Below Ground
NAD 27 Kansas South
N: 192822.41
E: 2128378.66

U.S. Alum. Cap.
10" Below Ground
NAD 27 Kansas South
N: 1902177.7
E: 2129028.93

N00°47'32"E - 2638.50' (Meas.)

N00°47'28"E - 2645.12' (Meas.)

1/2" Rebar 1.0'
Below Ground in
Gravel Road Intersection
NAD 27 Kansas South
N: 185321.4
E: 2129028.45

Found Stone,
Iron Bar 2.5'
Below Ground
NAD 27 Kansas South
N: 187492.64
E: 2123678.13

S89°16'09"W - 2663.94' (Meas.)

S89°29'11"W - 2661.95' (Meas.)

1/2" Rebar 1.3'
Below Ground
NAD 27 Kansas South
N: 187537.73
E: 2128341.70

HUDGENS 3307 #10-1
Elev. Ungraded Ground = 1363'

10

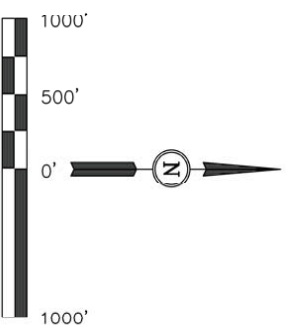

SPOT ELEVATION LOCATED AT THE NORTHEAST CORNER OF SECTION 22, T33S, R7W, 6th P.M. TAKEN FROM THE ANTI-ONY, QUADRANGLE, KANSAS, HARPER COUNTY, 7.5 MINUTE QUAD (TOPOGRAPHIC MAP) PUBLISHED BY THE UNITED STATES DEPARTMENT OF THE INTERIOR, GEOLOGICAL SURVEY. SAID ELEVATION IS MARKED AS BEING 1348 FEET.

BASIS OF ELEVATION

BASIS OF BEARINGS

BASIS OF BEARINGS IS A G.P.S. OBSERVATION.

CERTIFICATE

THIS IS TO CERTIFY THAT THE ABOVE IS A TRUE AND CORRECT COPY OF THE FIELD NOTES OF ACTUAL SURVEY TAKEN BY ME OR UNDER MY SUPERVISION AND THAT THE SAME ARE TRUE AND CORRECT TO THE BEST OF MY KNOWLEDGE AND BELIEF.

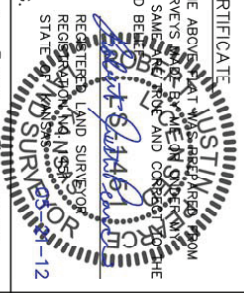

REV: 05-14-12 C.A.G.

UINTAH ENGINEERING & LAND SURVEYING
85 SOUTH 200 EAST - VERNAL, UTAH 84078
(435) 789-1017

LEGEND:		SCALE	DATE SURVEYED:	DATE DRAWN:
—	= 90° SYMBOL	1" = 1000'	04-10-12	04-19-12
●	= PROPOSED WELL HEAD.	PARTY	REFERENCES	
▲	= SECTION CORNERS LOCATED.	J.H. C.M. K.O.	G.L.O. PLAT	
		WEATHER	FILE	
		WARM	SCOMI	

NAD 83 (#10-1 SURFACE LOCATION)	
LATITUDE = 37°10'54.74" (37.181872)	
LONGITUDE = 98°03'40.14" (98.061152)	
NAD 27 (#10-1 SURFACE LOCATION)	
LATITUDE = 37°10'54.66" (37.181850)	
LONGITUDE = 98°03'39.91" (98.061086)	
STATE PLANE NAD 27 (KANSAS SOUTH)	
N: 187893.12 E: 2127956.22	