



APPLICATION FOR COMMINGLING OF PRODUCTION (K.A.R. 82-3-123) OR FLUIDS (K.A.R. 82-3-123a) *Commingling ID # _____*

OPERATOR: License # _____ API No. 15 - _____
Name: _____ Spot Description: _____
Address 1: _____ - - - - - Sec. _____ Twp. _____ S. R. _____ East West
Address 2: _____ Feet from North / South Line of Section
City: _____ State: _____ Zip: _____ + _____ Feet from East / West Line of Section
Contact Person: _____ County: _____
Phone: (_____) _____ Lease Name: _____ Well #: _____

1. Name and upper and lower limit of each production interval to be commingled:
Formation: _____ (Perfs): _____
Formation: _____ (Perfs): _____
Formation: _____ (Perfs): _____
Formation: _____ (Perfs): _____
Formation: _____ (Perfs): _____

2. Estimated amount of fluid production to be commingled from each interval:
Formation: _____ BOPD: _____ MCFPD: _____ BWPD: _____
Formation: _____ BOPD: _____ MCFPD: _____ BWPD: _____
Formation: _____ BOPD: _____ MCFPD: _____ BWPD: _____
Formation: _____ BOPD: _____ MCFPD: _____ BWPD: _____
Formation: _____ BOPD: _____ MCFPD: _____ BWPD: _____

3. Plat map showing the location of the subject well, all other wells on the subject lease, and all wells on offsetting leases within a 1/2 mile radius of the subject well, and for each well the names and addresses of the lessee of record or operator.

4. Signed certificate showing service of the application and affidavit of publication as required in K.A.R. 82-3-135a.

For Commingling of PRODUCTION ONLY, include the following:

- 5. Wireline log of subject well. Previously Filed with ACO-1: Yes No
- 6. Complete Form ACO-1 (*Well Completion form*) for the subject well.

For Commingling of FLUIDS ONLY, include the following:

- 7. Well construction diagram of subject well.
- 8. Any available water chemistry data demonstrating the compatibility of the fluids to be commingled.

AFFIDAVIT: I am the affiant and hereby certify that to the best of my current information, knowledge and personal belief, this request for commingling is true and proper and I have no information or knowledge, which is inconsistent with the information supplied in this application.

Submitted Electronically

KCC Office Use Only
 Denied Approved
15-Day Periods Ends: _____
Approved By: _____ Date: _____

Protests may be filed by any party having a valid interest in the application. Protests must be in writing and comply with K.A.R. 82-3-135b and must be filed within 15 days of publication of the notice of application.



Wellbore Schematic

WELL: Hardin, B 27-1
SSI: 720336
API: 15-205-25665
LOCATION: E2 NW Sec. 27 28S-17E
COUNTY: Wilson
STATE: Kansas

Casing	8.625" 24.75# @ 24' 4.5" 10.5# J-55, 4.05" ID w/ 0.0159 bbl/ft capacity @ 1156'
Perforations	Original Perfs: 12/2/05 & 1/17/06 - Riverton 1100-1102' (9) - Rowe 1049-1051' (9) - Tebo 955-957' (9) - Fleming 846-847' (5) - Croweburg 807-809' (9) - Bevier 789-790' (9) - Mulky 720-724' (17) - Summit 708-712' (17)
Completions	Spud Date: 10/8/03 RV Completion: 1/17/06 - 400 gals 15% HCl - 16.5 BPM - 7,400# 20/40 - 427 bbls fluid BCFT Completion: 1/17/06 - 450 gals 15% HCl - 14.8 BPM - 9,500# 20/40 - 564 bbls fluid SM Completion: 1/18/06 - 400 gals 15% HCl - 16.5 BPM - 3,300# 20/40 - 254 bbls fluid

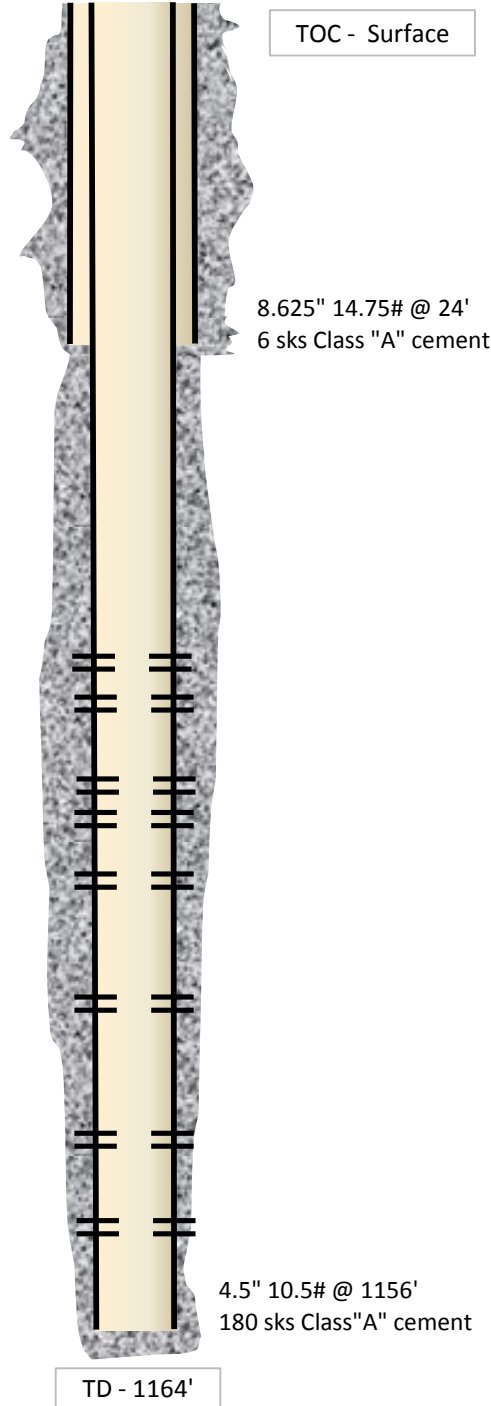

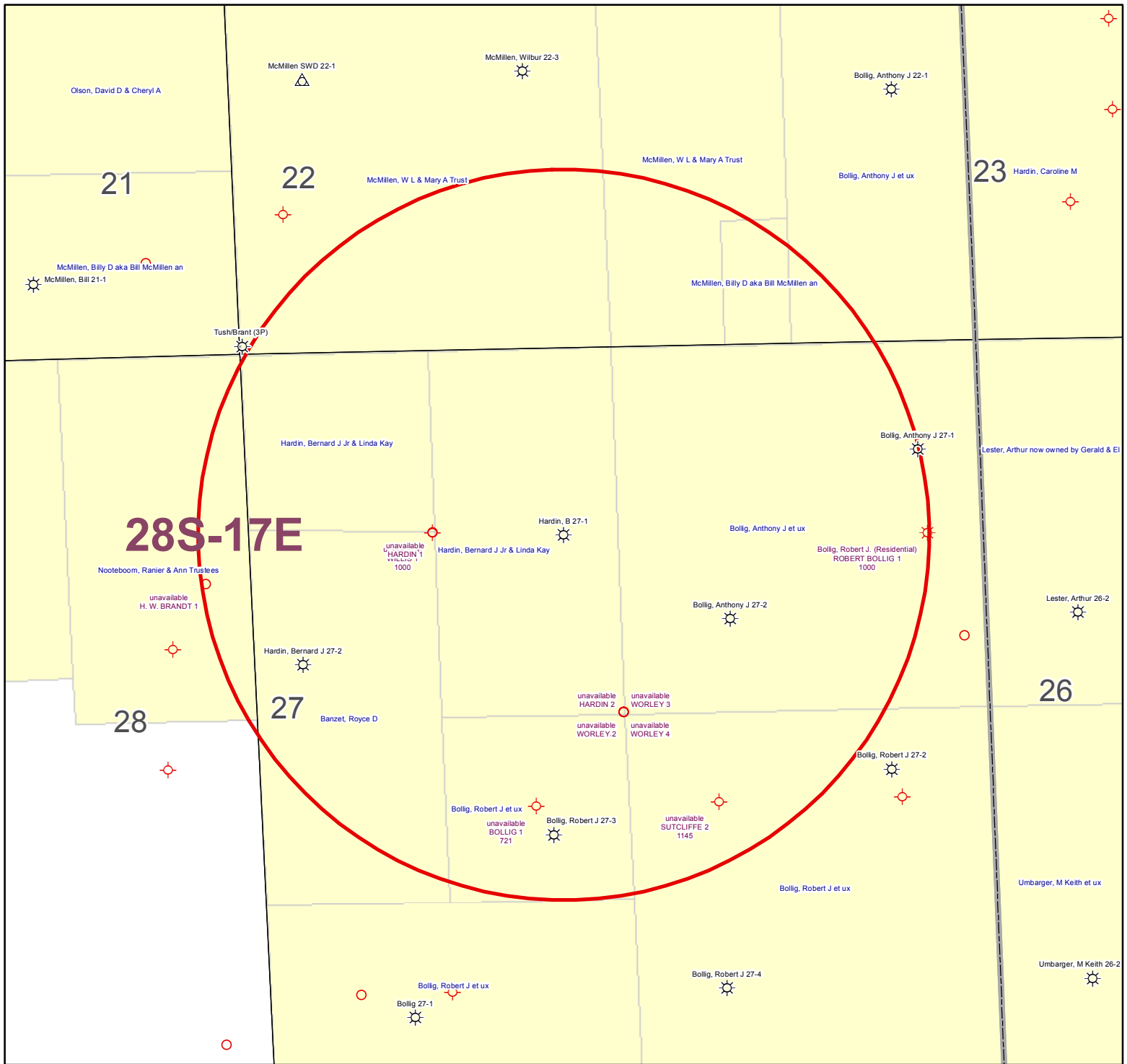

KGS STATUS

	DA/PA
	EOR
	GAS
	INJ/SWD
	OIL
	OIL/GAS
	OTHER

Hardin, B 27-1
 27-28S-17E
 1" = 1,000'

	A	B	C	D	E	F	G	H	I	J	K	
1	Produced Fluids #		1	2	3	4	5		Click here to run SSP Goal Seek SSP		Click	
2	Parameters	Units	Input	Input	Input	Input	Input					Click
3	Select the brines	Select fluid	<input checked="" type="checkbox"/>	<input checked="" type="checkbox"/>	<input checked="" type="checkbox"/>	<input checked="" type="checkbox"/>	<input checked="" type="checkbox"/>	Mixed brine:				
4	Sample ID	by checking						Cell H28 is				
5	Date	the box(es),	3/19/2012	3/4/2012	3/14/2012	1/20/2012	1/20/2012	STP calc. pH.				
6	Operator	Row 3	PostRock	PostRock	PostRock	PostRock	PostRock	Cells H35-38				Click
7	Well Name		Ward Feed	Ward Feed	Clinesmith	Clinesmith	Clinesmith	are used in				Click
8	Location		#34-1	#4-1	#5-4	#1	#2	mixed brines				
9	Field		CBM	CBM	Bartles	Bartles	Bartles	calculations.				
10	Na ⁺	(mg/l)*	19,433.00	27,381.00	26,534.00	25689.00	24220.00	24654.20	Initial(BH)	Final(WH)	SI/SR (Final-Initial)	
11	K ⁺ (if not known =0)	(mg/l)						0.00	Saturation Index values			
12	Mg ²⁺	(mg/l)	1,096.00	872.00	1,200.00	953.00	858.00	995.91	Calcite			
13	Ca ²⁺	(mg/l)	1,836.00	2,452.00	2,044.00	1920.00	1948.00	2040.23	-0.73	-0.60	0.13	
14	Sr ²⁺	(mg/l)						0.00	Barite			
15	Ba ²⁺	(mg/l)						0.00				
16	Fe ²⁺	(mg/l)	40.00	21.00	18.00	82.00	90.00	50.21	Halite			
17	Zn ²⁺	(mg/l)						0.00	-1.77	-1.80	-0.03	
18	Pb ²⁺	(mg/l)						0.00	Gypsum			
19	Cl ⁻	(mg/l)	36,299.00	48,965.00	47,874.00	45632.00	43147.00	44388.44	-3.19	-3.18	0.00	
20	SO ₄ ²⁻	(mg/l)	1.00	1.00	8.00	1.00	1.00	2.40	Hemihydrate			
21	F ⁻	(mg/l)						0.00	-3.96	-3.90	0.06	
22	Br ⁻	(mg/l)						0.00	Anhydrite			
23	SiO ₂	(mg/l) SiO ₂						0.00	-3.47	-3.36	0.12	
24	HCO ₃ Alkalinity**	(mg/l as HCO ₃)	190.00	234.00	259.00	268.00	254.00	241.03	Celestite			
25	CO ₃ Alkalinity	(mg/l as CO ₃)										
26	Carboxylic acids**	(mg/l)						0.00	Iron Sulfide			
27	Ammonia	(mg/L) NH ₃						0.00	-0.16	-0.22	-0.06	
28	Borate	(mg/L) H ₃ BO ₃						0.00	Zinc Sulfide			
29	TDS (Measured)	(mg/l)						72781				
30	Calc. Density (STP)	(g/ml)	1.038	1.051	1.050	1.048	1.045	1.047	Calcium fluoride			
31	CO ₂ Gas Analysis	(%)	19.97	18.76	22.41	35.53	33.79	26.16				
32	H ₂ S Gas Analysis***	(%)	0.0289	0.0292	0.0296	0.0306	0.0151	0.0269	Iron Carbonate			
33	Total H ₂ Saq	(mgH ₂ S/l)	1.00	1.00	1.00	1.00	0.50	0.90	-0.74	-0.51	0.23	
34	pH _i measured (STP)	pH	5.67	5.76	5.72	5.54	5.55	5.63	Inhibitor needed (mg/L)			
35	Choose one option to calculate SI?	0-CO ₂ %+Alk, 1-pH+Alk, 2-CO ₂ %+pH	0	0	0	0	0	0	Calcite	NTMP		
36	Gas/day(thousand cf/day)	(Mc/D)						0	0.00	0.00		
37	Oil/Day	(B/D)	0	0	1	1	1	4	Barite	BHPMP		
38	Water/Day	(B/D)	100	100	100	100	100	500	0.00	0.00		
39	For mixed brines, enter values for temperatures and pressures in Cells (H40-H43)							(Enter H40-H43)	pH			
40	Initial T	(F)	66.0	71.0	70.0	41.0	49.0	60.0	5.69	5.60		
41	Final T	(F)	66.0	71.0	70.0	41.0	49.0	89.0	Viscosity (CentiPoise)			
42	Initial P	(psia)	25.0	25.0	25.0	25.0	25.0	25.0	1.196	0.826		
43	Final P	(psia)	25.0	25.0	25.0	25.0	25.0	120.0	Heat Capacity (cal/ml/°C)			
44	Use TP on Calcite sheet?	1-Yes;0-No							0.955	0.959		
45	API Oil Grav.	API grav.						30.00	Inhibitor needed (mg/L)			
46	Gas Sp.Grav.	Sp.Grav.						0.60	Gypsum	HDTMP		
47	MeOH/Day	(B/D)	0					0	0.00	0.00		
48	MEG/Day	(B/D)	0					0	Anhydrite	HDTMP		
49	Conc. Multiplier								0.00	0.00		
50	H ⁺ (Strong acid) [†]	(N)										
51	OH ⁻ (Strong base) [†]	(N)										
52	Quality Control Checks at STP:											
53	H ₂ S Gas	(%)										
54	Total H ₂ Saq (STP)	(mgH ₂ S/l)										
55	pH Calculated	(pH)										
56	PCO ₂ Calculated	(%)										
57	Alkalinity Cacluated	(mg/l) as HCO ₃										
58	ΣCations=	(equiv./l)										
59	ΣAnions=	(equiv./l)										
60	Calc TDS=	(mg/l)										
61	Inhibitor Selection	Input	Unit	#	Inhibitor	Unit Converter (From metric to English)						
62	Protection Time	120	min	1	NTMP	From Unit	Value	To Unit	Value			
63	Have ScaleSoftPitzer			2	BHPMP	°C	80	°F	176			
64	pick inhibitor for you?	1	1-Yes;0-No	3	PAA	m ³	100	ft ³	3,531			
65	If No, inhibitor # is:	4	#	4	DTPMP	m ³	100	bb(42 US gal)	629			
66	If you select Mixed,			5	PPCA	MPa	1,000	psia	145,074			
67	1 st inhibitor # is:	1	#	6	SPA	Bar	496	psia	7,194			
68	% of 1 st inhibitor is:	50	%	7	HEDP	Torr	10,000	psia	193			
69	2 nd inhibitor # is:	2	#	8	HDTMP	Gal	10,000	bb(42 US gal)	238			
70	Display act. coeffs?	0	1-Yes;0-No	9	Average	Liters	10,000	bb(42 US gal)	63			
71				10	Mixed							

Saturation Index Calculations

Champion Technologies, Inc.
(Based on the Tomson-Oddo Model)

Brine 1: Ward Feed Yard 34-1

Brine 2: Ward Feed Yard 4-1

Brine 3: Clinesmith 5-4

Brine 4: Clinesmith 1

Brine 5: Clinesmith 2

Component (mg/L)	Ratio					Mixed Brine
	20% Brine 1	20% Brine 2	20% Brine 3	20% Brine 4	20 Brine 5	
Calcium	1836	2452	2044	1920	1948	1952
Magnesium	1096	872	1200	953	858	865
Barium	0	0	0	0	0	0
Strontium	0	0	0	0	0	0
Bicarbonate	190	234	259	268	254	253
Sulfate	1	1	8	1	1	1
Chloride	36299	48965	47874	45632	43147	43206
CO ₂ in Brine	246	220	264	422	405	401
Ionic Strength	1.12	1.48	1.46	1.38	1.31	1.31
Temperature (°F)	89	89	89	89	89	89
Pressure (psia)	50	50	120	120	120	119

Saturation Index

Calcite	-1.71	-1.41	-1.48	-1.68	-1.69	-1.69
Gypsum	-3.71	-3.64	-2.82	-3.73	-3.72	-3.69
Hemihydrate	-3.70	-3.65	-2.83	-3.74	-3.71	-3.69
Anhydrite	-3.89	-3.79	-2.97	-3.89	-3.88	-3.85
Barite	N/A	N/A	N/A	N/A	N/A	N/A
Celestite	N/A	N/A	N/A	N/A	N/A	N/A

PTB

Calcite	N/A	N/A	N/A	N/A	N/A	N/A
Gypsum	N/A	N/A	N/A	N/A	N/A	N/A
Hemihydrate	N/A	N/A	N/A	N/A	N/A	N/A
Anhydrite	N/A	N/A	N/A	N/A	N/A	N/A
Barite	N/A	N/A	N/A	N/A	N/A	N/A
Celestite	N/A	N/A	N/A	N/A	N/A	N/A

KANSAS CORPORATION COMMISSION
OIL & GAS CONSERVATION DIVISION

Form ACO-1
September 1999
Form Must Be Typed

WELL COMPLETION FORM
WELL HISTORY - DESCRIPTION OF WELL & LEASE

Operator: License # 31796
 Name: Quest Energy Service, Inc.
 Address: P.O. Box 100
 City/State/Zip: Benedict, KS 66714
 Purchaser: Quest Energy Service, Inc.
 Operator Contact Person: Douglas L. Lamb
 Phone: (620) 698-2250
 Contractor Name: James D. Lorenz
 License: 9313
 Wellsite Geologist: Mike Ebers
 Designate Type of Completion:
 New Well Re-Entry Workover
 Oil SWD SIOW Temp. Abd.
 Gas ENHR SIGW
 Dry Other (Core, WSW, Expl., Cathodic, etc)
 If Workover/Re-entry: Old Well Info as follows:
 Operator: _____
 Well Name: _____
 Original Comp. Date: _____ Original Total Depth: _____
 Deepening Re-perf. Conv. to Enhr./SWD
 Plug Back Plug Back Total Depth
 Commingled Docket No. _____
 Dual Completion Docket No. _____
 Other (SWD or Enhr.?) Docket No. _____

<u>10-8-03</u>	<u>10-10-03</u>	<u>11-5-03</u>
Spud Date or Recompletion Date	Date Reached TD	Completion Date or Recompletion Date

RECEIVED
FEB 09 2004
KCC WICHITA

API No. 15 - 205-25,665-0000
 County: Wilson
 E2 E2 NW 4 Sec. 27 Twp. 28 S. R. 17 East West
1320 feet from S / N (circle one) Line of Section
2280 feet from E / W (circle one) Line of Section
 Footages Calculated from Nearest Outside Section Corner:
 (circle one) NE SE NW SW
 Lease Name: B. Hardin Well #: 27-1
 Field Name: Cherokee Basin CBM
 Producing Formation: Not completed into producing zone
 Elevation: Ground: 990 Kelly Bushing: _____
 Total Depth: 1164 Plug Back Total Depth: 1155.5'
 Amount of Surface Pipe Set and Cemented at: 24 Feet
 Multiple Stage Cementing Collar Used? Yes No
 If yes, show depth set _____ Feet
 If Alternate II completion, cement circulated from: 1155.5'
 feet depth to: surface w/ 180 sx cmt.

ORIGINAL

Drilling Fluid Management Plan *Alten 3-17-04*
 (Data must be collected from the Reserve Pit)
 Chloride content _____ ppm Fluid volume _____ bbls
 Dewatering method used Air Drilled
 Location of fluid disposal if hauled offsite: _____
 Operator Name: _____
 Lease Name: _____ License No.: _____
 Quarter _____ Sec. _____ Twp. _____ S. R. _____ East West
 County: _____ Docket No.: _____

INSTRUCTIONS: An original and two copies of this form shall be filed with the Kansas Corporation Commission, 130 S. Market - Room 2078, Wichita, Kansas 67202, within 120 days of the spud date, recompletion, workover or conversion of a well. Rule 82-3-130, 82-3-106 and 82-3-107 apply. Information of side two of this form will be held confidential for a period of 12 months if requested in writing and submitted with the form (see rule 82-3-107 for confidentiality in excess of 12 months). One copy of all wireline logs and geologist well report shall be attached with this form. ALL CEMENTING TICKETS MUST BE ATTACHED. Submit CP-4 form with all plugged wells. Submit CP-111 form with all temporarily abandoned wells.

All requirements of the statutes, rules and regulations promulgated to regulate the oil and gas industry have been fully complied with and the statements herein are complete and correct to the best of my knowledge.

Signature: Douglas L. Lamb
 Title: President Date: 2/4/04
 Subscribed and sworn to before me this 4th day of February,
20 04
 Notary Public: Pamela G. Graves
 Date Commission Expires: 6/4/05

PAMELA G. GRAVES
 Notary Public - State of Kansas
 My Appt. Expires 6/4/05

KCC Office Use ONLY

Letter of Confidentiality Attached
 If Denied, Yes Date: _____
 Wireline Log Received
 Geologist Report Received
 UIC Distribution

X

Operator Name: Quest Energy Service, Inc. Lease Name: B. Hardin Well #: 27-1
 Sec. 27 Twp. 28 S. R. 17 East West County: Wilson

INSTRUCTIONS: Show important tops and base of formations penetrated. Detail all cores. Report all final copies of drill stems tests giving interval tested, time tool open and closed, flowing and shut-in pressures, whether shut-in pressure reached static level, hydrostatic pressures, bottom hole temperature, fluid recovery, and flow rates if gas to surface test, along with final chart(s). Attach extra sheet if more space is needed. Attach copy of all Electric Wireline Logs surveyed. Attach final geological well site report.

Drill Stem Tests Taken Yes No
(Attach Additional Sheets)

Samples Sent to Geological Survey Yes No

Cores Taken Yes No

Electric Log Run Yes No
(Submit Copy)

List All E. Logs Run:
Density - Neutron, Dual Induction - Guard

<input checked="" type="checkbox"/> Log	Formation (Top), Depth and Datum	<input checked="" type="checkbox"/> Sample
Name	Top	Datum
Lenapah Lime	474'	+516'
Altamont Lime	508'	+482'
Pawnee Lime	645'	+345'
Oswego Lime	686'	+304'
Verdegris Lime	804'	+186'
Mississippi Lime	1114'	-124'

CASING RECORD <input type="checkbox"/> New <input type="checkbox"/> Used							
Report all strings set-conductor, surface, intermediate, production, etc.							
Purpose of String	Size Hole Drilled	Size Casing Set (In O.D.)	Weight Lbs. / Ft.	Setting Depth	Type of Cement	# Sacks Used	Type and Percent Additives
Surface	11.00"	8.625"	24.75	24'	"A"	6	
Production	6.75"	4.50"	10.50	1155.5'	"A"	180	

ADDITIONAL CEMENTING / SQUEEZE RECORD				
Purpose:	Depth Top Bottom	Type of Cement	#Sacks Used	Type and Percent Additives
<input type="checkbox"/> Perforate				
<input type="checkbox"/> Protect Casing				
<input type="checkbox"/> Plug Back TD				
<input type="checkbox"/> Plug Off Zone				

Shots Per Foot	PERFORATION RECORD - Bridge Plugs Set/Type Specify Footage of Each Interval Perforated	Acid, Fracture, Shot, Cement Squeeze Record (Amount and Kind of Material Used)	Depth
None	Waiting on Pipeline		

TUBING RECORD		Size	Set At	Packer At	Liner Run <input type="checkbox"/> Yes <input type="checkbox"/> No
Date of First, Resumerd Production, SWD or Enhr.		Producing Method <input type="checkbox"/> Flowing <input type="checkbox"/> Pumping <input type="checkbox"/> Gas Lift <input type="checkbox"/> Other (Explain)			
Estimated Production Per 24 Hours	Oil Bbbs.	Gas Mcf	Water Bbbs.	Gas-Oil Ratio	Gravity

Disposition of Gas Vented Sold Used on Lease *(If vented, Submit ACO-18.)*

METHOD OF COMPLETION Open Hole Perf. Dually Comp. Commingled Other (Specify)

Production Interval

RECEIVED
FEB 09 2004
KCC WICHITA

AFFIDAVIT

STATE OF KANSAS \
- SS.
County of Sedgwick /

Mark Fletchall, of lawful age, being first duly sworn, depose and saith: That he is Record Clerk of The Wichita Eagle, a daily newspaper published in the City of Wichita, County of Sedgwick, State of Kansas, and having a general paid circulation on a daily basis in said County, which said newspaper has been continuously and uninterruptedly published in said County for more than one year prior to the first publication of the notice hereinafter mentioned, and which said newspaper has been entered as second class mail matter at the United States Post Office in Wichita, Kansas, and which said newspaper is not a trade, religious or fraternal publication and that a notice of a true copy is hereto attached was published in the regular and entire Morning issue of said The Wichita Eagle for _1_ issues, that the first publication of said notice was

made as aforesaid on the 21st of

June A.D. 2012, with

subsequent publications being made on the following dates:

And affiant further says that he has personal knowledge of the statements above set forth and that they are true.

Mark Fletchall

Subscribed and sworn to before me this

21st day of June, 2012



Penny L. Case
Notary Public Sedgwick County, Kansas

Printer's Fee : \$132.40

LEGAL PUBLICATION

PUBLISHED IN THE WICHITA EAGLE
JUNE 21, 2012 (3191674)
BEFORE THE STATE CORPORATION
COMMISSION OF THE STATE OF KANSAS
NOTICE OF FILING APPLICATION

RE: In the Matter of Postrock Midcontinent Production, LLC Application for Commingling of Production in the Hardin, B 27-1 located in Wilson County, Kansas.
TO: All Oil & Gas Producers, Unleased Mineral Interest Owners, Landowners, and all persons whomsoever concerned.

You, and each of you, are hereby notified that Postrock Midcontinent Production, LLC has filed an application to commingle the Riverton, Rowe, Tebo, Fleming, Croweburg, Bevier, Mulky, Summit and Bartlesville producing formations at the Hardin, B 27-1 located in the E2 E2 NW, S27-T28S-R17E, Approximately 1350 FNL & 2274 FWL, Wilson County, Kansas.

Any persons who object to or protest this application shall be required to file their objections or protest with the Conservation Division of the State Corporation Commission of the State of Kansas within fifteen (15) days from the date of this publication. These protests shall be filed pursuant to Commission regulations and must state specific reasons why granting the application may cause waste, violate correlative rights or pollute the natural resources of the State of Kansas.

All persons interested or concerned shall take notice of the foregoing and shall govern themselves accordingly. All person and/or companies wishing to protest this application are required to file a written protest with the Conservation Division of the Kansas Oil and Gas Commission.

Upon the receipt of any protest, the Commission will convene a hearing and protestants will be expected to enter an appearance either through proper legal counsel or as individuals, appearing on their own behalf.

Postrock Midcontinent Production, LLC
210 Park Avenue, Suite 2750
Oklahoma City, Oklahoma 73102
(405) 660-7704

PROOF OF PUBLICATION

STATE OF KANSAS
Wilson County - SS

JOSEPH S. and RITA M. RELPH, of lawful age, being duly sworn upon oath that they are the Owners and Publishers of the WILSON COUNTY CITIZEN:

THAT said newspaper has been published at least weekly fifty (50) times a year and has been so published for at least five years prior to the first publication of the attached notice:

THAT said newspaper is a general circulation on a daily, or weekly, or monthly, or yearly basis in;

WILSON COUNTY, KANSAS and is NOT a trade, religious or fraternal publication and has been PRINTED and PUBLISHED in Wilson County, Kansas.

THE ATTACHED was published on the following dates in a regular issue of said newspaper:

1st publication was made on the 18th day of June, 2012

2nd publication was made on the _____ day of _____, 20_____

3rd publication was made on the _____ day of _____, 20_____

4th publication was made on the _____ day of _____, 20_____

5th publication was made on the _____ day of _____, 20_____

6th publication was made on the _____ day of _____, 20_____

TOTAL PUBLICATION FEE: \$ 3850

(Signed) Joseph S. Relph

Subscribed and sworn to before me, this 19th day of June, 2012

Rita M. Relph (Notary Public)

My commission expires Aug. 30, 2014

(Published in the Wilson County Citizen on Monday, June 18, 2012.)

BEFORE THE STATE CORPORATION COMMISSION OF THE STATE OF KANSAS

NOTICE OF FILING APPLICATION

RE: In the Matter of Postrock Midcontinent Production, LLC Application for Commingling of Production in the Hardin, B 27-1 located in Wilson County, Kansas

TO: All Oil & Gas Producers, Unleased Mineral Interest Owners, Landowners, and all persons whomever concerned

You, and each of you, are hereby notified that Postrock Midcontinent Production, LLC has filed an application to commingle the Riverton, Rowe, Tebo, Fleming, Croweburg, Bevier, Mulky, Summit and Bartlesville producing formations at the Hardin, B 27-1 located in the E2 E2 NW, S27-T28S-R17E, Approximately 1350 FNL & 2274 FWL, Wilson County, Kansas

Any persons who object to or protest this application shall be required to file their objections or protest with the Conservation Division of the State Corporation Commission of the State of Kansas within fifteen (15) days from the date of this publication. These protests shall be filed pursuant to Commission regulations and must state specific reasons why granting the application may cause waste, violate correlative rights or pollute the natural resources of the State of Kansas.

All persons interested or concerned shall take notice of the foregoing and shall govern themselves accordingly. All person and/or companies wishing to protest this application are required to file a written protest with the Conservation Division of the Kansas Oil and Gas Commission.

Upon the receipt of any protest, the Commission will convene a hearing and protestants will be expected to enter an appearance either through proper legal counsel or as individuals, appearing on their own behalf

Postrock Midcontinent Production, LLC
210 Park Avenue, Suite 2750
Oklahoma City, Oklahoma 73102
(405) 660-7704

35 1 cpy



Affidavit of Notice Served

Re: Application for: APPLICATION FOR COMMINGLING OF PRODUCTION OR FLUIDS ACO-4

Well Name: HARDIN, B 27-1 Legal Location: E2E2NW S27-T28S-R17E

The undersigned hereby certifies that he / she is a duly authorized agent for the applicant, and that on the day 7TH of AUGUST, 2012, a true and correct copy of the application referenced above was delivered or mailed to the following parties:

Note: A copy of this affidavit must be served as a part of the application.

Name

Address (Attach additional sheets if necessary)

ROBERT J BOLLIG

14374 ANDERSON RD, CHANUTE, KS 66720

THOMAS R & JANET L ERBE

21184 800 RD, ALTOONA, KS 66710

I further attest that notice of the filing of this application was published in the WILSON COUNTY CITIZEN, the official county publication of WILSON county. A copy of the affidavit of this publication is attached.

Signed this 7TH day of AUGUST, 2012

[Signature]
Applicant or Duly Authorized Agent

Subscribed and sworn to before me this 7th day of AUGUST, 2012



[Signature]
Notary Public

My Commission Expires: [Signature]

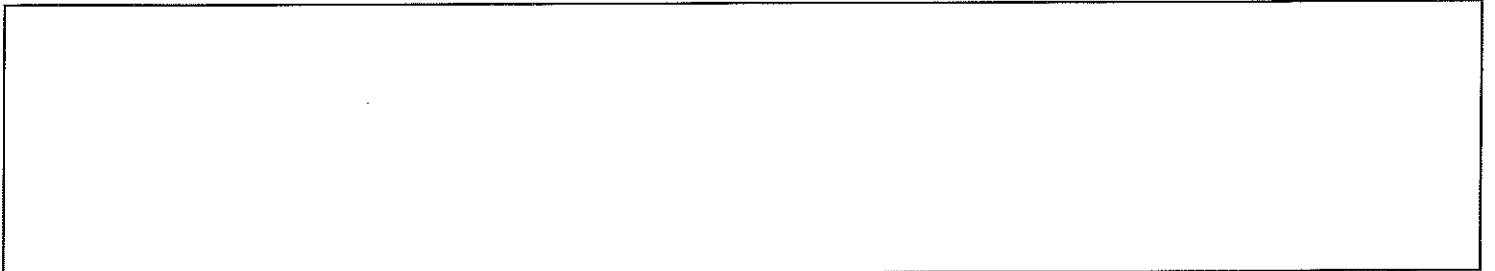

HARDIN, B 27-1 - APPLICATION FOR COMMINGLING OF PRODUCTION OR FLUIDS

[Redacted]

[Redacted]

Offset Operators, Unleased Mineral Owners and Landowners acreage
(Attach additional sheets if necessary)

Name:

Legal Description of Leasehold:

ROBERT J BOLLIG

NWNESENE S27-T28S-R17E

THOMAS R & JANET L ERBE

SE/4 LESS 27 ACRE TRAC OF S28-T28S-R17E

I hereby certify that the statements made herein are true and correct to the best of my knowledge and belief.

Jess L. Mairis
Applicant or Duly Authorized Agent

Subscribed and sworn before me this 7th day of AUGUST, 2012



Jennifer R. Beal
Notary Public

My Commission Expires: July 20, 2016

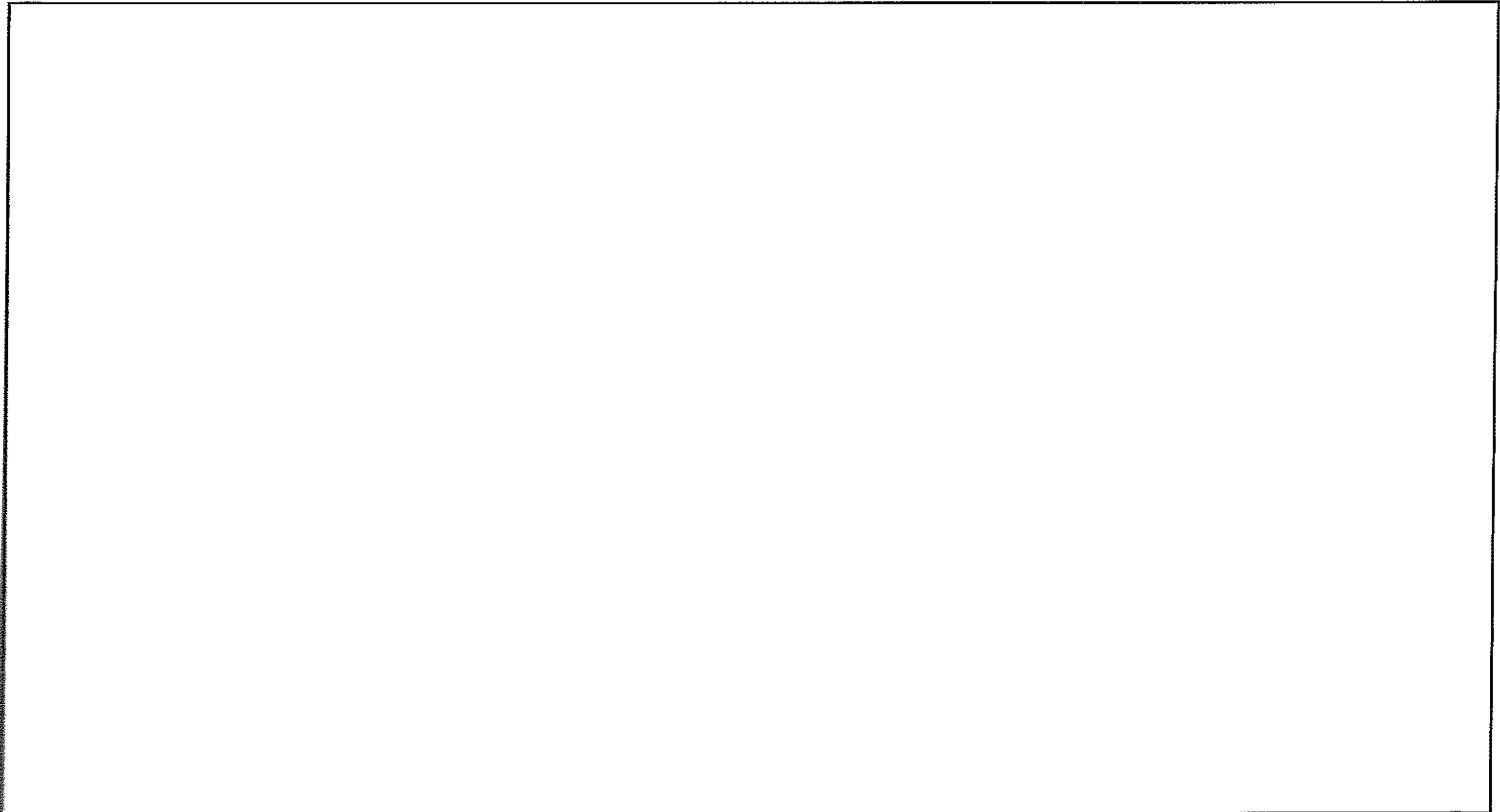

August 22 , 2012

Clark Edwards
PostRock Midcontinent Production LLC
Oklahoma Tower
210 Park Ave, Ste 2750
Oklahoma City, OK 73102

RE: Approved Commingling CO081205
B. Harding 27-1 Sec.27-T28S-R17E, Wilson County
API No. 15-205-25665-00-00

Dear Mr. Edwards:

Your Application for Commingling (ACO-4) for the above described well, received by the KCC on August 9, 2012, has been reviewed and approved by the Kansas Corporation Commission (KCC) per K.A.R. 82-3-123. Notice was examined and found to be proper per K.A.R. 82-3-135a. No protest had been filed within the 15-day protest period.

Based upon the depth of the Riverton formation perforations, total oil production shall not exceed 100 BOPD and total gas production shall not exceed 50% of the absolute open flow (AOF).

File form ACO-1 upon re-completion of the well to commingle.

Commingling ID number CO081205 has been assigned to this approved application. Use this number for well completion reports (ACO-1) and other correspondence that may concern this approved commingling.

Sincerely,

Rick Hestermann
Production Department