



Fall & Associates

Stake and Elevation Service

719 W. 5th Street

P.O. Box 404

Concordia, KS. 66901

1-800-536-2821

Date 6-11-12

Invoice Number 0608121

MURFIN DRILLING

Operator

1-34

Number

Sauvage

Farm Name

Decatur-KS

County-State

34

S

4s

T

30w

R

400' FNL 1440' FWL

Location

2885

Elevation 2985 Gr.

Ordered By: Shauna

Murfin Drilling
250 N. Water, Ste. 300
Wichita, KS. 67202

Scale 1"=1000'

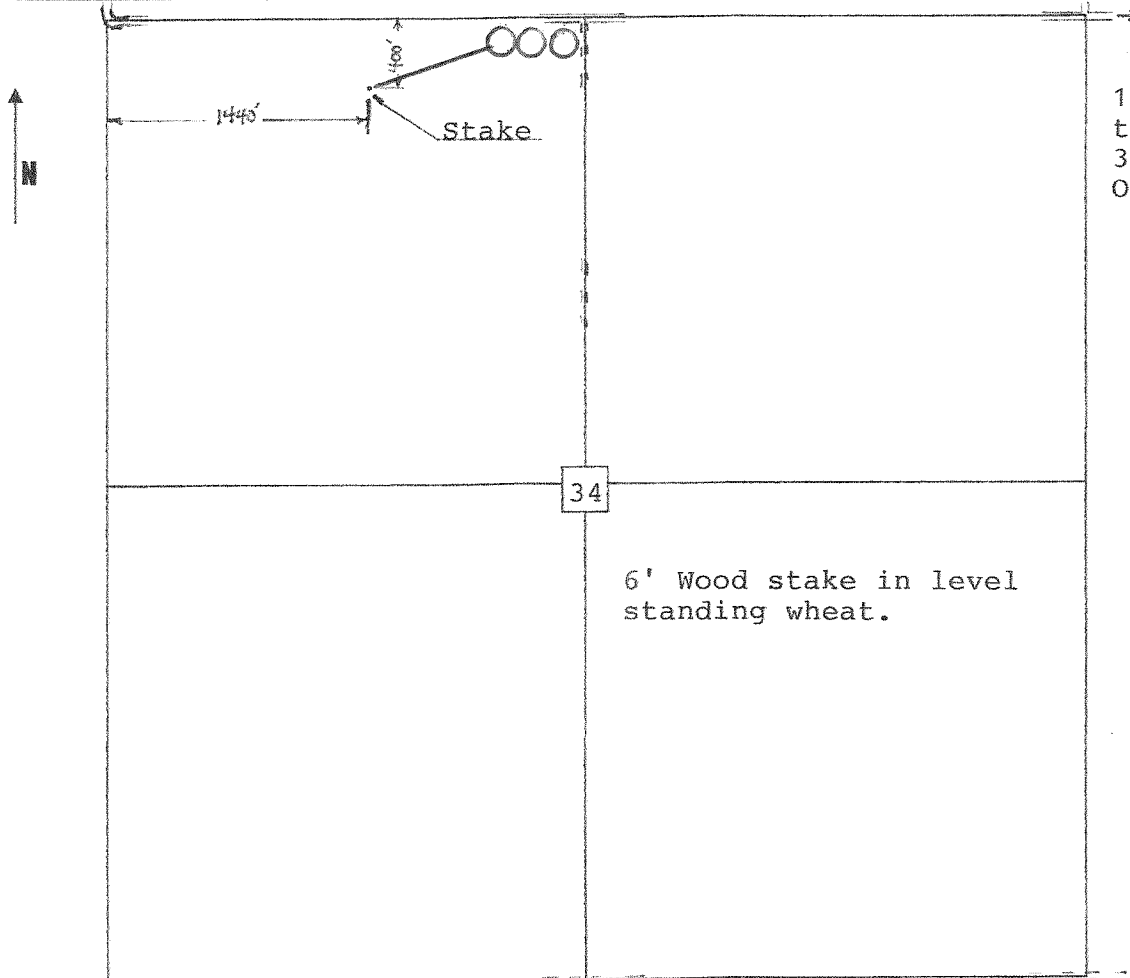

6 mi. E
11 mi. N
to Jct. Hwy
36 & 83 in
Oberlin

6' Wood stake in level
standing wheat.