

Fall & Associates

Stake and Elevation Service

719 W. 5th Street

P.O. Box 404

Concordia, KS. 66901

1-800-536-2821

Date 6-26-12

Invoice Number 0622121

MURFIN DRILLING

Operator

1-30

Number

Hatch

Farm Name

Rawlins-KS

County-State

30

S

1s

T

36w

R

2000' FSL 1950' FEL

Location

Elevation 3323 Gr.

Ordered By: Shauna

Murfin Drilling
250 N. Water, Ste. 300
Wichita, KS. 67202

Scale 1"=1000'

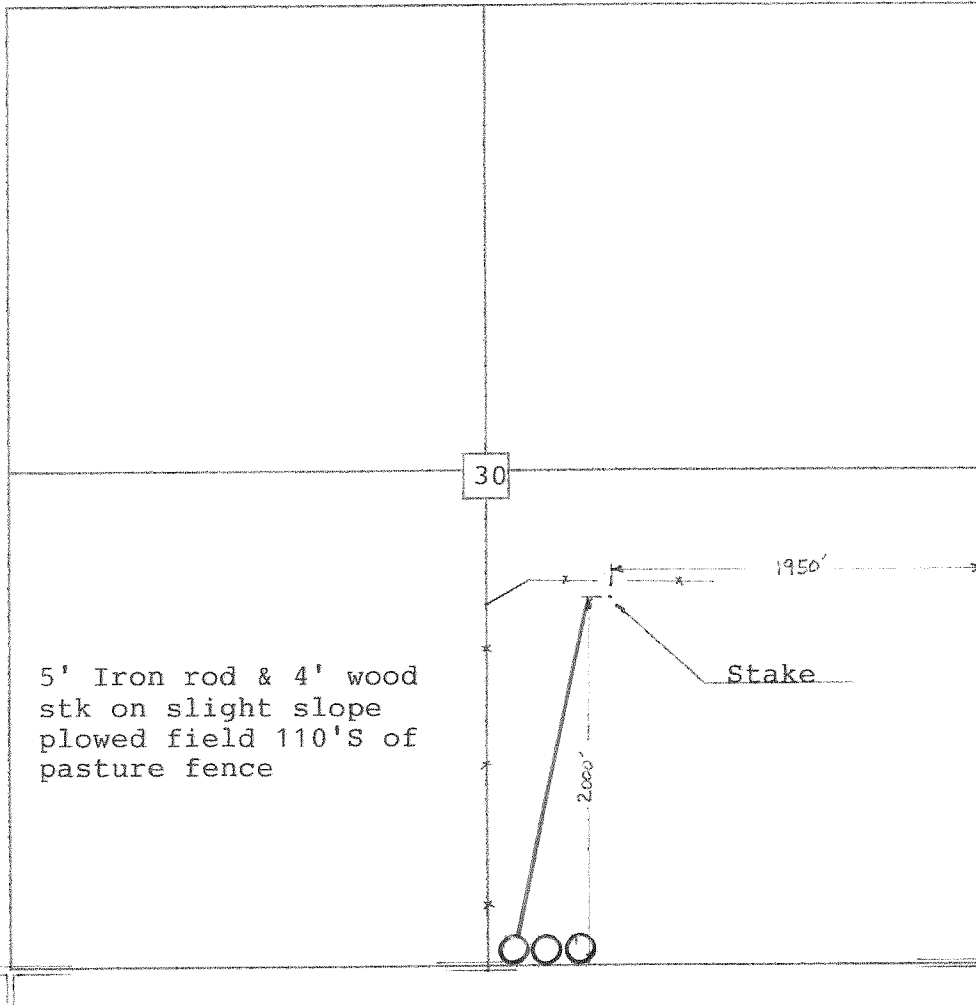

5' Iron rod & 4' wood
stk on slight slope
plowed field 110'S of
pasture fence

1 mi. E
10 mi. S to
McDonald