

Proposed Plan of Construction
 Bosworth B-1
 Sec 27 T22S-R34W
 Finney County, KS

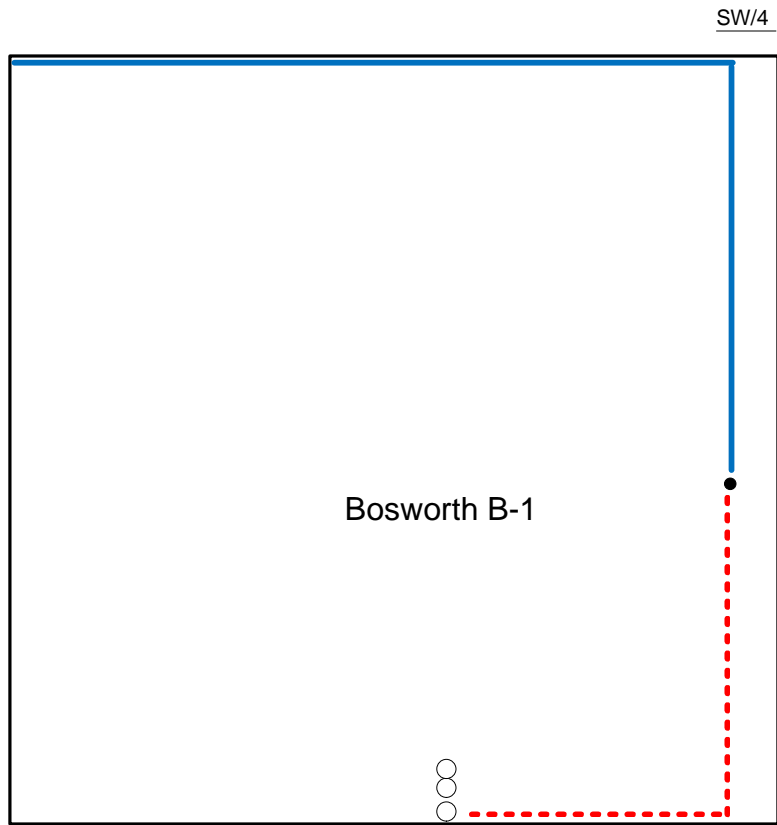
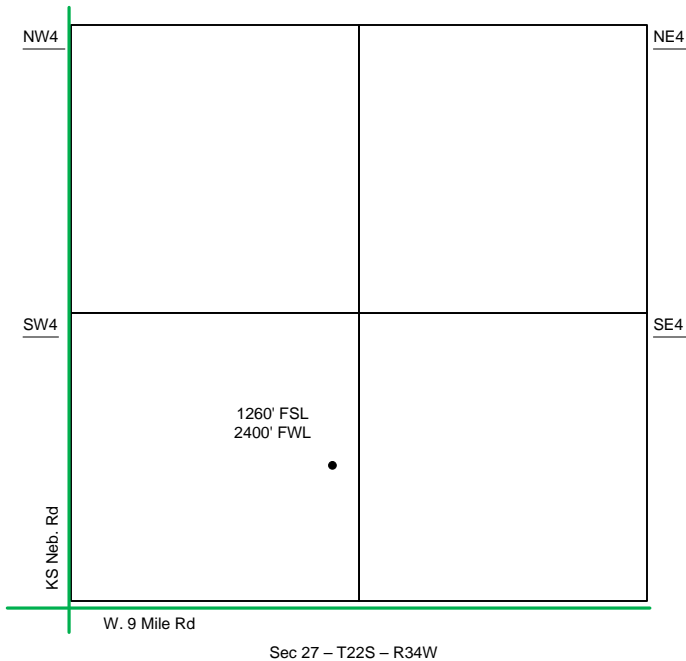

- Well Location
- Proposed Lease Roads
- - - Proposed Pipeline
- Proposed Tank Battery
- Proposed Power Lines
- - - Existing Pipeline

The Tank Battery for the Bosworth B-1 is located in the S of the SW quarter.

Proposed Details of
 SW/4 Sec 27 -T22S -R34W

Note-Drawing **Not** to Scale

Proposed Site Diagram
 Bosworth B-1
 July 9, 2012

