

IN ALL CASES PLOT THE INTENDED WELL ON THE PLAT BELOW

Plat of acreage attributable to a well in a prorated or spaced field

If the intended well is in a prorated or spaced field, please fully complete this side of the form. If the intended well is in a prorated or spaced field complete the plat below showing that the well will be properly located in relationship to other wells producing from the common source of supply. Please show all the wells and within 1 mile of the boundaries of the proposed acreage attribution unit for gas wells and within 1/2 mile of the boundaries of the proposed acreage attribution unit for oil wells.

API No. 15 - _____
 Operator: F.G. Holl Company, L.L.C.
 Lease: PENNER TRUST UNIT
 Well Number: 1-15
 Field: wildcat
 Number of Acres attributable to well: 10
 QTR / QTR / QTR of acreage: E2 - E2 - E2

Location of Well: County: Barton
 _____ 2560 feet from N / S Line of Section
 _____ 333 feet from E / W Line of Section
 Sec. 15 Twp. 20 S. R. 15 East West
 Is Section: Regular or Irregular
 If Section is Irregular, locate well from nearest corner boundary.
 Section corner used: NE NW SE SW

PLAT

(Show location of the well and shade attributable acreage for prorated or spaced wells.)
 (Show footage to the nearest lease or unit boundary line.)

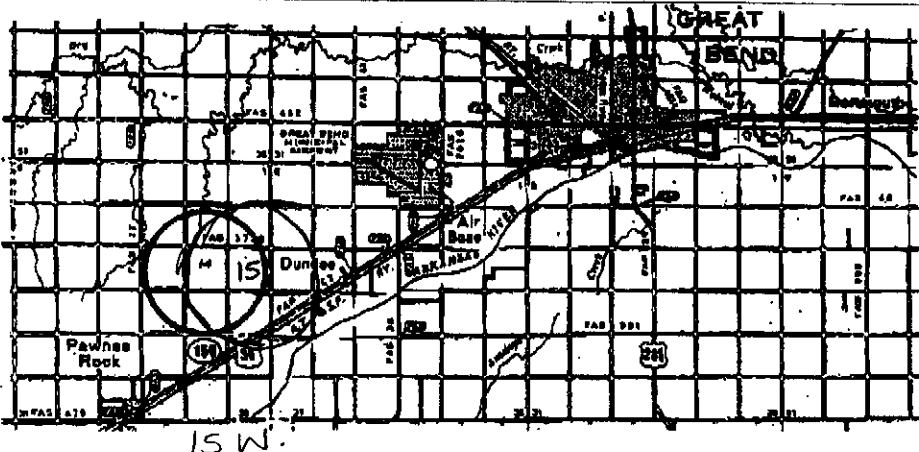
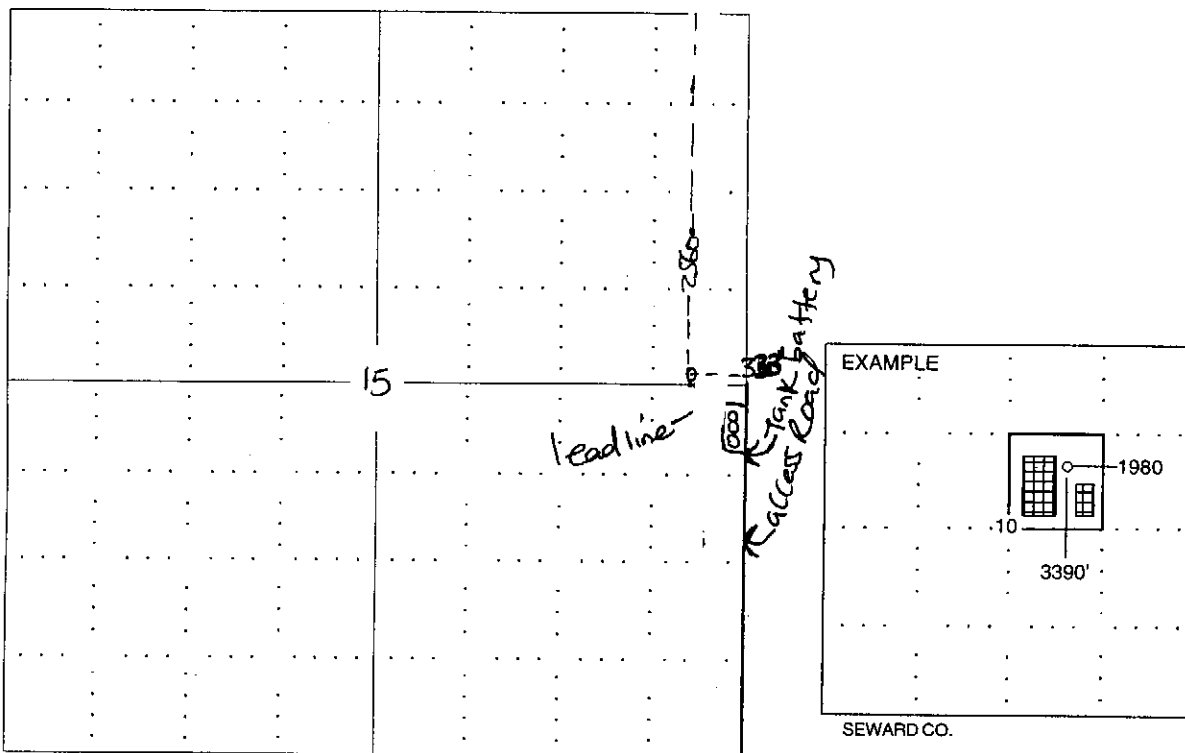

* Elevation data is based upon the best available photogrammetric data and upon a regular section of land containing 640 acres.
 * Dimensions shown were determined using the normal standards of care of oilfield surveys practicing in the State of Kansas. The section corners, which establish the precise section lines, and all necessary features, and the exact location of the drilling location in the section is not guaranteed. Therefore, the liability for errors in this service and updating this plat and all other services calling thereon shall be held against Kansas Oilfield Services, Inc. The operator and employees released from all losses, claims and damages and shall not be liable for any liability, claims, damages or consequential damages.
 * Dimensions derived from National Geodetic Vertical Datum.

Date June 26, 2012