

Proposed Plan of Construction
 Hentschel C-2
 Sec 8 T33S-R42W
 Morton County, KS

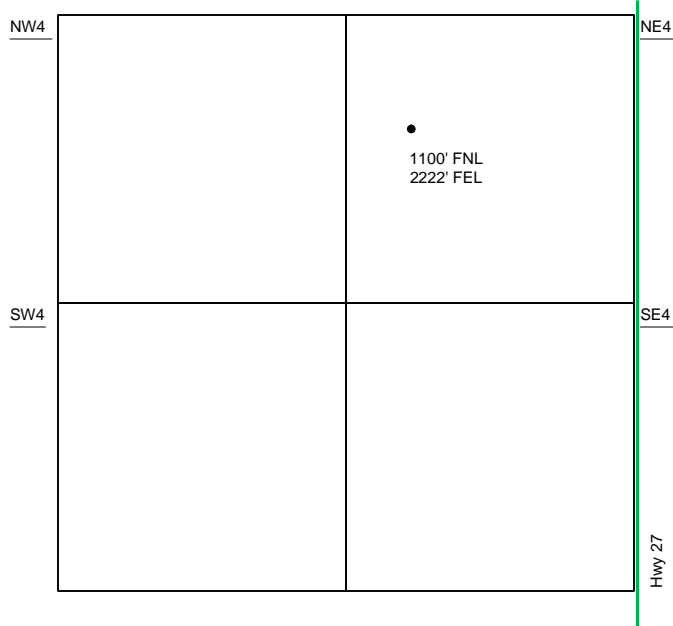

Sec 8 – T33S – R42W

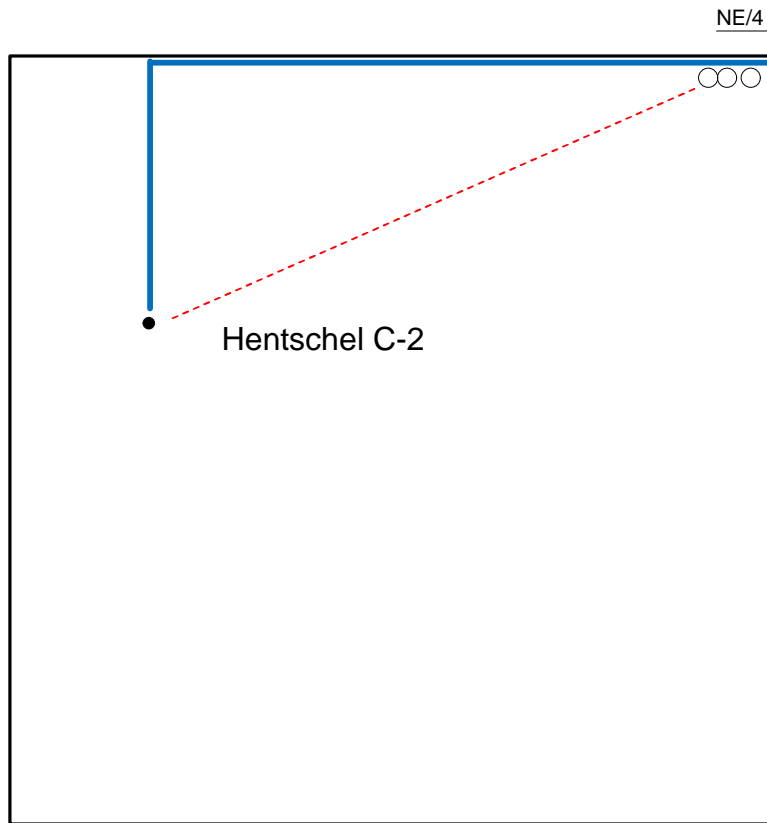

The Tank Battery for the Hentschel C-2 is located in the NE of the NE quarter.

- Well Location
- Proposed Lease Roads
- - - Proposed Pipeline
- Proposed Tank Battery
- Proposed Power Lines
- - - Existing Pipeline

Proposed Details of
 NE/4 Sec 8 -T33S -R42W

Note-Drawing **Not** to Scale

