

SGOMI
LOCATION LAYOUT FOR
SCHUPBACH 3510 #16-1 & #16-1H
SECTION 16, T35S, R10W, 6th P.M.
LOT 1

FIGURE #1
 SCALE: 1" = 100'
 DATE: 07-10-12
 DRAWN BY: C.A.G.
 VERSION: 1.0
 REVISED:
 REVISED BY:

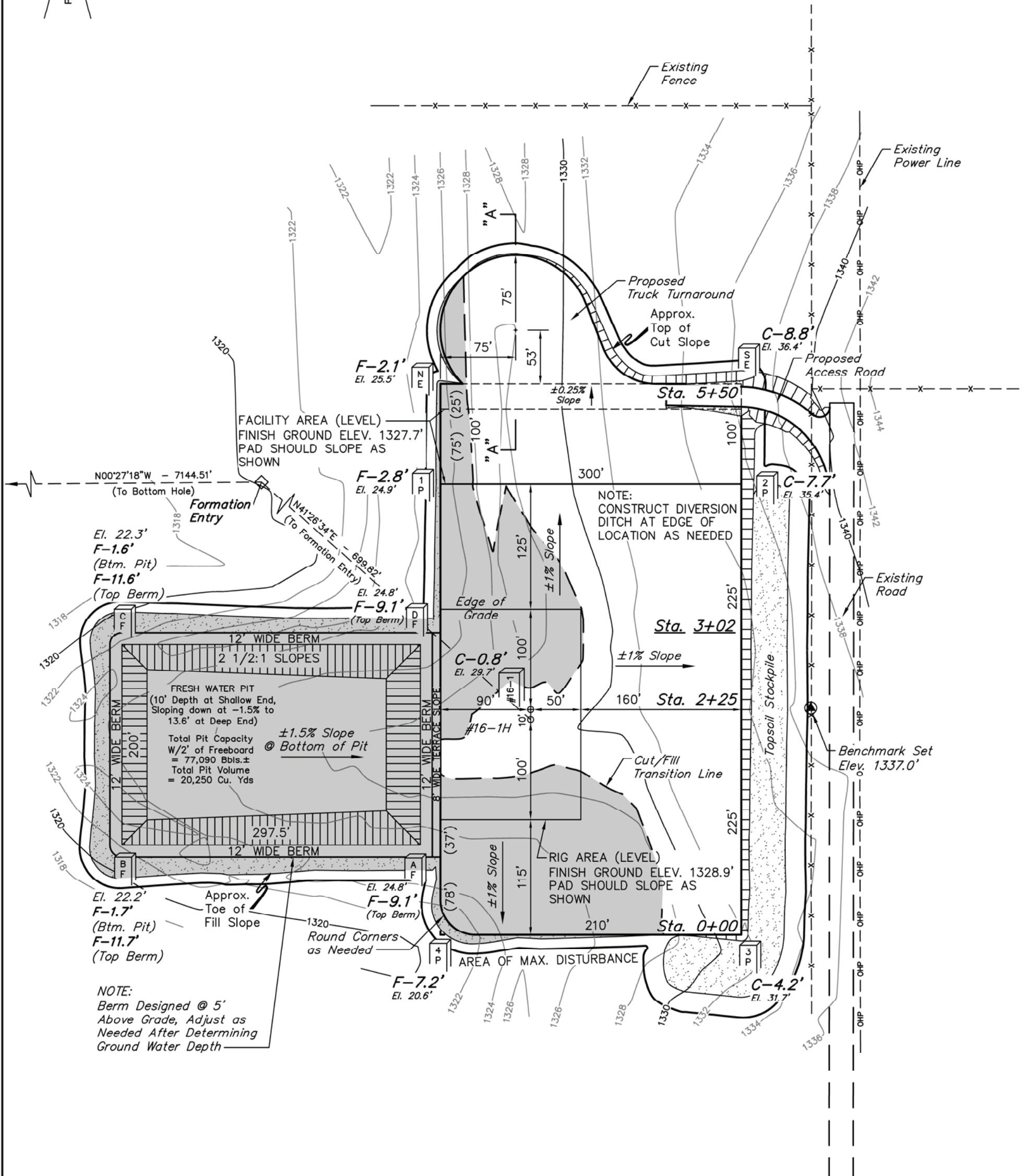

NOTE:
 Berm Designed @ 5'
 Above Grade, Adjust as
 Needed After Determining
 Ground Water Depth

NOTE:
 CONSTRUCT DIVERSION
 DITCH AT EDGE OF
 LOCATION AS NEEDED

BEARINGS AND DISTANCES FROM BENCHMARK TO STAKED POSITIONS		
STAKED POSITION	BEARING	DISTANCE
#16-1 LOCATION STAKE	N00°19'51"W	279.27'
#16-1H LOCATION STAKE	N02°23'28"W	279.46'
PAD CORNER 1	N31°08'10"E	431.58'
PAD CORNER 2	N72°46'08"E	233.62'
PAD CORNER 3	N73°02'27"W	237.31'
PAD CORNER 4	N31°34'41"W	433.36'
PIT CORNER A	N19°22'50"W	412.54'
PAD CORNER B	N11°15'56"W	700.21'
PAD CORNER C	N05°14'51"E	689.74'
PAD CORNER D	N09°12'53"E	394.43'
NE FACILITIES CORNER	N41°11'23"E	490.83'
SE FACILITIES CORNER	N77°53'42"E	330.45'

Elev. Ungraded Ground At #16-1 Loc. Stake = 1329.7'
 FINISHED GRADE ELEV. AT #16-1 LOC. STAKE = 1328.9'

UINTAH ENGINEERING & LAND SURVEYING
 85 So. 200 East * Vernal, Utah 84078 * (435) 789-1017