

VESS OIL CORPORATION  
COLAHAN LEASE  
SW.1/4, SECTION 25, T11S, R17W  
ELLIS COUNTY, KANSAS

NO

ROAD

Notes:

1. Set iron rod at location site.
2. All flagging Red & Yellow.
3. Overhead power available in Sec.25.
4. Kansas One Call System (Inc. should be notified before excavation (1-800-344-7233).
5. CAUTION: Various pipelines in Sec.25.
6. Cattle in pasture at date of staking.
7. Contact landowner for best access.
8. Location fell on the slope of a draw, no alternate set per representative.

\*Ingress and egress to location as shown on this plat is per usage only and may not be legally opened for public use. Contact landowner, tenant and county road department for access.

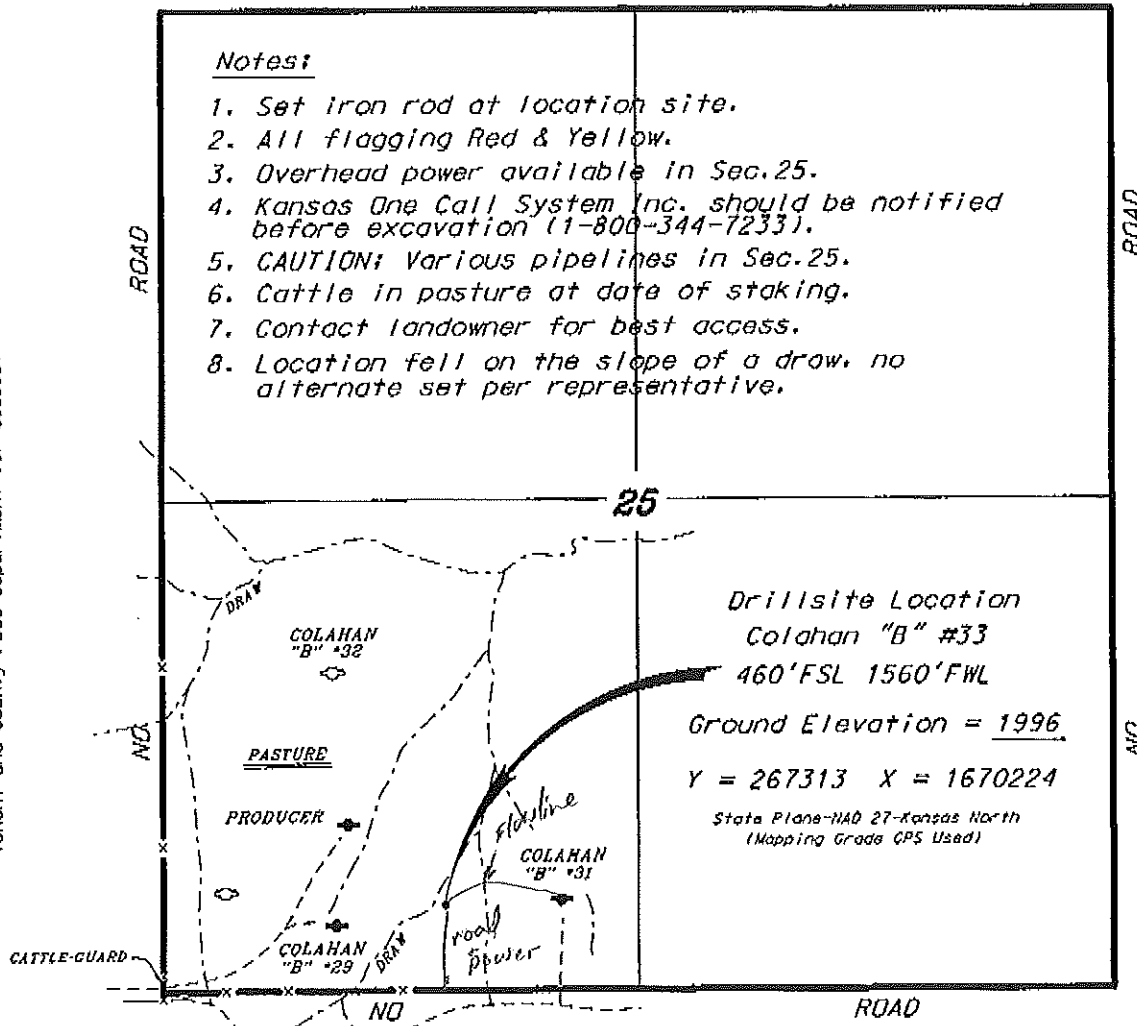

Directions:

From the intersection of Highway 183 and Interstate 70 at the north end of Hays, Kansas, go 14.0 miles north on Highway 183, then go 6.5 miles east, then go 2.19 miles south to a lease road entrance on east side of road, then go 0.53 miles east, then go 0.19 miles south, then go 0.15 miles east, then go 0.62 miles south to the south line of Section 26, then go 0.19 miles east to a cattle-guard at the southwest corner of Section 25, then go 0.29 miles East, then go 0.08 miles north to location.

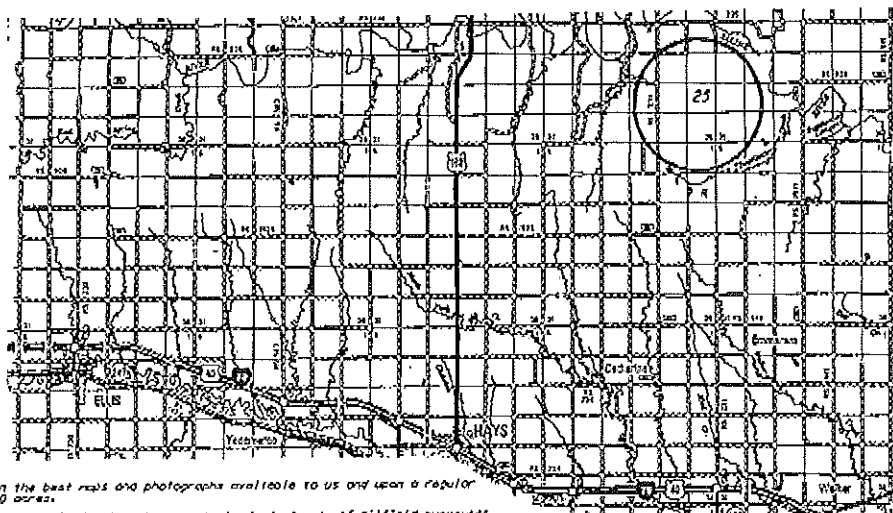

\* Controlling data is based upon the best maps and photographs available to us and upon a regular section of land containing 840 acres.

\* Approximate section lines were determined using the normal standard of care of oilfield surveys practiced in the state of Kansas. The section corners, which establish the precise section lines, were not necessarily located, and the exact location of the drillsite location in the section is not guaranteed. Therefore, the operator assuming this service and accepting this plat and all other parties relying thereon agree to hold Central Kansas Oilfield Services, Inc., its officers and employees harmless from all losses, costs and expenses and said entities released from any liability from incidental or consequential damages.

\* Elevations derived from National Geodetic Vertical Datum.

Date July 17, 2012