

SGOMI

LOCATION LAYOUT FOR

SCHUPBACH RANCH 3510 #3-1H
SECTION 3, T35S, R10W, 6th P.M.
480' FSL 2220' FWL

FIGURE #1

SCALE: 1" = 60'
DATE: 07-18-12
DRAWN BY: C.A.G.
VERSION: 1.0
REVISED:
REVISED BY:

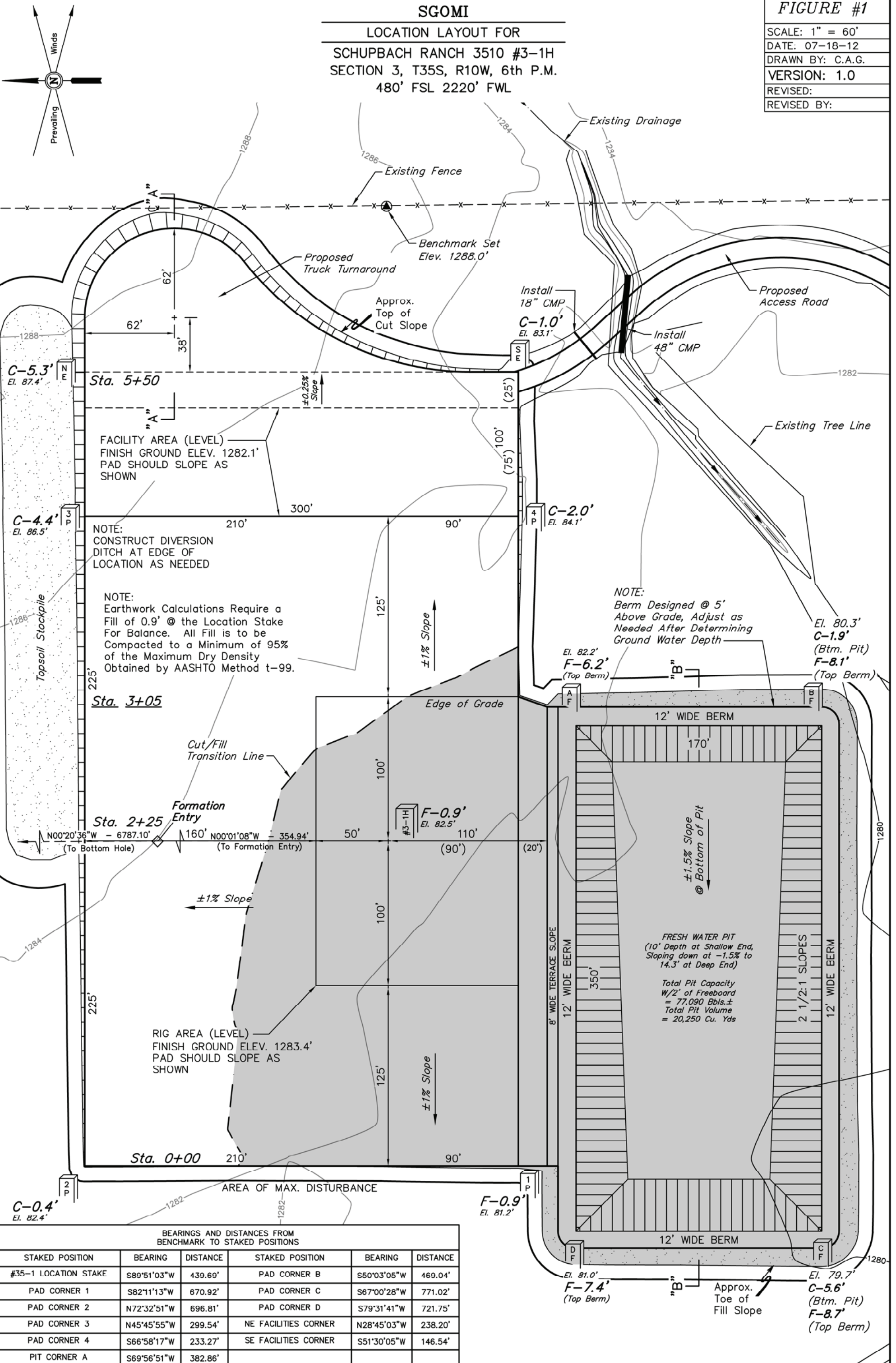

BEARINGS AND DISTANCES FROM BENCHMARK TO STAKED POSITIONS

STAKED POSITION	BEARING	DISTANCE	STAKED POSITION	BEARING	DISTANCE
#35-1 LOCATION STAKE	S89°51'03"W	439.69'	PAD CORNER B	S50°03'05"W	469.04'
PAD CORNER 1	S82°11'13"W	670.92'	PAD CORNER C	S67°00'28"W	771.02'
PAD CORNER 2	N72°32'51"W	696.81'	PAD CORNER D	S79°31'41"W	721.75'
PAD CORNER 3	N45°45'55"W	299.54'	NE FACILITIES CORNER	N28°45'03"W	238.20'
PAD CORNER 4	S66°58'17"W	233.27'	SE FACILITIES CORNER	S51°30'05"W	146.54'
PIT CORNER A	S69°56'51"W	382.86'			

Elev. Ungraded Ground At #3-1H Loc. Stake = 1282.5'
FINISHED GRADE ELEV. AT #3-1H LOC. STAKE = 1283.4'