



Fall & Associates
 Stake and Elevation Service
 719 W. 5th Street
 P.O. Box 484
 Concordia, KS. 66901
 1-800-536-2821

Date 8-14-12

Invoice Number 0810121

MURFIN DRILLING
 Operator

1-14
 Number

Poore
 Farm Name

Rawlins-KS
 County-State

14 3s 36w
 S T R

990' FNL 990' FWL
 Location

Murfin Drilling
 250 N. Water, Ste. 300
 Wichita, KS. 67202

Elevation 3317 Gr

Ordered By: Shauna

Scale 1"=1000'

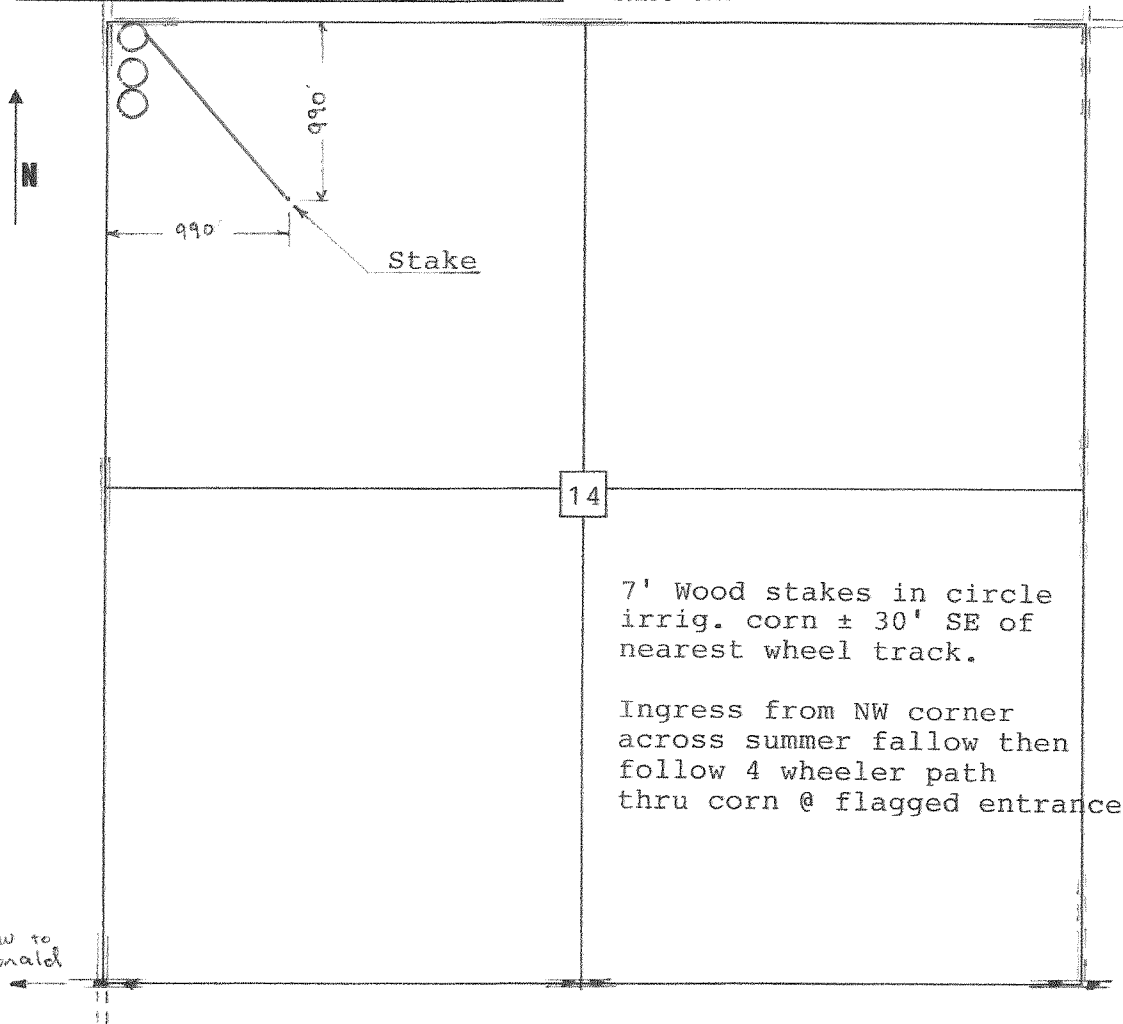

7' Wood stakes in circle
 irrig. corn ± 30' SE of
 nearest wheel track.

Ingress from NW corner
 across summer fallow then
 follow 4 wheeler path
 thru corn @ flagged entrance.

2m. w to
 McDonald