



1094511

For KCC Use ONLY

API # 15 - _____

IN ALL CASES PLOT THE INTENDED WELL ON THE PLAT BELOW

In all cases, please fully complete this side of the form. Include items 1 through 5 at the bottom of this page.

Operator: _____

Lease: _____

Well Number: _____

Field: _____

Number of Acres attributable to well: _____

QTR/QTR/QTR/QTR of acreage: _____ - _____ - _____ - _____

Location of Well: County: _____

_____ feet from N / S Line of Section

_____ feet from E / W Line of Section

Sec. _____ Twp. _____ S. R. _____ E W

Is Section: Regular or Irregular

If Section is Irregular, locate well from nearest corner boundary.

Section corner used: NE NW SE SW

PLAT

Show location of the well. Show footage to the nearest lease or unit boundary line. Show the predicted locations of lease roads, tank batteries, pipelines and electrical lines, as required by the Kansas Surface Owner Notice Act (House Bill 2032). You may attach a separate plat if desired.

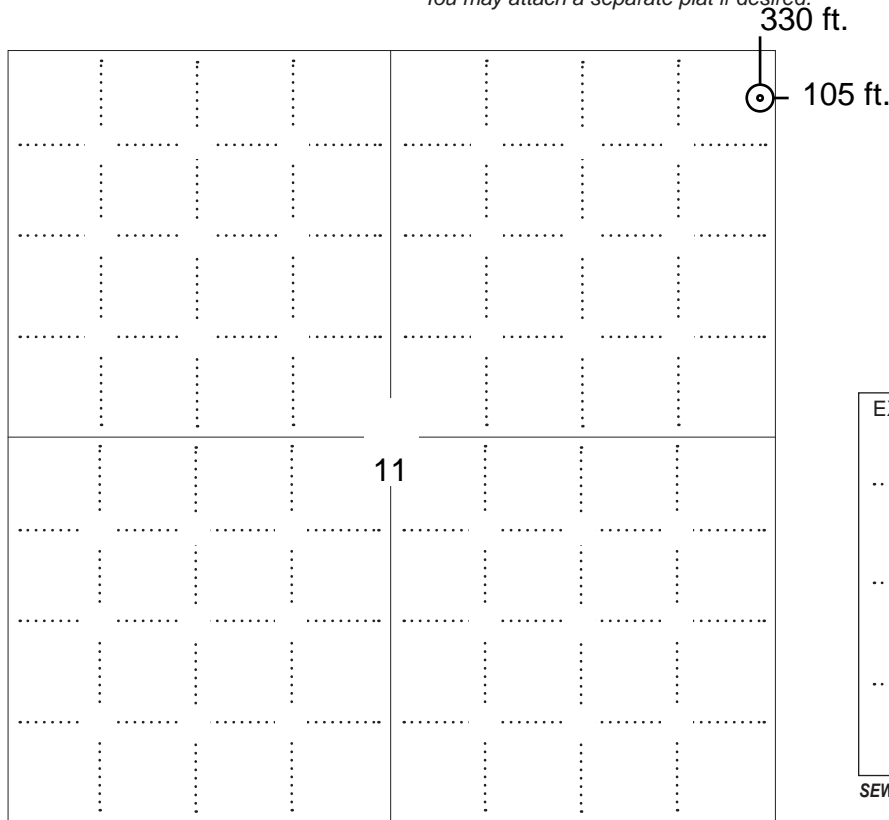

LEGEND

- Well Location
- Tank Battery Location
- Pipeline Location
- - - - Electric Line Location
- Lease Road Location



NOTE: In all cases locate the spot of the proposed drilling locaton.

In plotting the proposed location of the well, you must show:

- The manner in which you are using the depicted plat by identifying section lines, i.e. 1 section, 1 section with 8 surrounding sections, 4 sections, etc.
- The distance of the proposed drilling location from the south / north and east / west outside section lines.
- The distance to the nearest lease or unit boundary line (in footage).
- If proposed location is located within a prorated or spaced field a certificate of acreage attribution plat must be attached: (C0-7 for oil wells; CG-8 for gas wells).
- The predicted locations of lease roads, tank batteries, pipelines, and electrical lines.



KANSAS CORPORATION COMMISSION 1094511
OIL & GAS CONSERVATION DIVISION

Form CDP-1
May 2010
Form must be Typed

APPLICATION FOR SURFACE PIT

Submit in Duplicate

Operator Name:		License Number:	
Operator Address:			
Contact Person:		Phone Number:	
Lease Name & Well No.:		Pit Location (QQQQ): ____ - ____ - ____ - ____	
Type of Pit: <input type="checkbox"/> Emergency Pit <input type="checkbox"/> Burn Pit <input type="checkbox"/> Settling Pit <input type="checkbox"/> Drilling Pit <input type="checkbox"/> Workover Pit <input type="checkbox"/> Haul-Off Pit <i>(If WP Supply API No. or Year Drilled)</i>		Pit is: <input type="checkbox"/> Proposed <input type="checkbox"/> Existing If Existing, date constructed: _____ Pit capacity: _____ (bbls)	
Is the pit located in a Sensitive Ground Water Area? <input type="checkbox"/> Yes <input type="checkbox"/> No		Chloride concentration: _____ mg/l <i>(For Emergency Pits and Settling Pits only)</i>	
Is the bottom below ground level? <input type="checkbox"/> Yes <input type="checkbox"/> No		Artificial Liner? <input type="checkbox"/> Yes <input type="checkbox"/> No	
How is the pit lined if a plastic liner is not used?			
Pit dimensions (all but working pits): _____ Length (feet) _____ Width (feet) <input type="checkbox"/> N/A: Steel Pits Depth from ground level to deepest point: _____ (feet) <input type="checkbox"/> No Pit			
If the pit is lined give a brief description of the liner material, thickness and installation procedure.		Describe procedures for periodic maintenance and determining liner integrity, including any special monitoring.	
Distance to nearest water well within one-mile of pit: _____ feet Depth of water well _____ feet		Depth to shallowest fresh water _____ feet. Source of information: <input type="checkbox"/> measured <input type="checkbox"/> well owner <input type="checkbox"/> electric log <input type="checkbox"/> KDWR	
Emergency, Settling and Burn Pits ONLY: Producing Formation: _____ Number of producing wells on lease: _____ Barrels of fluid produced daily: _____ Does the slope from the tank battery allow all spilled fluids to flow into the pit? <input type="checkbox"/> Yes <input type="checkbox"/> No		Drilling, Workover and Haul-Off Pits ONLY: Type of material utilized in drilling/workover: _____ Number of working pits to be utilized: _____ Abandonment procedure: _____ _____ Drill pits must be closed within 365 days of spud date.	
<p>Submitted Electronically</p>			

KCC OFFICE USE ONLY

Liner Steel Pit RFAC RFAS

Date Received: _____ Permit Number: _____ Permit Date: _____ Lease Inspection: Yes No



CERTIFICATION OF COMPLIANCE WITH THE KANSAS SURFACE OWNER NOTIFICATION ACT

This form must be submitted with all Forms C-1 (Notice of Intent to Drill); CB-1 (Cathodic Protection Borehole Intent); T-1 (Request for Change of Operator Transfer of Injection or Surface Pit Permit); and CP-1 (Well Plugging Application). Any such form submitted without an accompanying Form KSONA-1 will be returned.

Select the corresponding form being filed: C-1 (Intent) CB-1 (Cathodic Protection Borehole Intent) T-1 (Transfer) CP-1 (Plugging Application)

OPERATOR: License # _____
Name: _____
Address 1: _____
Address 2: _____
City: _____ State: _____ Zip: _____ + _____
Contact Person: _____
Phone: (_____) _____ Fax: (_____) _____
Email Address: _____

Well Location:
____ - ____ - ____ - ____ Sec. ____ Twp. ____ S. R. ____ East West
County: _____
Lease Name: _____ Well #: _____

If filing a Form T-1 for multiple wells on a lease, enter the legal description of the lease below:

Surface Owner Information:

Name: _____
Address 1: _____
Address 2: _____
City: _____ State: _____ Zip: _____ + _____

When filing a Form T-1 involving multiple surface owners, attach an additional sheet listing all of the information to the left for each surface owner. Surface owner information can be found in the records of the register of deeds for the county, and in the real estate property tax records of the county treasurer.

If this form is being submitted with a Form C-1 (Intent) or CB-1 (Cathodic Protection Borehole Intent), you must supply the surface owners and the KCC with a plat showing the predicted locations of lease roads, tank batteries, pipelines, and electrical lines. The locations shown on the plat are preliminary non-binding estimates. The locations may be entered on the Form C-1 plat, Form CB-1 plat, or a separate plat may be submitted.

Select one of the following:

- I certify that, pursuant to the Kansas Surface Owner Notice Act (House Bill 2032), I have provided the following to the surface owner(s) of the land upon which the subject well is or will be located: 1) a copy of the Form C-1, Form CB-1, Form T-1, or Form CP-1 that I am filing in connection with this form; 2) if the form being filed is a Form C-1 or Form CB-1, the plat(s) required by this form; and 3) my operator name, address, phone number, fax, and email address.
- I have not provided this information to the surface owner(s). I acknowledge that, because I have not provided this information, the KCC will be required to send this information to the surface owner(s). To mitigate the additional cost of the KCC performing this task, I acknowledge that I am being charged a \$30.00 handling fee, payable to the KCC, which is enclosed with this form.

If choosing the second option, submit payment of the \$30.00 handling fee with this form. If the fee is not received with this form, the KSONA-1 form and the associated Form C-1, Form CB-1, Form T-1, or Form CP-1 will be returned.

I Submitted Electronically

For KCC Use ONLY

API # 15 - _____

IN ALL CASES PLOT THE INTENDED WELL ON THE PLAT BELOW

In all cases, please fully complete this side of the form. Include items 1 through 5 at the bottom of this page.

Operator: Baird Oil Company LLC
 Lease: White-Worcester Unit
 Well Number: 1-11
 Field: Wildcat

Number of Acres attributable to well: _____
 QTR/QTR/QTR/QTR of acreage: E2 - NE - NE - NE

Location of Well: County: Graham
 330 feet from N / S Line of Section
 105 feet from E / W Line of Section
 Sec. 11 Twp. 7 S. R. 22 E W

Is Section: Regular or Irregular

If Section is Irregular, locate well from nearest corner boundary.

Section corner used: NE NW SE SW

PLAT

Show location of the well. Show footage to the nearest lease or unit boundary line. Show the predicted locations of lease roads, tank batteries, pipelines and electrical lines, as required by the Kansas Surface Owner Notice Act (House Bill 2032). You may attach a separate plat if desired.

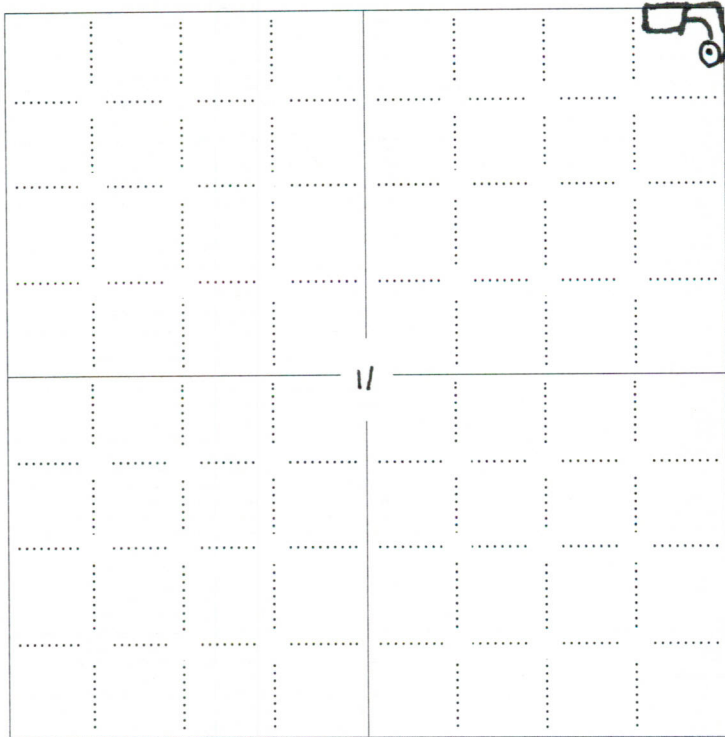

LEGEND

- Well Location
- Tank Battery Location
- Pipeline Location
- Electric Line Location
- Lease Road Location

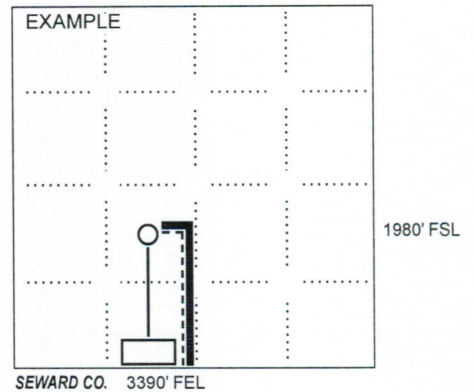

NOTE: In all cases locate the spot of the proposed drilling locaton.

In plotting the proposed location of the well, you must show:

1. The manner in which you are using the depicted plat by identifying section lines, i.e. 1 section, 1 section with 8 surrounding sections, 4 sections, etc.
2. The distance of the proposed drilling location from the south / north and east / west outside section lines.
3. The distance to the nearest lease or unit boundary line (in footage).
4. If proposed location is located within a prorated or spaced field a certificate of acreage attribution plat must be attached: (CO-7 for oil wells; CG-8 for gas wells).
5. The predicted locations of lease roads, tank batteries, pipelines, and electrical lines.

DECLARATION OF UNITIZATION

STATE OF KANSAS
COUNTY OF GRAHAM

WHEREAS, the undersigned, Baird Oil Company, LLC, is the operator of the following described Oil and Gas Leases, to-wit:

Oil and Gas Lease dated March 25, 2005, from The Warren A. White Revocable Living Trust dated May 8, 1991, as Lessor, to Baird Oil Company, LLC, as Lessee, recorded in book 214, pages 764 et seq. in the office of the Register of Deeds in Graham County, Kansas,

Said lease covering the following described land:

The Northeast Quarter (NE/4) of Section 11, Township 7, Range 22, Graham County, Kansas;

Oil and Gas Lease dated July 5, 2012, from David J. Worcester and Wanda G. Worcester, his wife, as Lessors, to J. Fred Hambright, Inc., as Lessee, recorded in book 256, pages 702 et seq. in the office of the Register of Deeds in Graham County, Kansas,

Said lease covering the following described land, to-wit:

The Northwest Quarter (NW/4) of Section 12, Township 7, Range 22, Graham County, Kansas;

WHEREAS, said Oil and Gas Leases contain the following pooling provision, to-wit:

"Lessee, at its option, is hereby given the right and power to pool or combine the acreage covered by this lease or any portion thereof with other land, lease or leases in the immediate vicinity thereof, when in lessee's judgment it is necessary or advisable to do so in order to properly develop and operate said lease premises so as to promote the conservation of oil, gas or other minerals in and under and that may be produced from said premises, such pooling to be of tracts contiguous to one another and to be into a unit or units not exceeding 40 acres each in the event of an oil well....."

WHEREAS, the undersigned intends to pool the acreage covered by the above described Oil and Gas Leases to form a unit consisting of approximately 10 acres and being described as:

A 10 acre tract in the NE/4 of 11-7-22, and the NW/4 of 12-7-22, Graham County, Kansas, the center of which is 330 feet from the North line and 105 feet from the East line in Section 11, Township 7, Range 22; consisting of a tract 435 feet East and West and 660 feet North and South from the NE/4 of Section 11, Township 7, Range 22; and tract 225 feet East and West by 660 feet North and South from the NW/4 of Section 12, Township 7, Range 22, Graham County, Kansas.

NOW THEREFORE, the undersigned elects to pool and unitize the above described approximately 10 acre portion of the acreage covered by said oil and gas leases as provided by the pooling clause in said leases and operate the same as a unit.

This declaration is effective as of the 29 day of August, 2012.

STATE OF KANSAS GRAHAM COUNTY, KANSAS
JUANITA TOLL REGISTER OF DEEDS
Book: 257 Page: 294-296
Receipt #: 34307 Recording Fee: \$18.00
Pages Recorded: 3
Date Recorded: 9/4/2012 11:25:29 AM

257 295

Baird Oil Company, LLC

Bohi Energy Inc.

By: *Jim R. Baird*
Jim R. Baird, President

By: *Kevin Phillips*
Kevin Phillips, POA

Jim R. Baird LLC

Hartman LLC

By: *Jim R. Baird*
Jim R. Baird, Member

By: *Robert B. Hartman*
Robert B. Hartman, Member

Lee Fetwiler
Lee Fetwiler

Kirk T. Rundle
Kirk T. Rundle

Rebecca L. Rundle
Rebecca L. Rundle

ACKNOWLEDGMENT

STATE OF KANSAS)
COUNTY OF PHILLIPS) ss:

The foregoing instrument was acknowledged before me this 29 day of August, 2012, by Jim R. Baird, as President of Baird Oil Company, LLC, on behalf of Baird Oil Company, LLC.

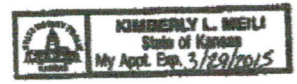

Kimberly L. Mehl
Notary Public

ACKNOWLEDGMENT

STATE OF Kansas)
COUNTY OF PHILLIPS) ss:

The foregoing instrument was acknowledged before me this 29th day of August, 2012, by Kevin Phillips, POA for Bohi Energy Inc., on behalf of Bohi Energy Inc.

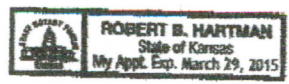

Robert B. Hartman
Notary Public

297 296

ACKNOWLEDGMENT

STATE OF KANSAS)
COUNTY OF PHILLIPS) ss:

The foregoing instrument was acknowledged before me this 29 day of August, 2012, by Jim R. Baird, Member of Jim R. Baird LLC, on behalf of Jim R. Baird, LLC.

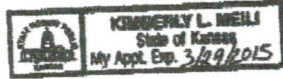

Kimberly L Mehl
Notary Public

ACKNOWLEDGMENT

STATE OF Kansas)
COUNTY OF Phillips) ss:

The foregoing instrument was acknowledged before me this 29 day of August, 2012, by Robert B. Hartman, Member of Hartman LLC, on behalf of Hartman LLC.

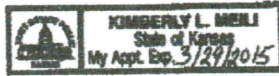

Kimberly L Mehl
Notary Public

ACKNOWLEDGMENT

STATE OF KANSAS)
COUNTY OF PHILLIPS) ss:

The above and foregoing instrument was acknowledged before me this 29th day of August, 2012, by Lee Tetwiler.

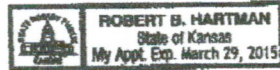

Robert B. Hartman
Notary Public

ACKNOWLEDGMENT

STATE OF KANSAS)
COUNTY OF PHILLIPS) ss:

The above and foregoing instrument was acknowledged before me this 29th day of August, 2012, by Kirk T. Rundle and Rebecca L. Rundle.



Robert B. Hartman
Notary Public

September 26, 2012

Jim R. Baird
Baird Oil Company LLC
113 W MAIN
PO BOX 428
LOGAN, KS 67646

Re: Drilling Pit Application
White-Worcester Unit 1-11
NE/4 Sec.11-07S-22W
Graham County, Kansas

Dear Jim R. Baird:

District staff has inspected the above referenced location and has determined that the reserve pit shall be constructed **without slots**, the bottom shall be flat and reasonably level, and the free fluids must be removed. The fluids are to be removed from the reserve pit as soon as practical after drilling operations have ceased. KEEP PITS away from draw/drainage

If production casing is set all completion fluids shall be removed from the working pits daily. NO completion fluids or non-exempt wastes shall be placed in the reserve pit.

The fluids should be taken to an authorized disposal well. Please call the District Office at (785) 625-0550 when the fluids have been removed. Please file form CDP-5 (August 2008), Exploration and Production Waste Transfer, through KOLAR within 30 days of fluid removal.

A copy of this letter should be posted in the doghouse along with the approved Intent to Drill. If you have any questions or concerns please feel free to contact the District Office at (785) 625-0550.