

Proposed Plan of Construction
 Branstetter Chester Unit #407W
 Sec 31 T27S-R33W
 Haskell County, KS

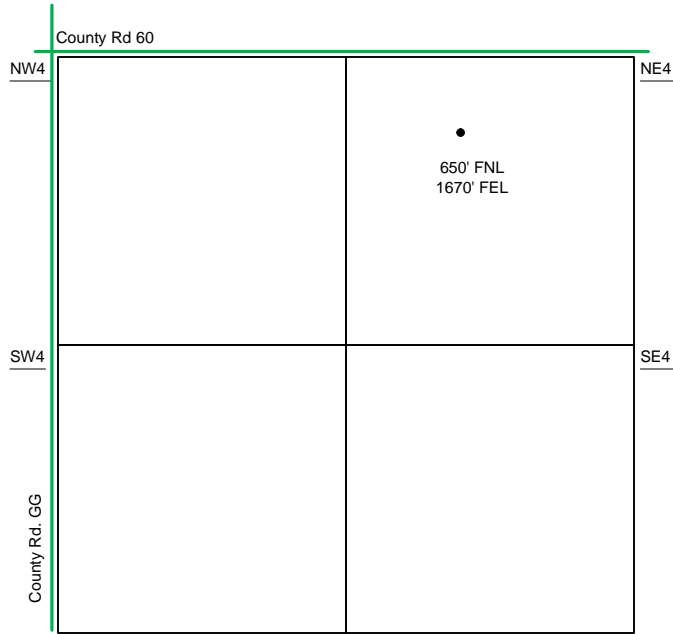

Sec 31 – T27S – R33W

NE/4

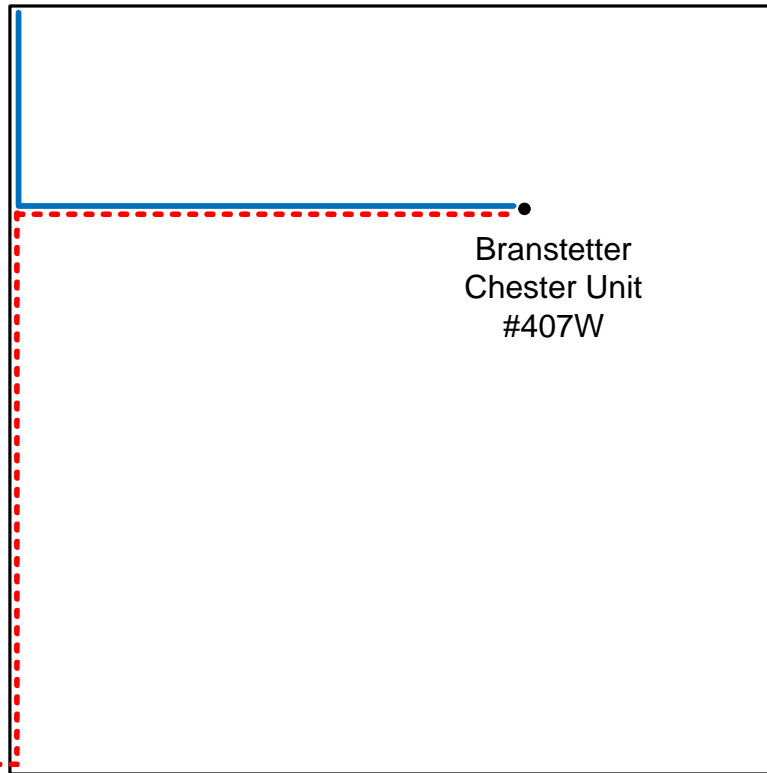

- Well Location
- Proposed Lease Roads
- - - Proposed Pipeline
- Proposed Tank Battery
- Proposed Power Lines
- - - Existing Pipeline

The Tank Battery for the Branstetter Chester Unit #407W is located in the NW of the SW quarter.

Proposed Details of
 NE/4 Sec 31 -T27S -R33W

Note-Drawing **Not** to Scale

Proposed Site Diagram
 Branstetter Chester
 Unit #407W
 September 18, 2012

