

Proposed Plan of Construction

Hitch A-6
Sec 30 T32S-R34W
Seward County, KS

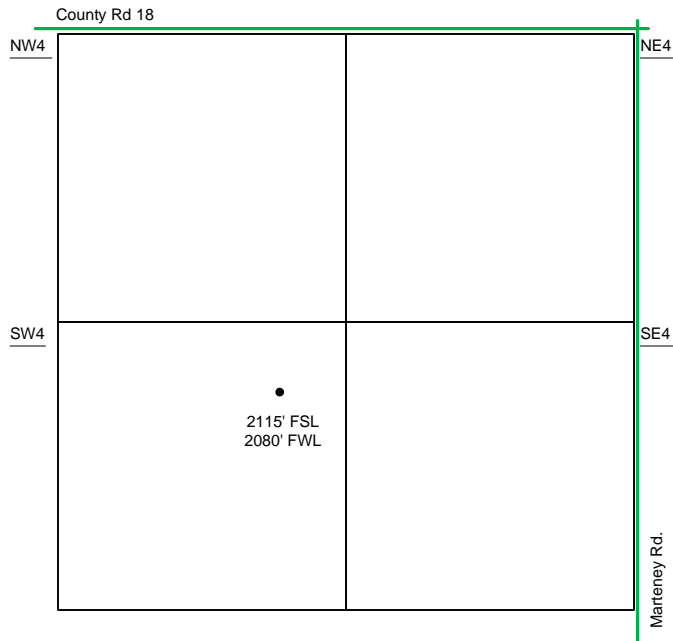

Sec 30 - T32S - R34W

SW/4

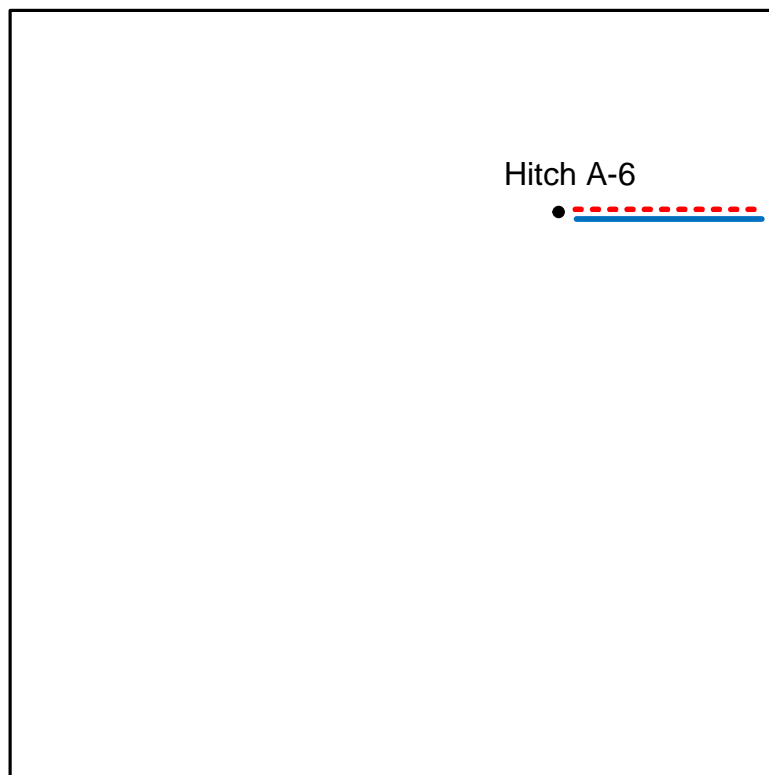

The Tank Battery for the Hitch A-6 is located in the SE of the NE quarter.

- Well Location
- Proposed Lease Roads
- - - Proposed Pipeline
- Proposed Tank Battery
- Proposed Power Lines
- - - Existing Pipeline

Proposed Details of
SW/4 Sec 30 -T32S -R34W

Note-Drawing **Not** to Scale

Proposed Site Diagram
Hitch A-6
September 10, 2012

