



Fall & Associates
 Stake and Elevation Service
 719 W. 5th Street
 P.O. Box 404
 Concordia, KS. 66901
 1-800-536-2821

Date 9-21-12

Invoice Number 0921121

MURFIN DRILLING
Operator

1-22
Number

Prochazka Unit
Farm Name

Rawlins-KS
County-State

22 3s 36w
S T R

990'FNL 2520'FEL
Location

Elevation 3330 Gr.

Ordered By: Shauna

Murfin Drilling
 250 N. Water
 Suite 300
 Wichita, KS. 67202

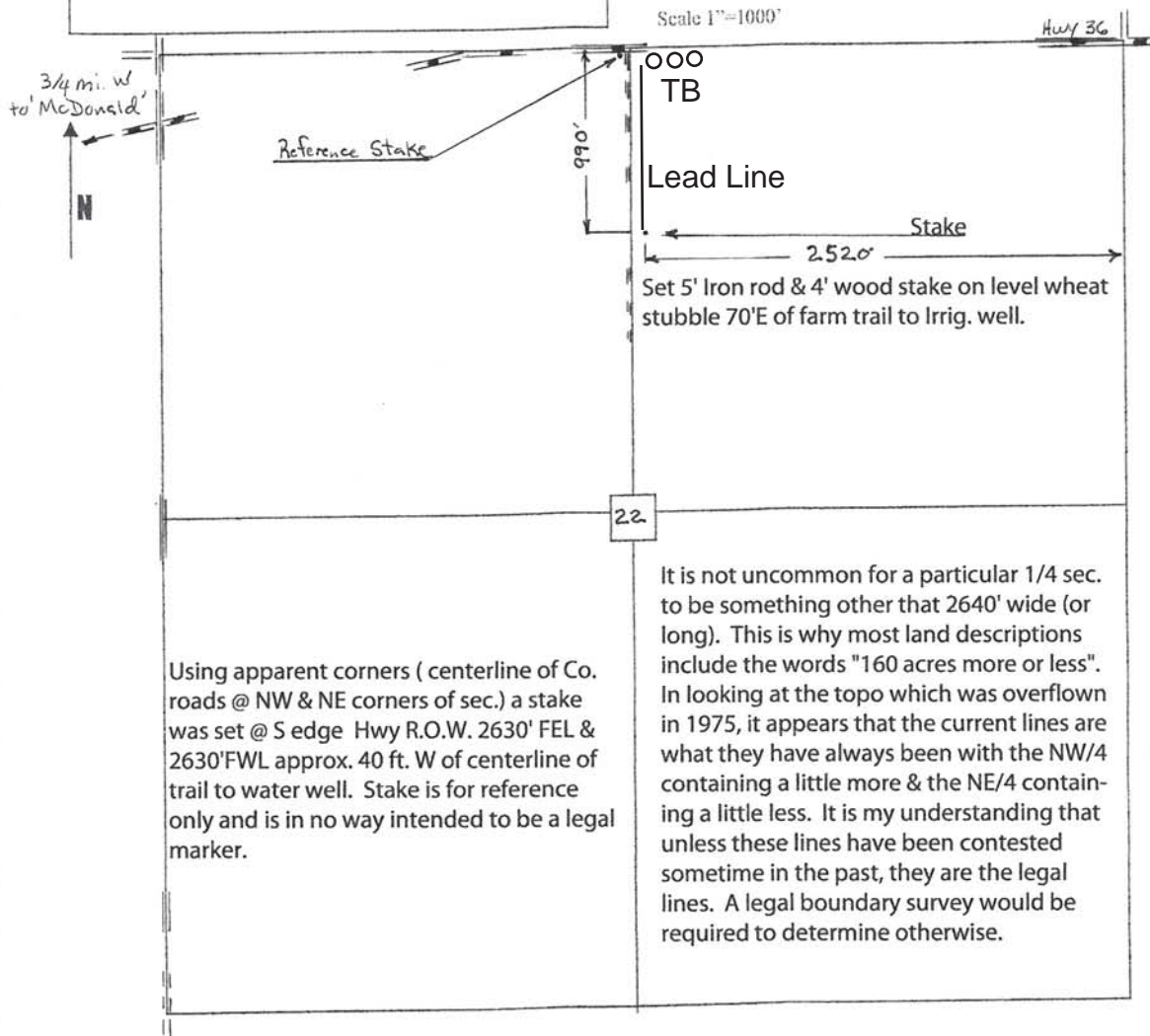

Using apparent corners (centerline of Co. roads @ NW & NE corners of sec.) a stake was set @ S edge Hwy R.O.W. 2630' FEL & 2630'FWL approx. 40 ft. W of centerline of trail to water well. Stake is for reference only and is in no way intended to be a legal marker.

It is not uncommon for a particular 1/4 sec. to be something other than 2640' wide (or long). This is why most land descriptions include the words "160 acres more or less". In looking at the topo which was overflowed in 1975, it appears that the current lines are what they have always been with the NW/4 containing a little more & the NE/4 containing a little less. It is my understanding that unless these lines have been contested sometime in the past, they are the legal lines. A legal boundary survey would be required to determine otherwise.

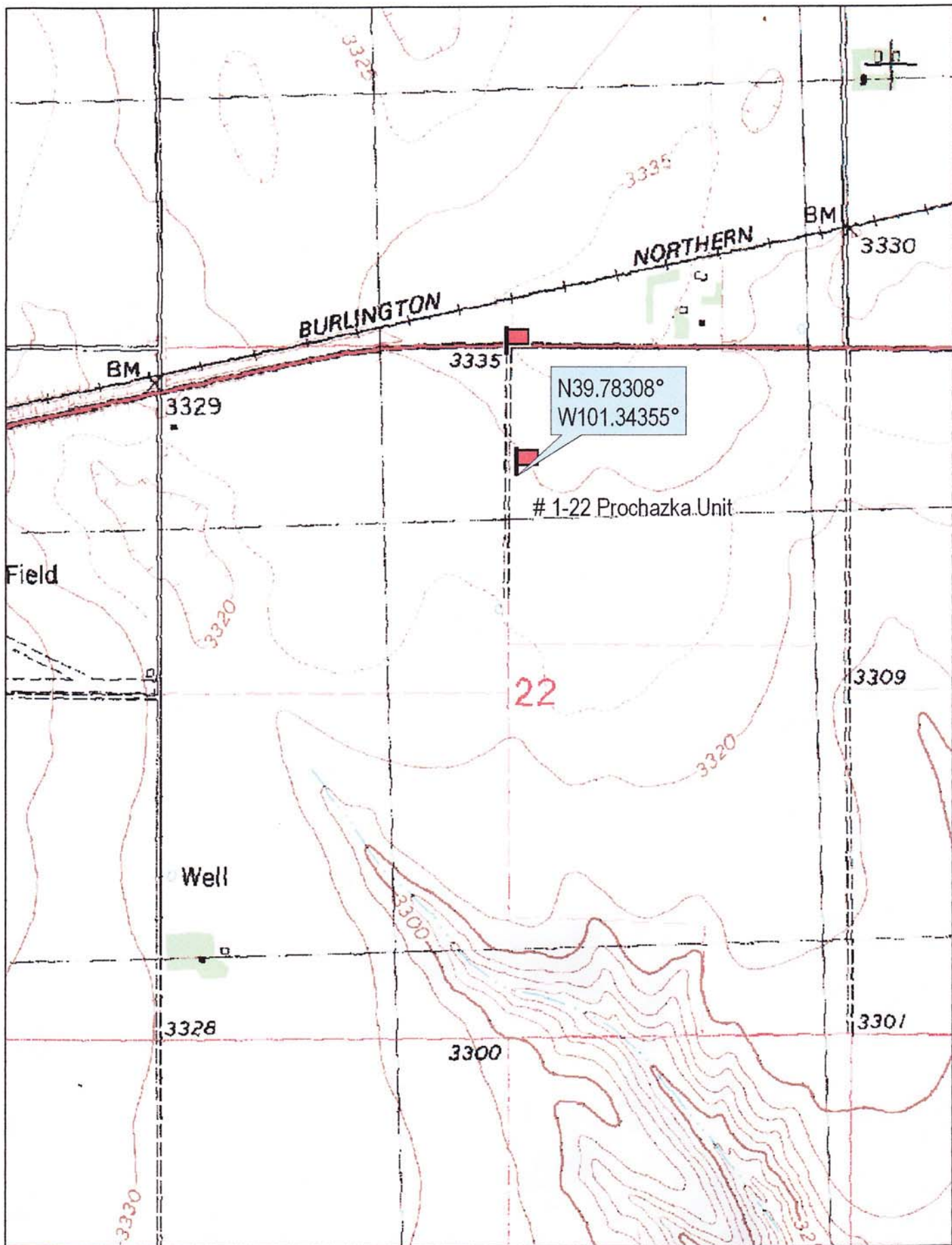

© 2002 DeLorme. 3-D TopoQuads ®. Data copyright of content owner.
www.delorme.com

Scale 1 : 12,000
1" = 1000 ft

