

Proposed Plan of Construction

Ladner F-5
Sec 13 T27S-R35W
Haskell County, KS

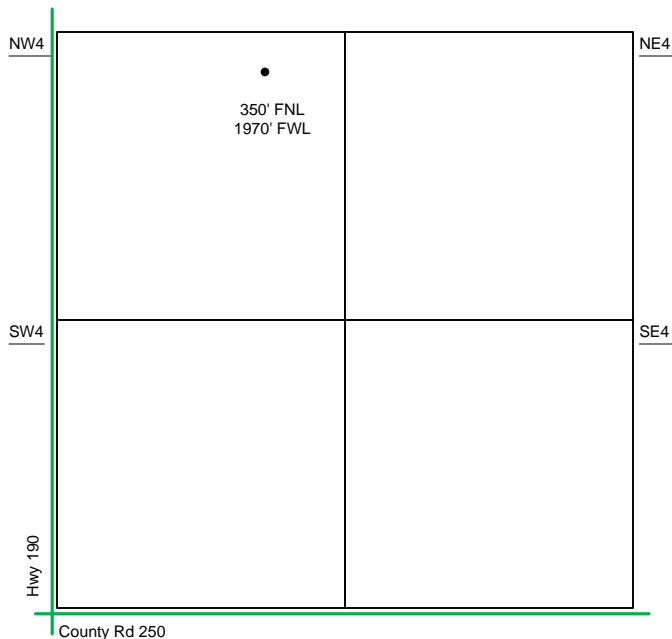

Sec 13 - T27S - R35W

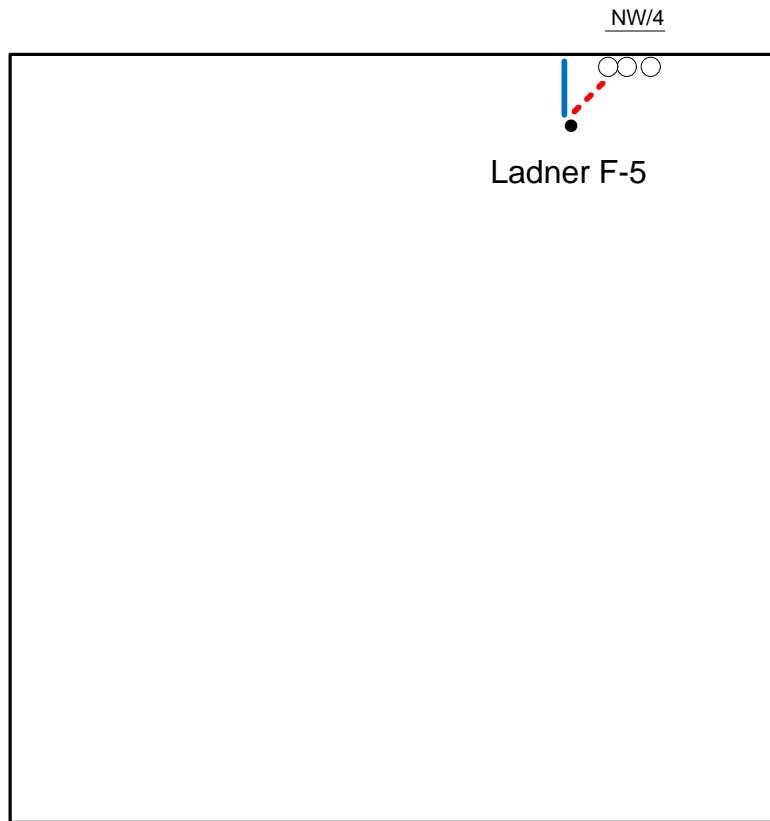

The Tank Battery for the Ladner F-5 will be located in the NE of the NW quarter.

- Well Location
- Proposed Lease Roads
- - - Proposed Pipeline
- Proposed Tank Battery
- Proposed Power Lines
- - - Existing Pipeline

Proposed Details of
NW/4 Sec 13 -T27S -R35W

Note-Drawing **Not** to Scale

