

SGOMI

LOCATION LAYOUT FOR

KAUP 3407 #16-1, #16-1H, #16-2H, #16-3H & #16-4H  
SECTION 16, T34S, R7W, 6th P.M.  
SW 1/4 SW 1/4

FIGURE #1

SCALE: 1" = 100'  
DATE: 07-30-12  
DRAWN BY: C.A.G.  
VERSION: 1.0  
REVISED:  
REVISED BY:

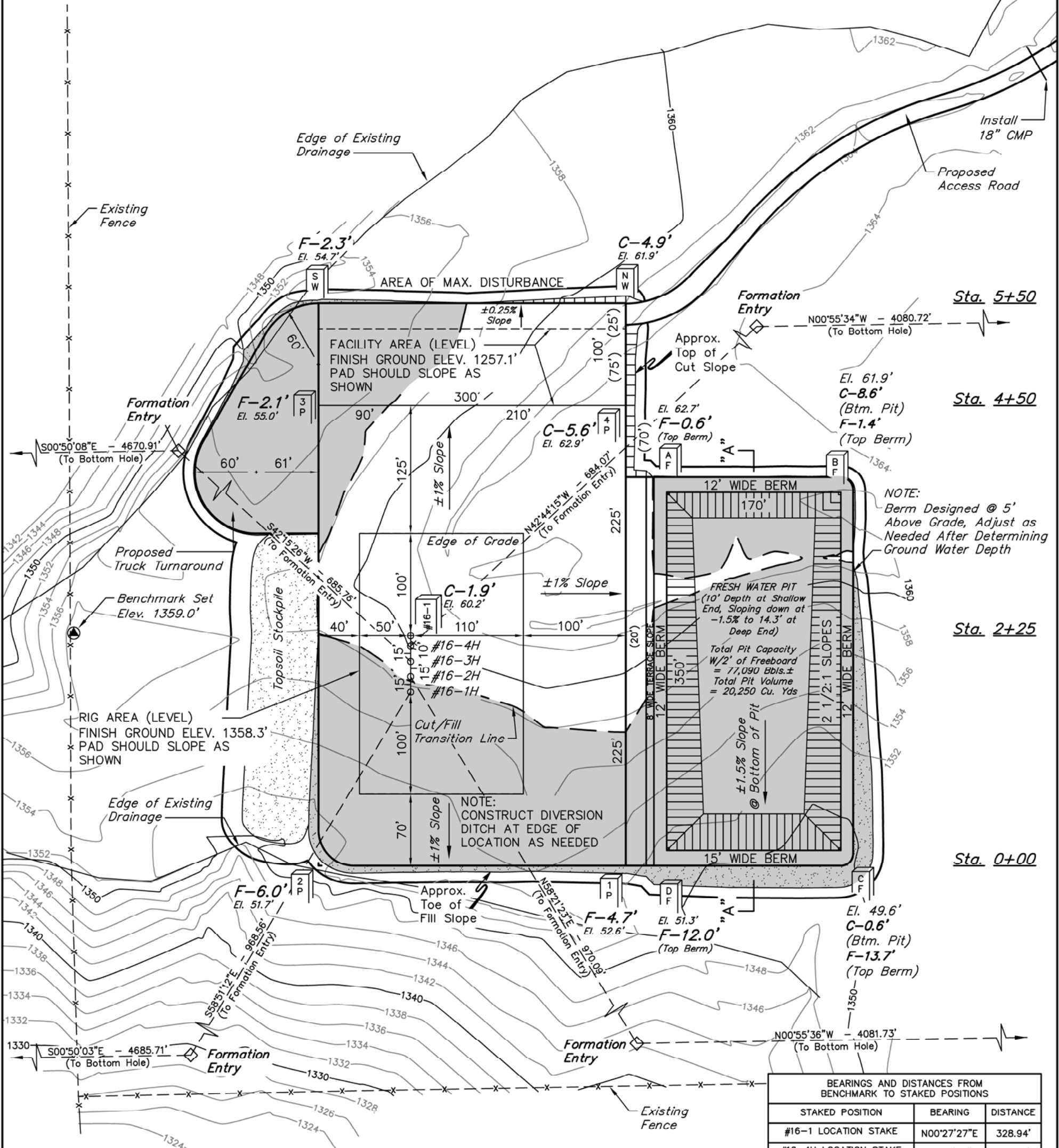
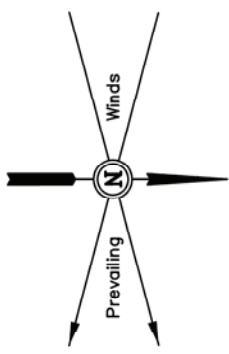

NOTE:  
Berm Designed @ 5'  
Above Grade, Adjust as  
Needed After Determining  
Ground Water Depth

Sta. 5+50  
Sta. 4+50  
Sta. 2+25  
Sta. 0+00

BEARINGS AND DISTANCES FROM BENCHMARK TO STAKED POSITIONS		
STAKED POSITION	BEARING	DISTANCE
#16-1 LOCATION STAKE	N00°27'27"E	328.94'
#16-4H LOCATION STAKE	N02°12'06"E	329.11'
#16-3H LOCATION STAKE	N04°48'27"E	330.09'
#16-2H LOCATION STAKE	N07°23'09"E	331.66'
#16-1H LOCATION STAKE	N09°56'38"E	333.91'
PAD CORNER 1	N22°53'49"E	585.00'
PAD CORNER 2	N43°36'34"E	329.99'
PAD CORNER 3	N42°56'52"W	326.46'
PAD CORNER 4	N22°25'21"W	583.03'
PIT CORNER A	N13°20'38"W	594.97'
PAD CORNER B	N10°23'47"W	761.44'
PAD CORNER C	N15°50'55"E	778.48'
PAD CORNER D	N20°09'45"E	616.73'
NW FACILITIES CORNER	N30°53'19"W	627.98'
SW FACILITIES CORNER	N53°27'08"W	401.26'

NOTE:  
Earthwork Calculations Require a  
Fill of 0.6' @ the #16-1H Location Stake  
For Balance. All Fill is to be  
Compacted to a Minimum of 95%  
of the Maximum Dry Density  
Obtained by AASHTO Method t-99.

Elev. Ungraded Ground At #16-1 Loc. Stake = 1260.2'  
FINISHED GRADE ELEV. AT #16-1 LOC. STAKE = 1258.3'