

Proposed Plan of Construction

Atkins J-5
Sec 33 T26S-R33W
Finney County, KS

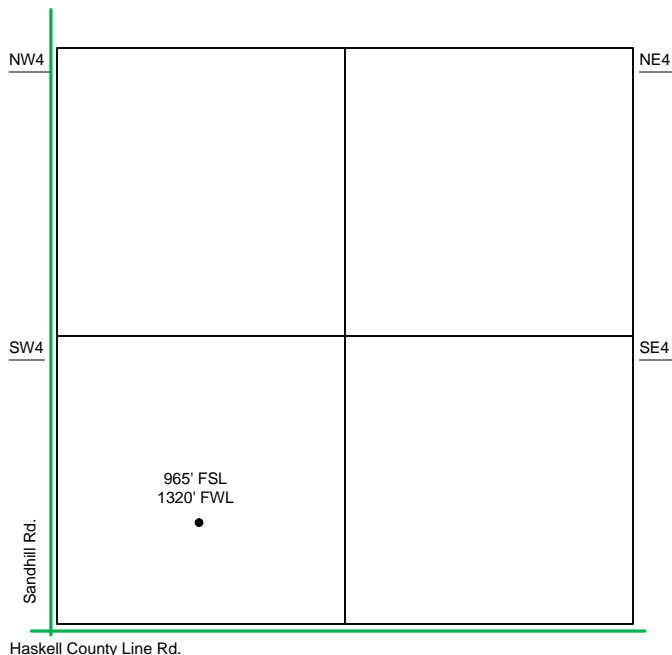

Sec 33 - T26S - R33W

SW/4

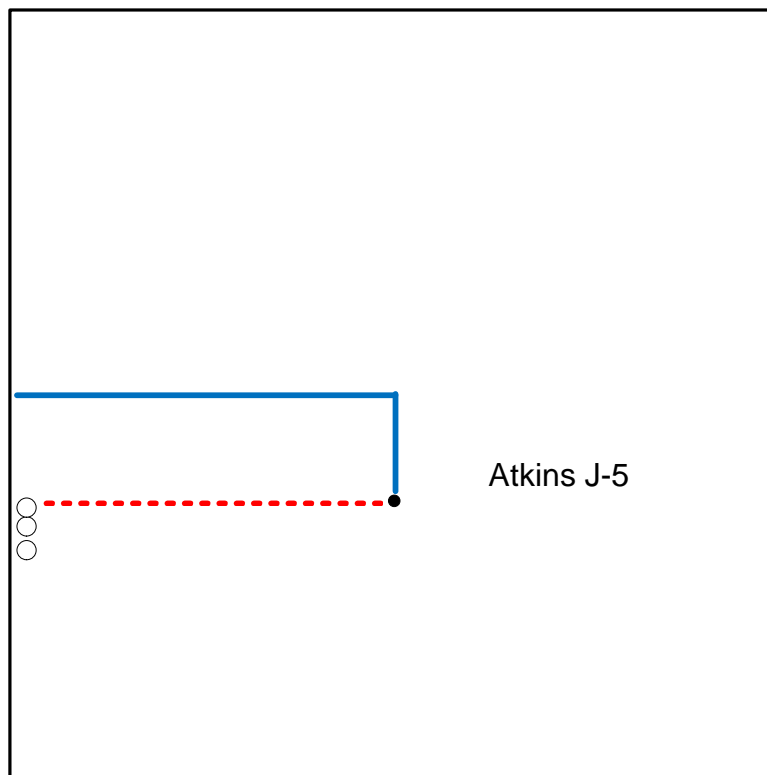

The Proposed Tank Battery for the Atkins J-5 is located in the SW of the SW quarter.

- Well Location
- Proposed Lease Roads
- - - Proposed Pipeline
- Proposed Tank Battery
- Proposed Power Lines
- - - Existing Pipeline

Proposed Details of
SW/4 Sec 33 -T26S -R33W

Note-Drawing **Not** to Scale

Proposed Site Diagram
Atkins J-5
October 15, 2012

