

# ADVANTAGE ELEVATIONS

OIL FIELD SURVEYORS

BOX 8604 - PRATT, KS 67124  
(620) 672-6491

103123

INVOICE NO.

VAL ENERGY INC

OPERATOR

2-25

NO.

Shirley Nelson

FARM

Barber

COUNTY

25

S

34s

T

11w

R

2310' FNL & 495' FWL of Sec

LOCATION

ELEVATION: 1363' GR



VAL ENERGY INC  
200 W Douglas, Ste 520  
Wichita, KS 67202-3005

AUTHORIZED BY: \_\_\_\_\_

SCALE: 1" = 100'

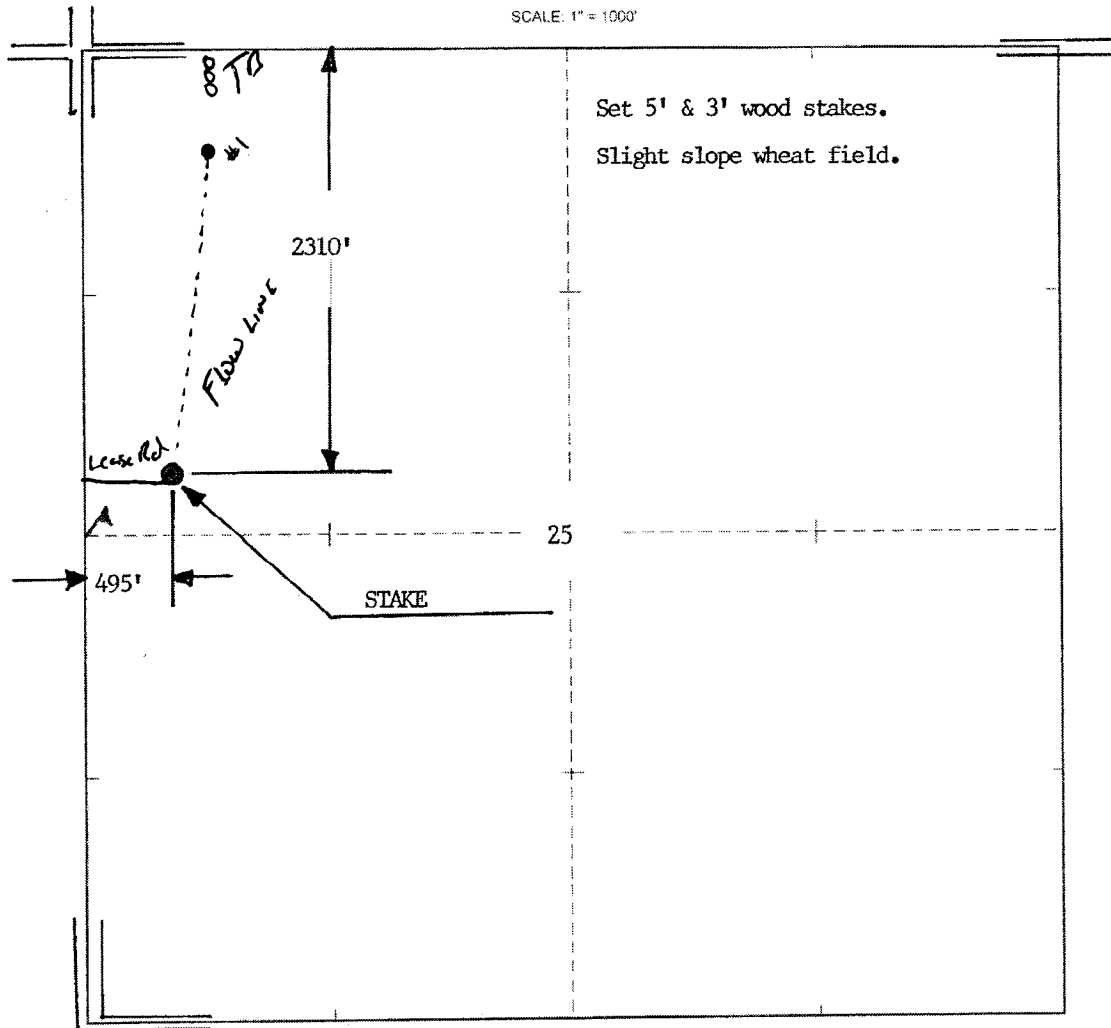

DATE STAKED: 10/4/12