



For KCC Use:
 Effective Date: _____
 District # _____
 SGA? Yes No

KANSAS CORPORATION COMMISSION 1102271
 OIL & GAS CONSERVATION DIVISION

Form C-1
 March 2010

Form must be Typed
 Form must be Signed
 All blanks must be Filled

NOTICE OF INTENT TO DRILL

Must be approved by KCC five (5) days prior to commencing well

Form KSONA-1, Certification of Compliance with the Kansas Surface Owner Notification Act, MUST be submitted with this form.

Expected Spud Date: _____
 month day year

OPERATOR: License# _____
 Name: _____
 Address 1: _____
 Address 2: _____
 City: _____ State: _____ Zip: _____ + _____
 Contact Person: _____
 Phone: _____

CONTRACTOR: License# _____
 Name: _____

Well Drilled For:	Well Class:	Type Equipment:
<input type="checkbox"/> Oil	<input type="checkbox"/> Enh Rec	<input type="checkbox"/> Infield
<input type="checkbox"/> Gas	<input type="checkbox"/> Storage	<input type="checkbox"/> Pool Ext.
	<input type="checkbox"/> Disposal	<input type="checkbox"/> Wildcat
<input type="checkbox"/> Seismic ; _____ # of Holes	<input type="checkbox"/> Other	<input type="checkbox"/> Mud Rotary
<input type="checkbox"/> Other: _____		<input type="checkbox"/> Air Rotary
		<input type="checkbox"/> Cable
<input type="checkbox"/> If OWWO: old well information as follows:		

Operator: _____
 Well Name: _____
 Original Completion Date: _____ Original Total Depth: _____

Directional, Deviated or Horizontal wellbore? Yes No
 If Yes, true vertical depth: _____
 Bottom Hole Location: _____
 KCC DKT #: _____

Spot Description: _____
 _____ - _____ - _____ Sec. _____ Twp. _____ S. R. _____ E W
 (Q/Q/Q/Q) _____ feet from N / S Line of Section
 _____ feet from E / W Line of Section

Is SECTION: Regular Irregular?
 (Note: Locate well on the Section Plat on reverse side)

County: _____
 Lease Name: _____ Well #: _____

Field Name: _____
 Is this a Prorated / Spaced Field? Yes No

Target Formation(s): _____
 Nearest Lease or unit boundary line (in footage): _____

Ground Surface Elevation: _____ feet MSL

Water well within one-quarter mile: Yes No

Public water supply well within one mile: Yes No

Depth to bottom of fresh water: _____

Depth to bottom of usable water: _____

Surface Pipe by Alternate: I II

Length of Surface Pipe Planned to be set: _____

Length of Conductor Pipe (if any): _____

Projected Total Depth: _____

Formation at Total Depth: _____

Water Source for Drilling Operations:
 Well Farm Pond Other: _____

DWR Permit #: _____
 (Note: Apply for Permit with DWR)

Will Cores be taken? Yes No
 If Yes, proposed zone: _____

AFFIDAVIT

The undersigned hereby affirms that the drilling, completion and eventual plugging of this well will comply with K.S.A. 55 et. seq.

It is agreed that the following minimum requirements will be met:

1. Notify the appropriate district office **prior** to spudding of well;
2. A copy of the approved notice of intent to drill **shall be** posted on each drilling rig;
3. The minimum amount of surface pipe as specified below **shall be set** by circulating cement to the top; in all cases surface pipe **shall be set** through all unconsolidated materials plus a minimum of 20 feet into the underlying formation.
4. If the well is dry hole, an agreement between the operator and the district office on plug length and placement is necessary **prior to plugging**;
5. The appropriate district office will be notified before well is either plugged or production casing is cemented in;
6. If an ALTERNATE II COMPLETION, production pipe shall be cemented from below any usable water to surface within **120 DAYS** of spud date. Or pursuant to Appendix "B" - Eastern Kansas surface casing order #133,891-C, which applies to the KCC District 3 area, alternate II cementing must be completed within 30 days of the spud date or the well shall be plugged. **In all cases, NOTIFY district office** prior to any cementing.

Submitted Electronically

For KCC Use ONLY

API # 15 - _____

Conductor pipe required _____ feet

Minimum surface pipe required _____ feet per ALT. I II

Approved by: _____

This authorization expires: _____
 (This authorization void if drilling not started within 12 months of approval date.)

Spud date: _____ Agent: _____

Remember to:

- File Certification of Compliance with the Kansas Surface Owner Notification Act (KSONA-1) with Intent to Drill;
- File Drill Pit Application (form CDP-1) with Intent to Drill;
- File Completion Form ACO-1 within 120 days of spud date;
- File acreage attribution plat according to field proration orders;
- Notify appropriate district office 48 hours prior to workover or re-entry;
- Submit plugging report (CP-4) after plugging is completed (within 60 days);
- Obtain written approval before disposing or injecting salt water.
- If well will not be drilled or permit has expired (See: authorized expiration date) please check the box below and return to the address below.

Well will not be drilled or Permit Expired Date: _____
 Signature of Operator or Agent: _____

Mail to: KCC - Conservation Division,
 130 S. Market - Room 2078, Wichita, Kansas 67202

E
W



1102271

For KCC Use ONLY

API # 15 - _____

IN ALL CASES PLOT THE INTENDED WELL ON THE PLAT BELOW

In all cases, please fully complete this side of the form. Include items 1 through 5 at the bottom of this page.

Operator: _____

Lease: _____

Well Number: _____

Field: _____

Number of Acres attributable to well: _____

QTR/QTR/QTR/QTR of acreage: _____ - _____ - _____ - _____

Location of Well: County: _____

_____ feet from N / S Line of Section

_____ feet from E / W Line of Section

Sec. _____ Twp. _____ S. R. _____ E W

Is Section: Regular or Irregular

If Section is Irregular, locate well from nearest corner boundary.

Section corner used: NE NW SE SW

PLAT

Show location of the well. Show footage to the nearest lease or unit boundary line. Show the predicted locations of lease roads, tank batteries, pipelines and electrical lines, as required by the Kansas Surface Owner Notice Act (House Bill 2032). You may attach a separate plat if desired.

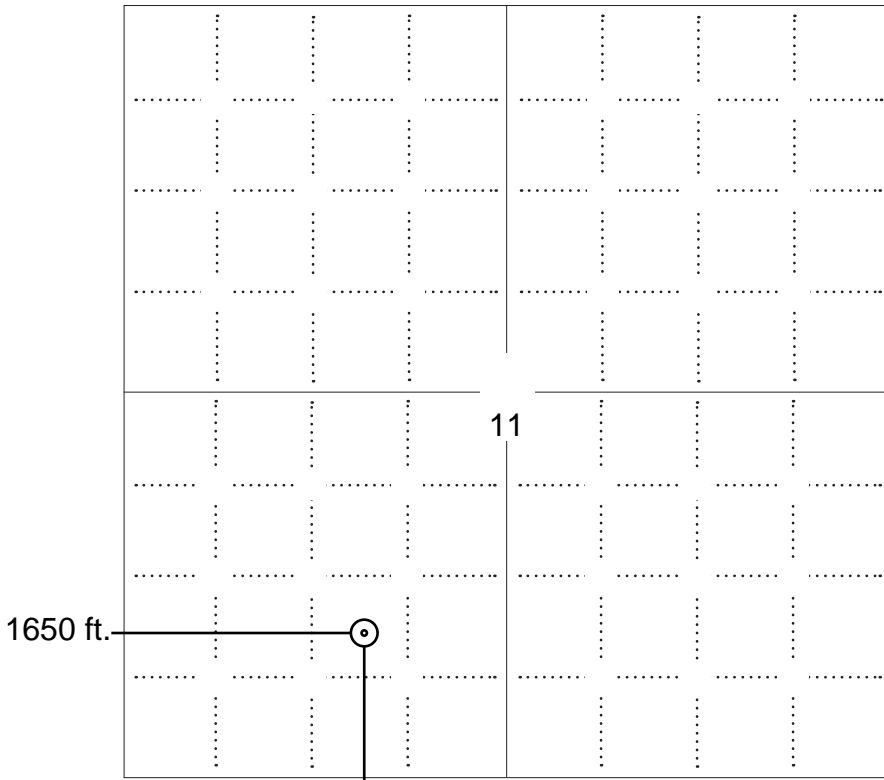

NOTE: In all cases locate the spot of the proposed drilling location.

LEGEND

- Well Location
- Tank Battery Location
- Pipeline Location
- Electric Line Location
- Lease Road Location



990 ft.

In plotting the proposed location of the well, you must show:

1. The manner in which you are using the depicted plat by identifying section lines, i.e. 1 section, 1 section with 8 surrounding sections, 4 sections, etc.
2. The distance of the proposed drilling location from the south / north and east / west outside section lines.
3. The distance to the nearest lease or unit boundary line (in footage).
4. If proposed location is located within a prorated or spaced field a certificate of acreage attribution plat must be attached: (C0-7 for oil wells; CG-8 for gas wells).
5. The predicted locations of lease roads, tank batteries, pipelines, and electrical lines.



KANSAS CORPORATION COMMISSION 1102271
OIL & GAS CONSERVATION DIVISION

Form CDP-1
May 2010
Form must be Typed

APPLICATION FOR SURFACE PIT

Submit in Duplicate

Operator Name:		License Number:	
Operator Address:			
Contact Person:		Phone Number:	
Lease Name & Well No.:		Pit Location (QQQQ): ____ - ____ - ____ - ____	
Type of Pit: <input type="checkbox"/> Emergency Pit <input type="checkbox"/> Burn Pit <input type="checkbox"/> Settling Pit <input type="checkbox"/> Drilling Pit <input type="checkbox"/> Workover Pit <input type="checkbox"/> Haul-Off Pit <i>(If WP Supply API No. or Year Drilled)</i>		Pit is: <input type="checkbox"/> Proposed <input type="checkbox"/> Existing If Existing, date constructed: _____ Pit capacity: _____ (bbls)	
Is the pit located in a Sensitive Ground Water Area? <input type="checkbox"/> Yes <input type="checkbox"/> No		Chloride concentration: _____ mg/l <i>(For Emergency Pits and Settling Pits only)</i>	
Is the bottom below ground level? <input type="checkbox"/> Yes <input type="checkbox"/> No		Artificial Liner? <input type="checkbox"/> Yes <input type="checkbox"/> No	
How is the pit lined if a plastic liner is not used?			
Pit dimensions (all but working pits): _____ Length (feet) _____ Width (feet) <input type="checkbox"/> N/A: Steel Pits Depth from ground level to deepest point: _____ (feet) <input type="checkbox"/> No Pit			
If the pit is lined give a brief description of the liner material, thickness and installation procedure.		Describe procedures for periodic maintenance and determining liner integrity, including any special monitoring.	
Distance to nearest water well within one-mile of pit: _____ feet Depth of water well _____ feet		Depth to shallowest fresh water _____ feet. Source of information: <input type="checkbox"/> measured <input type="checkbox"/> well owner <input type="checkbox"/> electric log <input type="checkbox"/> KDWR	
Emergency, Settling and Burn Pits ONLY: Producing Formation: _____ Number of producing wells on lease: _____ Barrels of fluid produced daily: _____ Does the slope from the tank battery allow all spilled fluids to flow into the pit? <input type="checkbox"/> Yes <input type="checkbox"/> No		Drilling, Workover and Haul-Off Pits ONLY: Type of material utilized in drilling/workover: _____ Number of working pits to be utilized: _____ Abandonment procedure: _____ _____ Drill pits must be closed within 365 days of spud date.	
<p>Submitted Electronically</p>			

KCC OFFICE USE ONLY

Liner Steel Pit RFAC RFAS

Date Received: _____ Permit Number: _____ Permit Date: _____ Lease Inspection: Yes No



CERTIFICATION OF COMPLIANCE WITH THE KANSAS SURFACE OWNER NOTIFICATION ACT

This form must be submitted with all Forms C-1 (Notice of Intent to Drill); CB-1 (Cathodic Protection Borehole Intent); T-1 (Request for Change of Operator Transfer of Injection or Surface Pit Permit); and CP-1 (Well Plugging Application). Any such form submitted without an accompanying Form KSONA-1 will be returned.

Select the corresponding form being filed: C-1 (Intent) CB-1 (Cathodic Protection Borehole Intent) T-1 (Transfer) CP-1 (Plugging Application)

OPERATOR: License # _____
Name: _____
Address 1: _____
Address 2: _____
City: _____ State: _____ Zip: _____ + _____
Contact Person: _____
Phone: (_____) _____ Fax: (_____) _____
Email Address: _____

Well Location:
____ - ____ - ____ - ____ Sec. ____ Twp. ____ S. R. ____ East West
County: _____
Lease Name: _____ Well #: _____

If filing a Form T-1 for multiple wells on a lease, enter the legal description of the lease below:

Surface Owner Information:

Name: _____
Address 1: _____
Address 2: _____
City: _____ State: _____ Zip: _____ + _____

When filing a Form T-1 involving multiple surface owners, attach an additional sheet listing all of the information to the left for each surface owner. Surface owner information can be found in the records of the register of deeds for the county, and in the real estate property tax records of the county treasurer.

If this form is being submitted with a Form C-1 (Intent) or CB-1 (Cathodic Protection Borehole Intent), you must supply the surface owners and the KCC with a plat showing the predicted locations of lease roads, tank batteries, pipelines, and electrical lines. The locations shown on the plat are preliminary non-binding estimates. The locations may be entered on the Form C-1 plat, Form CB-1 plat, or a separate plat may be submitted.

Select one of the following:

- I certify that, pursuant to the Kansas Surface Owner Notice Act (House Bill 2032), I have provided the following to the surface owner(s) of the land upon which the subject well is or will be located: 1) a copy of the Form C-1, Form CB-1, Form T-1, or Form CP-1 that I am filing in connection with this form; 2) if the form being filed is a Form C-1 or Form CB-1, the plat(s) required by this form; and 3) my operator name, address, phone number, fax, and email address.
- I have not provided this information to the surface owner(s). I acknowledge that, because I have not provided this information, the KCC will be required to send this information to the surface owner(s). To mitigate the additional cost of the KCC performing this task, I acknowledge that I am being charged a \$30.00 handling fee, payable to the KCC, which is enclosed with this form.

If choosing the second option, submit payment of the \$30.00 handling fee with this form. If the fee is not received with this form, the KSONA-1 form and the associated Form C-1, Form CB-1, Form T-1, or Form CP-1 will be returned.

I Submitted Electronically

For KCC Use ONLY
 API # 15 - _____

IN ALL CASES PLOT THE INTENDED WELL ON THE PLAT BELOW

In all cases, please fully complete this side of the form. Include items 1 through 5 at the bottom of this page.

Operator: BEN GILES
 Lease: 5446
 Well Number: 2 OWWO
 Field: GREENWICH

Number of Acres attributable to well: 10
 QTR/QTR/QTR/QTR of acreage: _____ - NW - SE - SW

Location of Well: County: SEDGWICK

 990 _____ feet from N / S Line of Section
 1,650 _____ feet from E / W Line of Section
 Sec. 11 Twp. 26 S. R. 2 E W

Is Section: Regular or Irregular

If Section is Irregular, locate well from nearest corner boundary.

Section corner used: NE NW SE SW

PLAT

Show location of the well. Show footage to the nearest lease or unit boundary line. Show the predicted locations of lease roads, tank batteries, pipelines and electrical lines, as required by the Kansas Surface Owner Notice Act (House Bill 2032). You may attach a separate plat if desired.

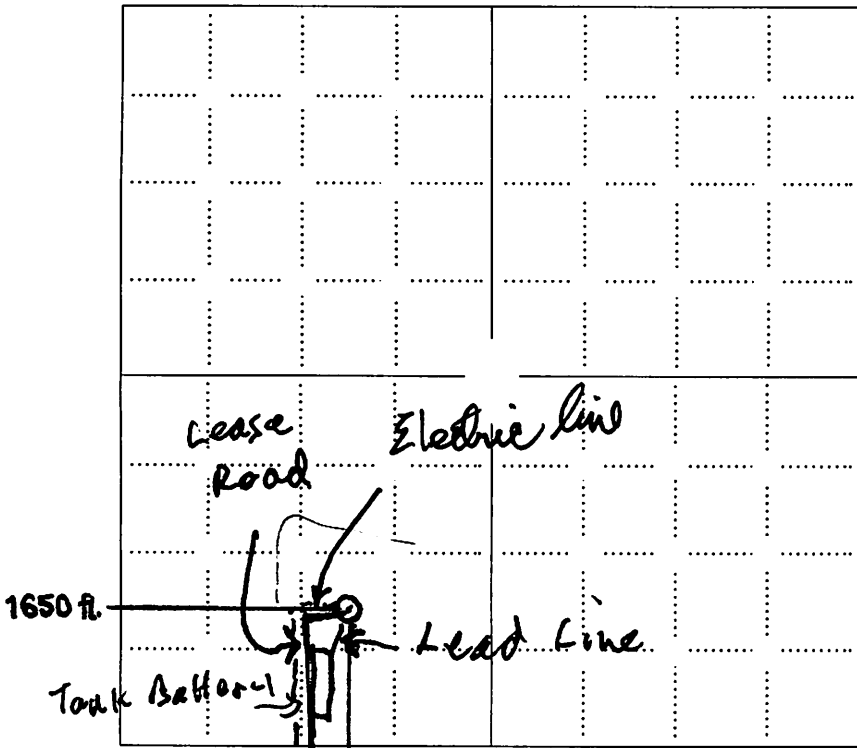

NOTE: In all cases locate the spot of the proposed drilling location.

990 ft.

In plotting the proposed location of the well, you must show:

1. The manner in which you are using the depicted plat by identifying section lines, i.e. 1 section, 1 section with 8 surrounding sections, 4 sections, etc.
2. The distance of the proposed drilling location from the south / north and east / west outside section lines.
3. The distance to the nearest lease or unit boundary line (in footage).
4. If proposed location is located within a prorated or spaced field a certificate of acreage attribution plat must be attached: (CO-7 for oil wells; CG-8 for gas wells).
5. The predicted locations of lease roads, tank batteries, pipelines, and electrical lines.

LEGEND

- Well Location
- Tank Battery Location
- Pipeline Location
- Electric Line Location
- Lease Road Location

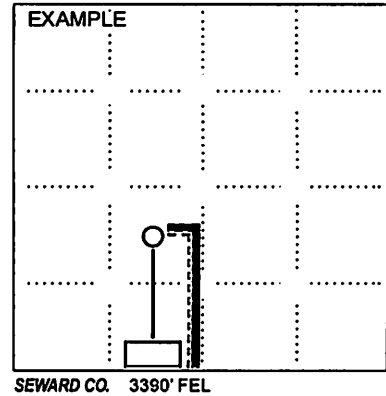

MWM Oil Co., Inc.
346 S. Lulu Street * Wichita, KS 67211
Phone: (316) 265-1992 * Fax: (316) 265-1999

November 21, 2012

Mr. Rick Hestermann
c/o Kansas Corporation Commission
130 S. Market Street
Wichita, KS 67202

Dear Mr. Hestermann,

Attached is an intent to drill for the M & L Land Stollei #2 OWWO at NW-SE-SW of Sec. 11-26S-2E in Sedgwick County, Kansas. This is a wash down of Shell Oil Company's Stollei #2 plugged in 1959. See copy of plugging reports attached.

I am requesting Alternate 2 for surface casing. According to the plugging reports, the original 8 5/8" casing was removed at 195ft. from surface. We plan on washing down to 195ft. and hooking on to the old 8 5/8" casing with new 8 5/8" casing. We will run a log to see where the top of the cement is and if it is not above 250ft. from surface, we will perforate the 8 5/8" casing at 250ft. and circulate cement to the surface.

Please let us know if this is acceptable.

Thank you for your consideration and time in the matter.

Very truly yours,
MWM Oil Co., Inc.

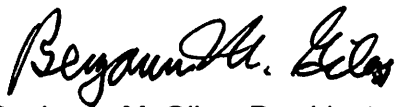
Benjamin M. Giles, President

Enclosures
BMG/tr

COPY

J.A. AYLFORD-SHELL.
 H. Stollei No. 2.

SEC. 11 T. 26 R. 2 E.
 NW 36 SW 990' PL
 990' GL

COUNTY. Sedgwick.

Total Depth. 2840
 Comm. 5-25-35 Comp. 6-18-35.
 Shot or treated.
 Contractor. J.A. Aylford.
 Issued. 7-15-35



CASING.

153/8" 155'
 85/8" 2620'
 7" 2840'

Elevation.

Reduction. 510 R.O. Est 600' Potential test.

Figures Indicate Bottom of Formations

clay	25	slate	5 BWPB	1190	lime	2310
shale	150	limo		1200	shale and shells	2345
shale	185	slate		1205	lime	2360
lime	160	limo		1210	shale	2380
shale	210	shale white		1220	shale & shells	2405
lime	240	slate white		1225	lime 21W 2435-45	2615
shale	260	limo-5 BWPB		1240	lime	2555
lime	270	slate		1245	shale	2585
shale and shells	325	limo		1255	shale	2615
lime	405	slate		1290	lime	2625
shale	420	shale blue		1325	shale	2640
lime and shale blue	455	limo		1330	lime	2650
lime	485	shale blue		1340	lime	2655
slate	505	ady limo		1365	shale	2660
lime	525	slate		1370	lime	2705
shale blue	535	lime		1376	lime	2725
lime	550	shale		1380	shale	2737
slate	555	slate		1385	lime	2750
lime	570	limo		1410	lime	2755
slate	575	slate		1430	shale	2790
lime	585	lime		1470	lime	2795
slate	590	shale blue		1475	lime	2800
lime	595	limo		1515	shale	2810
slate	600	shale blue		1530	lime	2815
lime	610	slate		1540	V.C. shale	2830
slate	620	limo		1570	V.C. shale	2839
lime	640	slate		1580	ohat	2840
slate and shells	705	lime		1600	show oil and water 1560'	
shale blk	780	limo		1610	oil and 850' wtr.	
lime	790	slate		1630	Total Depth.	
slate	810	lime		1645		
lime	815	slate		1650		
slate	825	lime		1665	Pumping- pumped 553 B.O.	
lime	840	lime		1675	and set 600 B. 24 hr.	
slate	870	shale blue		1685		
shale blue	885	lime		1706		
lime	895	lime		1715		
slate	925	shale		1725		
red rock	935	slate		1735		
shale blue	940	lime		1750		
lime	945	slate		1755		
slate	950	lime		1785		
slate	960	slate		1790		
red rock	965	lime		1835		
2 BWPB 985-1006		slate		1845		
slate	970	lime		1870		
lime	975	slate		1880		
slate	985	lime		1895		
lime	1005	slate		1925		
slate	1045	lime		1930		
lime	1055	slate		2005		
slate	1070	lime		2010		
carrying 5 BWPB		slate		2035		
lime	1090	shale		2040		
slate	1100	limo		2050		
lime 5 BWPB	1115	shale		2060		
shale blue	1180	lime		2100		
lime	1145	shale		2180		
slate	1150	lime		2290		
lime	1175	shale		2300		

Must only

RECEIVED

STATE COMMISSION

JUL 11 1959

CONSERVATION DIVISION

PL 3113
 FILE SEC. 11 T. 26 R. 2 E.
 BOOK PAGE 35 LINE 10

15-173-01988-00-00

STATE OF KANSAS
STATE CORPORATION COMMISSION
Give All Information Completely
Make Required Affidavit
Mail or Deliver Report to:
Conservation Division
State Corporation Commission
212 North Market, Insurance Bldg.
Wichita, Kansas

WELL PLUGGING RECORD

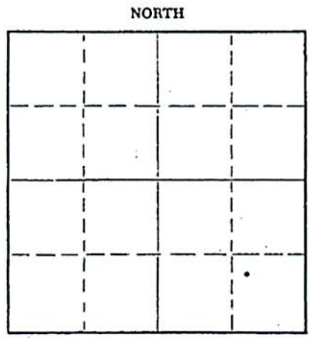

Locate well correctly on above Section Plat

Sedgwick County, Sec. 11 Twp. 26 Rge. 2 (E) E (W)
Location as "NE/CNWxSWx" or footage from lines nw-se-sw
Lease Owner Aylward Drilling Co
Lease Name Stolli # 2
Office Address 813 - 1st National Ban Bldg., Wichita, Kans
Character of Well (completed as Oil, Gas or Dry Hole) oil
Date well completed June 18-35
Application for plugging filed Aylward applied
Application for plugging approved 19
Plugging commenced 5-4-59
Plugging completed 5-5-59
Reason for abandonment of well or producing formation stoped producing
If a producing well is abandoned, date of last production 19
Was permission obtained from the Conservation Division or its agents before plugging was commenced? yes

Name of Conservation Agent who supervised plugging of this well Lee Guthrie
Producing formation Lime chat Depth to top 2830 Bottom 2840 Total Depth of Well 2840 Feet
Show depth and thickness of all water, oil and gas formations.

OIL, GAS OR WATER RECORDS

CASING RECORD

FORMATION	CONTENT	FROM	TO	SIZE	PUT IN	PULLED OUT
				8 1/4	2620'	193'
		liner		6 3/8	262'	none
					252'	

Describe in detail the manner in which the well was plugged, indicating where the mud fluid was placed and the method or methods used in introducing it into the hole. If cement or other plugs were used, state the character of same and depth placed, from _____ feet to _____ feet for each plug set.

2589' - 5 sacks cement dumped wet with bailer,
175' - 15' sack bridge - 25 sacks cement dumped ~~dry~~ dry
mudded hole to 30'
30' - 5' rock bridge - 25 sacks cement dumped dry, filled to bottom of
cellar, filled cellar with mud.

MISSION
5-25-59
MAY 25 1959
CONSERVATION DIVISION
Wichita, Kansas

(If additional description is necessary, use BACK of this sheet)
Name of Plugging Contractor Kent Well Servicing company
Address Box 667 El Dorado, Kansas

STATE OF Kansas COUNTY OF Butler, ss.
C. D. Payne (employee of owner) or (owner or operator) of the above-described well, being first duly sworn on oath, says: That I have knowledge of the facts, statements, and matters herein contained and the log of the above-described well as filed and that the same are true and correct. So help me God.

(Signature) C. D. Payne
Box 667 - El Dorado, Kansas
(Address)

SUBSCRIBED AND SWORN TO before me this 23 rd day of May 1959, 19____
Delma H. Stott
Notary Public.

My commission expires 3-14-1960

PLUGGING
FILE SEC. 11 Twp. 26 R. 2E
BOOK PAGE 35 LINE 10

RECEIVED
STATE CORPORATION COMMISSION

JUN 16 1959
6-16-59
CONSERVATION DIVISION
Wichita, Kansas

KANSAS
STATE CORPORATION COMMISSION
CONSERVATION DIVISION AGENT'S REPORT

TO:
Jewel M. Ogden, Director
500 Insurance Building
212 North Market
Wichita 2, Kansas

File No. Hall for file no County: Sedgewick

Location: NW-JESE SW RNS Sec. 11 Twp. 26 Rge. 2 (E) (#)

Name of Field: Greenwich Total Depth: 2846

I have this date completed supervision of plugging of:

Lease Name: Stallie Well No. 25

Operator's Full Name: Alvin J. Berg Co

Complete Address: 813 First National Bank Bldg Wichita Kansas

Plugging Contractor: Wirtwell Leonic

Address: Eldorado Kansas Box 667 License No. 394

Oil Well Gas Well Input Well SWD Well D & A

Other well as hereafter indicated:

Was any delay in plugging operations caused by Conservation Division Agent? Yes No

If yes how long? Reason:

Operation Completed: Hour 5:30 PM Day 5 Month 5 Year 59

The above well was plugged as follows:

→ Pipe out of hole filled to 2589. then set 5 sack cement
with 15" sack bridge and 25 sack cement at 175' mudded to
30' set 5' sack bridge and 25 sack cement which filled
to surface. 2620-85" Pipe Sub. Recovered 193'

Signed: Lee W. Muthill
Conservation Division Agent

Reviewed: Graham
Field Supervisor

Remarks:

PLUGGING
FILE SEC. 11 T. 26 R. 2E
BOOK PAGE 35 LINE 10

Conservation Division
Finney State Office Building
130 S. Market, Rm. 2078
Wichita, KS 67202-3802



Phone: 316-337-6200
Fax: 316-337-6211
<http://kcc.ks.gov/>

Mark Sievers, Chairman
Thomas E. Wright, Commissioner
Shari Feist Albrecht, Commissioner

Sam Brownback, Governor

December 7, 2012

Benjamin M. Giles
346 S. Lulu
Wichita, KS 67211

RE: Table I Exception
M & L Land-Stollei 2 OWWO, NW-SE-SW Sec.11-T26S-R2E, Sedgwick County, Kansas

Dear Mr. Giles:

The Kansas Corporation Commission (KCC) has received your request, dated November 21, 2012, for an exception to the Table 1 minimum surface pipe requirement of 200 feet for the proposed well. From your request, the KCC understands that you are to utilize the existing 155 feet of surface casing in this well bore and Alternate II cementing rules.

After review of this matter by technical staff it was determined that:

1. Bedrock at this location is the Permian Sumner Group and is located at or near surface.
2. The depth of the deepest water well of record within one mile of the proposed location is 148 feet.

Based on this information, an exception is granted for the Table 1 Minimum Surface Casing Requirements with the following stipulations:

1. Dig out and confirm the 13-3/8" casing is in place. Contact the district office when digging out the cellar for an inspection of the casing. The workover cannot proceed without verification of this casing.
2. Upon completion of the well, the production or long string casing nearest the formation wall shall be immediately cemented from a depth of at least **250** feet back to the surface. Notify the KCC District #2 office prior to spudding the well and one day before cementing the longstring so they may have the opportunity to witness the procedure.
3. In the event the well is dry and no additional production pipe has been cemented in-place, plugging will be performed according to KCC rules and KCC District #2 requirements.

Sincerely Yours,

Doug Louis
Director

cc: Steve Bond, Production Dept. ^{SB}
Jeff Klock - Dist #2 ✓ *via e-mail*

December 10, 2012

BEN GILES
Giles, Benjamin M.
346 S. LULU
WICHITA, KS 67211

Re: Drilling Pit Application
M & L LAND - STOLLEI 2 OWWO
SW/4 Sec.11-26S-02E
Sedgwick County, Kansas

Dear BEN GILES:

District staff has inspected the location and has determined that an unsealed condition will present a pollution threat to water resources.

District staff has recommended that the reserve pit be lined. If a plastic liner is to be used it must have a minimum thickness of 6 mil. Integrity of the liner must be maintained at all times.

If production casing is set all completion fluids shall be removed from the working pits daily. NO completion fluids or non-exempt wastes shall be placed in the reserve pit.

The fluids are to be removed from the reserve pit as soon as the Hutchinson Salt section has been drilled through and displacement of the fluids into the reserve pit has occurred. The fluids should be removed again as soon as practical after drilling operations have ceased. The fluids should be taken to an authorized disposal well. Please call the District Office at (316) 630-4000 when the fluids have been removed. Please file form CDP-5 (August 2008), Exploration and Production Waste Transfer, through KOLAR within 30 days of fluid removal.

A copy of this letter should be posted in the doghouse along with the approved Intent to Drill. If you have any questions or concerns please feel free to contact the District Office at (316) 630-4000.