



This Form must be Typed  
Form must be Signed  
All blanks must be Filled

### WELL PLUGGING APPLICATION

Form KSONA-1, Certification of Compliance with the Kansas Surface Owner Notification Act,  
MUST be submitted with this form.

OPERATOR: License #: \_\_\_\_\_  
Name: \_\_\_\_\_  
Address 1: \_\_\_\_\_  
Address 2: \_\_\_\_\_  
City: \_\_\_\_\_ State: \_\_\_\_\_ Zip: \_\_\_\_\_ + \_\_\_\_\_  
Contact Person: \_\_\_\_\_  
Phone: ( \_\_\_\_\_ ) \_\_\_\_\_

API No. 15 - \_\_\_\_\_  
If pre 1967, supply original completion date: \_\_\_\_\_  
Spot Description: \_\_\_\_\_  
\_\_\_\_ - \_\_\_\_ - \_\_\_\_ Sec. \_\_\_\_ Twp. \_\_\_\_ S. R. \_\_\_\_  East  West  
\_\_\_\_ Feet from  North /  South Line of Section  
\_\_\_\_ Feet from  East /  West Line of Section  
Footages Calculated from Nearest Outside Section Corner:  
 NE  NW  SE  SW  
County: \_\_\_\_\_  
Lease Name: \_\_\_\_\_ Well #: \_\_\_\_\_

Check One:  Oil Well  Gas Well  OG  D&A  Cathodic  Water Supply Well  Other: \_\_\_\_\_  
 SWD Permit #: \_\_\_\_\_  ENHR Permit #: \_\_\_\_\_  Gas Storage Permit #: \_\_\_\_\_

Conductor Casing Size: \_\_\_\_\_ Set at: \_\_\_\_\_ Cemented with: \_\_\_\_\_ Sacks  
Surface Casing Size: \_\_\_\_\_ Set at: \_\_\_\_\_ Cemented with: \_\_\_\_\_ Sacks  
Production Casing Size: \_\_\_\_\_ Set at: \_\_\_\_\_ Cemented with: \_\_\_\_\_ Sacks

List (ALL) Perforations and Bridge Plug Sets:

Elevation: \_\_\_\_\_ (  G.L. /  K.B. ) T.D.: \_\_\_\_\_ PBTD: \_\_\_\_\_ Anhydrite Depth: \_\_\_\_\_  
(Stone Corral Formation)

Condition of Well:  Good  Poor  Junk in Hole  Casing Leak at: \_\_\_\_\_  
(Interval)

Proposed Method of Plugging (attach a separate page if additional space is needed):

Is Well Log attached to this application?  Yes  No Is ACO-1 filed?  Yes  No

If ACO-1 not filed, explain why:

**Plugging of this Well will be done in accordance with K.S.A. 55-101 et. seq. and the Rules and Regulations of the State Corporation Commission**

Company Representative authorized to supervise plugging operations: \_\_\_\_\_  
Address: \_\_\_\_\_ City: \_\_\_\_\_ State: \_\_\_\_\_ Zip: \_\_\_\_\_ + \_\_\_\_\_  
Phone: ( \_\_\_\_\_ ) \_\_\_\_\_  
Plugging Contractor License #: \_\_\_\_\_ Name: \_\_\_\_\_  
Address 1: \_\_\_\_\_ Address 2: \_\_\_\_\_  
City: \_\_\_\_\_ State: \_\_\_\_\_ Zip: \_\_\_\_\_ + \_\_\_\_\_  
Phone: ( \_\_\_\_\_ ) \_\_\_\_\_

Proposed Date of Plugging (if known): \_\_\_\_\_

Payment of the Plugging Fee (K.A.R. 82-3-118) will be guaranteed by Operator or Agent

Submitted Electronically



### CERTIFICATION OF COMPLIANCE WITH THE KANSAS SURFACE OWNER NOTIFICATION ACT

*This form must be submitted with all Forms C-1 (Notice of Intent to Drill); CB-1 (Cathodic Protection Borehole Intent); T-1 (Request for Change of Operator Transfer of Injection or Surface Pit Permit); and CP-1 (Well Plugging Application). Any such form submitted without an accompanying Form KSONA-1 will be returned.*

Select the corresponding form being filed:  C-1 (Intent)  CB-1 (Cathodic Protection Borehole Intent)  T-1 (Transfer)  CP-1 (Plugging Application)

OPERATOR: License # \_\_\_\_\_  
Name: \_\_\_\_\_  
Address 1: \_\_\_\_\_  
Address 2: \_\_\_\_\_  
City: \_\_\_\_\_ State: \_\_\_\_\_ Zip: \_\_\_\_\_ + \_\_\_\_\_  
Contact Person: \_\_\_\_\_  
Phone: ( \_\_\_\_\_ ) \_\_\_\_\_ Fax: ( \_\_\_\_\_ ) \_\_\_\_\_  
Email Address: \_\_\_\_\_

Well Location: \_\_\_\_\_  
\_\_\_\_\_ - \_\_\_\_\_ - \_\_\_\_\_ Sec. \_\_\_\_\_ Twp. \_\_\_\_\_ S. R. \_\_\_\_\_  East  West  
County: \_\_\_\_\_  
Lease Name: \_\_\_\_\_ Well #: \_\_\_\_\_

*If filing a Form T-1 for multiple wells on a lease, enter the legal description of the lease below:*

**Surface Owner Information:**

Name: \_\_\_\_\_  
Address 1: \_\_\_\_\_  
Address 2: \_\_\_\_\_  
City: \_\_\_\_\_ State: \_\_\_\_\_ Zip: \_\_\_\_\_ + \_\_\_\_\_

*When filing a Form T-1 involving multiple surface owners, attach an additional sheet listing all of the information to the left for each surface owner. Surface owner information can be found in the records of the register of deeds for the county, and in the real estate property tax records of the county treasurer.*

*If this form is being submitted with a Form C-1 (Intent) or CB-1 (Cathodic Protection Borehole Intent), you must supply the surface owners and the KCC with a plat showing the predicted locations of lease roads, tank batteries, pipelines, and electrical lines. The locations shown on the plat are preliminary non-binding estimates. The locations may be entered on the Form C-1 plat, Form CB-1 plat, or a separate plat may be submitted.*

**Select one of the following:**

- I certify that, pursuant to the Kansas Surface Owner Notice Act (House Bill 2032), I have provided the following to the surface owner(s) of the land upon which the subject well is or will be located: 1) a copy of the Form C-1, Form CB-1, Form T-1, or Form CP-1 that I am filing in connection with this form; 2) if the form being filed is a Form C-1 or Form CB-1, the plat(s) required by this form; and 3) my operator name, address, phone number, fax, and email address.
- I have not provided this information to the surface owner(s). I acknowledge that, because I have not provided this information, the KCC will be required to send this information to the surface owner(s). To mitigate the additional cost of the KCC performing this task, I acknowledge that I am being charged a \$30.00 handling fee, payable to the KCC, which is enclosed with this form.

*If choosing the second option, submit payment of the \$30.00 handling fee with this form. If the fee is not received with this form, the KSONA-1 form and the associated Form C-1, Form CB-1, Form T-1, or Form CP-1 will be returned.*

I Submitted Electronically

Form	CP1 - Well Plugging Application
Operator	White & Ellis Drilling, Inc.
Well Name	ATTERBERRY 1-31
Doc ID	1102684

Perforations And Bridge Plug Sets

Perforation Top	Perforation Base	Formation	Bridge Plug Depth
4412	4416	KC	4749
4394	4402	Pleasantan	

White & Ellis Drilling, Inc.  
Form KSONA-1  
Atterbury 1-31 Lease

Continued—

Brian D. Morris  
4540 N. Baron Creek Ct.  
Bel Aire, KS 67226-4203

Appaloosa Investments L P  
C/O Lipizzan Petroleum Corp  
Bldg 600—Suite F  
8100 E. 22<sup>nd</sup> N.  
Wichita, KS 67226

Glenda S. Sorensen  
4323 Crowley Drive  
Dallas, TX 75229

C. Alan Morris  
6424 SW Castle Lane  
Topeka, KS 66614

Leila T. Patton Revocable  
Trust DTD 07/30/2008  
Leila T. Patton Trustee  
10 Colonial Court  
Wichita, KS 67208

KCC  
Prod - Pleasanton

SIDE ONE

STATE CORPORATION COMMISSION OF KANSAS  
OIL & GAS CONSERVATION DIVISION  
WELL COMPLETION OR RECOMPLETION FORM  
ACO-1 WELL HISTORY

101-21-423

DESCRIPTION OF WELL AND LEASE

Operator license # 5420  
name White & Ellis Drilling, Inc.  
address 401 E. Douglas # 500  
City/State/Zip Wichita, KS 67202

API NO. 15  
County Lane  
NW SW SW Sec 31 Twp 19 Rge 28 East  
(location) Sec Twp Rge East West  
990 Ft North from Southeast Corner of Section  
4950 Ft West from Southeast Corner of Section  
(Note: locate well in section plat below)

Operator Contact Person Michael Considine  
Phone 316-263-1102

Lease Name Atterbury Wells 1-31  
Field Name Unnamed New Pool

Contractor license # 5420  
name White & Ellis Drilling, Inc.

Producing Formation Pleasanton

Wellsite Geologist Ken Wiese  
Phone 316-263-6853  
PURCHASER KOCH

Elevation: Ground 2807 KS 2812

Designate Type of Completion  
 New Well  Re-Entry  Workover

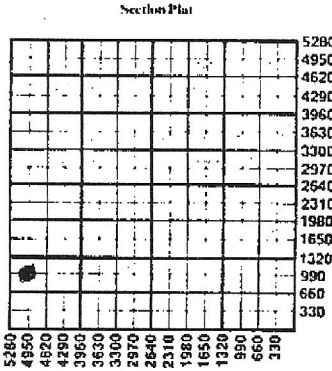

Oil  SWD  Temp Abd  
 Gas  Inj  Delayed Comp.  
 Dry  Other (Coro, Water Supply etc.)

WATER SUPPLY INFORMATION

If QWWQ: old well info as follows:  
Operator  
Well Name  
Comp. Date Old Total Depth

Source of Water:  
Division of Water Resources Permit #  
 Groundwater Ft North From Southeast Corner and (Well) Ft West From Southeast Corner of Sec Twp Rge East West  
 Surface Water Ft North From Southeast Corner and (Stream, Pond etc.) Ft West From Southeast Corner Sec Twp Rge East West  
 Other (explain) City of Dighton (purchased from city, R.W.D.#)

WELL HISTORY  
Drilling Method:  Mud Rotary  Air Rotary  Cable  
10-9-87 10-19-87 10-27-87  
Spud Date Date Reached TD Completion Date  
4750 none  
Total Depth PBTD  
Amount of Surface Pipe Set and Cemented at 307 feet  
Multiple Stage Cementing Collar Used?  Yes  No  
If Yes, Show Depth Set feet  
If alternate 2 completion, cement circulated from feet depth to w/ SX cmt  
2155 & up w/140 sx cmt  
TD to 3310 w/335 sx cmt

Disposition of Produced Water:  Disposal  Repressuring  
Docket #

INSTRUCTIONS: This form shall be completed in duplicate and filed with the Kansas Corporation Commission, 200 Colorado Derby Building, Wichita, Kansas 67202, within 90 days after completion or recompletion of any well. Rules 82-3-130 and 82-3-107 apply.  
Information on side two of this form will be held confidential for a period of 12 months if requested in writing and submitted with the form. See rule 82-3-107 for confidentiality in excess of 12 months.  
One copy of all wireline logs and drillers time log shall be attached with this form. Submit CP-4 form with all plugged wells. Submit CP-111 form with all temporarily abandoned wells.

All requirements of the statutes, rules, and regulations promulgated to regulate the oil and gas industry have been fully complied with and the statements herein are complete and correct to the best of my knowledge.

Signature Michael L. Considine  
Michael L. Considine  
Title Controller Date 1/22/88

Subscribed and sworn to before me this 28th day of January 19 88

Notary Public Carolyn J. Tjaden  
Notary Commission Expires

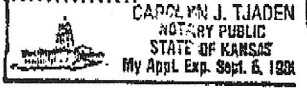

K.C.C. OFFICE USE ONLY  
F  Letter of Confidentiality Attached  
C  Wireline Log Received  
C  Drillers Time Log Received  
Distribution  
 KCC  SWD/Rep  NGPA  
 KGS  Plug  Other (Specify)

Form ACO-1 (7-84)

SIDE TWO

Operator Name White & Ellis Lease Name Attexbury Well# 1-31SEC 31 TWP. 18 RGE. 28  East  West

WELL LOG

**INSTRUCTIONS:** Show important tops and base of formations penetrated. Detail all cores. Report all drill stem tests giving interval tested, time tool open and closed, flowing and shut-in pressures, whether shut-in pressure reached static level, hydrostatic pressures, bottom hole temperature, fluid recovery, and flow rates if gas to surface during test. Attach extra sheet if more space is needed. Attach copy of log.

Drill Stem Tests Taken	<input checked="" type="checkbox"/> Yes	<input type="checkbox"/> No	<table border="0"> <tr> <td colspan="2">Formation Description</td> </tr> <tr> <td><input checked="" type="checkbox"/> Log</td> <td><input type="checkbox"/> Sample</td> </tr> <tr> <td>Name</td> <td>Top Bottom</td> </tr> <tr> <td>ANHYDRITE</td> <td>686</td> </tr> <tr> <td>BASE ANHYDRITE</td> <td>658</td> </tr> <tr> <td>HEEBNER</td> <td>-1167</td> </tr> <tr> <td>LANSING</td> <td>-1210</td> </tr> <tr> <td>MUNCIE CREEK</td> <td>-1391</td> </tr> <tr> <td>STARK</td> <td>-1493</td> </tr> <tr> <td>HUSHPUCKNEY</td> <td>-1533</td> </tr> <tr> <td>BASE KANSAS CITY</td> <td>-1574</td> </tr> <tr> <td>FT. SCOTT</td> <td>-1742</td> </tr> <tr> <td>CHEROKEE SHALE</td> <td>-1764</td> </tr> <tr> <td>MISSISSIPPIAN</td> <td>-1839</td> </tr> <tr> <td>MISS. DOLOMITE</td> <td>-1844</td> </tr> </table>	Formation Description		<input checked="" type="checkbox"/> Log	<input type="checkbox"/> Sample	Name	Top Bottom	ANHYDRITE	686	BASE ANHYDRITE	658	HEEBNER	-1167	LANSING	-1210	MUNCIE CREEK	-1391	STARK	-1493	HUSHPUCKNEY	-1533	BASE KANSAS CITY	-1574	FT. SCOTT	-1742	CHEROKEE SHALE	-1764	MISSISSIPPIAN	-1839	MISS. DOLOMITE	-1844
Formation Description																																	
<input checked="" type="checkbox"/> Log	<input type="checkbox"/> Sample																																
Name	Top Bottom																																
ANHYDRITE	686																																
BASE ANHYDRITE	658																																
HEEBNER	-1167																																
LANSING	-1210																																
MUNCIE CREEK	-1391																																
STARK	-1493																																
HUSHPUCKNEY	-1533																																
BASE KANSAS CITY	-1574																																
FT. SCOTT	-1742																																
CHEROKEE SHALE	-1764																																
MISSISSIPPIAN	-1839																																
MISS. DOLOMITE	-1844																																
Samples Sent to Geological Survey	<input checked="" type="checkbox"/> Yes	<input type="checkbox"/> No																															
Cores Taken	<input type="checkbox"/> Yes	<input type="checkbox"/> No																															

DST #	
1 4386-4502' 45-60-45-60 Rec. 1156' GIP, 150' MCO (75% oil) 525' CO (34) 60' OCM (10% oil) IFP 167#-167#, FFP 311#-356#, ISIP 1272# FSIP 1217#	
#2 4521-4565 30-30-30-30 Rec. 5' Mud with oil spks. IFP 22#-22# FFP 22#-22#, ISIP 56# FSIP 44#	
#3 4547-4585 45-60-45-60, Rec 55' OCM (open 10% oil) IFP 56#-56#, FFP 56#-56#, ISIP 67# FSIP 56#	
#4 4584-4635 30-30-30-30 Rec 5' Oil spked mud, IFP 44#-44#, FFP 44#-44#, ISIP 56# FSIP 56#	

CASING RECORD <input type="checkbox"/> new <input type="checkbox"/> used							
Report all strings set - conductor, surface, intermediate, production, etc.							
Purpose of string	size hole drilled	size casing set (in O.D.)	weight lbs/ft.	setting depth	type of cement	# sacks used	type and percent additives
Surface		8 5/8"		307	60/40 Poz	175	2% gal. 37. CC
Production	7 7/8	5 1/2"	14#	4749	Fixatropic	140	
PERFORATION RECORD				Acid, Fracture, Shot, Cement Squeeze Record			
shots per foot	specify footage of each interval perforated			amount and kind of material used			Depth
4	4412-4416 <i>K.C.</i>			1250 Gal. 15% NE. acid			
3	4394-4402 <i>Pleasanton</i>						
TUBING RECORD							
size 2 3/8		set at 4390		pecker at none		Liner Run <input type="checkbox"/> Yes <input checked="" type="checkbox"/> No	
Date of First Production	Producing method <input type="checkbox"/> flowing <input checked="" type="checkbox"/> pumping <input type="checkbox"/> gas lift <input type="checkbox"/> Other (explain)						
11-7-87							
Estimated Production Per 24 Hours	Oil	Gas	Water	Gas-Oil Ratio	Gravity		
45		none	105		40°		
	Bbls	SCF	Bbls	CFPB			

Disposition of gas:  vented  
 sold  
 used on lease

METHOD OF COMPLETION  
 open hole  perforation  
 other (specify) \_\_\_\_\_  
 Dually Completed.  
 Commingled

PRODUCTION INTERVAL  
 4394-4402

Conservation Division  
Finney State Office Building  
130 S. Market, Rm. 2078  
Wichita, KS 67202-3802



Phone: 316-337-6200  
Fax: 316-337-6211  
<http://kcc.ks.gov/>

Mark Sievers, Chairman  
Thomas E. Wright, Commissioner  
Shari Feist Albrecht, Commissioner

Sam Brownback, Governor

November 28, 2012

Dallas Flowers  
White & Ellis Drilling, Inc.  
PO BOX 48848  
WICHITA, KS 67201-8848

Re: Plugging Application  
API 15-101-21423-00-00  
ATTERBERRY 1-31  
SW/4 Sec.31-19S-28W  
Lane County, Kansas

Dear Dallas Flowers:

This letter is to notify you that the Conservation Division has received your plugging proposal, form CP-1, for the above well and has reviewed the proposal for completeness. The central office will now forward your CP-1 to the district office listed below for review of the proposed plugging method. **Please contact the district office for approval of your proposed plugging method at least five (5) days before plugging the well, pursuant to K.A.R. 82-3-113(b). If a workover pit will be used during the plugging of the well it must be permitted. A CDP-1 form must be filed and approved prior to the use of the pit in accordance with K.A.R. 82-3-600.**

The Conservation Division's review of form CP-1, either in the central or district office, does not include an inquiry into well ownership or the filing operator's legal right to plug the well. This notice in no way constitutes authorization to plug the above well by persons not having legal rights of ownership or interest in the well.

**This notice is void after May 27, 2013. The CP-1 filing does not bring the above well into compliance with K.A.R 82-3-111 with regard to the Commission's temporary abandonment requirements.**

Sincerely,  
Production Department Supervisor

cc: District 1

(620) 225-8888