

**Proposed Plan of Construction**  
 Mosbarger B-1  
 Sec 9 T28S-R33W  
 Haskell County, KS

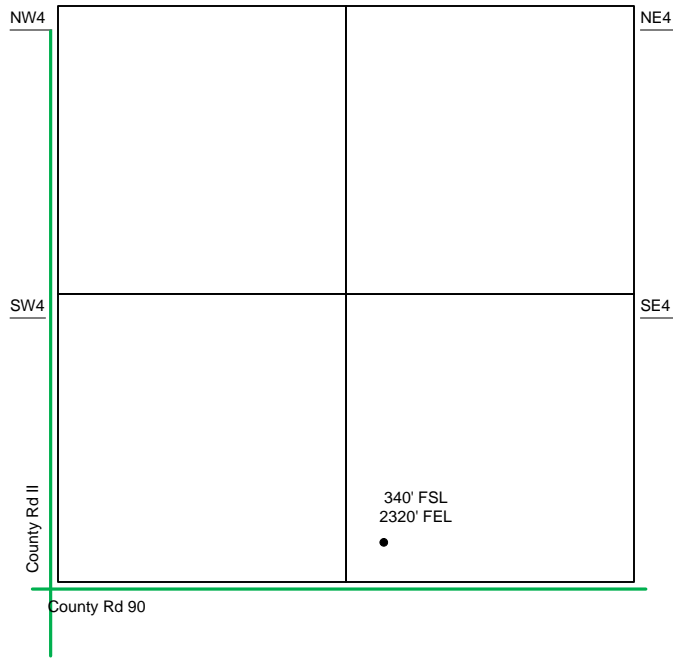

Sec 9 – T28S – R33W

SE/4

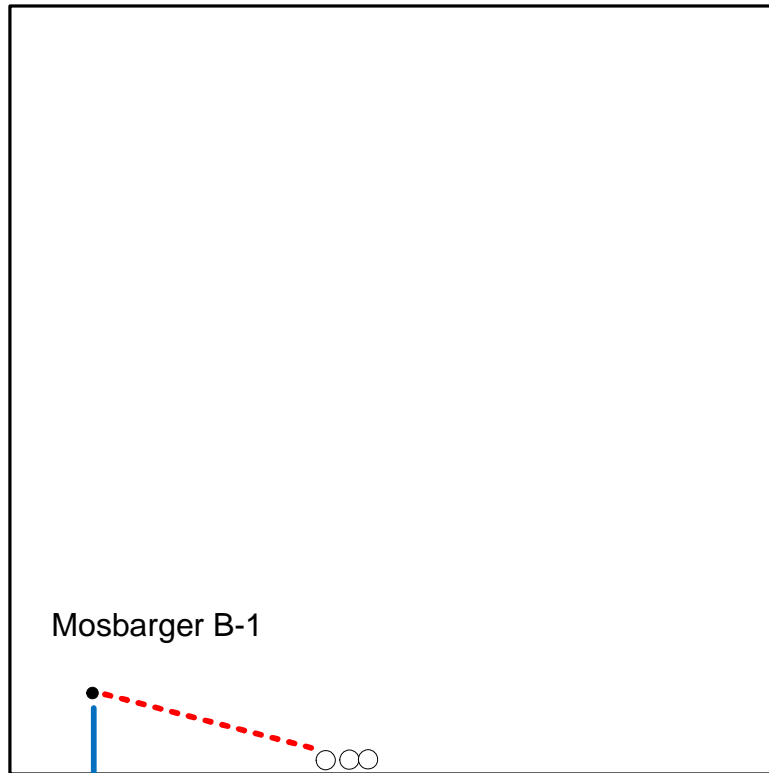

- Well Location
- Proposed Lease Roads
- - - Proposed Pipeline
- Proposed Tank Battery
- Proposed Power Lines
- - - Existing Pipeline

Proposed Details of  
 SE/4 Sec 9 -T28S -R33W

The Tank Battery for the Mosbarger B-1 will be located in the S of the SE quarter.

Note-Drawing **Not** to Scale

