

SGOMI

LOCATION LAYOUT FOR

HEDRICK 2106 #19-1, #19-1H & #19-2H
 Section 19, T21S, R6W, 6th P.M.
 SW 1/4 NE 1/4

FIGURE #1

SCALE: 1" = 60'
 DATE: 09-12-12
 DRAWN BY: C.A.G.
 VERSION: 1.1
 REVISED: 11-16-12
 REVISED BY: C.A.G.

NOTE:
 Berm Designed @ 5'
 Above Grade, Adjust as
 Needed After Determining
 Ground Water Depth

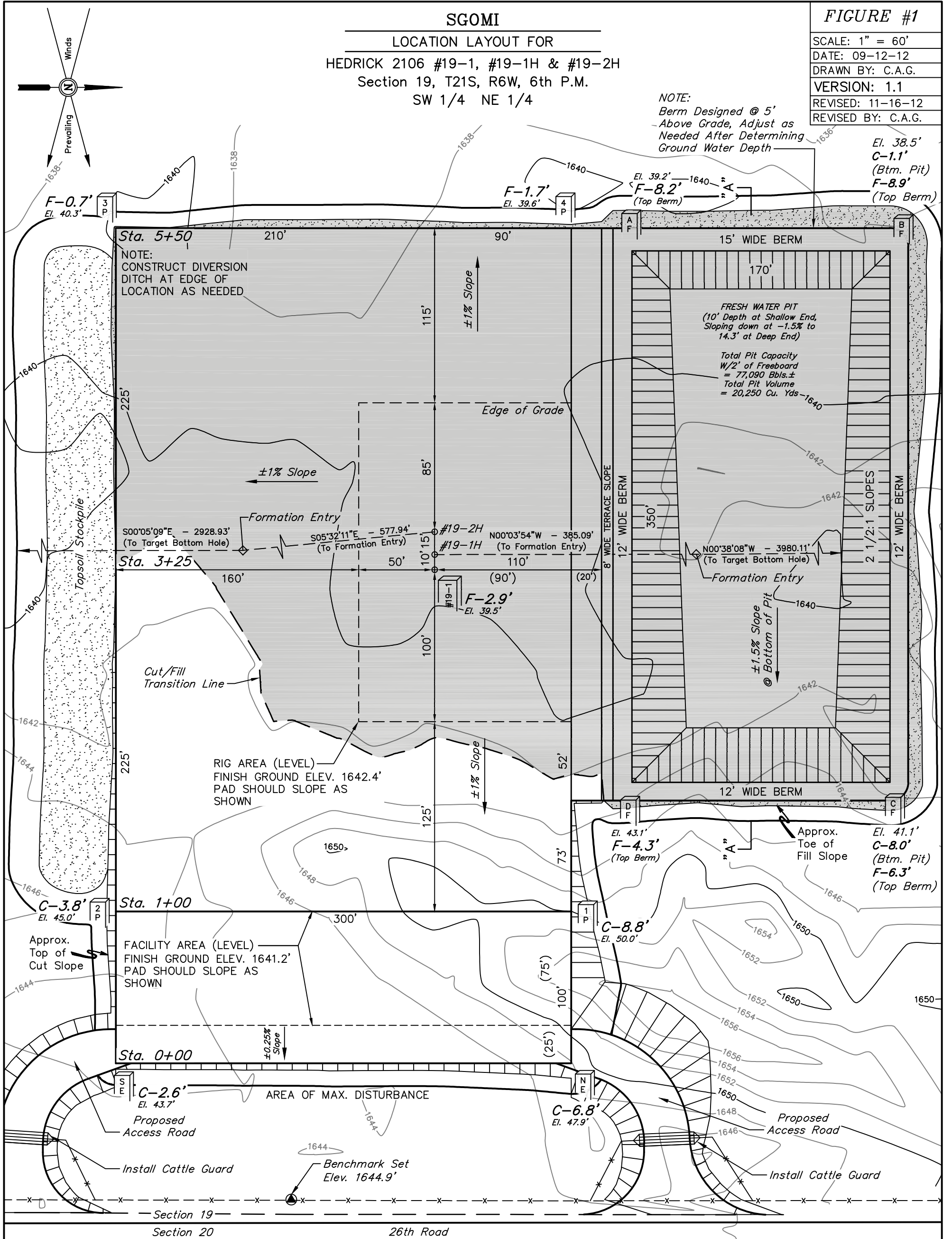

NOTE:
 Earthwork Calculations Require a
 Fill @ the Location Stakes
 For Balance. All Fill is to be
 Compacted to a Minimum of 95%
 of the Maximum Dry Density
 Obtained by AASHTO Method t-99.

BEARINGS AND DISTANCES FROM BENCHMARK TO STAKED POSITIONS					
STAKED POSITION	BEARING	DISTANCE	STAKED POSITION	BEARING	DISTANCE
#19-1 LOCATION STAKE	N77°10'21"W	425.45'	PIT CORNER A	N70°14'07"W	663.91'
#19-1H LOCATION STAKE	N77°28'08"W	435.22'	PAD CORNER B	N57°44'12"W	738.95'
#19-2H LOCATION STAKE	N77°52'46"W	449.86'	PAD CORNER C	N34°50'40"W	481.23'
PAD CORNER 1	N45°49'10"W	264.66'	PAD CORNER D	N50°45'49"W	354.84'
PAD CORNER 2	S58°39'54"W	222.19'	NE FACILITIES CORNER	N25°57'22"W	205.19'
PAD CORNER 3	S79°45'58"W	650.25'	SE FACILITIES CORNER	S37°51'32"W	146.32'
PAD CORNER 4	N73°55'04"W	665.91'			

Elev. Ungraded Ground At #19-1 Loc. Stake = 1639.5'
 FINISHED GRADE ELEV. AT #19-1 LOC. STAKE = 1642.4'

UINTAH ENGINEERING & LAND SURVEYING
 85 So. 200 East * Vernal, Utah 84078 * (435) 789-1017