



APPLICATION FOR COMMINGLING OF PRODUCTION (K.A.R. 82-3-123) OR FLUIDS (K.A.R. 82-3-123a) *Commingling ID # _____*

OPERATOR: License # _____ API No. 15 - _____
Name: _____ Spot Description: _____
Address 1: _____ - - - - - Sec. _____ Twp. _____ S. R. _____ East West
Address 2: _____ Feet from North / South Line of Section
City: _____ State: _____ Zip: _____ + _____ Feet from East / West Line of Section
Contact Person: _____ County: _____
Phone: (_____) _____ Lease Name: _____ Well #: _____

1. Name and upper and lower limit of each production interval to be commingled:
Formation: _____ (Perfs): _____
Formation: _____ (Perfs): _____
Formation: _____ (Perfs): _____
Formation: _____ (Perfs): _____
Formation: _____ (Perfs): _____

2. Estimated amount of fluid production to be commingled from each interval:
Formation: _____ BOPD: _____ MCFPD: _____ BWPD: _____
Formation: _____ BOPD: _____ MCFPD: _____ BWPD: _____
Formation: _____ BOPD: _____ MCFPD: _____ BWPD: _____
Formation: _____ BOPD: _____ MCFPD: _____ BWPD: _____
Formation: _____ BOPD: _____ MCFPD: _____ BWPD: _____

3. Plat map showing the location of the subject well, all other wells on the subject lease, and all wells on offsetting leases within a 1/2 mile radius of the subject well, and for each well the names and addresses of the lessee of record or operator.

4. Signed certificate showing service of the application and affidavit of publication as required in K.A.R. 82-3-135a.

For Commingling of PRODUCTION ONLY, include the following:

- 5. Wireline log of subject well. Previously Filed with ACO-1: Yes No
- 6. Complete Form ACO-1 (*Well Completion form*) for the subject well.

For Commingling of FLUIDS ONLY, include the following:

- 7. Well construction diagram of subject well.
- 8. Any available water chemistry data demonstrating the compatibility of the fluids to be commingled.

AFFIDAVIT: I am the affiant and hereby certify that to the best of my current information, knowledge and personal belief, this request for commingling is true and proper and I have no information or knowledge, which is inconsistent with the information supplied in this application.

Submitted Electronically

KCC Office Use Only
 Denied Approved
15-Day Periods Ends: _____
Approved By: _____ Date: _____

Protests may be filed by any party having a valid interest in the application. Protests must be in writing and comply with K.A.R. 82-3-135b and must be filed within 15 days of publication of the notice of application.

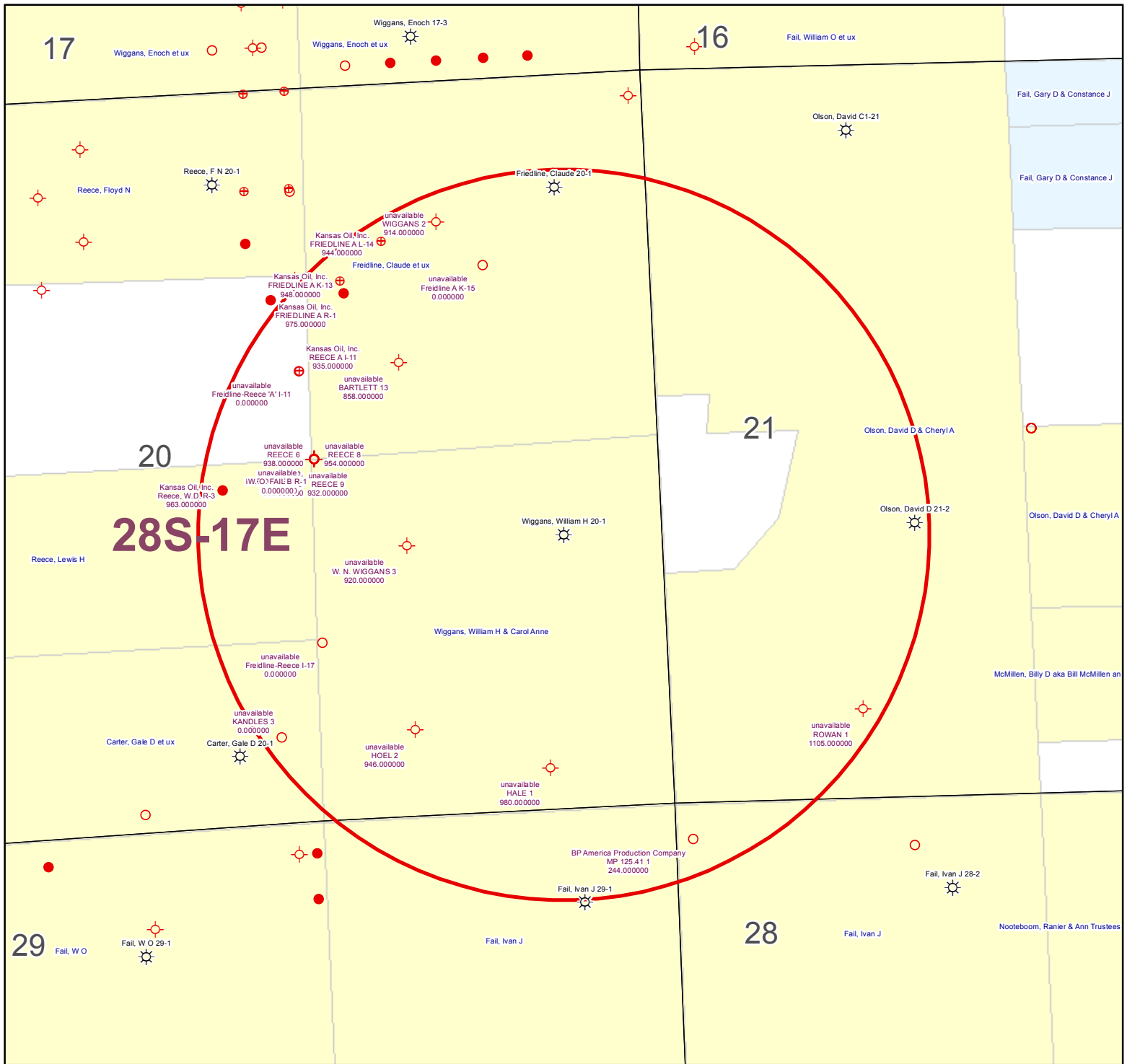

KGS STATUS

⊗	DA/PA
⊕	EOR
☀	GAS
△	INJ/SWD
●	OIL
☀	OIL/GAS
○	OTHER

Wiggins, William H 20-1
 20-28S-17E
 1" = 1,000'

AFFIDAVIT

STATE OF KANSAS \
- SS.
County of Sedgwick /

Mark Fletchall, of lawful age, being first duly sworn, deposeth and saith: That he is Record Clerk of The Wichita Eagle, a daily newspaper published in the City of Wichita, County of Sedgwick, State of Kansas, and having a general paid circulation on a daily basis in said County, which said newspaper has been continuously and uninterruptedly published in said County for more than one year prior to the first publication of the notice hereinafter mentioned, and which said newspaper has been entered as second class mail matter at the United States Post Office in Wichita, Kansas, and which said newspaper is not a trade, religious or fraternal publication and that a notice of a true copy is hereto attached was published in the regular and entire Morning issue of said The Wichita Eagle for 1 issues, that the first publication of said notice was

made as aforesaid on the 17th of

January A.D. 2013, with

subsequent publications being made on the following dates:

And affiant further says that he has personal knowledge of the statements above set forth and that they are true.

Mark Fletchall

Subscribed and sworn to before me this

17th day of January, 2013

PENNY L CASE
Notary Public, State of Kansas
My Appt. Expires 5/28/2014

Penny L Case
Notary Public Sedgwick County, Kansas

Printer's Fee : \$132.40

LEGAL PUBLICATION
PUBLISHED IN THE WICHITA EAGLE
JANUARY 17, 2013 (3227036)
BEFORE THE STATE CORPORATION
COMMISSION OF THE STATE OF KANSAS
NOTICE OF FILING APPLICATION
RE: In the Matter of Postrock Midcontinent
Production, LLC Application for
Commingle of Production in the
Wiggins, William H 20-1 located in Wilson
County, Kansas.
TO: All Oil & Gas Producers, Unleased Mineral
Interest Owners, Landowners, and all
persons whomsoever concerned.
You, and each of you, are hereby notified
that Postrock Midcontinent Production, LLC
has filed an application to commingle the
Summit, Mulky, bevier, Croweburg, Fleming,
Rowe, Neutral, Riverton and Cattleman
producing formations at the Wiggins,
William H 20-1, located in the NE SW NE SE,
S20-T26S-R17E, Approximately 1976 FSL &
708 FEL, Wilson County, Kansas.
Any persons who object to or protest
this application shall be required to file their
objections or protest with the Conservation
Division of the State Corporation Commission
of the State of Kansas within fifteen (15)
days from the date of this publication. These
protests shall be filed pursuant to Commission
regulations and must state specific reasons
why granting the application may cause waste,
violate correlative rights or pollute the natural
resources of the State of Kansas.
All persons interested or concerned shall
take notice of the foregoing and shall govern
themselves accordingly. All person and/or
companies wishing to protest this application
are required to file a written protest with the
Conservation Division of the Kansas Oil and
Gas Commission.
Upon the receipt of any protest, the
Commission will convene a hearing and
protestants will be expected to enter an
appearance either through proper legal
counsel or as individuals, appearing on their
own behalf.
Postrock Midcontinent Production, LLC
210 Park Avenue, Suite 2750
Oklahoma City, Oklahoma 73102
(405) 660-7704

Affidavit of Notice Served

Re: Application for: APPLICATION FOR COMMINGLING OF PRODUCTION OR FLUIDS ACO-4

Well Name: WIGGANS, WILLIAM H 20-1 Legal Location: NESWNESE S20-T28S-R17E

The undersigned hereby certifies that he / she is a duly authorized agent for the applicant, and that on the day 28TH of JANUARY, 2013, a true and correct copy of the application referenced above was delivered or mailed to the following parties:

Note: A copy of this affidavit must be served as a part of the application.

Name

Address (Attach additional sheets if necessary)

SEE ATTACHED

I further attest that notice of the filing of this application was published in the WILSON COUNTY CITIZEN, the official county publication of WILSON county. A copy of the affidavit of this publication is attached.

Signed this 28TH day of JANUARY, 2013

Applicant or Duly Authorized Agent

Subscribed and sworn to before me this 28th day of JANUARY, 2013



Jennifer R. Beal
Notary Public

My Commission Expires: July 20, 2014

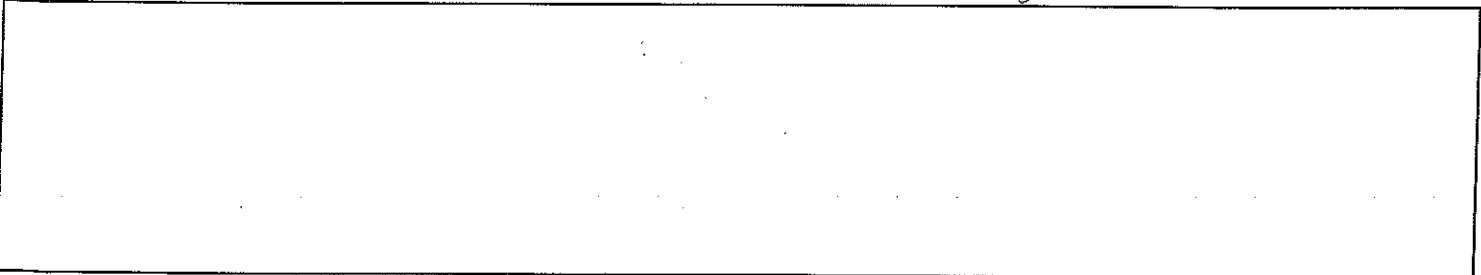

WIGGANS, WILLIAM 20-1

LEGAL LOCATION	SPOT	CURR_OPERA	ADDRESS
S28-T28S-R17E	NW NW NW	BP America Production Company	2225 W OKLAHOMA AVE, ULYSSES, KS 67880
S20-T28S-R17E	NW SW NE	Kansas Oil, Inc.	16716 WICHITA RD, CHANUTE, KS 66720
S20-T28S-R17E	NE	Kansas Oil, Inc.	16716 WICHITA RD, CHANUTE, KS 66720
S20-T28S-R17E	NW NW SW NE	Kansas Oil, Inc.	16716 WICHITA RD, CHANUTE, KS 66720
S20-T28S-R17E	SW NE	Kansas Oil, Inc.	16716 WICHITA RD, CHANUTE, KS 66720
S20-T28S-R17E	NW NE NE SW	Kansas Oil, Inc.	16716 WICHITA RD, CHANUTE, KS 66720

WIGGANS, WILLIAM 20-1

20-28S-17E

S2 NW4 less 4 acre tract

C.K. Reece

315 LAMBETH RD

Waterloo, IA 50701

21-28S-17E

Tract in W/2

Jason & Jaime Costin

15543 Wichita Rd

Chanute, KS 66720

WIGGANS, WILLIAM 20-1

LEGAL LOCATION	SPOT	CURR_OPERA	ADDRESS
S28-T28S-R17E	NW NW NW	BP America Production Company	2225 W OKLAHOMA AVE, ULYSSES, KS 67880
S20-T28S-R17E	NW SW NE	Kansas Oil, Inc.	16716 WICHITA RD, CHANUTE, KS 66720
S20-T28S-R17E	NE	Kansas Oil, Inc.	16716 WICHITA RD, CHANUTE, KS 66720
S20-T28S-R17E	NW NW SW NE	Kansas Oil, Inc.	16716 WICHITA RD, CHANUTE, KS 66720
S20-T28S-R17E	SW NE	Kansas Oil, Inc.	16716 WICHITA RD, CHANUTE, KS 66720
S20-T28S-R17E	NW NE NE SW	Kansas Oil, Inc.	16716 WICHITA RD, CHANUTE, KS 66720

WIGGANS, WILLIAM 20-1

20-28S-17E

S2 NW4 less 4 acre tract

C.K. Reece

315 LAMBETH RD

Waterloo, IA 50701

21-28S-17E

Tract in W/2

Jason & Jaime Costin

15543 Wichita Rd

Chanute, KS 66720

PROOF OF PUBLICATION

STATE OF KANSAS
Wilson County - SS

JOSEPH S. and RITA M. RELPH, of lawful age, being duly sworn upon oath that they are the Owners and Publishers of the WILSON COUNTY CITIZEN:

THAT said newspaper has been published at least weekly fifty (50) times a year and has been so published for at least five years prior to the first publication of the attached notice:

THAT said newspaper is a general circulation on a daily, or weekly, or monthly, or yearly basis in;

WILSON COUNTY, KANSAS and is NOT a trade, religious or fraternal publication and has been PRINTED and PUBLISHED in Wilson County, Kansas.

THE ATTACHED was published on the following dates in a regular issue of said newspaper:

1st publication was made on the 21st day of January, 2013

2nd publication was made on the _____ day of _____, 20_____

3rd publication was made on the _____ day of _____, 20_____

4th publication was made on the _____ day of _____, 20_____

5th publication was made on the _____ day of _____, 20_____

6th publication was made on the _____ day of _____, 20_____

TOTAL PUBLICATION FEE: \$ 37.73

(Signed) Joseph S. Relph

Subscribed and sworn to before me, this 27th day of January, 2013

Rita M. Relph (Notary Public)

My commission expires Aug. 30, 2014

(Published in the Wilson County Citizen on <pm> day, January 21, 2013.

BEFORE THE STATE CORPORATION COMMISSION OF THE STATE OF KANSAS

NOTICE OF FILING APPLICATION

RE: In the Matter of Postrock Midcontinent Production, LLC Application for Commingling of Production in the Wiggans, William H 20-1 located in Wilson County, Kansas.

TO: All Oil & Gas Producers, Unleased Mineral Interest Owners, Landowners, and all persons whomsoever concerned.

You, and each of you, are hereby notified that Postrock Midcontinent Production, LLC has filed an application to commingle the Summit, Mulky, bevier, Croweburg, Fleming, Rowe, Neutral, River-ton and Cattleman producing formations at the Wiggans, William H 20-1, located in the NE SW NE SE, S20-T28S-R17E, Approximately 1976 FSL & 708 FEL, Wilson County, Kansas.

Any persons who object to or protest this application shall be required to file their objections or protest with the Conservation Division of the State Corporation Commission of the State of Kansas within fifteen (15) days from the date of this publication. These protests shall be filed pursuant to Commission regulations and must state specific reasons why granting the application may cause waste, violate correlative rights or pollute the natural resources of the State of Kansas.

All persons interested or concerned shall take notice of the foregoing and shall govern themselves accordingly. All person and/or companies wishing to protest this application are required to file a written protest with the Conservation Division of the Kansas Oil and Gas Commission.

Upon the receipt of any protest, the Commission will convene a hearing and protestants will be expected to enter an appearance either through proper legal counsel or as individuals, appearing on their own behalf.

Postrock Midcontinent Production, LLC
210 Park Avenue, Suite 2750
Oklahoma City, Oklahoma 73102
(405) 680-7704
97 1 cpy.

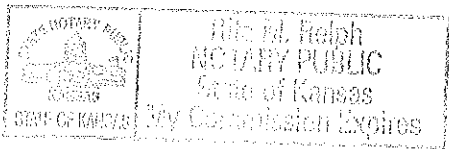

February 12, 2013

Clark Edwards
PostRock Midcontinent Production LLC
Oklahoma Tower
210 Park Ave, Ste 2750
Oklahoma City, OK 73102

RE: Approved Commingling CO011316
Wiggans, William H. 20-1, Sec. 20-T28S-R17E, Wilson County
API No. 15-205-26836-00-00

Dear Mr. Edwards:

Your Application for Commingling (ACO-4) for the above described well, received by the KCC on January 29, 2013, has been reviewed and approved by the Kansas Corporation Commission (KCC) per K.A.R. 82-3-123. Notice was examined and found to be proper per K.A.R. 82-3-135a. No protest had been filed within the 15-day protest period.

Based upon the depth of the Riverton formation perforations, total oil production shall not exceed 100 BOPD and total gas production shall not exceed 50% of the absolute open flow (AOF).

File form ACO-1 upon re-completion of the well to commingle.

Commingling ID number CO011316 has been assigned to this approved application. Use this number for well completion reports (ACO-1) and other correspondence that may concern this approved commingling.

Sincerely,

Rick Hestermann
Production Department