

Proposed Plan of Construction

Birney Trust B-2
Sec 24 T29S-R33W
Haskell County, KS

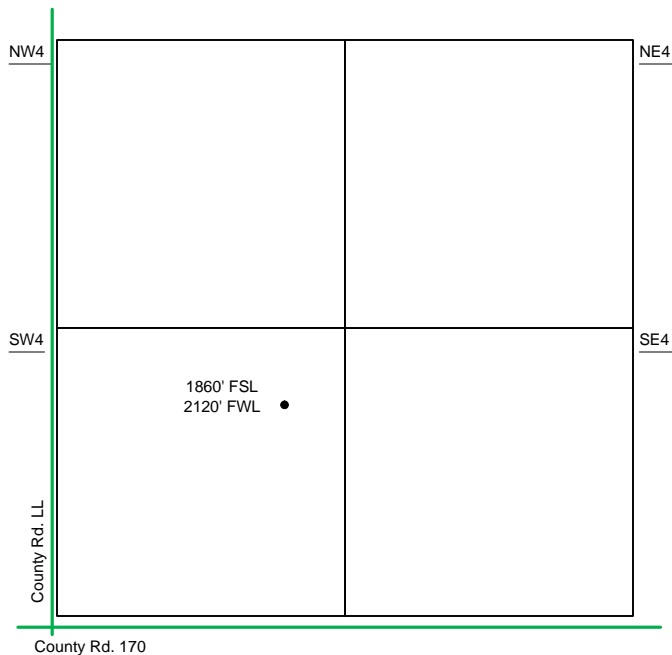

Sec 24 - T29S - R33W

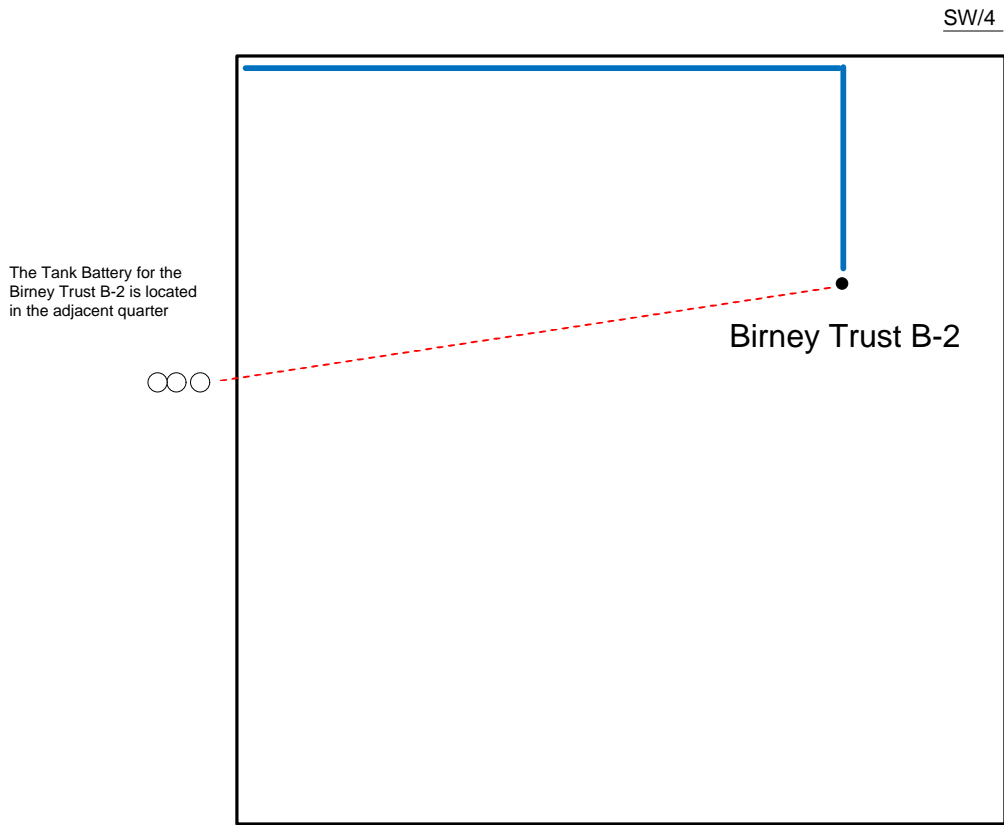

Proposed Details of
SW/4 Sec 24 -T29S -R33W

- Well Location
- Proposed Lease Roads
- - - Proposed Pipeline
- Proposed Tank Battery
- Proposed Power Lines
- - - Existing Pipeline

Note-Drawing **Not** to Scale

Proposed Site Diagram
Birney Trust B-2
December 4, 2012

