

**NEW GULF OPERATING, LLC  
ST. JOSEPH LEASE  
S. 1/2, SECTION 10, T12S, R32W  
LOGAN COUNTY, KANSAS**

GRAVEL (YUMA ROAD) ROAD

Notes:

1. Set (2) wood stakes at location site.
2. All flogging Red & Yellow.
3. Overhead power available at N. & E. lines. Sec. 10.
4. Kansas One Call System Inc. should be notified before excavation (1-800-344-7233).
5. CAUTION: Various pipelines in Sec. 10.
6. Cattle in stubble at date of staking.
7. Contact landowner for best access.

ROAD

1430 ROAD

GRAVEL

10

83

HIGHWAY

Drillsite Location  
St. Joseph #1-10  
592'FSL 2595'FWL

Ground Elevation = 3002

Y = 262806 X = 1187594

Tanks State Plane-NAD 27-Kansas North  
(Mapping Grade GPS Used)

STUBBLE

ELECTRIC WIRE FENCE  
& CROPLINE 100' W.  
OF LOCATION

STUBBLE

Lease Road (WAGON ROAD)

GRAVEL

FIELD ENTRANCE

ROAD

SCALE 1" = 1000'

Egress and egress to location as shown on this plot is per usage only and may not be legally opened for public use. Contact landowner, tenant and county road department for access.

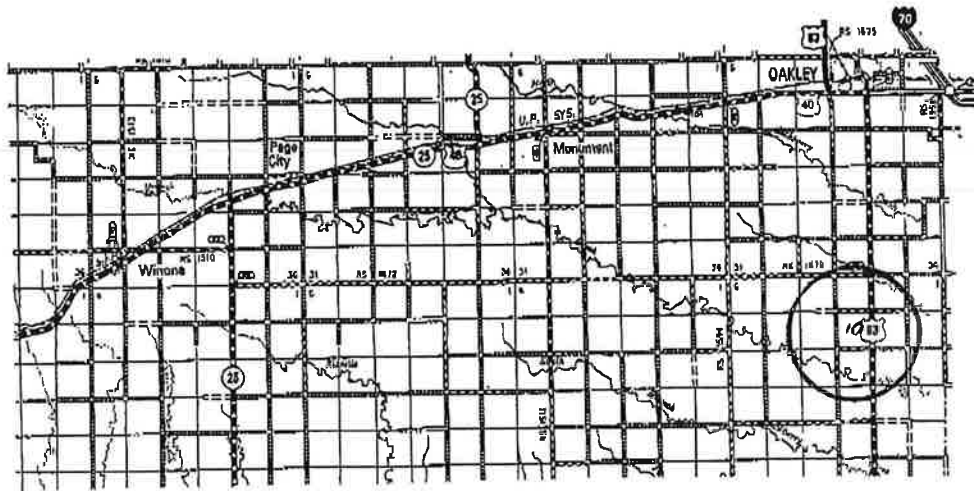

• Controlling data is based upon the best maps and photographs available to us and upon a regular section of land containing 640 acres.  
• Appropriate section lines were determined using the normal standard of care of oilfield surveyors practicing in the state of Kansas. The section corners, when established the precise section lines, were not necessarily located, and the exact location of the drillsite location in the section is not guaranteed. Therefore, the Operator securing this service and occupying this plot and all other parties relying thereon agree to hold Central Kansas Oilfield Services, Inc., its officers and employees harmless from all losses, costs and expenses and said entities released from any liability from incidental or consequential damages.  
• Elevations derived from NATIONAL Geodetic Vertical Datum.

Date November 15, 2012