

Pro-Stake LLC
 Oil Field & Construction Site Staking
 P.O. Box 2324
 Garden City, Kansas 67846
 Office/Fax: (620) 276-6159
 Cell: (620) 272-1499

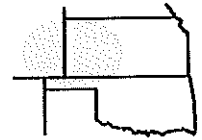

192722bar
 PLAT NO.

10546
 INVOICE NO.

Ritchie Exploration Inc.

OPERATOR

#1 Riegel 28AD

LEASE NAME

Ford County, KS

COUNTY

28 27s 22w
 Sec. Twp. Rng.

2305' FSL - 2000' FEL

LOCATION SPOT

GR. ELEVATION: **2419.1'**

SCALE: **1" = 1000'**
 DATE: **Dec 11th, 2012**
 MEASURED BY: **Luke R.**
 DRAWN BY: **Drew H.**
 AUTHORIZED BY: **Justin C.**



Directions: From the center of Ford Ks. at the intersection of Hwy 400/Main St & 9th St. - Now go 1.8 miles North on Hwy 400 - Now go 1.5 miles East on Ridge Rd to SE corner of 28-27s-22w - Now go 0.4 North on 127 Rd to ingress stake West into - Now go 2000' West through wheat stubble into staked location.
Final ingress must be verified with land owner or Operator.

*This drawing does not constitute a monumented survey or a land survey plat.
 This drawing is for construction purposes only.*

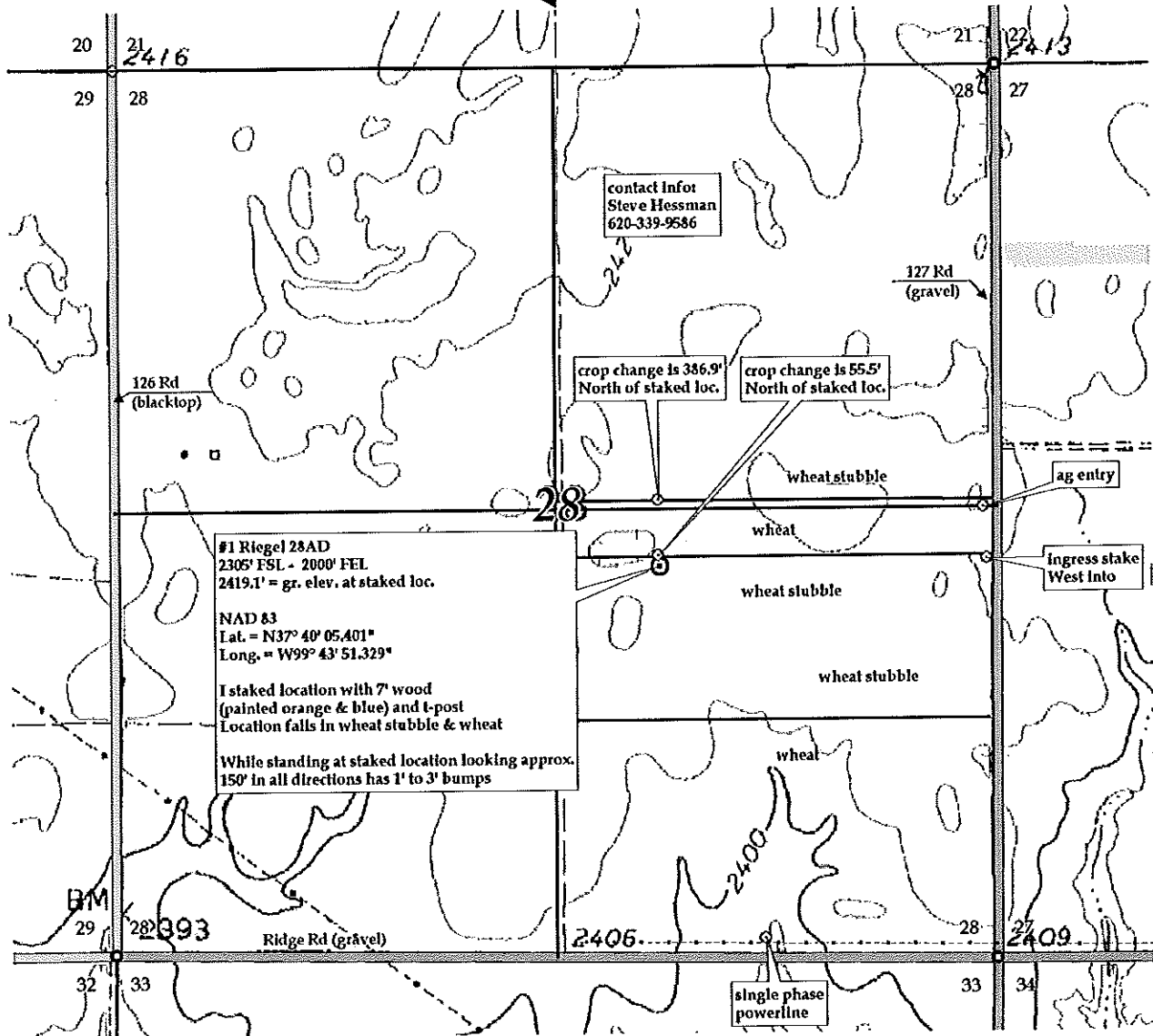

KANSAS SURFACE OWNER NOTIFICATION ACT

R 22 W

T
27
S

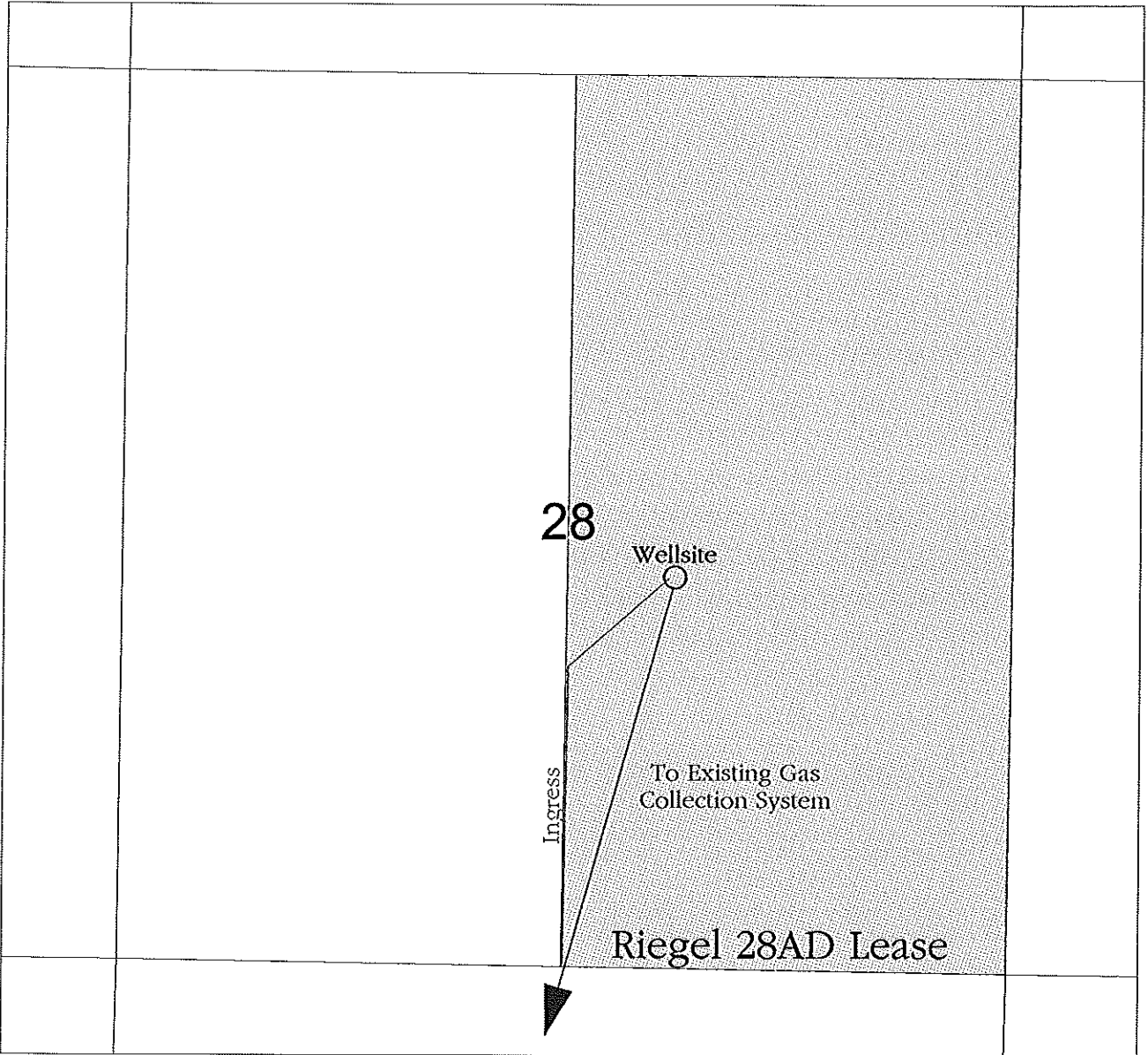

SCALE = 1 : 12,000

FORD COUNTY, KANSAS