

SGOMI

LOCATION LAYOUT FOR

REFFNER 2308 #4-1, #4-1HN, #4-1HS & #4-2HS
SECTION 4, T23S, R8W, 6th P.M.
LOT 3

FIGURE #1

SCALE: 1" = 60'

DATE: 11-30-12

DRAWN BY: C.A.G.

VERSION: 1.0

REVISED:

REVISED BY:

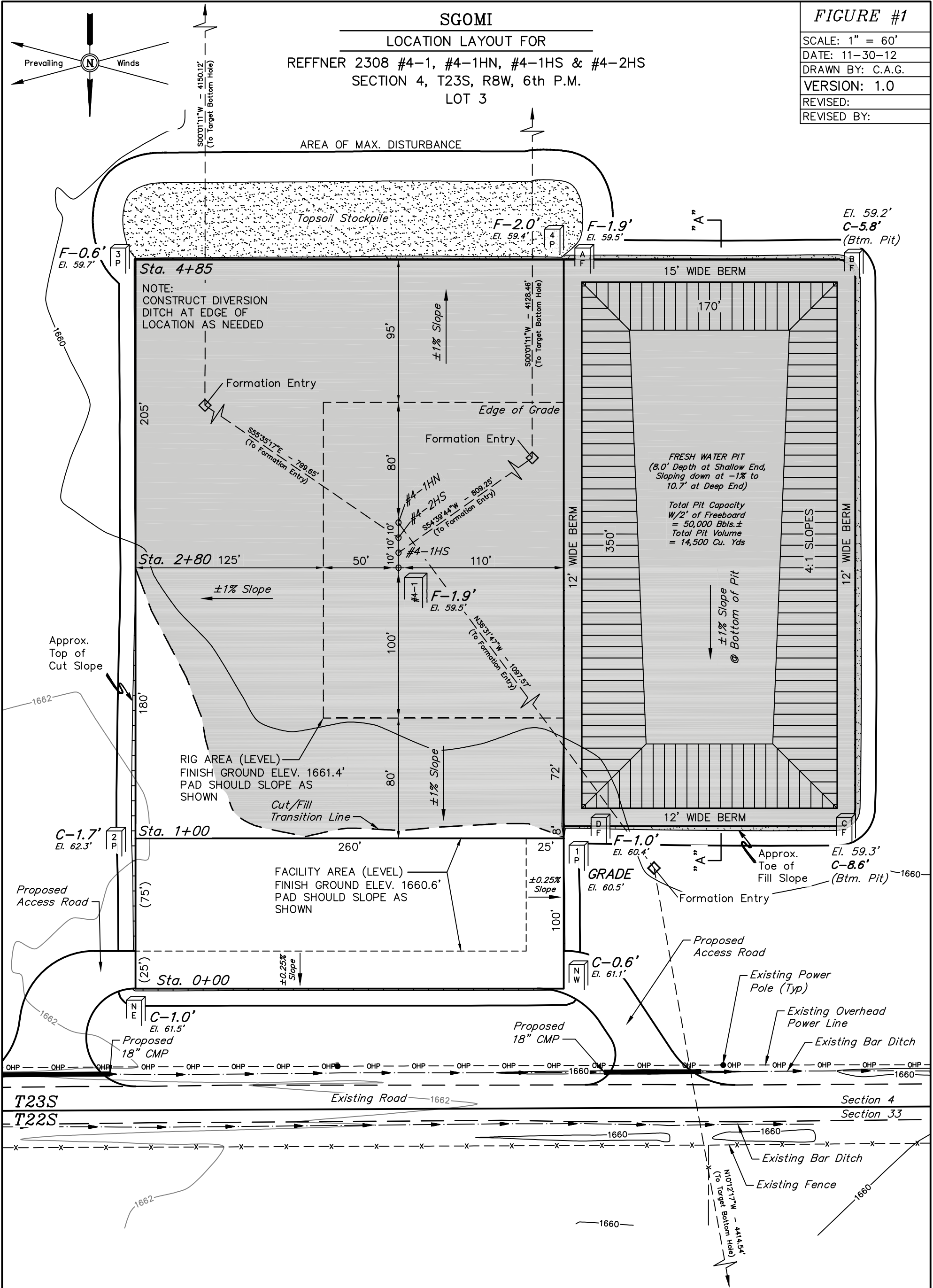

NOTE:
Earthwork Calculations Require a Fill @ the Location Stakes For Balance. All Fill is to be Compacted to a Minimum of 95% of the Maximum Dry Density Obtained by AASHTO Method t-99.

| BEARINGS AND DISTANCES FROM BENCHMARK TO STAKED POSITIONS | | | | | |
|---|-------------|----------|----------------------|-------------|----------|
| STAKED POSITION | BEARING | DISTANCE | STAKED POSITION | BEARING | DISTANCE |
| #4-1 LOCATION STAKE | S56°43'07"W | 328.07' | PIT CORNER A | S46°57'39"W | 542.18' |
| #4-1H LOCATION STAKE | S55°16'59"W | 333.67' | PAD CORNER B | S56°50'20"W | 676.47' |
| PAD CORNER 1 | S89°59'42"W | 384.27' | PAD CORNER C | S87°58'38"W | 566.63' |
| PAD CORNER 2 | S89°59'39"W | 99.24' | PAD CORNER D | S87°06'08"W | 396.75' |
| PAD CORNER 3 | S14°27'24"W | 397.62' | NW FACILITIES CORNER | N75°24'57"W | 397.09' |
| PAD CORNER 4 | S44°56'46"W | 543.96' | NE FACILITIES CORNER | N44°47'28"W | 140.89' |

Elev. Ungraded Ground At #4-1 Loc. Stake = 1659.5'
FINISHED GRADE ELEV. AT #4-1 LOC. STAKE = 1661.4'