



**APPLICATION FOR COMMINGLING OF PRODUCTION (K.A.R. 82-3-123) OR FLUIDS (K.A.R. 82-3-123a)** *Commingling ID #* \_\_\_\_\_

OPERATOR: License # \_\_\_\_\_ API No. 15 - \_\_\_\_\_  
Name: \_\_\_\_\_ Spot Description: \_\_\_\_\_  
Address 1: \_\_\_\_\_ - - - - - Sec. \_\_\_\_\_ Twp. \_\_\_\_\_ S. R. \_\_\_\_\_  East  West  
Address 2: \_\_\_\_\_ Feet from  North /  South Line of Section  
City: \_\_\_\_\_ State: \_\_\_\_\_ Zip: \_\_\_\_\_ + \_\_\_\_\_ Feet from  East /  West Line of Section  
Contact Person: \_\_\_\_\_ County: \_\_\_\_\_  
Phone: ( \_\_\_\_\_ ) \_\_\_\_\_ Lease Name: \_\_\_\_\_ Well #: \_\_\_\_\_

1. Name and upper and lower limit of each production interval to be commingled:  
Formation: \_\_\_\_\_ (Perfs): \_\_\_\_\_  
Formation: \_\_\_\_\_ (Perfs): \_\_\_\_\_  
Formation: \_\_\_\_\_ (Perfs): \_\_\_\_\_  
Formation: \_\_\_\_\_ (Perfs): \_\_\_\_\_  
Formation: \_\_\_\_\_ (Perfs): \_\_\_\_\_

2. Estimated amount of fluid production to be commingled from each interval:  
Formation: \_\_\_\_\_ BOPD: \_\_\_\_\_ MCFPD: \_\_\_\_\_ BWPD: \_\_\_\_\_  
Formation: \_\_\_\_\_ BOPD: \_\_\_\_\_ MCFPD: \_\_\_\_\_ BWPD: \_\_\_\_\_  
Formation: \_\_\_\_\_ BOPD: \_\_\_\_\_ MCFPD: \_\_\_\_\_ BWPD: \_\_\_\_\_  
Formation: \_\_\_\_\_ BOPD: \_\_\_\_\_ MCFPD: \_\_\_\_\_ BWPD: \_\_\_\_\_  
Formation: \_\_\_\_\_ BOPD: \_\_\_\_\_ MCFPD: \_\_\_\_\_ BWPD: \_\_\_\_\_

3. Plat map showing the location of the subject well, all other wells on the subject lease, and all wells on offsetting leases within a 1/2 mile radius of the subject well, and for each well the names and addresses of the lessee of record or operator.

4. Signed certificate showing service of the application and affidavit of publication as required in K.A.R. 82-3-135a.

**For Commingling of PRODUCTION ONLY, include the following:**

- 5. Wireline log of subject well. Previously Filed with ACO-1:  Yes  No
- 6. Complete Form ACO-1 (*Well Completion form*) for the subject well.

**For Commingling of FLUIDS ONLY, include the following:**

- 7. Well construction diagram of subject well.
- 8. Any available water chemistry data demonstrating the compatibility of the fluids to be commingled.

**AFFIDAVIT:** I am the affiant and hereby certify that to the best of my current information, knowledge and personal belief, this request for commingling is true and proper and I have no information or knowledge, which is inconsistent with the information supplied in this application.

**Submitted Electronically**

**KCC Office Use Only**  
 Denied  Approved  
15-Day Periods Ends: \_\_\_\_\_  
Approved By: \_\_\_\_\_ Date: \_\_\_\_\_

*Protests may be filed by any party having a valid interest in the application. Protests must be in writing and comply with K.A.R. 82-3-135b and must be filed within 15 days of publication of the notice of application.*



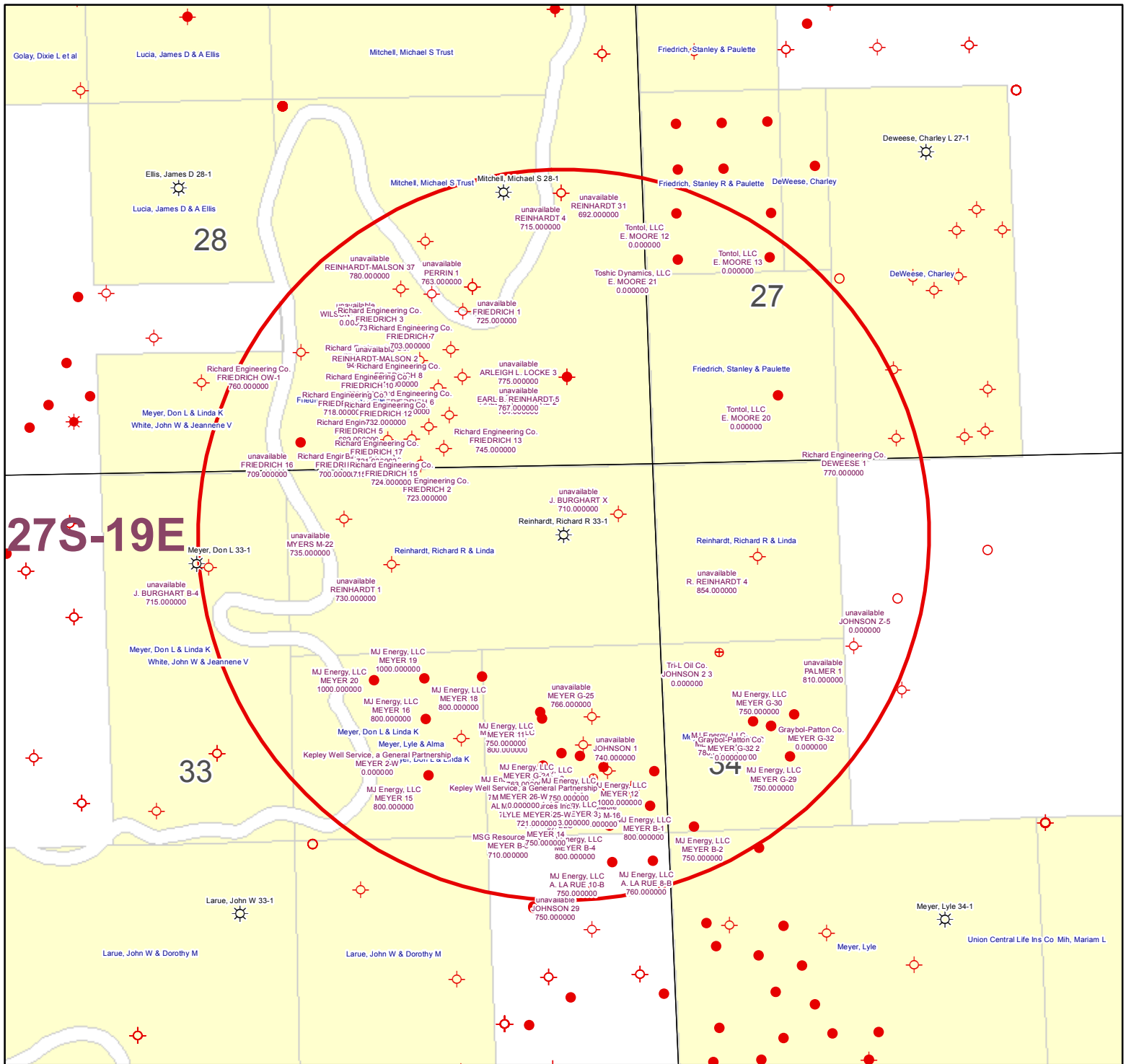

KGS STATUS	
⊕	DA/PA
⊗	EOR
☀	GAS
△	INJ/SWD
●	OIL
☀	OIL/GAS
○	OTHER

Reinhardt, Richard R 33-1  
 33-27S-19E  
 1" = 1,000'

BEFORE THE STATE CORPORATION COMMISSION OF THE STATE OF KANSAS  
**NOTICE OF FILING APPLICATION**

RE: In the Matter of **Postrock Midcontinent Production, LLC** Application for Commingling of Production in the **Reinhardt, Richard R 33-1** located in **Neosho County, Kansas.**

TO: All Oil & Gas Producers, Un-leased Mineral Interest Owners, Landowners, and all persons whomever concerned.

You, and each of you, are hereby notified that **Postrock Midcontinent Production, LLC** has filed an application to commingling the **Summit, Mulky, Croweburg, Fleming, Welr, Rowe, Neutral, Riverton and Cattleman** producing formations at the **Reinhardt, Richard R 33-1**, located in the **NE NE, S33-T27S-R19E, Approximately 500 FNL & 660 FEL, Neosho County, Kansas.**

Any persons who object to or protest this application shall be required to file their objections or protest with the Conservation Division of the State Corporation Commission of the State of Kansas within fifteen (15) days from the date of this publication. These protests shall be filed pursuant to Commission regulations and must state specific reasons why granting the application may cause waste, violate correlative rights or pollute the natural resources of the State of Kansas.

All persons interested or concerned shall take notice of the foregoing and shall govern themselves accordingly. All person and/or companies wishing to protest this application are required to file a written protest with the Conservation Division of the Kansas Oil and Gas Commission.

Upon the receipt of any protest, the Commission will convene a hearing and protestants will be expected to enter an appearance either through proper legal counsel or as individuals, appearing on their own behalf.

**Postrock Midcontinent Production, LLC**  
210 Park Avenue, Suite 2750  
Oklahoma City, Oklahoma  
73102  
(405) 660-7704

A COPY OF THE AFFIDAVIT OF PUBLICATION MUST ACCOMPANY ALL APPLICATIONS

**Affidavit of Publication**

STATE OF KANSAS, NEOSHO COUNTY, ss:  
*Rhonda Howerter*, being first duly sworn, deposes and says: That *she* is *Classified Manager* of *THE CHANUTE TRIBUNE*, a daily newspaper printed in the State of Kansas, and published in and of general circulation in Neosho County, Kansas, with a general paid circulation on a daily basis in Neosho County, Kansas, and that said newspaper is not a trade, religious or fraternal publication.

Said newspaper is a daily published at least weekly 50 times a year: has been so published continuously and uninterruptedly in said county and state for a period of more than five years prior to the first publication of said notice; and has been admitted at the post office of Chanute, in said county as second class matter.

That the attached notice is a true copy thereof and was published in the regular and entire issue of said newspaper for 1 consecutive time, the first publication thereof being made as aforesaid on the 16 day of January 2012 with subsequent publications being made on the following dates:

\_\_\_\_\_, 2012 \_\_\_\_\_, 2012  
\_\_\_\_\_, 2012 \_\_\_\_\_, 2012

*Rhonda Howerter*

Subscribed and sworn to and before me this 16 day of January, 2012

*[Signature]*  
\_\_\_\_\_  
Notary Public

My commission expires: January 9, 2015

Printer's Fee ..... \$ 67.34

Affidavit, Notary's Fee ..... \$ 3.00

Additional Copies ..... \$ \_\_\_\_\_

**Total Publication Fees** ..... \$ 70.34

 **SHANNA L. GUIOT**  
Notary Public - State of Kansas  
My Appt. Expires 1-9-15

**AFFIDAVIT**

STATE OF KANSAS \
- SS.
County of Sedgwick /

Mark Fletchall, of lawful age, being first duly sworn, depose and saith: That he is Record Clerk of The Wichita Eagle, a daily newspaper published in the City of Wichita, County of Sedgwick, State of Kansas, and having a general paid circulation on a daily basis in said County, which said newspaper has been continuously and uninterruptedly published in said County for more than one year prior to the first publication of the notice hereinafter mentioned, and which said newspaper has been entered as second class mail matter at the United States Post Office in Wichita, Kansas, and which said newspaper is not a trade, religious or fraternal publication and that a notice of a true copy is hereto attached was published in the regular and entire Morning issue of said The Wichita Eagle for 1 issues, that the first publication of said notice was

made as aforesaid on the 17th of

January A.D. 2013, with

subsequent publications being made on the following dates:

And affiant further says that he has personal knowledge of the statements above set forth and that they are true.

*Mark Fletchall*

Subscribed and sworn to before me this

17th day of January, 2013

PENNY L. CASE
Notary Public - State of Kansas
My Appt. Expires 5/28/2014

*Penny L. Case*
Notary Public Sedgwick County, Kansas

Printer's Fee : \$132.40

**LEGAL PUBLICATION**

PUBLISHED IN THE WICHITA EAGLE
JANUARY 17, 2013 (3227059)
BEFORE THE STATE CORPORATION
COMMISSION OF THE STATE OF KANSAS
NOTICE OF FILING APPLICATION

RE: In the Matter of Postrock Midcontinent
Production, LLC Application for
Commingle of Production in the
Reinhardt, Richard R 33-1 located in
Neosho County, Kansas.

TO: All Oil & Gas Producers, Unleased Mineral
Interest Owners, Landowners, and all
persons whomsoever concerned.

You, and each of you, are hereby notified
that Postrock Midcontinent Production, LLC
has filed an application to commingle the
Summit, Mulky, Croweburg, Fleming, Welr,
Rowe, Neutral, Riverton and Cattleman
producing formations at the Reinhardt,
Richard R. 33-1, located in the NE NE,
S33-T275-R19E, Approximately 500 FNL & 660
FEL, Neosho County, Kansas.

Any persons who object to or protest
this application shall be required to file their
objections or protest with the Conservation
Division of the State Corporation Commission
of the State of Kansas within fifteen (15)
days from the date of this publication. These
protests shall be filed pursuant to Commission
regulations and must state specific reasons
why granting the application may cause waste,
violate correlative rights or pollute the natural
resources of the State of Kansas.

All persons interested or concerned shall
take notice of the foregoing and shall govern
themselves accordingly. All person and/or
companies wishing to protest this application
are required to file a written protest with the
Conservation Division of the Kansas Oil and
Gas Commission.

Upon the receipt of any protest, the
Commission will convene a hearing and
protestants will be expected to enter an
appearance either through proper legal
counsel or as individuals, appearing on their
own behalf.

Postrock Midcontinent Production, LLC
210 Park Avenue, Suite 2750
Oklahoma City, Oklahoma 73102
(405) 660-7704

**Affidavit of Notice Served**

Re: Application for: APPLICATION FOR COMMINGLING OF PRODUCTION OR FLUIDS ACO-4

Well Name: REINHARDT, RICHARD R 33-1 Legal Location: NENE S33-T27S-R19E

The undersigned hereby certifies that he / she is a duly authorized agent for the applicant, and that on the day 5TH of FEBRUARY, 2013, a true and correct copy of the application referenced above was delivered or mailed to the following parties:

*Note: A copy of this affidavit must be served as a part of the application.*

Name

Address (Attach additional sheets if necessary)

**SEE ATTACHED**

I further attest that notice of the filing of this application was published in the THE CHANUTE TRIBUNE, the official county publication of NEOSHO county. A copy of the affidavit of this publication is attached.

Signed this 5TH day of FEBRUARY, 2013

[Signature]  
Applicant or Duly Authorized Agent

Subscribed and sworn to before me this 5<sup>th</sup> day of FEBRUARY, 2013



Jennifer R Beal  
Notary Public

My Commission Expires: July 20, 2016

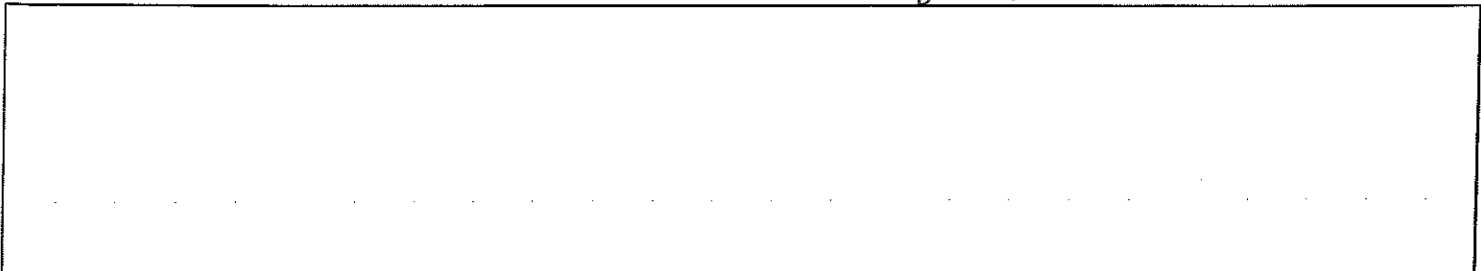

REINHARDT, RICHARD R 33-1

LEGAL LOCATION	SPOT	CURR_OPERA	ADDRESS
S28-T27S-R19E	SW SE SW SE	Bird Energy, Inc.	2020 THOMPSON, PO BOX 1612, DODGE CITY, KS 67801
S34-T27S-R19E	NE SW NW	Graybol-Patton Co.	SWANSON PLAZA - 7136 S YALE, STE 200, TULSA, OK 74136
S34-T27S-R19E	NE SW NW	Graybol-Patton Co.	SWANSON PLAZA - 7136 S YALE, STE 200, TULSA, OK 74136
S33-T27S-R19E	NE	Kepley Well Service, a General Partnership	19245 FORD RD, CHANUTE, KS 66720
S33-T27S-R19E	SE NE SW NE	Kepley Well Service, a General Partnership	19245 FORD RD, CHANUTE, KS 66720
S33-T27S-R19E	NW NE NE SE	MJ Energy, LLC	3570 E 12TH AVE, STE 205, DENVER, CO 80206
S33-T27S-R19E	NE NE NE SE	MJ Energy, LLC	3570 E 12TH AVE, STE 205, DENVER, CO 80206
S33-T27S-R19E	SE SE NE	MJ Energy, LLC	3570 E 12TH AVE, STE 205, DENVER, CO 80206
S33-T27S-R19E	SW SE NE	MJ Energy, LLC	3570 E 12TH AVE, STE 205, DENVER, CO 80206
S33-T27S-R19E	NE SW SE NE	MJ Energy, LLC	3570 E 12TH AVE, STE 205, DENVER, CO 80206
S33-T27S-R19E	SE NW SE NE	MJ Energy, LLC	3570 E 12TH AVE, STE 205, DENVER, CO 80206
S33-T27S-R19E	NE SE SE NE	MJ Energy, LLC	3570 E 12TH AVE, STE 205, DENVER, CO 80206
S33-T27S-R19E	NE SW SE NE	MJ Energy, LLC	3570 E 12TH AVE, STE 205, DENVER, CO 80206
S33-T27S-R19E	SE SW SE NE	MJ Energy, LLC	3570 E 12TH AVE, STE 205, DENVER, CO 80206
S33-T27S-R19E	NW SE SW NE	MJ Energy, LLC	3570 E 12TH AVE, STE 205, DENVER, CO 80206
S33-T27S-R19E	SW NE SW NE	MJ Energy, LLC	3570 E 12TH AVE, STE 205, DENVER, CO 80206
S33-T27S-R19E	SE NW SE NE	MJ Energy, LLC	3570 E 12TH AVE, STE 205, DENVER, CO 80206
S33-T27S-R19E	NE NE SW NE	MJ Energy, LLC	3570 E 12TH AVE, STE 205, DENVER, CO 80206
S33-T27S-R19E	NW NE SW NE	MJ Energy, LLC	3570 E 12TH AVE, STE 205, DENVER, CO 80206
S33-T27S-R19E	NE NW SW NE	MJ Energy, LLC	3570 E 12TH AVE, STE 205, DENVER, CO 80206
S33-T27S-R19E	SE SE SE NE	MJ Energy, LLC	3570 E 12TH AVE, STE 205, DENVER, CO 80206
S34-T27S-R19E	SW SW SW NW	MJ Energy, LLC	3570 E 12TH AVE, STE 205, DENVER, CO 80206
S33-T27S-R19E	SW SE SE NE	MJ Energy, LLC	3570 E 12TH AVE, STE 205, DENVER, CO 80206
S33-T27S-R19E	NE SW SE NE	MJ Energy, LLC	3570 E 12TH AVE, STE 205, DENVER, CO 80206
S33-T27S-R19E	NW SE SE NE	MJ Energy, LLC	3570 E 12TH AVE, STE 205, DENVER, CO 80206
S34-T27S-R19E	NW SE SW NW	MJ Energy, LLC	3570 E 12TH AVE, STE 205, DENVER, CO 80206
S34-T27S-R19E	SW NE SW NW	MJ Energy, LLC	3570 E 12TH AVE, STE 205, DENVER, CO 80206
S34-T27S-R19E	SE NW SW NW	MJ Energy, LLC	3570 E 12TH AVE, STE 205, DENVER, CO 80206
S34-T27S-R19E	NE SW NW	MJ Energy, LLC	3570 E 12TH AVE, STE 205, DENVER, CO 80206
S33-T27S-R19E	SW SE NE	MSG Resources Inc.	975 1400TH ST, IOLA, KS 66749

REINHARDT, RICHARD R 33-1

S33-T27S-R19E	SW SE NE	MSG Resources Inc.	975 1400TH ST, IOLA, KS 66749
S27-T27S-R19E	SW SE SW	Richard Engineering Co.	1228 S STEUBEN, CHANUTE, KS 66720
S28-T27S-R19E	SW NE SW SE	Richard Engineering Co.	1228 S STEUBEN, CHANUTE, KS 66720
S28-T27S-R19E	SW NE SW SE	Richard Engineering Co.	1228 S STEUBEN, CHANUTE, KS 66720
S28-T27S-R19E	NE SE SW SE	Richard Engineering Co.	1228 S STEUBEN, CHANUTE, KS 66720
S28-T27S-R19E	NE SE SW SE	Richard Engineering Co.	1228 S STEUBEN, CHANUTE, KS 66720
S28-T27S-R19E	SE SE SW SE	Richard Engineering Co.	1228 S STEUBEN, CHANUTE, KS 66720
S28-T27S-R19E	SW SE SW SE	Richard Engineering Co.	1228 S STEUBEN, CHANUTE, KS 66720
S28-T27S-R19E	SW SE SW SE	Richard Engineering Co.	1228 S STEUBEN, CHANUTE, KS 66720
S28-T27S-R19E	NE NE SW SE	Richard Engineering Co.	1228 S STEUBEN, CHANUTE, KS 66720
S28-T27S-R19E	NE NE SW SE	Richard Engineering Co.	1228 S STEUBEN, CHANUTE, KS 66720
S28-T27S-R19E	SE NE SW SE	Richard Engineering Co.	1228 S STEUBEN, CHANUTE, KS 66720
S28-T27S-R19E	NW NE SW SE	Richard Engineering Co.	1228 S STEUBEN, CHANUTE, KS 66720
S28-T27S-R19E	SW NW SW SE	Richard Engineering Co.	1228 S STEUBEN, CHANUTE, KS 66720
S27-T27S-R19E	NW SW NW SW	Tontol, LLC	1228 S STEUBEN, CHANUTE, KS 66720
S27-T27S-R19E	SW SE NW SW	Tontol, LLC	1228 S STEUBEN, CHANUTE, KS 66720
S27-T27S-R19E	NW SE SW SW	Tontol, LLC	1228 S STEUBEN, CHANUTE, KS 66720
S27-T27S-R19E	SW SW NW SW	Toshic Dynamics, LLC	1228 S STEUBEN, CHANUTE, KS 66720
S34-T27S-R19E	NW	Tri-L Oil Co.	1228 S STEUBEN, CHANUTE, KS 66720
			8149 N 87TH PL, STE 104, SCOTTSDALE, AZ 85258
			8149 N 87TH PL, STE 104, SCOTTSDALE, AZ 85258
			8149 N 87TH PL, STE 104, SCOTTSDALE, AZ 85258
			8226 E HIGHLAND AVE, SCOTTSDALE, AZ 85251
			2351 MINNESOTA RD, IOLA, KS 66749



REINHARDT, RICHARD R 33-1

**28-27S-19E**

trt in SE4 SW4     Roland L & M'Lee A McClay  
20200 Liberty Rd  
Chanute, KS 66720

**33-27S-19E**

E2 SW4             John W & Dorothy M. LaRue  
11400 190th Rd  
Chanute, KS 66720

**34-27S-19E**

E2 NW4             Nina Johnson Living Trust  
490 2600 St  
Elsmore, KS 66732

**Offset Operators, Unleased Mineral Owners and Landowners acreage**  
(Attach additional sheets if necessary)

Name:

Legal Description of Leasehold:

SEE ATTACHED



I hereby certify that the statements made herein are true and correct to the best of my knowledge and belief.

Applicant or Duty Authorized Agent

Subscribed and sworn before me this 5TH day of FEBRUARY, 2013

Notary Public

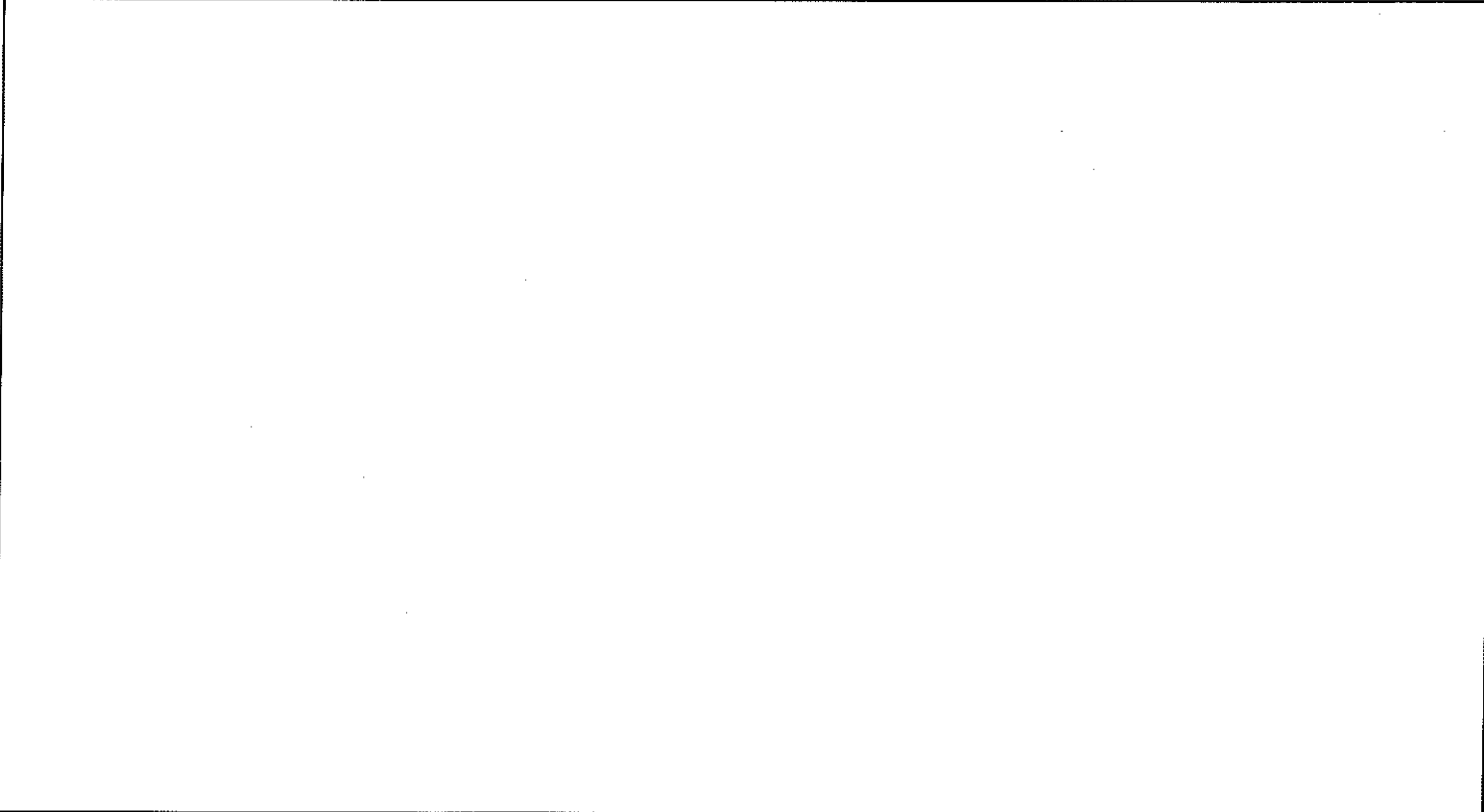
My Commission Expires: July 20, 2016



**REINHARDT, RICHARD R 33-1**

<b>LEGAL LOCATION</b>	<b>SPOT</b>	<b>CURR_OPERA</b>	<b>ADDRESS</b>
S28-T27S-R19E	SW SE SW SE	Bird Energy, Inc.	2020 THOMPSON, PO BOX 1612, DODGE CITY, KS 67801
S34-T27S-R19E	NE SW NW	Graybol-Patton Co.	SWANSON PLAZA - 7136 S YALE, STE 200, TULSA, OK 74136
S34-T27S-R19E	NE SW NW	Graybol-Patton Co.	SWANSON PLAZA - 7136 S YALE, STE 200, TULSA, OK 74136
S33-T27S-R19E	NE	Kepley Well Service, a General Partnership	19245 FORD RD, CHANUTE, KS 66720
S33-T27S-R19E	SE NE SW NE	Kepley Well Service, a General Partnership	19245 FORD RD, CHANUTE, KS 66720
S33-T27S-R19E	NW/NE NE SE	MJ Energy, LLC	19245 FORD RD, CHANUTE, KS 66720
S33-T27S-R19E	NE NE NE SE	MJ Energy, LLC	3570 E 12TH AVE, STE 205, DENVER, CO 80206
S33-T27S-R19E	NE NE NE SE	MJ Energy, LLC	3570 E 12TH AVE, STE 205, DENVER, CO 80206
S33-T27S-R19E	SE SE NE	MJ Energy, LLC	3570 E 12TH AVE, STE 205, DENVER, CO 80206
S33-T27S-R19E	SE SE NE	MJ Energy, LLC	3570 E 12TH AVE, STE 205, DENVER, CO 80206
S33-T27S-R19E	SE SE NE	MJ Energy, LLC	3570 E 12TH AVE, STE 205, DENVER, CO 80206
S33-T27S-R19E	SE SE NE	MJ Energy, LLC	3570 E 12TH AVE, STE 205, DENVER, CO 80206
S33-T27S-R19E	SE SE NE	MJ Energy, LLC	3570 E 12TH AVE, STE 205, DENVER, CO 80206
S33-T27S-R19E	NE NE SW NE	MJ Energy, LLC	3570 E 12TH AVE, STE 205, DENVER, CO 80206
S33-T27S-R19E	NW/NE SW NE	MJ Energy, LLC	3570 E 12TH AVE, STE 205, DENVER, CO 80206
S33-T27S-R19E	SW NE SW NE	MJ Energy, LLC	3570 E 12TH AVE, STE 205, DENVER, CO 80206
S33-T27S-R19E	SE NW SE NE	MJ Energy, LLC	3570 E 12TH AVE, STE 205, DENVER, CO 80206
S33-T27S-R19E	SE NW SE NE	MJ Energy, LLC	3570 E 12TH AVE, STE 205, DENVER, CO 80206
S33-T27S-R19E	NE NE SW NE	MJ Energy, LLC	3570 E 12TH AVE, STE 205, DENVER, CO 80206
S33-T27S-R19E	NW/NE SW NE	MJ Energy, LLC	3570 E 12TH AVE, STE 205, DENVER, CO 80206
S33-T27S-R19E	SW NE SW NE	MJ Energy, LLC	3570 E 12TH AVE, STE 205, DENVER, CO 80206
S33-T27S-R19E	SE SE SE NE	MJ Energy, LLC	3570 E 12TH AVE, STE 205, DENVER, CO 80206
S33-T27S-R19E	SE SE SE NE	MJ Energy, LLC	3570 E 12TH AVE, STE 205, DENVER, CO 80206
S34-T27S-R19E	SW SW SW NW	MJ Energy, LLC	3570 E 12TH AVE, STE 205, DENVER, CO 80206
S33-T27S-R19E	SW SE SE NE	MJ Energy, LLC	3570 E 12TH AVE, STE 205, DENVER, CO 80206
S33-T27S-R19E	NE SW SE NE	MJ Energy, LLC	3570 E 12TH AVE, STE 205, DENVER, CO 80206
S33-T27S-R19E	NW SE SE NE	MJ Energy, LLC	3570 E 12TH AVE, STE 205, DENVER, CO 80206
S34-T27S-R19E	NW SE SW NW	MJ Energy, LLC	3570 E 12TH AVE, STE 205, DENVER, CO 80206
S34-T27S-R19E	SW NE SW NW	MJ Energy, LLC	3570 E 12TH AVE, STE 205, DENVER, CO 80206
S34-T27S-R19E	SE NW SW NW	MJ Energy, LLC	3570 E 12TH AVE, STE 205, DENVER, CO 80206
S34-T27S-R19E	SE NW SW NW	MJ Energy, LLC	3570 E 12TH AVE, STE 205, DENVER, CO 80206
S34-T27S-R19E	NE SW NW	MJ Energy, LLC	3570 E 12TH AVE, STE 205, DENVER, CO 80206
S33-T27S-R19E	SW SE NE	MSG Resources Inc.	975 1400TH ST, IOOLA, KS 66749

REINHARDT, RICHARD R 33-1

S33-T27S-R19E	SW SE NE	MSG Resources Inc.
S27-T27S-R19E	SW SE SW	Richard Engineering Co.
S28-T27S-R19E	SW NE SW SE	Richard Engineering Co.
S28-T27S-R19E	SW NE SW SE	Richard Engineering Co.
S28-T27S-R19E	NE SE SW SE	Richard Engineering Co.
S28-T27S-R19E	NE SE SW SE	Richard Engineering Co.
S28-T27S-R19E	SE SE SW SE	Richard Engineering Co.
S28-T27S-R19E	SW SE SW SE	Richard Engineering Co.
S28-T27S-R19E	SW SE SW SE	Richard Engineering Co.
S28-T27S-R19E	NE NE SW SE	Richard Engineering Co.
S28-T27S-R19E	SW SE SW SE	Richard Engineering Co.
S28-T27S-R19E	NW SE SW SE	Richard Engineering Co.
S28-T27S-R19E	SE NE SW SE	Richard Engineering Co.
S28-T27S-R19E	NE NE SW SE	Richard Engineering Co.
S28-T27S-R19E	SE NE SW SE	Richard Engineering Co.
S28-T27S-R19E	SE NE SW SE	Richard Engineering Co.
S28-T27S-R19E	NW NE SW SE	Richard Engineering Co.
S28-T27S-R19E	SW NW SW SE	Richard Engineering Co.
S27-T27S-R19E	NW SW NW SW	Tontol, LLC
S27-T27S-R19E	SW SE NW SW	Tontol, LLC
S27-T27S-R19E	NW SE SW SW	Tontol, LLC
S27-T27S-R19E	SW SW NW SW	Toshic Dynamics, LLC
S34-T27S-R19E	NW	Tri-L Oil Co.

975 1400TH ST, IOLA, KS 66749
1228 S STEUBEN, CHANUTE, KS 66720
1228 S STEUBEN, CHANUTE, KS 66720
1228 S STEUBEN, CHANUTE, KS 66720
1228 S STEUBEN, CHANUTE, KS 66720
1228 S STEUBEN, CHANUTE, KS 66720
1228 S STEUBEN, CHANUTE, KS 66720
1228 S STEUBEN, CHANUTE, KS 66720
1228 S STEUBEN, CHANUTE, KS 66720
1228 S STEUBEN, CHANUTE, KS 66720
1228 S STEUBEN, CHANUTE, KS 66720
1228 S STEUBEN, CHANUTE, KS 66720
1228 S STEUBEN, CHANUTE, KS 66720
1228 S STEUBEN, CHANUTE, KS 66720
1228 S STEUBEN, CHANUTE, KS 66720
1228 S STEUBEN, CHANUTE, KS 66720
1228 S STEUBEN, CHANUTE, KS 66720
1228 S STEUBEN, CHANUTE, KS 66720
1228 S STEUBEN, CHANUTE, KS 66720
1228 S STEUBEN, CHANUTE, KS 66720
1228 S STEUBEN, CHANUTE, KS 66720
1228 S STEUBEN, CHANUTE, KS 66720
1228 S STEUBEN, CHANUTE, KS 66720
8149 N 87TH PL, STE 104, SCOTTSDALE, AZ 85258
8149 N 87TH PL, STE 104, SCOTTSDALE, AZ 85258
8149 N 87TH PL, STE 104, SCOTTSDALE, AZ 85258
8226 E HIGHLAND AVE, SCOTTSDALE, AZ 85251
2351 MINNESOTA RD, IOLA, KS 66749

28-27S-19E

trt in SE4 SW4  
Roland L & M'Lee A McClay  
20200 Liberty Rd  
Chanute, KS 66720

33-27S-19E

E2 SW4  
John W & Dorothy M. LaRue  
11400 190th Rd  
Chanute, KS 66720

34-27S-19E

E2 NW4  
Nina Johnson Living Trust  
490 2600 St  
Elsmore, KS 66732

Conservation Division  
Finney State Office Building  
130 S. Market, Rm. 2078  
Wichita, KS 67202-3802



Phone: 316-337-6200  
Fax: 316-337-6211  
<http://kcc.ks.gov/>

Mark Sievers, Chairman  
Thomas E. Wright, Commissioner  
Shari Feist Albrecht, Commissioner

Sam Brownback, Governor

February 20, 2013

Clark Edwards  
PostRock Midcontinent Production LLC  
Oklahoma Tower  
210 Park Ave, Ste 2750  
Oklahoma City, OK 73102

RE: Approved Commingling CO021302  
Reinhardt, Richard R. 33-1, Sec. 33-T27S-R19E, Neosho County  
API No. 15-133-27135-00-00

Dear Mr. Edwards:

Your Application for Commingling (ACO-4) for the above described well, received by the KCC on February 5, 2013, has been reviewed and approved by the Kansas Corporation Commission (KCC) per K.A.R. 82-3-123. Notice was examined and found to be proper per K.A.R. 82-3-135a. No protest had been filed within the 15-day protest period.

Based upon the depth of the Riverton formation perforations, total oil production shall not exceed 100 BOPD and total gas production shall not exceed 50% of the absolute open flow (AOF).

**File form ACO-1 upon re-completion of the well to commingle.**

Commingling ID number CO021302 has been assigned to this approved application. Use this number for well completion reports (ACO-1) and other correspondence that may concern this approved commingling.

Sincerely,

Rick Hestermann  
Production Department