

CIVIL ENGINEERS • SURVEYORS  
901 N. 8th Street, Suite 100 Kansas City, KS 66101 \* p. (913) 371-5300 \* f. (913) 371-2677  
BHC RHODES is a trademark of Brungardt Honomichi & Company, P.A.

FRIEND RD. (CO. RD. JJ) Enter

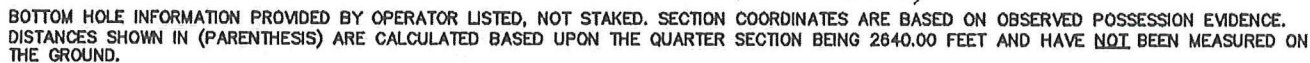

ELEVATION:  
2922

GOOD DRILL SITE? \_\_\_\_\_ STAKES SET: \_\_\_\_\_  
 BEST ACCESSIBILITY TO LOCATION: FROM SOUTH AND EAST BY PAVED ROADS  
 DISTANCE & DIRECTION FROM HWY JCT OR TOWN: FROM THE INTERSECTION OF US HWY 83 AND HWY 50/400 NORTH  
OF GARDEN CITY, NORTH ON US HWY 83 FOR ±18.2 MILES. TURN LEFT (WEST) ON FINNEY-SCOTT RD. FOR ±4.5 MILES.  
TURN LEFT (SOUTH) ON BIG LOWE RD. FOR ±1 MILE. TURN RIGHT (WEST) ON FRIEND RD. FOR 0.1 MILE TO SITE ON THE  
LEFT (SOUTH).

**CERTIFICATE:**

KANSAS LIC. NO. 778



BHC Rhodes Job  
No.: 016330.00.75  
Field: MDK Office: PJS

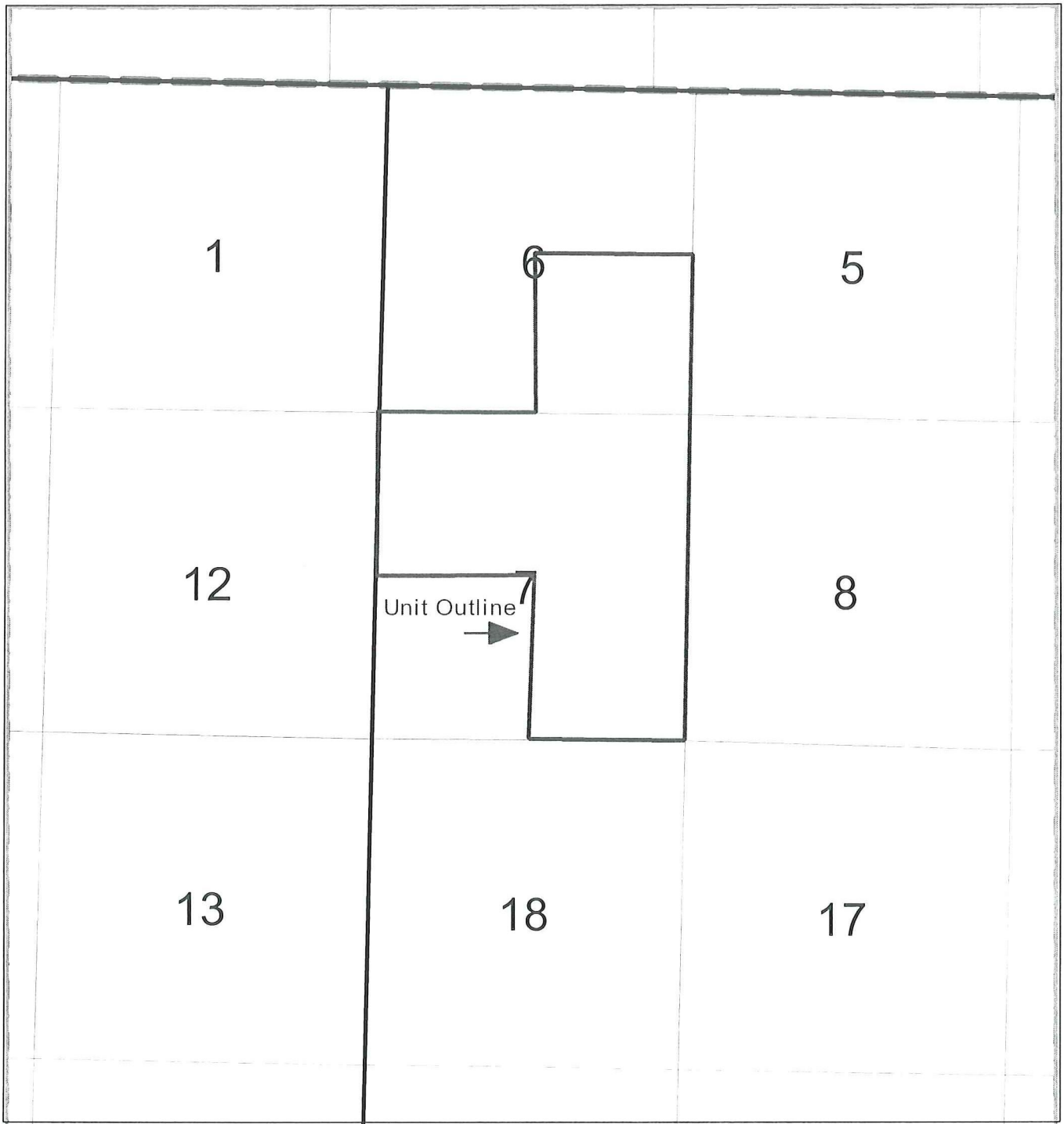

|   |       |
|---|-------|
|  |       |
| Buerkle 2133 1-7H<br>Finney County, Kansas<br>Unit Outline                            |       |
| Date:   | Geol: |

Buerkle 2133 1-7H  
Lease Information

**Unit Description:** SE/4 of Section 6-21S-33W and the  
E/2 & NW/4 of Section 7-21S-33W.

**Surface Owner:**

Robert L. and Donita P. Buerkle, h&w, JTROS  
20035 N Big Lowe Road  
Holcomb, KS 67851