

**Proposed Plan of Construction**  
 Manley A-1  
 Sec 33 T21S-R35W  
 Kearny County, KS

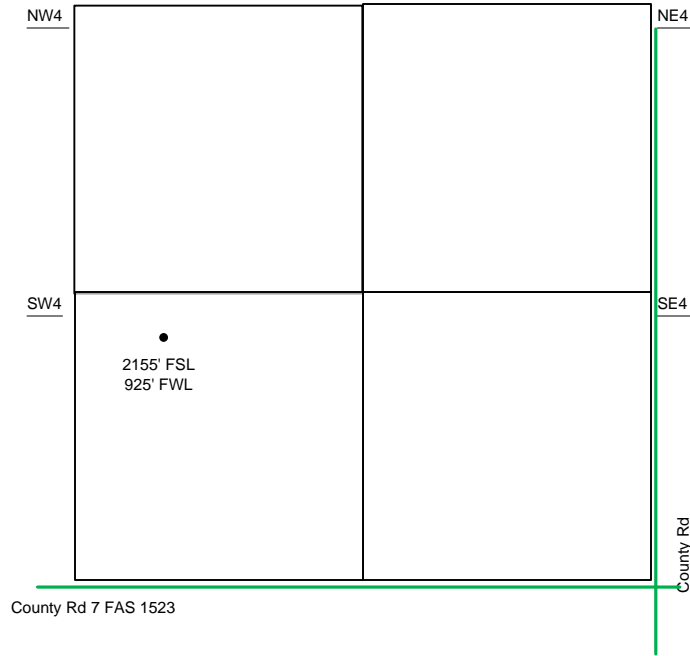

Sec 33 – T21S – R35W

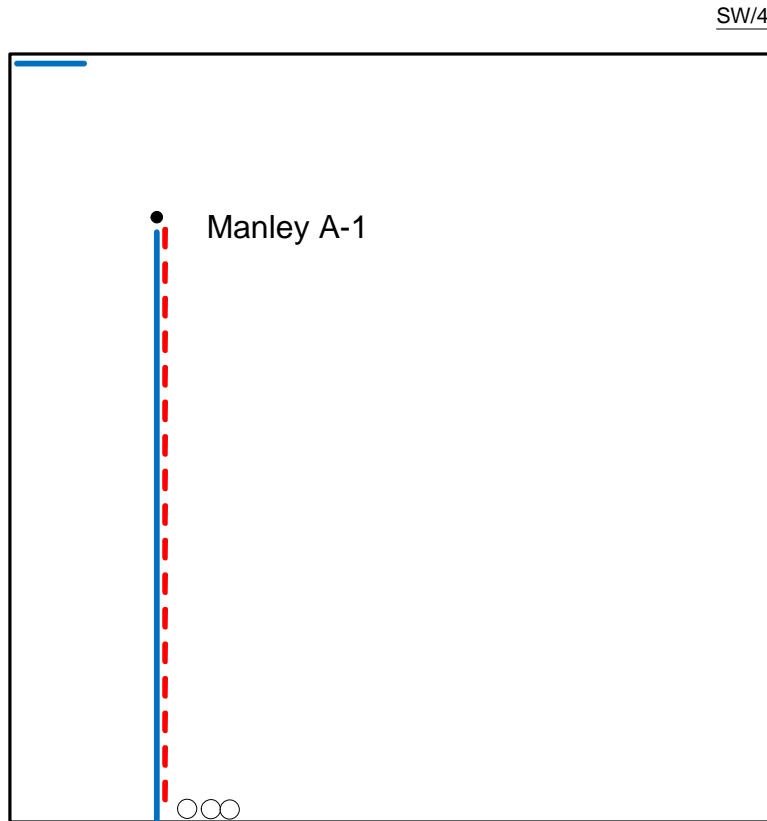

- Well Location
- Proposed Lease Roads
- - - Proposed Pipeline
- Proposed Tank Battery
- Proposed Power Lines
- - - Existing Pipeline

The **Proposed** Tank Battery for the Manley A-1 is located in the S/C of the SW quarter.

Proposed Details of  
 SW/4 Sec 33 -T21S -R35W

Note-Drawing **Not** to Scale

