



APPLICATION FOR COMMINGLING OF PRODUCTION (K.A.R. 82-3-123) OR FLUIDS (K.A.R. 82-3-123a) *Commingling ID # _____*

OPERATOR: License # _____ API No. 15 - _____
Name: _____ Spot Description: _____
Address 1: _____ - - - - - Sec. _____ Twp. _____ S. R. _____ East West
Address 2: _____ Feet from North / South Line of Section
City: _____ State: _____ Zip: _____ + _____ Feet from East / West Line of Section
Contact Person: _____ County: _____
Phone: (_____) _____ Lease Name: _____ Well #: _____

1. Name and upper and lower limit of each production interval to be commingled:
Formation: _____ (Perfs): _____
Formation: _____ (Perfs): _____
Formation: _____ (Perfs): _____
Formation: _____ (Perfs): _____
Formation: _____ (Perfs): _____

2. Estimated amount of fluid production to be commingled from each interval:
Formation: _____ BOPD: _____ MCFPD: _____ BWPD: _____
Formation: _____ BOPD: _____ MCFPD: _____ BWPD: _____
Formation: _____ BOPD: _____ MCFPD: _____ BWPD: _____
Formation: _____ BOPD: _____ MCFPD: _____ BWPD: _____
Formation: _____ BOPD: _____ MCFPD: _____ BWPD: _____

3. Plat map showing the location of the subject well, all other wells on the subject lease, and all wells on offsetting leases within a 1/2 mile radius of the subject well, and for each well the names and addresses of the lessee of record or operator.

4. Signed certificate showing service of the application and affidavit of publication as required in K.A.R. 82-3-135a.

For Commingling of PRODUCTION ONLY, include the following:

- 5. Wireline log of subject well. Previously Filed with ACO-1: Yes No
- 6. Complete Form ACO-1 (*Well Completion form*) for the subject well.

For Commingling of FLUIDS ONLY, include the following:

- 7. Well construction diagram of subject well.
- 8. Any available water chemistry data demonstrating the compatibility of the fluids to be commingled.

AFFIDAVIT: I am the affiant and hereby certify that to the best of my current information, knowledge and personal belief, this request for commingling is true and proper and I have no information or knowledge, which is inconsistent with the information supplied in this application.

Submitted Electronically

KCC Office Use Only
 Denied Approved
15-Day Periods Ends: _____
Approved By: _____ Date: _____

Protests may be filed by any party having a valid interest in the application. Protests must be in writing and comply with K.A.R. 82-3-135b and must be filed within 15 days of publication of the notice of application.

R 19 W

T
12
S

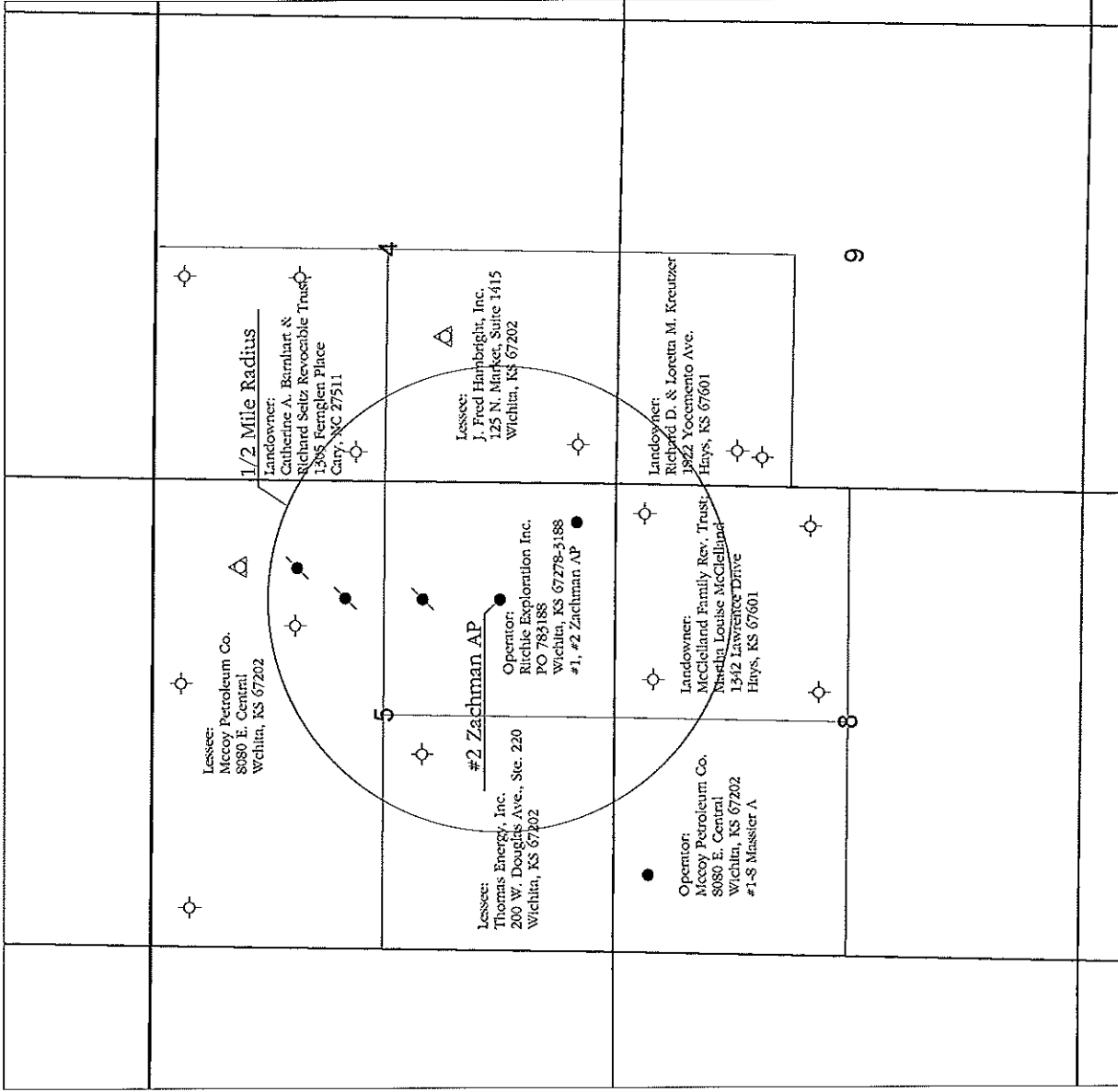



RITCHIE
 EXPLORATION INC.
 WICHITA, KANSAS

Application for
 Commingling of
 Production or Fluids

Applicant Well: #2 Zachman AP
 All Wells within 1/2 Mile Radius
 Name and Address of Lessee of Record or Operator
 On Offsetting Leases

Ellis County, Kansas	
Prepared By: Justin Clegg	Scale: 1 : 24,000
Date: February 12, 2013	

- Legend**
- Oil Well
 - /— Abandoned Oil Well
 - /— Dry and Abandoned Well
 - △ Service Well

APPLICATION FOR COMMINGLING OF PRODUCTION OR FLUIDS

**Operator, Lessee or Unleased Mineral Owner
within a ½ mile radius of Ritchie Exploration, Inc.'s**

**#2 Zachman AP
1320' FSL & 1320' FEL
Section 5-12S-19W
Ellis Co., KS**

Township 12 South, Range 19 West

Sec. 4:	NW/4	Catherine A. Barnhart & Richard Seitz Revocable Trust 1305 Fernglen Place Cary, NC 27511	Landowners
	SW/4	J. Fred Hambright, Inc. 125 N. Market, Suite 1415 Wichita, KS 67202	Lessee
Sec. 5:	N/2, less a 250 sq. ft. tract in C SW/4NE/4NE/4	McCoy Petroleum Corporation 8080 E. Central Wichita, KS 67206	Lessee
	SW/4	Thomas Energy, Inc. 200 W. Douglas Ave., Ste. 220 Wichita, KS 67202	Lessee
	SE/4	Ritchie Exploration, Inc. P.O. Box 783188 Wichita, KS 67278-3188	Operator: #1 Zachman AP, #2 Zachman AP
Sec. 8:	NE/4	McClelland Family Rev. Trust; Martha Louise McClelland 1342 Lawrence Drive Hays, KS 67601	Landowners
	NW/4, less a 4 acre tract	McCoy Petroleum Corporation	Operator: Massier 'A' #1-8
Sec. 9:	N/2NW/4; N/2S/2NW/4	Richard D. & Loretta M. Kreutzer 1822 Yocemento Ave. Hays, KS 67601	Landowners

AFFIDAVIT

STATE OF KANSAS)
 - SS.
County of Sedgwick)

John Niernberger, of lawful age, being first duly sworn, deposeth and saith: That he is Production Manager of Ritchie Exploration, County of Sedgwick, State of Kansas, and that notice was given to all lessee of record or operator within ½ mile radius of the Zachman AP #2 well located in the County of Ellis (see attached plat map). This notice included a letter regarding application for commingling and the commingling form. All notices were mailed on February 12, 2013.

made as aforesaid on the **12th** of

February A.D. 2012

And affiant further says that he has personal knowledge of the statements above set forth and that they are true.

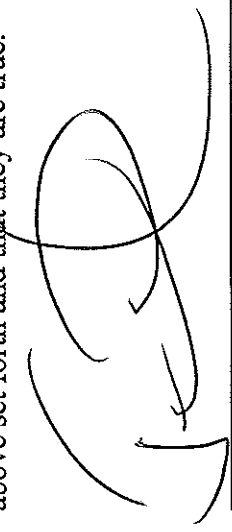

Subscribed and sworn to before me this

12th day of February 2012

KAREN HOPPER
NOTARY PUBLIC-STATE OF KANSAS
MY APPT. EXPIRES 3.8.15

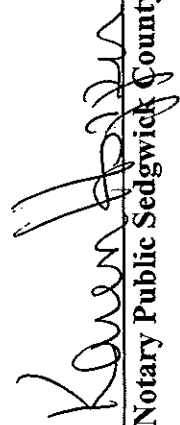

Notary Public Sedgwick County, Kansas

**KANSAS CORPORATION COMMISSION
OIL & GAS CONSERVATION DIVISION
WELL COMPLETION FORM**

Form ACO-1
June 2009
Form Must Be Typed
Form must be Signed
All blanks must be Filled

WELL HISTORY - DESCRIPTION OF WELL & LEASE

OPERATOR: License # 4767
 Name: Ritchie Exploration, Inc.
 Address 1: P.O. Box 783188
 Address 2: _____
 City: Wichita State: KS Zip: 67278 + 3188
 Contact Person: Peter Fiorini
 Phone: (316) 691-9500
 CONTRACTOR: License # _____
 Name: _____
 Wellsite Geologist: _____
 Purchaser: _____

API No. 15 - 051-23083
 Spot Description: _____
 _____ C SE4 Sec. 5 Twp. 12 S. R. 19 East West
1.320 Feet from North / South Line of Section
1.320 Feet from East / West Line of Section
 Footages Calculated from Nearest Outside Section Corner:
 NE NW SE SW
 County: Ellis
 Lease Name: Zachman AP Well #: 2
 Field Name: Star Southeast

Designate Type of Completion:
 New Well Re-Entry Workover
 Oil WSW SWD SIOW
 Gas D&A ENHR SIGW
 OG GSW Temp. Abd.
 CM (Coal Bed Methane)
 Cathodic Other (Core, Expl., etc.): _____

Producing Formation: LKC, Arbrucke
 Elevation: Ground: 2137' Kelly Bushing: 2142'
 Total Depth: 3750' Plug Back Total Depth: 3720'
 Amount of Surface Pipe Set and Cemented at: 180' Feet
 Multiple Stage Cementing Collar Used? Yes No
 If yes, show depth set: _____ Feet
 If Alternate II completion, cement circulated from: _____
 feet depth to: _____ w/ _____ sx cmt.

If Workover/Re-entry: Old Well Info as follows: _____
 Operator: Ritchie Exploration
 Well Name: Zachman AP #2

Original Comp. Date: 8-16-82 Original Total Depth: 3750'
 Deepening Re-perf. Conv. to ENHR Conv. to SWD
 Conv. to GSW
 Plug Back: _____ Plug Back Total Depth
 Commingled Permit #: _____
 Dual Completion Permit #: _____
 SWD Permit #: _____
 ENHR Permit #: _____
 GSW Permit #: _____

Drilling Fluid Management Plan
 (Data must be collected from the Reserve Pit)
 Chloride content: _____ ppm Fluid volume: _____ bbls
 Dewatering method used: _____
 Location of fluid disposal if hauled offsite: _____
 Operator Name: _____ License #: _____
 Lease Name: _____
 Quarter _____ Sec. _____ Twp. _____ S. R. _____ East West
 County: _____ Permit #: _____

8/19/2010 8/21/2010 8/31/2010
 Spud Date or Date Reached TD Completion Date or
 Recompletion Date Recompletion Date

INSTRUCTIONS: An original and two copies of this form shall be filed with the Kansas Corporation Commission, 130 S. Market - Room 2078, Wichita, Kansas 67202, within 120 days of the spud date, recompletion, workover or conversion of a well. Rule 82-3-130, 82-3-106 and 82-3-107 apply. Information of side two of this form will be held confidential for a period of 12 months if requested in writing and submitted with the form (see rule 82-3-107 for confidentiality in excess of 12 months). One copy of all wireline logs and geologist well report shall be attached with this form. ALL CEMENTING TICKETS MUST BE ATTACHED. Submit CP-4 form with all plugged wells. Submit CP-111 form with all temporarily abandoned wells.

AFFIDAVIT

I am the affiant and I hereby certify that all requirements of the statutes, rules and regulations promulgated to regulate the oil and gas industry have been fully complied with and the statements herein are complete and correct to the best of my knowledge.

Signature: _____
 Title: Production/Development Geologist Date: 12/21/2010

KCC Office Use ONLY

Letter of Confidentiality Received
 Date: _____
 Confidential Release Date: _____
 Wireline Log Received
 Geologist Report Received
 UIC Distribution
 ALT I II III Approved by: _____ Date: _____

Operator Name: Ritchie Exploration, Inc. Lease Name: Zachman AP Well #: 2
 Sec. 5 Twp. 12 S. R. 19 East West County: Ellis

INSTRUCTIONS: Show important tops and base of formations penetrated. Detail all cores. Report all final copies of drill stems tests giving interval tested, time tool open and closed, flowing and shut-in pressures, whether shut-in pressure reached static level, hydrostatic pressures, bottom hole temperature, fluid recovery, and flow rates if gas to surface test, along with final chart(s). Attach extra sheet if more space is needed. Attach complete copy of all Electric Wire-line Logs surveyed. Attach final geological well site report.

Drill Stem Tests Taken Yes No Log Formation (Top), Depth and Datum Sample
 (Attach Additional Sheets)

Samples Sent to Geological Survey Yes No Top Datum
 Cores Taken Yes No
 Electric Log Run Yes No
 Electric Log Submitted Electronically Yes No
 (If no, Submit Copy)

SEE ATTACHED

List All E. Logs Run:
Sidewall Neutron Log

Purpose of String	Size Hole Drilled	Size Casing Set (In O.D.)	Weight Lbs./ Ft.	CASING RECORD		Setting Depth	Type of Cement	# Sacks Used	Type and Percent Additives
				<input type="checkbox"/> New	<input checked="" type="checkbox"/> Used				
Surface	12-1/4	8-5/8	20	180'				200	
Production	7-7/8	5.5	15.5	3745'				200	

ADDITIONAL CEMENTING / SQUEEZE RECORD

Purpose:	Depth Top Bottom	Type of Cement	# Sacks Used	Type and Percent Additives
<input type="checkbox"/> Perforate <input type="checkbox"/> Protect Casing <input type="checkbox"/> Plug Back TD <input type="checkbox"/> Plug Off Zone				

Shots Per Foot	PERFORATION RECORD - Bridge Plugs Set/Type Specify Footage of Each Interval Perforated	Acid, Fracture, Shot, Cement Squeeze Record (Amount and Kind of Material Used)	Depth
	3480-86', 3490-96', 3554-58' (LKC) (10/83)	750 gal 15% NE + 63 soluble-perf-ball-sealers (8/21/10)	
	3574-78', 3590-3600' (LKC) (8/82)	750 gal 15% NE + 62 soluble-perf-ball-sealers (8/21/10)	
4	3696'-3701' (Arbuckle) (8/19/10)	500 gals 15% INS (8/20/10)	

TUBING RECORD: Size: 2 3/8" Set At: 3713' Packer At: Liner Run: Yes No

Date of First, Resumed Production, SWD or ENHR.	Producing Method:			Water	Gas-Oil Ratio	Gravity
8/31/2010	<input type="checkbox"/> Flowing	<input checked="" type="checkbox"/> Pumping	<input type="checkbox"/> Gas Lift	<input type="checkbox"/> Other (Explain)	Bbls.	31.3
Estimated Production Per 24 Hours	Oil Bbls.	Gas Mcf	Water Bbls.		34	

DISPOSITION OF GAS:	METHOD OF COMPLETION:	PRODUCTION INTERVAL:
<input type="checkbox"/> Vented <input type="checkbox"/> Sold <input type="checkbox"/> Used on Lease (if vented, Submit ACC-18.)	<input type="checkbox"/> Open Hole <input checked="" type="checkbox"/> Perf. <input type="checkbox"/> Dually Comp. (Submit ACC-6) <input checked="" type="checkbox"/> Commingled (Submit ACC-4)	

AFFIDAVIT OF PUBLICATION

State of Kansas, Ellis County, ss:

Mary Karst

being first duly sworn, deposes and says:

That he/she is Advertising Manager

of THE HAYS DAILY NEWS, a daily newspaper printed in the State of Kansas, and published in and of general circulation in Ellis County, Kansas, with a general paid circulation on a yearly basis in Ellis County, Kansas, and that said newspaper is not a trade, religious or fraternal publication.

Said newspaper is published daily, except Saturday, is published at least weekly 50 times a year; has been so published continuously and uninterrupted in said county and state for a period of more than five years prior to the first publication of said notice; and has been admitted at the post office of Hays in said county as second class matter.

That the attached notice is a true copy thereof and was published in the regular and entire issue of said newspaper for 1 consecutive day, the first publication thereof being made as aforesaid on the 15th day of February, 2013, with subsequent publications being made on the following dates:

____, 20____, _____, 20____
____, 20____, _____, 20____
____, 20____, _____, 20____

Mary Karst

Subscribed and sworn to before me this 15th day of February, 2013.

[Signature]
Notary Public

My Appointment expires 5-28-13
Printer's Fee..... \$45.90
Additional copies..... \$ _____
Total Fee..... \$45.90

(Published in The Hays Daily News Feb. 15, 2013)

You, and each of you, are hereby notified that Ritchie Exploration, Inc. has filed an application to commence the commingling of production from the Lansing-Kansas City and Arbuckle sources of supply for the #2 Zachman AP well located approx. C SE/4 of Section 5-12S-19W, Ellis County, Kansas.

Any persons who object to or protest this application shall be required to file their objections or protests with the Conservation Division of the State Corporation Commission of the State of Kansas within fifteen (15) days from the date of the publication. These protests shall be filed pursuant to Commission regulations and must state specific reasons why the grant of the application may cause waste, violate correlative rights or pollute the natural resources of the state of Kansas. If no protests are received, this application may be granted through a summary proceeding. If valid protests are received, this matter will be set for hearing.

All persons interested or concerned shall take notice of the foregoing and shall govern themselves accordingly.

RITCHIE EXPLORATION, INC.
P.O. Box 783188
Wichita, KS 67278-3188
(316) 691-9500

NOTARY PUBLIC - State of Kansas
JANICE C. TINKEL
My Appt. Exp. 5-28-13

AFFIDAVIT

STATE OF KANSAS \ - SS.
County of Sedgwick /

Mark Fletchall, of lawful age, being first duly sworn, deposed and saith: That he is Record Clerk of The Wichita Eagle, a daily newspaper published in the City of Wichita, County of Sedgwick, State of Kansas, and having a general paid circulation on a daily basis in said County, which said newspaper has been continuously and uninterruptedly published in said County for more than one year prior to the first publication of the notice hereinafter mentioned, and which said newspaper has been entered as second class mail matter at the United States Post Office in Wichita, Kansas, and which said newspaper is not a trade, religious or fraternal publication and that a notice of a true copy is hereto attached was published in the regular and entire Morning issue of said The Wichita Eagle for 1 issues - weeks, that the first publication of said notice was

made as aforesaid on the 14th of

February A.D. 2013, with

subsequent publications being made on the following dates:

And affiant further says that he has personal knowledge of the statements above set forth and that they are true.

Mark Fletchall

Subscribed and sworn to before me this

8th day of March

Deborah C. Sanders
Notary Public Sedgwick County, Kansas

Printers Fee: \$139.20

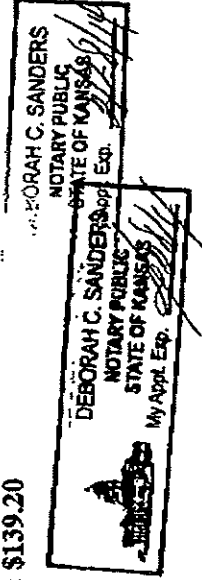

230 Legal Notices

LEGAL NOTICE
You, and each of you, are hereby notified that Ritchie Exploration, Inc. has filed an application to commence the construction of a well from the Lansing-Kansas City and Arbuckle sources of supply for the #2 Zachman AP well in Sedgwick County, Kansas, in the E1/4 of Sec. 16, T25S, R6W, E15 County, Kansas. Any persons who object to or protest this application shall be required to file their objections or protests with the Chairman, Division of the State Corporation Commission of the State of Kansas within fifteen (15) days from the date of the publication of this protest to the Commission. Regulations and must state specific reasons why the grant of the application may cause waste, violate correlative rights or pollute the surface waters of the State of Kansas. If no protests are received, this application may be granted through a summary proceeding. If valid protests are filed, this matter will be set for hearing. All persons interested or concerned shall take notice of the foregoing and shall govern themselves accordingly.

Ritchie Exploration, Inc.
P.O. Box 7831M
Wichita, KS 67278-3188
(316) 691-9200

Mark Sievers, Chairman
Thomas E. Wright, Commissioner
Shari Feist Albrecht, Commissioner

Sam Brownback, Governor

March 11, 2013

John Niernberger
Ritchie Exploration, Inc.
P.O. Box 783188
Wichita, KS 67278-3188

RE: Approved Commingling CO031302
Zachman AP #2 Sec.5-T12S-R19W, Ellis County
API No. 15-051-23083-00-01

Dear Mr. Niernberger:

Your Application for Commingling (ACO-4) for the above described well has been reviewed and approved by the Kansas Corporation Commission (KCC) per K.A.R. 82-3-123. Notice was examined and found to be proper per K.A.R. 82-3-135a. No protest had been filed within the 15-day protest period. This application, which was received by the KCC on March 11, 2013, concerns approval to simultaneously produce from the following sources of supply through the same tubing string in the same wellbore:

Source of Supply	Estimated Current Production			Perf Depth
	BOPD	MCFPD	BWPD	
LKC	2.26	0.0	19.0	3480-3600 OA
Arbuckle	0.25	0.0	5.0	3696-3701
Total Estimated Current Production	2.51	0.0	24.0	

Based upon the depth of the Arbuckle formation perforations, total oil production shall not exceed 200 BOPD and total gas production shall not exceed 50% of the absolute open flow (AOF).

Commingling ID number CO031302 has been assigned to this approved application. Use this number for well completion reports (ACO-1) and other correspondence that may concern this approved commingling.

Sincerely,

Rick Hestermann
Production Department