



**APPLICATION FOR COMMINGLING OF PRODUCTION (K.A.R. 82-3-123) OR FLUIDS (K.A.R. 82-3-123a)** *Commingling ID # \_\_\_\_\_*

OPERATOR: License # \_\_\_\_\_ API No. 15 - \_\_\_\_\_  
Name: \_\_\_\_\_ Spot Description: \_\_\_\_\_  
Address 1: \_\_\_\_\_ - - - - - Sec. \_\_\_\_\_ Twp. \_\_\_\_\_ S. R. \_\_\_\_\_  East  West  
Address 2: \_\_\_\_\_ Feet from  North /  South Line of Section  
City: \_\_\_\_\_ State: \_\_\_\_\_ Zip: \_\_\_\_\_ + \_\_\_\_\_ Feet from  East /  West Line of Section  
Contact Person: \_\_\_\_\_ County: \_\_\_\_\_  
Phone: ( \_\_\_\_\_ ) \_\_\_\_\_ Lease Name: \_\_\_\_\_ Well #: \_\_\_\_\_

1. Name and upper and lower limit of each production interval to be commingled:  
Formation: \_\_\_\_\_ (Perfs): \_\_\_\_\_  
Formation: \_\_\_\_\_ (Perfs): \_\_\_\_\_  
Formation: \_\_\_\_\_ (Perfs): \_\_\_\_\_  
Formation: \_\_\_\_\_ (Perfs): \_\_\_\_\_  
Formation: \_\_\_\_\_ (Perfs): \_\_\_\_\_

2. Estimated amount of fluid production to be commingled from each interval:  
Formation: \_\_\_\_\_ BOPD: \_\_\_\_\_ MCFPD: \_\_\_\_\_ BWPD: \_\_\_\_\_  
Formation: \_\_\_\_\_ BOPD: \_\_\_\_\_ MCFPD: \_\_\_\_\_ BWPD: \_\_\_\_\_  
Formation: \_\_\_\_\_ BOPD: \_\_\_\_\_ MCFPD: \_\_\_\_\_ BWPD: \_\_\_\_\_  
Formation: \_\_\_\_\_ BOPD: \_\_\_\_\_ MCFPD: \_\_\_\_\_ BWPD: \_\_\_\_\_  
Formation: \_\_\_\_\_ BOPD: \_\_\_\_\_ MCFPD: \_\_\_\_\_ BWPD: \_\_\_\_\_

3. Plat map showing the location of the subject well, all other wells on the subject lease, and all wells on offsetting leases within a 1/2 mile radius of the subject well, and for each well the names and addresses of the lessee of record or operator.

4. Signed certificate showing service of the application and affidavit of publication as required in K.A.R. 82-3-135a.

**For Commingling of PRODUCTION ONLY, include the following:**

- 5. Wireline log of subject well. Previously Filed with ACO-1:  Yes  No
- 6. Complete Form ACO-1 (*Well Completion form*) for the subject well.

**For Commingling of FLUIDS ONLY, include the following:**

- 7. Well construction diagram of subject well.
- 8. Any available water chemistry data demonstrating the compatibility of the fluids to be commingled.

**AFFIDAVIT:** I am the affiant and hereby certify that to the best of my current information, knowledge and personal belief, this request for commingling is true and proper and I have no information or knowledge, which is inconsistent with the information supplied in this application.

**Submitted Electronically**

**KCC Office Use Only**  
 Denied  Approved  
15-Day Periods Ends: \_\_\_\_\_  
Approved By: \_\_\_\_\_ Date: \_\_\_\_\_

*Protests may be filed by any party having a valid interest in the application. Protests must be in writing and comply with K.A.R. 82-3-135b and must be filed within 15 days of publication of the notice of application.*

34

35

36

3

2

1

10

11

12

15

14

13

9S 19W

**BARRY UNIT**  
Rooks County, Kansas

Well No. 6-34

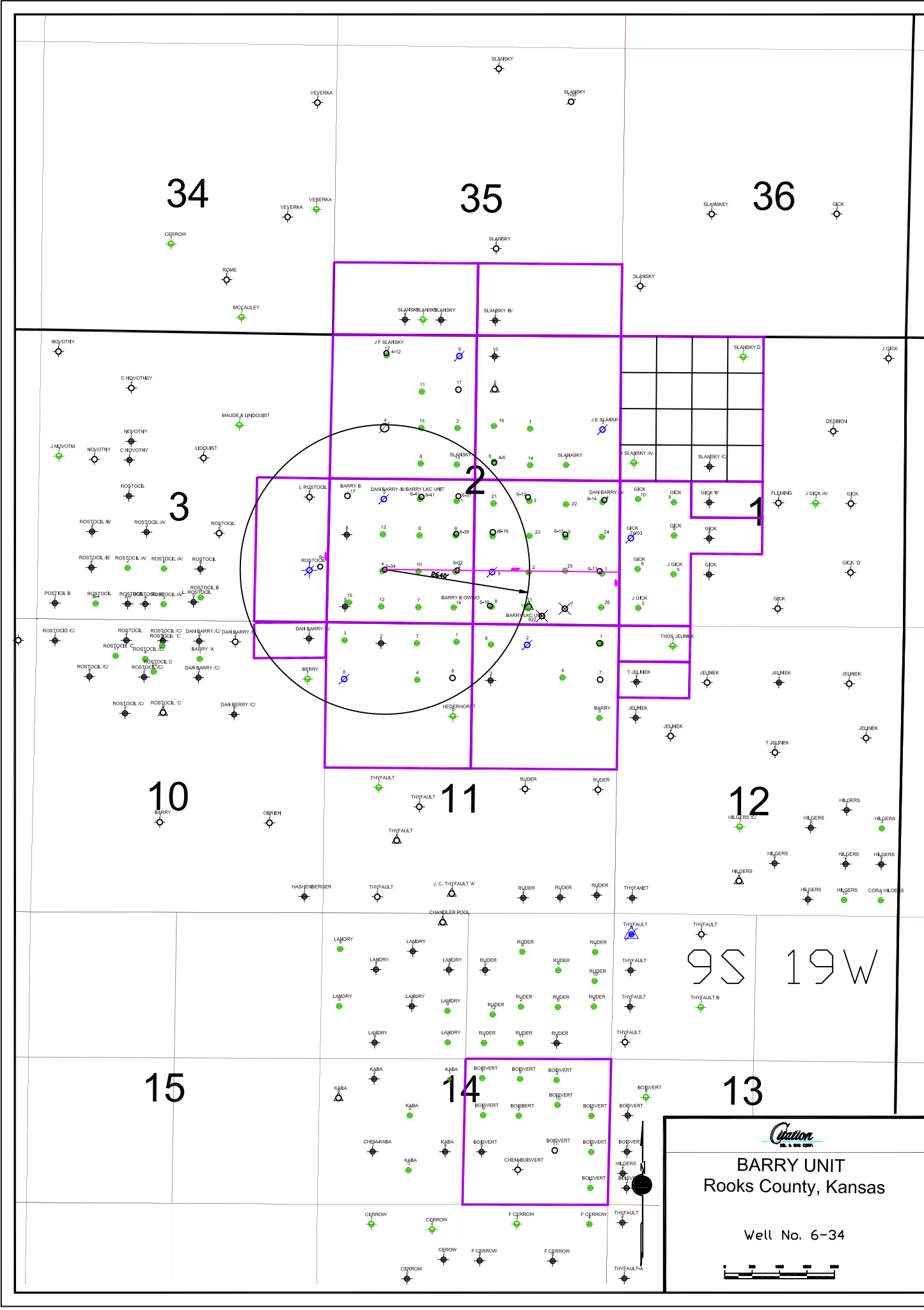

STATE OF KANSAS  
Rooks  
COUNTY SS.

# Affidavit of Publication

Jack Krier, being first duly sworn, deposes and says: That he is publisher of the *Plainville Times*, a weekly newspaper printed in the State of Kansas, and published in and of general circulation in Rooks County, Kansas, with a general paid circulation on a weekly basis in Rooks County, Kansas, and that said newspaper is not a trade, religious or fraternal publication.

Said newspaper is a weekly published one day a week and has been published continuously and uninterruptedly in said county and state for a period of more than five years prior to the first publication of said notice; and has been admitted at the post office of Plainville, Kansas, in said county as second class matter.

That the attached notice is a true copy thereof and was published in the regular and entire issue of said newspaper for 1 consecutive week, the first publication thereof being made as aforesaid on the 28 day of March, 2013, with subsequent publications being made on the following dates:

\_\_\_\_\_, 20\_\_\_\_, \_\_\_\_\_, 20\_\_\_\_  
\_\_\_\_\_, 20\_\_\_\_, \_\_\_\_\_, 20\_\_\_\_  
\_\_\_\_\_, 20\_\_\_\_, \_\_\_\_\_, 20\_\_\_\_

Signed: Jack Krier

Subscribed and sworn to before me this, 29th

day of March, 2013.

 Richelle Twenter  
Notary Public's Signature

My commission expires: 3/30/16

Publication Fee \$ 33.75  
Affidavit, Notary's Fee \$ 0.50  
Additional copies @ \$ \_\_\_\_\_  
Total Publication Fee \$ 34.25

(Published in the March 28, 2013 issue of the Plainville Times) t1

BEFORE THE STATE CORPORATION COMMISSION OF THE STATE OF KANSAS COUNTY OF ROOKS

### NOTICE OF FILING APPLICATION

Re: Citation Oil & Gas Corp. - - Application for Commingling of Production or Fluids in the Barry LKC Unit 6-34, located in Rooks County, Kansas.

TO: All Oil & Gas Producers, Unleased Mineral Interest Owners, Landowners, and all persons whoever concerned.

You, and each of you, are hereby notified that Citation Oil & Gas Corp. has filed an Application for Commingling of Production or Fluids in Lansing-Kansas City and Arbuckle formations at the Barry LKC Unit 6-34 lease, located in the NE SW SW of Section 2, T9S-R19W, Rooks County, Kansas.

Any persons who object to or protest this application shall be required to file their objections or protest with the Conservation Division of the State Corporation Commission of the State of Kansas within fifteen (15) days from the date of this publication. These protests shall be filed pursuant to Commission regulations and must state specific reasons why the grant of the application may cause waste, violate correlative rights or pollute the natural resources of the State of Kansas. All persons interested or concerned shall take notice of the foregoing and shall govern themselves accordingly.

Citation Oil & Gas Corp.  
P O Box 690688  
Houston, TX 77269-0688  
(281) 891-1564

**Offset Operators, Unleased Mineral Owners and Landowners acreage**

*(Attach additional sheets if necessary)*

Name:

Legal Description of Leasehold:

_____	_____
_____	_____
_____	_____
_____	_____
_____	_____
_____	_____
_____	_____
_____	_____
_____	_____
_____	_____
_____	_____
_____	_____
_____	_____
_____	_____
_____	_____
_____	_____
_____	_____
_____	_____
_____	_____

*I hereby certify that the statements made herein are true and correct to the best of my knowledge and belief.*

\_\_\_\_\_ *Applicant or Duly Authorized Agent*

Subscribed and sworn before me this \_\_\_\_\_ day of \_\_\_\_\_, \_\_\_\_\_

\_\_\_\_\_ *Notary Public*

My Commission Expires: \_\_\_\_\_

**Instructions:**

1. Fully complete application, including page 4 (*plat map*) showing subject well and all known oil, gas and input wells, including wells being drilled, inactive wells, or dry holes, within one-half mile. Show lease names and operators or unleased mineral rights owners of all lands within one-half mile. Show well numbers and elevations of producing formation tops.
2. Attach some type of log (*drillers log, electric log, etc.*).
3. Attach some type of verification of cementing for surface casing, longstring, D.V. tool, perforations, etc. (*Cement ticket and job log, bond log, etc.*)
4. Attach Affidavit of Notice.
5. Fill in schematic drawing of subsurface facilities including: size, setting depth, amount of cement, measured or calculated tops of cement for each of surface, intermediate (*if any*) and production casing; size and setting depth of tubing and packer; geological zone of injection showing top and bottom of injection interval.
6. The original and one copy of the application and all attachments shall be mailed to the State Corporation Commission, Conservation Division.
7. Deliver or mail one (1) copy of the application to the landowner on whose land the injection well is located and to each operator or lessee of record and each unleased mineral rights owner within one-half mile of the applicant well.
8. Approval of this application, if granted, is valid only as long as there are no substantial changes in operation set forth in the application. A substantial change requires the approval of a new application. **No injection well may be used without prior written authorization.**
9. All application fees must accompany the application.

**AFFIDAVIT**

STATE OF KANSAS \
- SS.
County of Sedgwick /

Mark Fletchall, of lawful age, being first duly sworn, depose and saith: That he is Record Clerk of The Wichita Eagle, a daily newspaper published in the City of Wichita, County of Sedgwick, State of Kansas, and having a general paid circulation on a daily basis in said County, which said newspaper has been continuously and uninterruptedly published in said County for more than one year prior to the first publication of the notice hereinafter mentioned, and which said newspaper has been entered as second class mail matter at the United States Post Office in Wichita, Kansas, and which said newspaper is not a trade, religious or fraternal publication and that a notice of a true copy is hereto attached was published in the regular and entire Morning issue of said The Wichita Eagle for  1  issues, that the first publication of said notice was

made as aforesaid on the  8th  of

April  A.D.  2013 , with

subsequent publications being made on the following dates:

And affiant further says that he has personal knowledge of the statements above set forth and that they are true.

*Mark Fletchall*

Subscribed and sworn to before me this

8th day of April, 2013

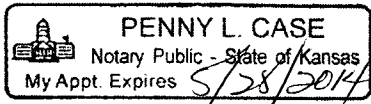

*Penny L. Case*
Notary Public Sedgwick County, Kansas

Printer's Fee :  \$101.20

**LEGAL PUBLICATION**
PUBLISHED IN THE WICHITA EAGLE
MONDAY, APRIL 8, 2013 (3239875)
STATE CORPORATION COMMISSION OF
THE STATE OF KANSAS
COUNTY OF ROOKS
**NOTICE OF FILING APPLICATION**
RE: Citation Oil & Gas Corp. - - Application
for Commingling of Production or Fluids in
the Barry LKC Unit 6-34, located in Rooks
County, Kansas.
TO: All Oil & Gas Producers, Unleased
Mineral Interest Owners, Landowners, and
all persons whoever concerned.
You, and each of you, are hereby notified
that Citation Oil & Gas Corp. has filed an
Application for Commingling of Production or
Fluids in Lansing-Kansas City and Arbuckle
formations at the **Barry LKC Unit 6-34**
lease, located in the **NE SW SW of Section 2,
T9S-R19W, Rooks County, Kansas.**
Any persons who object to or protest this
application shall be required to file their
objections or protest with the Conservation
Division of the State Corporation
Commission of the State of Kansas within
fifteen (15) days from the date of this
publication. These protests shall be filed
pursuant to Commission regulations and
must state specific reasons why the grant
of the application may cause waste, violate
correlative rights or pollute the natural
resources of the State of Kansas. All persons
interested or concerned shall take notice of
the foregoing and shall govern themselves
accordingly.
Citation Oil & Gas Corp.
P O Box 690688
Houston, TX 77269-0688
(281) 891-1564

April 23, 2013

Tami Troxel  
Citation Oil & Gas Corp  
14077 Cutten Rd  
Houston, TX 77269-0688

RE: Approved Commingling CO041311  
Barry LKC Unit 6-34, Sec. 2-T9S-R19W, Rooks County  
API No. 15-163-03501-00-00

Dear Ms. Troxel:

Your Application for Commingling (ACO-4) for the above described well has been reviewed and approved by the Kansas Corporation Commission (KCC) per K.A.R. 82-3-123. Notice was examined and found to be proper per K.A.R. 82-3-135a. No protest had been filed within the 15-day protest period. This application, which was received by the KCC on April 8, 2013, concerns approval to simultaneously produce from the following sources of supply through the same tubing string in the same wellbore:

Source of Supply	Estimated Current Production			Perf Depth
	BOPD	MCFPD	BWPD	
Topeka	4.0	0.0	35.0	3083-3110
Lansing-Kansas City	3.0	0.0	33.0	3175-3383
Arbuckle	15.0	0.0	135.0	3428-3452
Total Estimated Current Production	18.0	0.0	168.0	

Based upon the depth of the Arbuckle formation perforations, total oil production shall not exceed 100 BOPD and total gas production shall not exceed 50% of the absolute open flow (AOF).

**File Form ACO-1 upon re-completion of the well to commingle.**

Commingling ID number CO041311 has been assigned to this approved application. Use this number for well completion reports (ACO-1) and other correspondence that may concern this approved commingling.

Sincerely,

Rick Hestermann  
Production Department