



APPLICATION FOR COMMINGLING OF PRODUCTION (K.A.R. 82-3-123) OR FLUIDS (K.A.R. 82-3-123a) *Commingling ID # _____*

OPERATOR: License # _____ API No. 15 - _____
Name: _____ Spot Description: _____
Address 1: _____ - - - - - Sec. _____ Twp. _____ S. R. _____ East West
Address 2: _____ Feet from North / South Line of Section
City: _____ State: _____ Zip: _____ + _____ Feet from East / West Line of Section
Contact Person: _____ County: _____
Phone: (_____) _____ Lease Name: _____ Well #: _____

1. Name and upper and lower limit of each production interval to be commingled:
Formation: _____ (Perfs): _____
Formation: _____ (Perfs): _____
Formation: _____ (Perfs): _____
Formation: _____ (Perfs): _____
Formation: _____ (Perfs): _____

2. Estimated amount of fluid production to be commingled from each interval:
Formation: _____ BOPD: _____ MCFPD: _____ BWPD: _____
Formation: _____ BOPD: _____ MCFPD: _____ BWPD: _____
Formation: _____ BOPD: _____ MCFPD: _____ BWPD: _____
Formation: _____ BOPD: _____ MCFPD: _____ BWPD: _____
Formation: _____ BOPD: _____ MCFPD: _____ BWPD: _____

3. Plat map showing the location of the subject well, all other wells on the subject lease, and all wells on offsetting leases within a 1/2 mile radius of the subject well, and for each well the names and addresses of the lessee of record or operator.

4. Signed certificate showing service of the application and affidavit of publication as required in K.A.R. 82-3-135a.

For Commingling of PRODUCTION ONLY, include the following:

- 5. Wireline log of subject well. Previously Filed with ACO-1: Yes No
- 6. Complete Form ACO-1 (*Well Completion form*) for the subject well.

For Commingling of FLUIDS ONLY, include the following:

- 7. Well construction diagram of subject well.
- 8. Any available water chemistry data demonstrating the compatibility of the fluids to be commingled.

AFFIDAVIT: I am the affiant and hereby certify that to the best of my current information, knowledge and personal belief, this request for commingling is true and proper and I have no information or knowledge, which is inconsistent with the information supplied in this application.

Submitted Electronically

KCC Office Use Only
 Denied Approved
15-Day Periods Ends: _____
Approved By: _____ Date: _____

Protests may be filed by any party having a valid interest in the application. Protests must be in writing and comply with K.A.R. 82-3-135b and must be filed within 15 days of publication of the notice of application.

R 32 W

T
14
S

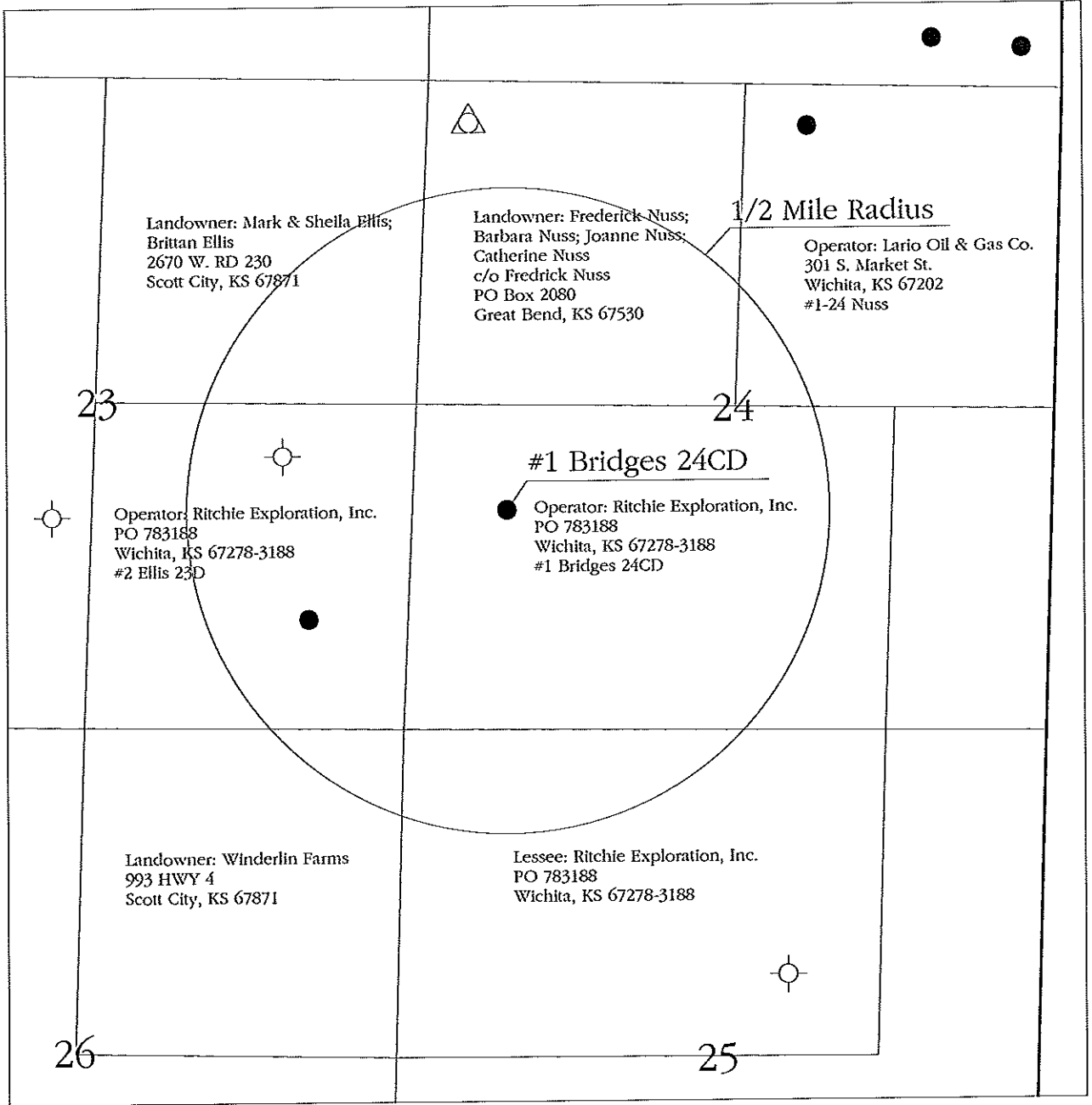

- Legend**
- Oil Well
 - ⊕ Dry and Abandoned Well
 - △ Service Well



RITCHIE
EXPLORATION, INC.
Wichita, Kansas

Application for
Commingling of
Production or Fluids

Applicant Well: #1 Bridges 24CD
All Wells within 1/2 Mile Radius
Name and Address of Lessee of Record or Operator
On Offsetting Leases

Logan County, Kansas		
Prepared By: Justin Clegg	Scale: 1 : 16,000	Date: January 28, 2013

APPLICATION FOR COMMINGLING OF PRODUCTION OR FLUIDS

Operator, Lessee or Unleased Mineral Owner
within a ½ mile radius of Ritchie Exploration, Inc.'s

#1 Bridges 24CD
1790' FSL & 782' FWL
Section 24-14S-32W
Logan Co., KS

Township 14 South, Range 32 West

Sec. 23:	NE/4	Mark & Sheila Ellis; Brittan Ellis 2670 W. RD 230 Scott City, KS 67871	Landowners
	SE/4	Ritchie Exploration, Inc. P.O. Box 783188 Wichita, KS 67278-3188	Operator: #2 Ellis 23D
Sec. 24:	NE/4	Lario Oil & Gas Company 301 S. Market St. Wichita, KS 67202	Operator: Nuss #1-24
	NW/4	Frederick Nuss; Barbara Nuss; Joanne Nuss; Catherine Nuss c/o Frederick Nuss P.O. Box 2080 Great Bend, KS 67530	Landowners
	SW/4; W/2SE/4	Ritchie Exploration, Inc.	Operator: #1 Bridges 24CD
Sec. 25:	NW/4; W/2NE/4	Ritchie Exploration, Inc.	Lessee
Sec. 26:	NE/4	Winderlin Farms 993 HWY 4 Scott City, KS 67871	Landowner

AFFIDAVIT

STATE OF KANSAS)
 - SS.
County of Sedgwick)

John Niernberger, of lawful age, being first duly sworn, deposes and saith: That he is Production Manager of Ritchie Exploration, County of Sedgwick, State of Kansas, and that notice was given to all lessee of record or operator within ½ mile radius of the Bridges 24CD #1 well located in the County of Logan (see attached plat map). This notice included a letter and a copy of the Commingle Application (ACO-4). All notices were mailed on January 29, 2013.

made as aforesaid on the 29th of

January A.D. 2013

And affiant further says that he has personal knowledge of the statements above set forth and that they are true.

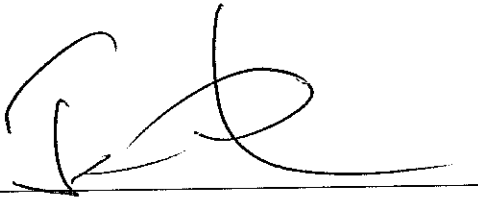

Subscribed and sworn to before me this

29th day of January 2013

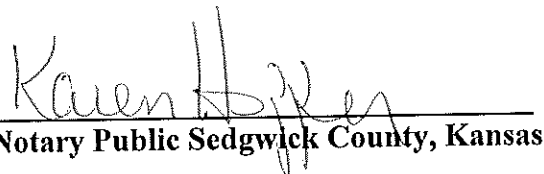

Notary Public Sedgwick County, Kansas

AFFIDAVIT

STATE OF KANSAS \
- SS.
County of Sedgwick /

Mark Fitchall, of lawful age, being first duly sworn, deposeth and saith: That he is Record Clerk of The Wichita Eagle, a daily newspaper published in the City of Wichita, County of Sedgwick, State of Kansas, and having a general paid circulation on a daily basis in said County, which said newspaper has been continuously and uninterruptedly published in said County for more than one year prior to the first publication of the notice hereinafter mentioned, and which said newspaper has been entered as second class mail matter at the United States Post Office in Wichita, Kansas, and which said newspaper is not a trade, religious or fraternal publication and that a notice of a true copy is hereto attached was published in the regular and entire Morning issue of said The Wichita Eagle for 1 issues - weeks, that the first publication of said notice was

made as aforesaid on the 30th of
January A.D. 2013, with
subsequent publications being made on
the following dates:

And affiant further says that he has personal knowledge of the statements above set forth and that they are true.

Mark Fitchall

Subscribed and sworn to before me this

March 11, 2013

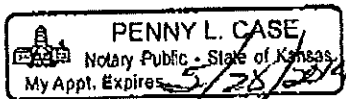

Penny L. Case
Notary Public Sedgwick County, Kansas

Printers Fee: \$136.80

230 Legal Notices

LEGAL NOTICE
You, and each of you, are hereby notified that Ritchie Exploration, Inc. has filed an application to commence the commingling of production from the Morrow Sand and Johnson sources of supply for the #1 Bridges 24CD well located approx. S/2 NW 5W of Section 24-14S-32W, Logan County, Kansas. Any persons who object to or protest this application shall be required to file their objections or protests with the Conservation Division of the State Corporation Commission of the State of Kansas within fifteen (15) days from the date of the publication. These protests shall be filed pursuant to Commission regulations and must state specific reasons why the grant of the application may cause waste, violate correlative rights or pollute the natural resources of the state of Kansas. If no protests are received, this application may be granted through a summary proceeding. If valid protests are received, this matter will be set for hearing. All persons interested or concerned shall take notice of the foregoing and shall govern themselves accordingly.
Ritchie Exploration, Inc.
PO Box 783168
Wichita, KS 67278-3168
(316) 691-9500

Proof of Publication

State of Kansas,
County of Logan, ss:

Barbara Glover

of lawful age, being duly sworn upon oath states that he/she is the editor of **THE OAKLEY GRAPHIC**.

THAT said newspaper has been published at least weekly 50 times a year and has been so published for at least five years prior to the first publication of the attached notice.

THAT said newspaper was entered as second class matter at the post office of its publication;

THAT said newspaper has a general paid circulation on a daily, weekly, monthly, or yearly basis in LOGAN County, Kansas and is NOT a trade, religious or fraternal publication and has been printed and published in LOGAN County, Kansas.

THE ATTACHED was published on the following dates in a regular issue of said newspaper:

1st Publication was made on the 6 day of Feb., 20 13
2nd Publication was made on the ___ day of ___, 20 ___
3rd Publication was made on the ___ day of ___, 20 ___
4th Publication was made on the ___ day of ___, 20 ___
5th Publication was made on the ___ day of ___, 20 ___
6th Publication was made on the ___ day of ___, 20 ___

Publication fee \$ 43.20
Affidavit, Notary's Fees \$ _____
Additional Copies @ _____ \$ _____
Total Publication Fee \$ 43.20

Barbara Glover
(Signed)

Witness my hand this 15 day of February, 20 13

SUBSCRIBED and SWORN to before me this 15

day of February, 20 13.

Kelley C. Anderson
(Notary Public)

My commission expires 2.7.2014

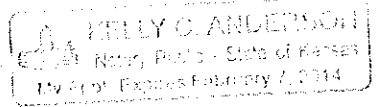

Published in the Oakley Graphic Feb. 6, 2013
LEGAL NOTICE

You, and each of you, are hereby notified that Ritchie Exploration, Inc. has filed an application to commence the commingling of production from the Morrow Sand and Johnson sources of supply for the #1 Bridges 24CD well located approx. S/2 NW SW of Section 24-14S-32W, Logan County, Kansas.

Any persons who object to or protest this application shall be required to file their objections or protests with the Conservation Division of the State Corporation Commission of the State of Kansas within fifteen (15) days from the date of the publication. These protests shall be filed pursuant to Commission regulations and must state specific reasons why the grant of the application may cause waste, violate correlative rights or pollute the natural resources of the state of Kansas.

If no protests are received, this application may be granted through a summary proceeding. If valid protests are received, this matter will be set for hearing.

All persons interested or concerned shall take notice of the foregoing and shall govern themselves accordingly.

RITCHIE EXPLORATION, INC.
P.O. Box 783188
Wichita, KS 67278-3188
316) 691-9500

**KANSAS CORPORATION COMMISSION
OIL & GAS CONSERVATION DIVISION**

Form ACO-1
October 2008
Form Must Be Typed

**WELL COMPLETION FORM
WELL HISTORY - DESCRIPTION OF WELL & LEASE**

OPERATOR: License # 4767
 Name: Ritchie Exploration, Inc.
 Address 1: P.O. Box 783188
 Address 2: _____
 City: Wichita State: KS Zip: 67278 + 3118
 Contact Person: John Niernberger
 Phone: (316) 691-9500
 CONTRACTOR: License # 30606
 Name: Murfin Drilling Co., Inc.
 Wellsite Geologist: Jeff Christian
 Purchaser: NCRA
 Designate Type of Completion:
 New Well Re-Entry Workover
 Oil SWD SIOW
 Gas ENHR SIGW
 CM (Coal Bed Methane) Temp. Abd.
 Dry Other _____
 (Core, WSW, Expl., Cathodic, etc.)

If Workover/Re-entry: Old Well Info as follows:
 Operator: _____
 Well Name: _____
 Original Comp. Date: _____ Original Total Depth: _____
 Deepening Re-perf. Conv. to Enhr. Conv. to SWD
 Plug Back: _____ Plug Back Total Depth _____
 Commingled Docket No.: _____
 Dual Completion Docket No.: _____
 Other (SWD or Enhr.?) Docket No.: _____

<u>7/14/10</u>	<u>7/24/10</u>	<u>7/24/10</u>
Spud Date or Recompletion Date	Date Reached TD	Completion Date or Recompletion Date

API No. 15 - 109-20926-00-00
 Spot Description: 140' N & 122' E of
 S/2 NW SW Sec. 24 Twp. 14 S. R. 32 East West
1790 Feet from North / South Line of Section
782 Feet from East / West Line of Section
 Footages Calculated from Nearest Outside Section Corner:
 NE NW SE SW
 County: Logan
 Lease Name: Bridges 24CD Well #: 1
 Field Name: _____
 Producing Formation: Morrow Sand & Johnson
 Elevation: Ground: 2743 Kelly Bushing: 2753
 Total Depth: 4460 Plug Back Total Depth: 4426
 Amount of Surface Pipe Set and Cemented at: 214 Feet
 Multiple Stage Cementing Collar Used? Yes No
 If yes, show depth set: 2197 Feet
 If Alternate II completion, cement circulated from: surface
 feet depth to: 2197 w/ 245 sx cmf.

Drilling Fluid Management Plan
 (Data must be collected from the Reserve Pit)
 Chloride content: 7000 ppm Fluid volume: 700 bbls
 Dewatering method used: evaporation
 Location of fluid disposal if hauled offsite: _____
 Operator Name: _____
 Lease Name: _____ License No.: _____
 Quarter _____ Sec. _____ Twp. _____ S. R. _____ East West
 County: _____ Docket No.: _____

INSTRUCTIONS: An original and two copies of this form shall be filed with the Kansas Corporation Commission, 130 S. Market - Room 2078, Wichita, Kansas 67202, within 120 days of the spud date, recompletion, workover or conversion of a well. Rule 82-3-130, 82-3-106 and 82-3-107 apply. Information of side two of this form will be held confidential for a period of 12 months if requested in writing and submitted with the form (see rule 82-3-107 for confidentiality in excess of 12 months). One copy of all wireline logs and geologist well report shall be attached with this form. ALL CEMENTING TICKETS MUST BE ATTACHED. Submit CP-4 form with all plugged wells. Submit CP-111 form with all temporarily abandoned wells.

All requirements of the statutes, rules and regulations promulgated to regulate the oil and gas industry have been fully complied with and the statements herein are complete and correct to the best of my knowledge.

Signature: _____
 Title: Production Manager Date: 10/28/10
 Subscribed and sworn to before me this 28th day of October,
 20 10.
 Notary Public: [Signature]
 Date Commission Expires: 5-4-11

KCC Office Use ONLY

Letter of Confidentiality Received
 If Denied, Yes Date: _____
 Wireline Log Received
 Geologist Report Received
 UIC Distribution

DEBRA K. PHILLIPS
 Notary Public - State of Kansas
 My Appt. Expires 5-4-11

Operator Name: Ritchie Exploration, Inc. Lease Name: Bridges 24CD Well #: 1
 Sec. 24 Twp. 14 S. R. 32 East West County: Logan

INSTRUCTIONS: Show important tops and base of formations penetrated. Detail all cores. Report all final copies of drill stems tests giving interval tested, time tool open and closed, flowing and shut-in pressures, whether shut-in pressure reached static level, hydrostatic pressures, bottom hole temperature, fluid recovery, and flow rates if gas to surface test, along with final chart(s). Attach extra sheet if more space is needed. Attach copy of all Electric Wireline Logs surveyed. Attach final geological well site report.

Drill Stem Tests Taken <input checked="" type="checkbox"/> Yes <input type="checkbox"/> No <i>(Attach Additional Sheets)</i> Samples Sent to Geological Survey <input checked="" type="checkbox"/> Yes <input type="checkbox"/> No Cores Taken <input type="checkbox"/> Yes <input checked="" type="checkbox"/> No Electric Log Run <input checked="" type="checkbox"/> Yes <input type="checkbox"/> No <i>(Submit Copy)</i> List All E. Logs Run: Dual Induction Log Compensated Density/Neutron Log	<input type="checkbox"/> Log Formation (Top), Depth and Datum <input checked="" type="checkbox"/> Sample Name Top Datum SEE ATTACHED
-----------------------------------------------------------------------------------------------------------------------------------------------------------------------------------------------------------------------------------------------------------------------------------------------------------------------------------------------------------------------------------------------------------------------------------------------------------------------------------------------------------------------------------------------------	------------------------------------------------------------------------------------------------------------------------------------------------

CASING RECORD <input checked="" type="checkbox"/> New <input type="checkbox"/> Used							
Report all strings set-conductor, surface, intermediate, production, etc.							
Purpose of String	Size Hole Drilled	Size Casing Set (In O.D.)	Weight Lbs. / Ft.	Setting Depth	Type of Cement	# Sacks Used	Type and Percent Additives
Surface	12-1/4	8-5/8	23#	214	common	175	3%cc, 2%gel
Production	7-7/8	5-1/2	15.5#	4457	ASC	200	10% salt, 2% gal & 3/4% CD-31

ADDITIONAL CEMENTING / SQUEEZE RECORD				
Purpose:	Depth Top Bottom	Type of Cement	#Sacks Used	Type and Percent Additives
<input type="checkbox"/> Perforate <input type="checkbox"/> Protect Casing <input type="checkbox"/> Plug Back TD <input type="checkbox"/> Plug Off Zone				

Shots Per Foot	PERFORATION RECORD - Bridge Plugs Set/Type Specify Footage of Each Interval Perforated	Acid, Fracture, Shot, Cement Squeeze Record <i>(Amount and Kind of Material Used)</i>	Depth
4	4384.5' - 4391' (8/6/10)	1000 gals 7.5% MIRA w/10% Methanol	
		220 bbls Pro-Gel & 16,500# of 16/30 Brady sand + 247,000 SCF N2	
4	4356.5' - 4361', 4342.5' - 4348' (9/8/10)	1000 gals 15% NE	
	*****Waiting on County Road to be built so can set Equipment*****		

TUBING RECORD: Size: <u>2-7/8</u> Set At: <u>4410</u> Packer At: <u> </u>		Liner Run: <input type="checkbox"/> Yes <input checked="" type="checkbox"/> No
Date of First, Resumed Production, SWD or Enhr. <u> </u>		Producing Method: <input type="checkbox"/> Flowing <input checked="" type="checkbox"/> Pumping <input type="checkbox"/> Gas Lift <input type="checkbox"/> Other (Explain) <u> </u>
Estimated Production Per 24 Hours	Oil Bbls. <u> </u> Gas Mcf <u> </u> Water Bbls. <u> </u> Gas-Oil Ratio <u> </u> Gravity <u> </u>	

DISPOSITION OF GAS: <input type="checkbox"/> Vented <input type="checkbox"/> Sold <input type="checkbox"/> Used on Lease <i>(If vented, Submit ACO-18.)</i>	METHOD OF COMPLETION: <input type="checkbox"/> Open Hole <input type="checkbox"/> Perf. <input type="checkbox"/> Dually Comp. <input type="checkbox"/> Commingled <input type="checkbox"/> Other (Specify) <u> </u>	PRODUCTION INTERVAL: <u> </u> <u> </u>
-------------------------------------------------------------------------------------------------------------------------------------------------------------------	---------------------------------------------------------------------------------------------------------------------------------------------------------------------------------------------------------------------------	----------------------------------------------



#1 Bridges 24CD

1790' FSL & 782' FWL

140' N & 122' E of S/2 NW SW Section 24-14S-32W

Logan County, Kansas

API# 15-109-20926-0000

Elevation: GL: 2743', KB: 2753'

Sample Tops			Ref. Well
Anhydrite	2217'	+536	-1
B/Anhydrite	2232'	+521	+4
Heebner	3735'	-982	+13
Lansing	3770'	-1017	+14
Lansing "C"	3805'	-1052	+15
Lansing "D"	3820'	-1067	+12
Lansing "E"	3857'	-1104	+15
Muncie Shale	3928'	-1175	+20
Lansing "H"	3942'	-1189	+18
Lansing "I"	3974'	-1221	+17
Lansing "J"	4002'	-1249	+16
Lansing "K"	4036'	-1283	+10
Lansing "L"	4067'	-1314	+12
BKC	4111'	-1358	+9
Marmaton	4133'	-1380	+7
Altamont	4153'	-1400	+11
Pawnee	4222'	-1469	+16
Myric Station	4260'	-1507	+17
Fort Scott	4275'	-1522	+16
Cherokee Shale	4303'	-1550	+16
Johnson	4344'	-1591	+16
B/Johnson	4374'	-1621	+16
Morrow Sand	4384'	-1631	+36
Mississippian	4392'	-1639	+35
RTD	4460'	-1707	

Mark Sievers, Chairman
Thomas E. Wright, Commissioner
Shari Feist Albrecht, Commissioner

Sam Brownback, Governor

March 12, 2013

John Niernberger
Ritchie Exploration, Inc.
P.O. Box 783188
Wichita, KS 67278-3188

RE: Approved Commingling CO031305
Bridges 24 CD 1, Sec.24-T14S-R32W, Logan County
API No. 15-109-20926-00-00

Dear Mr. Niernberger:

Your Application for Commingling (ACO-4) for the above described well has been reviewed and approved by the Kansas Corporation Commission (KCC) per K.A.R. 82-3-123. Notice was examined and found to be proper per K.A.R. 82-3-135a. No protest had been filed within the 15-day protest period. This application, which was received by the KCC on March 12, 2013, concerns approval to simultaneously produce from the following sources of supply through the same tubing string in the same wellbore:

Source of Supply	Estimated Current Production			Perf Depth
	BOPD	MCFPD	BWPD	
Morrow Sand	0.73	0.00	12.26	4384-4391
Johnson	4.29	0.00	2.16	4356-4361; 4342-4348
Total Estimated Current Production	5.02	0.00	14.42	

Based upon the depth of the Morrow Sand formation perforations, total oil production shall not exceed 200 BOPD and total gas production shall not exceed 50% of the absolute open flow (AOF).

Commingling ID number CO031305 has been assigned to this approved application. Use this number for well completion reports (ACO-1) and other correspondence that may concern this approved commingling.

Sincerely,

Rick Hestermann
Production Department