



Confidentiality Requested:

Yes No

KANSAS CORPORATION COMMISSION 1121056
OIL & GAS CONSERVATION DIVISION

Form ACO-1
August 2013

Form must be Typed
Form must be Signed
All blanks must be Filled

WELL COMPLETION FORM
WELL HISTORY - DESCRIPTION OF WELL & LEASE

OPERATOR: License # _____

Name: _____

Address 1: _____

Address 2: _____

City: _____ State: _____ Zip: _____ + _____

Contact Person: _____

Phone: (_____) _____

CONTRACTOR: License # _____

Name: _____

Wellsite Geologist: _____

Purchaser: _____

Designate Type of Completion:

- New Well Re-Entry Workover
- Oil WSW SWD SIOW
- Gas D&A ENHR SIGW
- OG GSW Temp. Abd.
- CM (Coal Bed Methane)
- Cathodic Other (Core, Expl., etc.): _____

If Workover/Re-entry: Old Well Info as follows:

Operator: _____

Well Name: _____

Original Comp. Date: _____ Original Total Depth: _____

- Deepening Re-perf. Conv. to ENHR Conv. to SWD
- Plug Back Conv. to GSW Conv. to Producer
- Commingled Permit #: _____
- Dual Completion Permit #: _____
- SWD Permit #: _____
- ENHR Permit #: _____
- GSW Permit #: _____

Spud Date or Recompletion Date	Date Reached TD	Completion Date or Recompletion Date
-----------------------------------	-----------------	---

API No. 15 - _____

Spot Description: _____

_____-_____-_____-_____-_____-_____-_____-_____-_____-_____-_____-_____-_____-_____-_____-
Sec. _____ Twp. _____ S. R. _____ East West

_____-_____-_____-_____-_____-_____-_____-_____-_____-_____-_____-_____-_____-_____-_____-
Feet from North / South Line of Section

_____-_____-_____-_____-_____-_____-_____-_____-_____-_____-_____-_____-_____-_____-_____-
Feet from East / West Line of Section

Footages Calculated from Nearest Outside Section Corner:

- NE NW SE SW

GPS Location: Lat: _____, Long: _____
(e.g. xx.xxxxx) (e.g. -xxx.xxxxx)

Datum: NAD27 NAD83 WGS84

County: _____

Lease Name: _____ Well #: _____

Field Name: _____

Producing Formation: _____

Elevation: Ground: _____ Kelly Bushing: _____

Total Vertical Depth: _____ Plug Back Total Depth: _____

Amount of Surface Pipe Set and Cemented at: _____ Feet

Multiple Stage Cementing Collar Used? Yes No

If yes, show depth set: _____ Feet

If Alternate II completion, cement circulated from: _____

feet depth to: _____ w/ _____ sx cmt.

Drilling Fluid Management Plan

(Data must be collected from the Reserve Pit)

Chloride content: _____ ppm Fluid volume: _____ bbls

Dewatering method used: _____

Location of fluid disposal if hauled offsite:

Operator Name: _____

Lease Name: _____ License #: _____

Quarter _____ Sec. _____ Twp. _____ S. R. _____ East West

County: _____ Permit #: _____

AFFIDAVIT

I am the affiant and I hereby certify that all requirements of the statutes, rules and regulations promulgated to regulate the oil and gas industry have been fully complied with and the statements herein are complete and correct to the best of my knowledge.

Submitted Electronically

KCC Office Use ONLY

- Confidentiality Requested
Date: _____
- Confidential Release Date: _____
- Wireline Log Received
- Geologist Report Received
- UIC Distribution
- ALT I II III Approved by: _____ Date: _____



1121056

Operator Name: _____ Lease Name: _____ Well #: _____

Sec. _____ Twp. _____ S. R. _____ East West County: _____

INSTRUCTIONS: Show important tops of formations penetrated. Detail all cores. Report all final copies of drill stems tests giving interval tested, time tool open and closed, flowing and shut-in pressures, whether shut-in pressure reached static level, hydrostatic pressures, bottom hole temperature, fluid recovery, and flow rates if gas to surface test, along with final chart(s). Attach extra sheet if more space is needed.

Final Radioactivity Log, Final Logs run to obtain Geophysical Data and Final Electric Logs must be emailed to kcc-well-logs@kcc.ks.gov. Digital electronic log files must be submitted in LAS version 2.0 or newer AND an image file (TIFF or PDF).

Drill Stem Tests Taken <input type="checkbox"/> Yes <input type="checkbox"/> No <i>(Attach Additional Sheets)</i> Samples Sent to Geological Survey <input type="checkbox"/> Yes <input type="checkbox"/> No Cores Taken <input type="checkbox"/> Yes <input type="checkbox"/> No Electric Log Run <input type="checkbox"/> Yes <input type="checkbox"/> No List All E. Logs Run: _____	<input type="checkbox"/> Log Formation (Top), Depth and Datum <input type="checkbox"/> Sample Name Top Datum
--	---

CASING RECORD <input type="checkbox"/> New <input type="checkbox"/> Used							
Report all strings set-conductor, surface, intermediate, production, etc.							
Purpose of String	Size Hole Drilled	Size Casing Set (In O.D.)	Weight Lbs. / Ft.	Setting Depth	Type of Cement	# Sacks Used	Type and Percent Additives

ADDITIONAL CEMENTING / SQUEEZE RECORD				
Purpose:	Depth Top Bottom	Type of Cement	# Sacks Used	Type and Percent Additives
<input type="checkbox"/> Perforate <input type="checkbox"/> Protect Casing <input type="checkbox"/> Plug Back TD <input type="checkbox"/> Plug Off Zone				

Did you perform a hydraulic fracturing treatment on this well? Yes No *(If No, skip questions 2 and 3)*
 Does the volume of the total base fluid of the hydraulic fracturing treatment exceed 350,000 gallons? Yes No *(If No, skip question 3)*
 Was the hydraulic fracturing treatment information submitted to the chemical disclosure registry? Yes No *(If No, fill out Page Three of the ACO-1)*

Shots Per Foot	PERFORATION RECORD - Bridge Plugs Set/Type Specify Footage of Each Interval Perforated	Acid, Fracture, Shot, Cement Squeeze Record <i>(Amount and Kind of Material Used)</i>	Depth

TUBING RECORD: Size: _____ Set At: _____ Packer At: _____ Liner Run: Yes No

Date of First, Resumed Production, SWD or ENHR. _____ Producing Method:
 Flowing Pumping Gas Lift Other *(Explain)* _____

Estimated Production Per 24 Hours	Oil Bbls.	Gas Mcf	Water Bbls.	Gas-Oil Ratio	Gravity

DISPOSITION OF GAS: <input type="checkbox"/> Vented <input type="checkbox"/> Sold <input type="checkbox"/> Used on Lease <i>(If vented, Submit ACO-18.)</i>	METHOD OF COMPLETION: <input type="checkbox"/> Open Hole <input type="checkbox"/> Perf. <input type="checkbox"/> Dually Comp. <input type="checkbox"/> Commingled <i>(Submit ACO-5)</i> <input type="checkbox"/> Other <i>(Specify)</i> _____ <i>(Submit ACO-4)</i>	PRODUCTION INTERVAL: _____ _____
--	---	---

Form	ACO1 - Well Completion
Operator	SandRidge Exploration and Production LLC
Well Name	Michael 3507 1-7H
Doc ID	1121056

All Electric Logs Run

Boresight
Density
Induction
Mudlog

Form	ACO1 - Well Completion
Operator	SandRidge Exploration and Production LLC
Well Name	Michael 3507 1-7H
Doc ID	1121056

Perforations

Shots Per Foot	Perforation Record	Material Record	Depth
2	9488-9830	4220 bbls water, 36 bbls acid, 75M lbs sd, 4303 TLTR	
5	9157-9437	4215 bbls water, 36 bbls acid, 75M lbs sd, 9193 TLTR	
5	8794-9058	4209 bbls water, 36 bbls acid, 75M lbs sd, 13921 TLTR	
5	8409-8699	4203 bbls water, 36 bbls acid, 75M lbs sd, 18592 TLTR	
5	8132-8358	4199 bbls water, 36 bbls acid, 75M lbs sd, 22968 TLTR	
5	7661-8000	4192 bbls water, 36 bbls acid, 75M lbs sd, 27286 TLTR	
5	7280-7587	4186 bbls water, 36 bbls acid, 75M lbs sd, 31604 TLTR	
5	6992-7222	4181 bbls water, 36 bbls acid, 75M lbs sd, 35886 TLTR	
5	6576-6894	4175 bbls water, 36 bbls acid, 75M lbs sd, 41062 TLTR	
5	6571-6894	4205 bbls water, 36 bbls acid, 75M lbs sd, 45777 TLTR	

Form	ACO1 - Well Completion
Operator	SandRidge Exploration and Production LLC
Well Name	Michael 3507 1-7H
Doc ID	1121056

Casing

Purpose Of String	Size Hole Drilled	Size Casing Set	Weight	Setting Depth	Type Of Cement	Number of Sacks Used	Type and Percent Additives
Conductor	20	20	75	90	Mid-Continent Conductor grout	10	none
Surface	12.25	9.63	36	823	Schlumberger Class C Cement	210	1115 lb Bentonite Extender, 73 cf LITEPOZ 3 Extender, 53 lb Polyester Flake, 366 lb Calcium Chloride 77 pct concentration

Form	ACO1 - Well Completion
Operator	SandRidge Exploration and Production LLC
Well Name	Michael 3507 1-7H
Doc ID	1121056

Casing

Purpose Of String	Size Hole Drilled	Size Casing Set	Weight	Setting Depth	Type Of Cement	Number of Sacks Used	Type and Percent Additives
Intermediate	8.75	7	25	5317	50/50 POZ Class H	290	32 lb Chemical Extender, 368 lb Bentonite Extender, 95 cf LITEPOZ 3 Extender, 380 lb KOLITE Lost Circulation Additive, 51 lb Antifoam Agent, 18 lb TIC Dispersant, 96 lb FLAC Fluid Loss Additive

Form	ACO1 - Well Completion
Operator	SandRidge Exploration and Production LLC
Well Name	Michael 3507 1-7H
Doc ID	1121056

Casing

Purpose Of String	Size Hole Drilled	Size Casing Set	Weight	Setting Depth	Type Of Cement	Number of Sacks Used	Type and Percent Additives
Production Liner	6.12	4.5	11.6	9956	Class H Cement	385	627 lb Bentonite Extender, 286 cf LITEPOZ 3 Extender, 400 lb KOLITE Lost Circulation Additive, 96 lb Antifoam Agent, 49 lb TIC Dispersant, 96 lb Chemical Extender, 286 lb FLAC Fluid Loss Additive

Conservation Division
Finney State Office Building
130 S. Market, Rm. 2078
Wichita, KS 67202-3802



Phone: 316-337-6200
Fax: 316-337-6211
<http://kcc.ks.gov/>

Mark Sievers, Chairman
Thomas E. Wright, Commissioner
Shari Feist Albrecht, Commissioner

Sam Brownback, Governor

March 04, 2013

Tiffany Golay
SandRidge Exploration and Production LLC
123 ROBERT S. KERR AVE
OKLAHOMA CITY, OK 73102-6406

Re: ACO1
API 15-077-21901-01-00
Michael 3507 1-7H
NW/4 Sec.07-35S-07W
Harper County, Kansas

Dear Production Department:

We are herewith requesting that the Well Completion Form ACO-1 and attached information for the subject well be held confidential for a period of two years.

Should you have any questions or need additional information regarding subject well, please contact our office.

Respectfully,
Tiffany Golay

Mid-Continent Conductor, LLC

P.O. Box 1570
Woodward, OK 73802
Phone: (580)254-5400
Fax: (580)254-3242

Invoice

Date	Invoice #
1/21/2013	1666

Bill To
SandRidge Energy, Inc. Attn: Purchasing Mgr. 123 Robert S. Kerr Avenue Oklahoma City, OK. 73102

Ordered By	Terms	Date of Service	Lease Name/Legal Desc.	Drilling Rig
Ricky Beene	Net 45	1/21/2013	Michael 3507 1-7H, Harper Cnty, KS	Horizon 15

Item	Quantity	Description
Conductor Hole	90	Drilled 90 ft. conductor hole
20" Pipe	90	Furnished 90 ft. of 20 inch conductor pipe
Mouse Hole	80	Drilled 80 ft. mouse hole
16" Pipe	80	Furnished 80 ft. of 16 inch mouse hole pipe
Cellar Hole	1	Drilled 6' x 6' cellar hole
6' X 6' Tinhorn	1	Furnished and set 6' X 6' tinhorn
Mud and Water	1	Furnished mud and water to location
Transport Truck - Conductor	1	Transport mud and water to location
Grout & Trucking	10	Furnished grout and trucking to location
Grout Pump	1	Furnished grout pump
Fence Panels	4	Furnished and set fence panels around conductor holes
Welder & Materials	1	Furnished welder and materials
Dirt Removal	1	Furnished labor and equipment for dirt removal
Cover Plate	1	Furnished cover plates
Permits	1	Permits

AFE: DC12310
 Well: MICHAEL 3506 1-7H
 Code: 850.010
 AMT: [REDACTED]
 Co Man: [Signature] JAMES PRIET

Subtotal	<u>[REDACTED]</u>
Sales Tax (0.0%)	\$0.00
Total	<u>[REDACTED]</u>



Service Contract Receipt
SCHLUMBERGER TECHNOLOGY CORPORATION

Service Contract Number
C4PA-00147

Invoice Mailing Address: SANDRIDGE ENERGY INC. - FOR ELECTRONIC INVOICING ONLY (EDI) 123 ROBERT S. KERR AVENUE OKLAHOMA CITY OK 73102-6406 USA		Left District Date: 10-Feb-2013 Time: 5:00 AM
		Arrive Location Date: 10-Feb-2013 Time: 8:00 AM
		Start Job Date: 10-Feb-2013 Time: 6:00 PM
		Complete Job Date: 10-Feb-2013 Time: 7:00 PM
		Leave Location Date: 10-Feb-2013 Time: 8:00 PM
		Arrived District Date: 11-Feb-2013 Time: 12:00 AM
Service Description: Cementing Primary, Primary Surface		
Customer PO AFE DC 12310	Contract Cust Ref	Well Name & Number MICHAEL-3507-1-7 H Field OKAN
		County/Parish/Block/Borough Harper State/Province KS
Customer or Authorized Representative Imael Franco		SLB Location El Reno, OK Legal Location
API/UWI 15077219010100	Pricebook B0JS / WSV_GEOREF_USL_2011_USD_Pressure_Pumping_US_	Rig Horizon 15
Service Instructions: cement 9 5/8 casing		

THE ESTIMATED CHARGES AND DATA SHOWN BELOW ARE SUBJECT TO CORRECTION BY SCHLUMBERGER

Item	Description	Qty	Unit	Price	Disc %	Amount
------	-------------	-----	------	-------	--------	--------

Products

56704005	Plug, Top Rubber Alum Core 9.625 in	0	EA	665.00	47.00%	0.00
56720005	Plug, Cementing Bottom Aluminum 9.625 in	0	EA	890.00	47.00%	0.00
D020	Bentonite Extender	1115	LB	0.50	47.00%	
D035-CF	LITEPOZ 3 Extender	73	CF	9.20	47.00%	
D130	Polyester Flake	53	LB	4.40	47.00%	
D903	Cement, Class C	327	CF	22.95	47.00%	
S001	Calcium Chloride 77pct concentration	366	LB	1.44	47.00%	

Products Subtotal:

Discount:

Products Total:

Services

48019000	Bulk Unit, Per Hr on location	8	HR	115.00	47.00%	
48601000	Cement Plug Container	1	JOB	556.40	47.00%	
49100000	Cement Blending Charge	424	CF	2.43	47.00%	
49102000	Transportation, Cement Ton-mile	943	MI	2.16	47.00%	
59200002	Transportation, Mileage Heavy Vehicles	100	MI	5.91	47.00%	
59200005	Transportation, Mileage Light Vehicles	100	MI	3.47	47.00%	
59697004	CemCAT Monitoring System	1	JOB	941.60	47.00%	
102871020	Pump, Casing Cement 0-2000 ft	1	EA	2,396.80	47.00%	
102946000	Fuel Surcharge (non-discounted)	3	EA	450.00		
107138100	Circulating Equipment before job	1	EA	1,498.00	25.00%	
107264001	Regulatory Conformance Charge	3	EA	364.87		
48020000	Pump, Cement Add Hr	6	HR	608.90	35.00%	
48019000	Bulk Unit, Per Hr on location	12	HR	115.00	35.00%	
102476000	Service Supervisor/Field Engineer	2	HR	112.35	35.00%	
102476001	Equipment Operator/Service Technician	2	HR	90.95	35.00%	

Services Subtotal:

Discount:

Services Total:

Total (Before Discount):	65,000.00
Discount:	65,000.00
Special Discount:	0.00
Estimated Discounted Total (USD):	70,500.00



Service Contract Receipt
SCHLUMBERGER TECHNOLOGY CORPORATION

Service Contract Number
C4PA-00181

Invoice Mailing Address: SANDRIDGE ENERGY INC. - FOR ELECTRONIC INVOICING ONLY (EDI) 123 ROBERT S. KERR AVENUE OKLAHOMA CITY OK 73102-6406 USA		Left District	Date: 17-Feb-2013	Time: 2:00 AM
		Arrive Location	Date: 17-Feb-2013	Time: 5:30 AM
		Start Job	Date: 17-Feb-2013	Time: 8:30 AM
		Complete Job	Date: 17-Feb-2013	Time: 10:00 AM
		Leave Location	Date: 17-Feb-2013	Time: 11:00 AM
		Arrived District	Date: 17-Feb-2013	Time: 3:00 PM
Service Description: Cementing Primary, Primary Intermediate				
Customer PO	Contract	Well Name & Number	Field	
AFE	Cust Ref	County/Parish/Block/Borough	State/Province	
Customer or Authorized Representative		SLB Location	Legal Location	
API/UM	Pricebook	Rig		
15077219010100	BOJS / WSV_GEOREF_USL_2011_USD_Pressure_Pumping_US_	Horizon 15		
Service Instructions: To provide services, equipment, personnel and materials to safely cement a 7" intermediate casing as per client request.				

THE ESTIMATED CHARGES AND DATA SHOWN BELOW ARE SUBJECT TO CORRECTION BY SCHLUMBERGER

Item	Description	Qty	Unit	Price	%	Amount
Products						
✓ D079	Chemical Extender	32	LB.	3.05	47%	
56704070	Plug, Top Rubber Alum Core 7 in	1	EA	400.00	47.00%	
B306	PSG Polymer Slurry B306	5	GA	105.00	47.00%	
✓ D013	Retarder	8	LB	2.79	47.00%	
✓ D020	Bentonite Extender	638	LB	0.50	47.00%	
✓ D035-CF	LITEPOZ 3 Extender	95	CF	9.20	47.00%	
✓ D042	KOLITE Lost Circulation Additive	380	LB	0.99	47.00%	
✓ D046	Antifoam Agent, All Purpose	51	LB	5.90	47.00%	
✓ D065	TIC Dispersant	18	LB	7.86	47.00%	
✓ D112	FLAC Fluid Loss Additive	96	LB	15.20	47.00%	
✓ D909	Cement, Class H	195	CF	24.13	47.00%	
Products Subtotal:						
Discount:						
Products Total:						
Services						
48019000	Bulk Unit, Per Hr on location	6	HR	115.00	47.00%	
48020000	Pump, Cement Add Hr	2	HR	609.90	35.00%	
48601000	Cement Plug Container	1	JOB	556.40	47.00%	
49100000	Cement Blending Charge	307	CF	2.43	47.00%	
49102000	Transportation, Cement Ton-mile	663	MI	2.16	47.00%	
59200002	Transportation, Mileage Heavy Vehicles	100	MI	5.91	47.00%	
59200005	Transportation, Mileage Light Vehicles	100	MI	3.47	47.00%	
59697004	CemCAT Monitoring System	1	JOB	941.60	47.00%	
102871060	Pump, Casing Cement 5501-8000 ft	1	EA	3,745.00	47.00%	
102946000	Fuel Surcharge (non-discounted)	2	EA	450.00		
107138100	Circulating Equipment before job	1	EA	1,498.00	25.00%	
107264001	Regulatory Conformance Charge	2	EA	364.87		
Services Subtotal:						
Discount:						
Services Total:						
Total (Before Discount):						
Discount:						
Special Discount:		0.00				
Estimated Discounted Total (USD):						



Service Contract Receipt
SCHLUMBERGER TECHNOLOGY CORPORATION

Service Contract Number CDL7-00116

Invoice Mailing Address: SANDRIDGE ENERGY INC. - FOR ELECTRONIC INVOICING ONLY (EDI) 123 ROBERT S. KERR AVENUE OKLAHOMA CITY OK 73102-6406 USA	Left District	Date: 03-Mar-2013	Time: 6:00 PM
	Arrive Location	Date: 03-Mar-2013	Time: 10:00 PM
	Start Job	Date: 04-Mar-2013	Time: 1:00 PM
	Complete Job	Date: 04-Mar-2013	Time: 3:00 PM
	Leave Location	Date: 04-Mar-2013	Time: 4:00 PM
	Arrived District	Date: 04-Mar-2013	Time: 8:00 PM
	Service Description: Cementing Primary, Primary Liner		
Customer PO	Contract	Well Name & Number Michael 3506 1-7H	Field Harper
AFE	Cust Ref	County/Parish/Block/Borough Harper	State/Province Kansas
Customer or Authorized Representative ISMAEL FRANCO		SLB Location El Reno, OK	Legal Location
API/UWI 15077219010100	Pricebook B0JS / WSV_GEOREF_USL_2011_USD_Pressure_Pumping_US_	Rig Horizon 15	
Service Instructions: To provide services, equipment, personnel and materials to safely cement a 4 1/2" liner as per client request. Pump 30 bbls of Gel water, 570 sks of 13.6 ppg slurry, drop dart, and displace as per clients request. / Only puped 385 sks per client request			

THE ESTIMATED CHARGES AND DATA SHOWN BELOW ARE SUBJECT TO CORRECTION BY SCHLUMBERGER

Item	Description	Qty	UOM	Price	Disc	Amount
Products						
B306	PSG Polymer Slurry B306	6	GA	105.00	47.00%	[REDACTED]
D013	Retarder	105	LB	2.79	47.00%	[REDACTED]
D020	Bentonite Extender	627	LB	0.50	47.00%	[REDACTED]
D035-CF	LITEPOZ 3 Extender	286	CF	9.20	47.00%	[REDACTED]
D042	KOLITE Lost Circulation Additive	400	LB	0.99	47.00%	[REDACTED]
D046	Antifoam Agent, All Purpose	96	LB	5.90	47.00%	[REDACTED]
D065	TIC Dispersant	49	LB	7.86	47.00%	[REDACTED]
D079	Chemical Extender	96	LB	3.05	47.00%	[REDACTED]
D112	FLAC Fluid Loss Additive	286	LB	15.20	47.00%	[REDACTED]
D909	Cement, Class H	287	CF	24.13	47.00%	[REDACTED]
Products Subtotal:						[REDACTED]
Discount:						[REDACTED]
Products Total:						[REDACTED]
Services						
48019000	Bulk Unit, Per Hr on location	16	HR	115.00	47.00%	[REDACTED]
49100000	Cement Blending Charge	593	CF	2.43	47.00%	[REDACTED]
49102000	Transportation, Cement Ton-mile	1246	MI	2.16	47.00%	[REDACTED]
59200002	Transportation, Mileage Heavy Vehicles	100	MI	5.91	47.00%	[REDACTED]
59200005	Transportation, Mileage Light Vehicles	100	MI	3.47	47.00%	[REDACTED]
59697004	CemCAT Monitoring System	1	JOB	941.60	47.00%	[REDACTED]
102872105	Pump, Liner/Sqz/Plug 10001-10500 ft	1	EA	7,918.00	47.00%	[REDACTED]
102946000	Fuel Surcharge (non-discounted)	3	EA	450.00		[REDACTED]
107138100	Circulating Equipment before job	1	EA	1,498.00	25.00%	[REDACTED]
107264001	Regulatory Conformance Charge	3	EA	364.87		[REDACTED]
48020000	Pump, Cement Add Hr	10	HR	609.90	35.00%	[REDACTED]
48019000	Bulk Unit, Per Hr on location	20	HR	115.00	35.00%	[REDACTED]
102476001	Equipment Operator/Service Technician	30	HR	90.95	35.00%	[REDACTED]
102476000	Service Supervisor/Field Engineer	10	HR	112.35	35.00%	[REDACTED]
Services Subtotal:						[REDACTED]
Discount:						[REDACTED]
Services Total:						[REDACTED]

Archer Survey Report

Company: Archer Directional Services

Location: Sec 07-T35S-R07W

Well: Michael 3507 1-7H

Rig: Horizon 15

API or UWI:

Job Number: 04076-431-22

State: KS

Operator: Sandridge Energy

County: Harper

Magnetic Declination: 0.00

Comment

Proposed Azimuth: 179.59

North Reference: GRID

Tiein Survey Data:

MD	Inclination	Azimuth	TVD	NS	EW
0.00	0.00	0.00	0.00	0.00	0.00

MD	Inclination	Azimuth	TVD	NS	EW	CA	CD	VS	DLS
232.00	0.80	277.20	231.99	0.20	-1.61	277.20	1.62	-0.21	0.34
478.00	0.50	277.20	477.98	0.55	-4.38	277.20	4.41	-0.58	0.12
721.00	0.50	277.20	720.97	0.82	-6.48	277.20	6.53	-0.86	0.00
853.00	0.40	277.20	852.96	0.95	-7.51	277.20	7.57	-1.00	0.08
1311.00	0.50	230.20	1310.95	-0.13	-10.63	269.30	10.63	0.05	0.08
1784.00	0.20	260.40	1783.94	-1.59	-13.03	263.05	13.13	1.50	0.07
2259.00	0.10	139.40	2258.94	-2.04	-13.58	261.45	13.73	1.94	0.06
2733.00	0.40	160.60	2732.94	-3.92	-12.76	252.93	13.35	3.83	0.07
3209.00	0.20	147.90	3208.93	-6.19	-11.76	242.26	13.29	6.10	0.04
3682.00	0.40	15.20	3681.93	-5.29	-10.89	244.08	12.11	5.22	0.12
3871.00	0.10	124.00	3870.92	-4.75	-10.58	245.83	11.60	4.67	0.23
3935.00	0.20	200.20	3934.92	-4.89	-10.58	245.21	11.65	4.81	0.31
3966.00	0.60	188.70	3965.92	-5.10	-10.62	244.36	11.78	5.02	1.31
3998.00	3.10	171.70	3997.90	-6.12	-10.52	239.81	12.17	6.04	7.91
4029.00	5.40	166.40	4028.82	-8.37	-10.06	230.24	13.08	8.29	7.52
4060.00	7.70	166.80	4059.61	-11.81	-9.24	218.04	14.99	11.74	7.42
4093.00	9.50	166.50	4092.24	-16.61	-8.10	205.99	18.48	16.55	5.46
4124.00	10.50	162.50	4122.77	-21.79	-6.65	196.97	22.78	21.74	3.93
4156.00	11.80	162.50	4154.16	-27.69	-4.79	189.81	28.10	27.66	4.06
4187.00	13.00	166.50	4184.44	-34.10	-3.02	185.06	34.24	34.08	4.76
4219.00	15.00	167.30	4215.49	-41.64	-1.27	181.75	41.66	41.63	6.28
4250.00	17.60	167.20	4245.24	-50.13	0.65	179.26	50.13	50.13	8.39
4282.00	20.40	166.10	4275.49	-60.26	3.06	177.09	60.34	60.28	8.82
4314.00	22.70	165.70	4305.26	-71.66	5.93	175.27	71.91	71.70	7.20
4345.00	25.20	166.10	4333.58	-83.87	8.99	173.88	84.35	83.93	8.08
4377.00	28.30	166.80	4362.16	-97.87	12.36	172.80	98.64	97.95	9.74
4408.00	30.90	168.20	4389.11	-112.82	15.67	172.09	113.90	112.93	8.68
4440.00	33.10	170.10	4416.25	-129.47	18.85	171.72	130.83	129.60	7.56
4472.00	35.10	171.60	4442.74	-147.18	21.70	171.61	148.77	147.33	6.78
4503.00	37.10	173.00	4467.79	-165.28	24.14	171.69	167.03	165.45	6.98
4535.00	38.60	173.50	4493.06	-184.78	26.44	171.86	186.66	184.96	4.78
4567.00	40.50	174.10	4517.73	-205.03	28.64	172.05	207.02	205.23	6.06
4598.00	43.00	174.90	4540.86	-225.58	30.62	172.27	227.65	225.79	8.25
4630.00	45.40	175.60	4563.79	-247.81	32.46	172.54	249.93	248.04	7.65
4662.00	47.50	175.70	4585.84	-270.94	34.22	172.80	273.09	271.17	6.57

4694.00	49.20	176.30	4607.11	-294.79	35.89	173.06	296.96	295.04	5.49
4726.00	50.10	176.30	4627.83	-319.12	37.46	173.31	321.31	319.38	2.81
4757.00	49.90	175.60	4647.75	-342.81	39.14	173.49	345.04	343.08	1.85
4789.00	49.60	174.80	4668.43	-367.15	41.18	173.60	369.45	367.43	2.13
4821.00	49.20	174.70	4689.25	-391.34	43.40	173.67	393.74	391.64	1.27
4851.00	49.50	174.80	4708.80	-414.01	45.49	173.73	416.50	414.32	1.03
4883.00	49.80	175.50	4729.51	-438.31	47.55	173.81	440.88	438.64	1.91
4915.00	51.20	175.60	4749.87	-462.93	49.46	173.90	465.56	463.27	4.38
4947.00	53.30	176.10	4769.46	-488.16	51.29	174.00	490.85	488.51	6.68
4979.00	56.30	176.30	4787.90	-514.25	53.02	174.11	516.97	514.61	9.39
5011.00	59.80	176.20	4804.83	-541.34	54.80	174.22	544.10	541.72	10.94
5042.00	64.00	177.10	4819.43	-568.63	56.39	174.34	571.42	569.02	13.79
5074.00	68.00	177.70	4832.44	-597.83	57.72	174.49	600.61	598.23	12.62
5105.00	71.60	178.50	4843.15	-626.90	58.68	174.65	629.64	627.30	11.86
5137.00	74.10	178.70	4852.58	-657.47	59.43	174.84	660.15	657.87	7.84
5169.00	77.00	179.10	4860.57	-688.44	60.02	175.02	691.06	688.86	9.14
5201.00	79.90	179.70	4866.97	-719.79	60.35	175.21	722.32	720.20	9.25
5232.00	83.10	179.80	4871.56	-750.45	60.48	175.39	752.88	750.86	10.33
5263.00	86.50	180.10	4874.36	-781.31	60.51	175.57	783.65	781.73	11.01
5358.00	90.50	181.60	4876.85	-876.25	59.10	176.14	878.24	876.65	4.50
5390.00	90.70	181.50	4876.52	-908.24	58.23	176.33	910.10	908.63	0.70
5422.00	90.50	182.50	4876.18	-940.21	57.12	176.52	941.95	940.60	3.19
5453.00	90.20	182.90	4875.99	-971.18	55.66	176.72	972.77	971.55	1.61
5485.00	90.40	182.90	4875.82	-1003.14	54.04	176.92	1004.59	1003.50	0.63
5580.00	89.80	184.20	4875.66	-1097.95	48.15	177.49	1099.01	1098.27	1.51
5674.00	89.30	183.90	4876.40	-1191.71	41.52	178.00	1192.44	1191.98	0.62
5769.00	90.20	185.00	4876.81	-1286.43	34.14	178.48	1286.88	1286.64	1.50
5863.00	88.60	184.20	4877.79	-1380.11	26.61	178.90	1380.37	1380.27	1.90
5958.00	88.20	184.50	4880.45	-1474.80	19.40	179.25	1474.93	1474.90	0.53
6052.00	88.30	183.20	4883.32	-1568.54	13.10	179.52	1568.60	1568.60	1.39
6147.00	88.70	181.90	4885.80	-1663.42	8.87	179.69	1663.44	1663.44	1.43
6242.00	88.70	181.60	4887.96	-1758.35	5.97	179.81	1758.36	1758.34	0.32
6337.00	88.80	181.50	4890.03	-1853.29	3.40	179.89	1853.29	1853.27	0.15
6432.00	89.30	180.60	4891.61	-1948.26	1.66	179.95	1948.26	1948.22	1.08
6527.00	88.50	180.60	4893.43	-2043.24	0.67	179.98	2043.24	2043.19	0.84
6622.00	88.50	179.30	4895.92	-2138.20	0.75	179.98	2138.20	2138.15	1.37
6716.00	91.00	179.30	4896.33	-2232.19	1.90	179.95	2232.19	2232.14	2.66
6810.00	92.20	179.30	4893.70	-2326.14	3.04	179.93	2326.14	2326.10	1.28
6904.00	90.50	179.20	4891.49	-2420.10	4.27	179.90	2420.11	2420.07	1.81
6999.00	89.80	178.90	4891.24	-2515.09	5.85	179.87	2515.10	2515.07	0.80
7094.00	91.50	179.20	4890.16	-2610.07	7.42	179.84	2610.08	2610.05	1.82
7188.00	91.60	179.30	4887.62	-2704.02	8.65	179.82	2704.04	2704.02	0.15
7283.00	91.40	178.60	4885.13	-2798.97	10.39	179.79	2798.99	2798.98	0.77
7378.00	90.50	178.40	4883.56	-2893.93	12.88	179.74	2893.96	2893.95	0.97
7472.00	89.60	177.30	4883.48	-2987.86	16.41	179.69	2987.90	2987.90	1.51
7567.00	91.60	177.60	4882.48	-3082.76	20.63	179.62	3082.82	3082.82	2.13
7688.00	94.90	179.20	4875.62	-3203.49	24.01	179.57	3203.58	3203.58	3.03
7783.00	92.70	180.50	4869.33	-3298.28	24.26	179.58	3298.36	3298.36	2.69
7877.00	91.30	181.60	4866.05	-3392.20	22.53	179.62	3392.27	3392.27	1.89
7972.00	88.80	182.10	4865.96	-3487.14	19.47	179.68	3487.20	3487.19	2.68
8067.00	88.20	182.90	4868.45	-3582.02	15.33	179.75	3582.05	3582.04	1.05
8161.00	87.40	184.30	4872.06	-3675.76	9.43	179.85	3675.77	3675.73	1.71
8255.00	86.70	184.40	4876.90	-3769.36	2.31	179.96	3769.36	3769.28	0.75
8350.00	85.50	184.30	4883.36	-3863.87	-4.88	180.07	3863.87	3863.74	1.27
8444.00	86.00	181.40	4890.32	-3957.48	-9.54	180.14	3957.50	3957.31	3.12
8539.00	89.10	180.20	4894.39	-4052.38	-10.86	180.15	4052.39	4052.19	3.50
8634.00	90.70	180.20	4894.55	-4147.37	-11.20	180.15	4147.39	4147.19	1.68

8729.00	90.00	179.10	4893.97	-4242.37	-10.62	180.14	4242.38	4242.18	1.37
8824.00	91.10	178.50	4893.06	-4337.34	-8.63	180.11	4337.35	4337.17	1.32
8920.00	87.70	178.20	4894.06	-4433.28	-5.86	180.08	4433.28	4433.12	3.56
9014.00	86.50	177.70	4898.82	-4527.10	-2.51	180.03	4527.10	4526.96	1.38
9109.00	88.60	178.20	4902.88	-4621.94	0.89	179.99	4621.94	4621.83	2.27
9204.00	92.50	178.20	4901.97	-4716.87	3.87	179.95	4716.88	4716.78	4.11
9299.00	89.30	179.20	4900.48	-4811.82	6.03	179.93	4811.83	4811.74	3.53
9394.00	89.80	179.70	4901.22	-4906.82	6.94	179.92	4906.82	4906.74	0.74
9489.00	89.30	179.10	4901.97	-5001.81	7.93	179.91	5001.81	5001.74	0.82
9584.00	89.00	179.20	4903.38	-5096.79	9.34	179.89	5096.79	5096.72	0.33
9679.00	88.40	180.60	4905.53	-5191.76	9.51	179.90	5191.77	5191.69	1.60
9774.00	89.50	179.70	4907.27	-5286.74	9.26	179.90	5286.75	5286.67	1.50
9868.00	91.50	179.20	4906.45	-5380.73	10.16	179.89	5380.74	5380.66	2.19
9962.00	90.50	177.10	4904.81	-5474.66	13.20	179.86	5474.67	5474.61	2.47
10058.00	89.30	176.90	4904.98	-5570.52	18.22	179.81	5570.55	5570.51	1.27
10099.00	89.30	176.90	4905.48	-5611.46	20.44	179.79	5611.50	5611.46	0.00

Hydraulic Fracturing Fluid Product Component Information Disclosure

Job Start Date:	4/16/2013
Job End Date:	4/17/2013
State:	Kansas
County:	Harper
API Number:	15-077-21901-01-00
Operator Name:	SandRidge Energy
Well Name and Number:	MICHAEL 3507 1-7H
Longitude:	-98.12560000
Latitude:	37.01510000
Datum:	NAD27
Federal/Tribal Well:	NO
Total Base Water Volume (gal):	1,829,953
Total Base Non Water Volume:	



Hydraulic Fracturing Fluid Composition:

Trade Name	Supplier	Purpose	Ingredients	Chemical Abstract Service Number (CAS #)	Maximum Ingredient Concentration in Additive (% by mass)**	Maximum Ingredient Concentration in HF Fluid (% by mass)**	Comments
C102	Bosque Disposal Systems, LLC	Oxidizer					
			Chlorine Dioxide	10049-04-4	15.00000	100.00000	
Ingredients shown above are subject to 29 CFR 1910.1200(i) and appear on Material Safety Data Sheets (MSDS). Ingredients shown below are Non-MSDS.							
HCL 15, Slickwater	Schlumberger	Corrosion Inhibitor, Friction Reducer, Scale Inhibitor, Biocide, Surfactant, Acid, Iron Control Agent, Propping Agent					
			Sodium erythorbate	6381-77-7	0.02201		
			Alkenes, C>10 a-	64743-02-8	0.00109		
			2-Propenoic acid, ammonium salt	10604-69-0	0.00595		
			Crystalline silica	14808-60-7	96.34923		
			C14 alpha olefin ethoxylate	84133-50-6	0.00654		
			Alkyl(c12-16) dimethylbenzyl ammonium chloride	68424-85-1	0.00206		
			Propan-2-ol	67-63-0	0.00093		
			Methanol	67-56-1	0.00881		
			Sorbitan monooleate	1338-43-8	0.02081		
			Alcohols, C12-C16, ethoxylated	68551-12-2	0.01237		
			Glutaraldehyde	111-30-8	0.01154		

		Water (Including Mix Water Supplied by Client)*	-		
		Polyethylene glycol monoethyl ether	81726-34-8	0.10607	
		Ethane-1,2-diol	107-21-1	0.00635	
		Potassium hydroxide	1310-58-3	0.00021	
		Alcohols, C14-15, ethoxylated (7EO)	68951-67-7	0.00245	
		Dicoco dimethyl quaternary ammonium chloride	61789-77-3	0.00465	
		Ethoxylated oleic acid	9004-96-0	0.02378	
		Ethanol	64-17-5	0.00025	
		Prop-2-yn-1-ol	107-19-7	0.00163	
		Sorbitol Tetraoleate	61723-83-9	0.01486	
		Acrylamide/ammonium acrylate copolymer	26100-47-0	0.23783	
		Trisodium ortho phosphate	7601-54-9	0.02231	
		Alcohols, C10-C16, ethoxylated	68002-97-1	0.01225	
		Distillates (petroleum), hydrotreated light	64742-47-8	0.28540	
		Hydrogen chloride	7647-01-0	2.72786	
		Alcohols, C12-C14, ethoxylated	68439-50-9	0.01225	
		Ammonium chloride	12125-02-9	0.13675	
		Thiourea, polymer with formaldehyde and 1-phenylethanone	68527-49-1	0.00526	
		Fatty acids, tall-oil	61790-12-3	0.00639	

* Total Water Volume sources may include fresh water, produced water, and/or recycled water

** Information is based on the maximum potential for concentration and thus the total may be over 100%

Note: For Field Development Products (products that begin with FDP), MSDS level only information has been provided. Ingredient information for chemicals subject to 29 CFR 1910.1200(i) and Appendix D are obtained from suppliers Material Safety Data Sheets (MSDS)

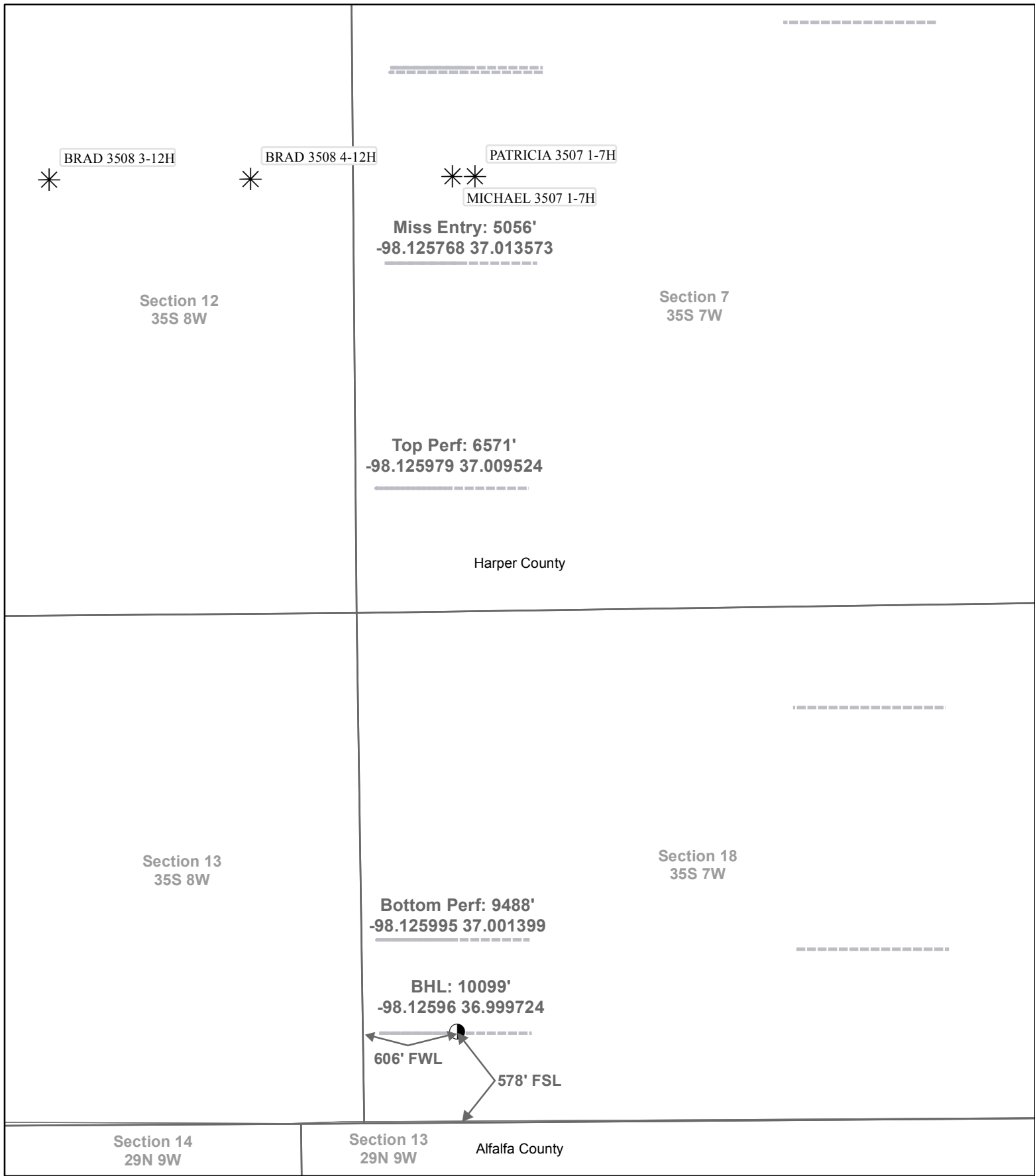

SANDRIDGE
THE POWER OF US™

Actual Bottom-Hole Location of Michael 3507 1-7H
Harper County, Kansas
T&R: 35S 7W
Section: 18, 606' FWL & 578' FSL
Long/Lat:-98.12596 36.999724

1 in = 833 ft

0 650 1,300 2,600 Feet

Draftsman: Aaron Birk	Draft Date: 5/14/2013
Drawing Name/Number: Addendum_Michael_1-7H.mxd	
Coordinate System: NAD 1927 State Plane Kansas South FIPS: 1502	

Remarks

Tiffany Golay
05/01/013 11:03 am

Conductor weight= 106.5 lbs/ft

Tiffany Golay
03/04/013 11:15 am

TD= 10,099 TVD= 4,905