

Proposed Plan of Construction
 Koehn D-1
 Sec 2 T28S-R33W
 Haskell County, KS

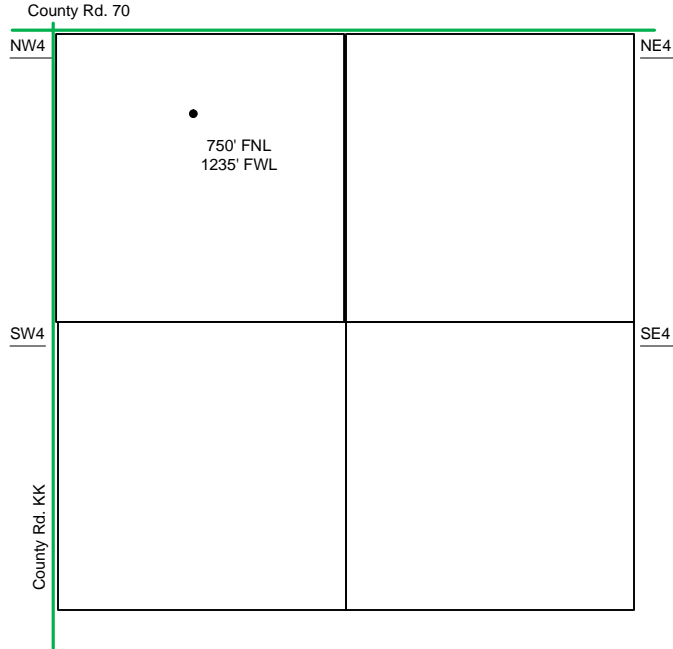

Sec 2 – T28S – R33W

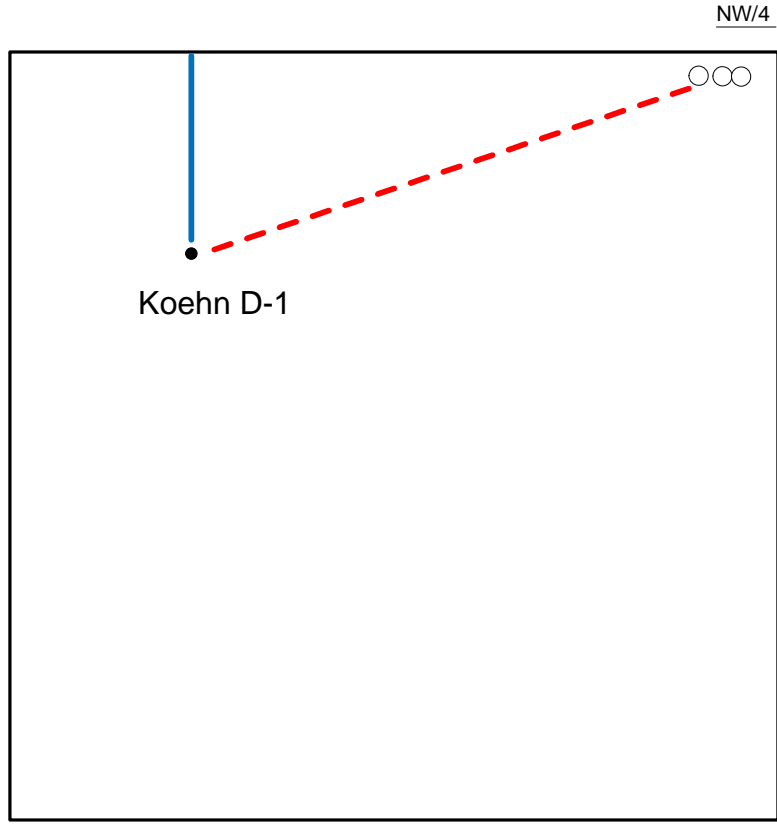

The **Proposed** Tank Battery for the Koehn D-1 is located in the NE of the NW quarter.

- Well Location
- Proposed Lease Roads
- - - Proposed Pipeline
- Proposed Tank Battery
- Proposed Power Lines
- - - Existing Pipeline

Proposed Details of
 NW/4 Sec 2 -T28S -R33W

Note-Drawing **Not** to Scale

